

1-10-10-30  
4

# PERMIT 03-296040

SEWAGE DISPOSAL SYSTEM  
HOWARD COUNTY HEALTH DEPARTMENT  
BUREAU OF ENVIRONMENTAL HEALTH  
410-313-2640

P 515255

A REPAIR

ISSUE DATE 5/22/2001

APPROVAL DATE 6/4/01

INDEXED

South Carroll Backhoe, Inc

IS PERMITTED TO INSTALL x ALTER       

ADDRESS 4410 Salem Bottom Road, Westminster, MD 21157 PHONE 410-875-4197

SUBDIVISION        LOT NUMBER        ADDRESS 12625 Triadelphia Road

PROPERTY OWNER Robert Markush PROPERTY OWNER'S ADDRESS Same

SEPTIC TANK CAPACITY EX. 1000 GALLONS

PUMP CHAMBER CAPACITY        GALLONS

NUMBER OF BEDROOMS 4

SQUARE FEET PER BEDROOM 180

LINEAR FEET OF TRENCH REQUIRED 100

TRENCHES: Trenches to be 2 feet wide. Inlet 3 feet below original grade. Bottom maximum depth 10 1/2 feet below original grade. 7 feet of stone below distribution box.

LOCATION: REPAIR - PURPOSE - Existing system has failed. In support of B00130334 (IBR Add'l)  
Call for inspection when ground is opened so sanitarian can recommend repair. 5/22

PLANS APPROVED        DATE       

PERMIT VOID AFTER 2 YEARS

NOTE: CONTRACTOR RESPONSIBLE FOR SCHEDULING A PRE-CONSTRUCTION INSPECTION FOR ALL INSTALLATIONS

NOTE: TOP OF SEPTIC TANKS ARE TO BE NO DEEPER THAN 3.0 FEET BELOW FINISH GRADE

NOTE: WATERTIGHT SEPTIC TANKS REQUIRED

NOTE: CLEANOUT REQUIRED EVERY 70 FEET OF SEWER LINE AND/OR AT 90° SWEEPS IN LINES FROM HOUSE TO DRAIN FIELDS, 90° ELBOWS ARE NOT ACCEPTABLE

NOTE: ALL PARTS OF SEPTIC SYSTEMS (I.E. TANK, DISTRIBUTION BOX, DRAINFIELDS) TO BE 100 FEET FROM ANY WATER WELL UNLESS OTHERWISE SPECIFICALLY AUTHORIZED

NOTE: NO ABSORPTION TRENCH TO EXCEED 100 FEET IN LENGTH UNLESS SPECIFICALLY AUTHORIZED

NOTE: ALL PIPE FROM HOUSE TO SEPTIC TANK MUST BE CAST IRON OR SCHEDULE 35/40 PVC OR ABS

NOTE: MANHOLE RISERS REQUIRED ON ALL SEPTIC TANKS AND PUMP CHAMBERS

NOTE: DISTRIBUTION BOXES MUST HAVE BAFFLES

NOTE: IF PUMPED SEPTIC SYSTEM REQUIRED, (1) SEPTIC PUMP DETAIL TO BE PROVIDED BY INSTALLER PRIOR TO ISSUANCE OF SEPTIC PERMIT (2) PUMP PERFORMANCE TEST IS NECESSARY PRIOR TO HEALTH DEPARTMENT APPROVAL OF SEPTIC PERMIT

NEITHER THE HOWARD COUNTY COUNCIL NOR THE HEALTH DEPARTMENT IS RESPONSIBLE FOR THE  
SUCCESSFUL OPERATION OF ANY SYSTEM  
PERMITTEE RESPONSIBLE FOR OBTAINING FINAL APPROVAL ON THIS PERMIT  
CALL 410-313-2640 FOR INSPECTION OF SEPTIC SYSTEM

NOT TO SCALE

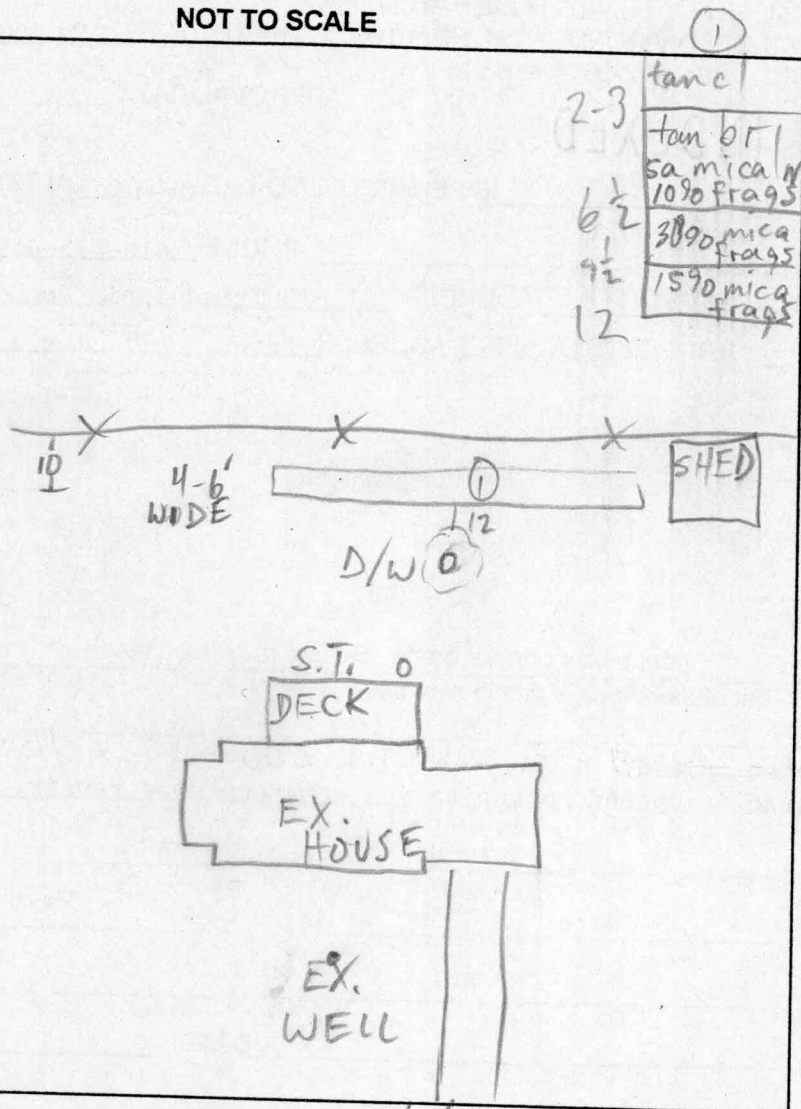

### TRENCH DATA

TRENCH WIDTH 4-6' ±

TRENCH INLET DEPTH 3

TRENCH BOTTOM DEPTH 10

DEPTH OF STONE 7

NUMBER OF TRENCHES 1

TOTAL TRENCH LENGTH 50-55

ABSORBENT AREA 350 + 350 = 700

DISTRIBUTION BOX LEVEL —

BAFFLE IN DISTRIBUTION BOX —

### SEPTIC TANK DATA

SEPTIC TANK EX. 1000 GALLONS

MANHOLE RISER —

6 INCH INSPECTION PORT ✓

### PUMP CHAMBER DATA

PUMP CHAMBER GALLONS —

MANHOLE RISER —

ALARM —

PUMP PERFORMANCE TEST —

PRE-CONSTRUCTION INSPECTION: 6/4/01 OK TO START MR

INSPECTION COMMENTS: 6/4/01 PER INSTALLER, TRENCH WALL COLLAPSED  
TRENCH NOW 4-6' WIDE @ MOST LOCATIONS; OK TO COVER MR

INSPECTOR M. Rifkin DATE SYSTEM APPROVED 6/4/01