

PERMIT

SEWAGE DISPOSAL SYSTEM

DEPARTMENT OF HEALTH AND MENTAL HYGIENE

P 46784

A 46659

DISTRICT _____

DATE 1/31/91

DATE SYSTEM APPROVED 2/13/91

INSPECTOR M. Riffin

INDEXED

HOWARD COUNTY HEALTH DEPARTMENT
BUREAU OF ENVIRONMENTAL HEALTH
461-9933

Bill Ingram, Farm and Home Excavating IS PERMITTED TO INSTALL ALTER _____

ADDRESS 14954 Bushy Park Road, Woodbine, Maryland 21797 PHONE 442-2139

SUBDIVISION _____ LOT _____ ROAD 14831 Triadelphia Road

PROPERTY OWNER Dr. Charles Goshen 465-1352

ADDRESS _____ 964-9484

SEPTIC TANK CAPACITY 1000 GALLONS

NUMBER OF BEDROOMS _____

BARN ONLY

630 SQUARE FEET TOTAL

LOCATION MAY BE ADJUSTED DOWNHILL IF SATISFACTORY
SOIL CONDITIONS ARE CONFIRMED AT TIME OF SEPTIC
SYSTEM INSTALLATION.

LINEAR FEET OF TRENCH REQUIRED 210

TRENCHES - 630 sq. ft. total. Trench to be 3 feet wide. Inlet 3 feet below original grade. Bottom maximum depth 5 feet below original grade. Effective area begins at 3 feet below original grade. 2 feet of stone below distribution pipe.

LOCATION - Install 3 - 70' trenches at highest location in the sewage disposal easement that can be plumbed by gravity from the Barn. The beginning of the highest trench will be approximately 300' from the front property line and 400' from the right property line.

PLANS APPROVED BY Craig Williams *ok/cw* cm DATE 01/25/91

COVER NO WORK UNTIL INSPECTED AND APPROVED

NEITHER THE HOWARD COUNTY COUNCIL NOR THE HEALTH DEPARTMENT IS RESPONSIBLE FOR THE SUCCESSFUL OPERATION OF ANY SYSTEM

NOTE: CLEANOUT REQUIRED EVERY 70 FEET OF SEWER LINE AND/OR AT 90° SWEEPS IN LINES FROM HOUSE TO DRAIN FIELDS, 90° ELBOWS NOT ACCEPTABLE.

NOTE: ALL PARTS OF SEPTIC SYSTEMS (I.E. TANK, DISTRIBUTION BOX TRENCHES) TO BE 100 FEET FROM WELL (UNLESS OTHERWISE SPECIFICALLY AUTHORIZED)

NOTE: IF DEEP TRENCH(ES) ARE USED CALL FOR INSPECTION BEFORE AND AFTER PLACING GRAVEL IN TRENCH(ES)

NOTE: NO DRY WELL SHALL EXCEED 15 FOOT IN DIAMETER NO ABSORPTION TRENCH TO EXCEED 100 FEET IN LENGTH

NOTE: ALL PIPE FROM HOUSE TO SEPTIC TANK MUST BE CAST IRON OR SCHEDULE 35/40 PVC OR ABS

PERMIT VOID AFTER TWO YEARS

NOTE: INSTALL STAND PIPE ON SEPTIC TANK AND DRY WELL STAND PIPES MUST BE 6 INCHES IN DIAMETER CAST IRON. CONCRETE OR TERRA COTTA OR PVA OR ABS ACCEPTED. IF TOP OF SEPTIC TANK IS DEEPER THAN 3 FEET. MANHOLE TO GRADE REQUIRED.

NOTE: DISTRIBUTION BOXES MUST HAVE BAFFLES

***INSTALLER IS RESPONSIBLE FOR OBTAINING FINAL APPROVAL ON THIS PERMIT**

P.
46659

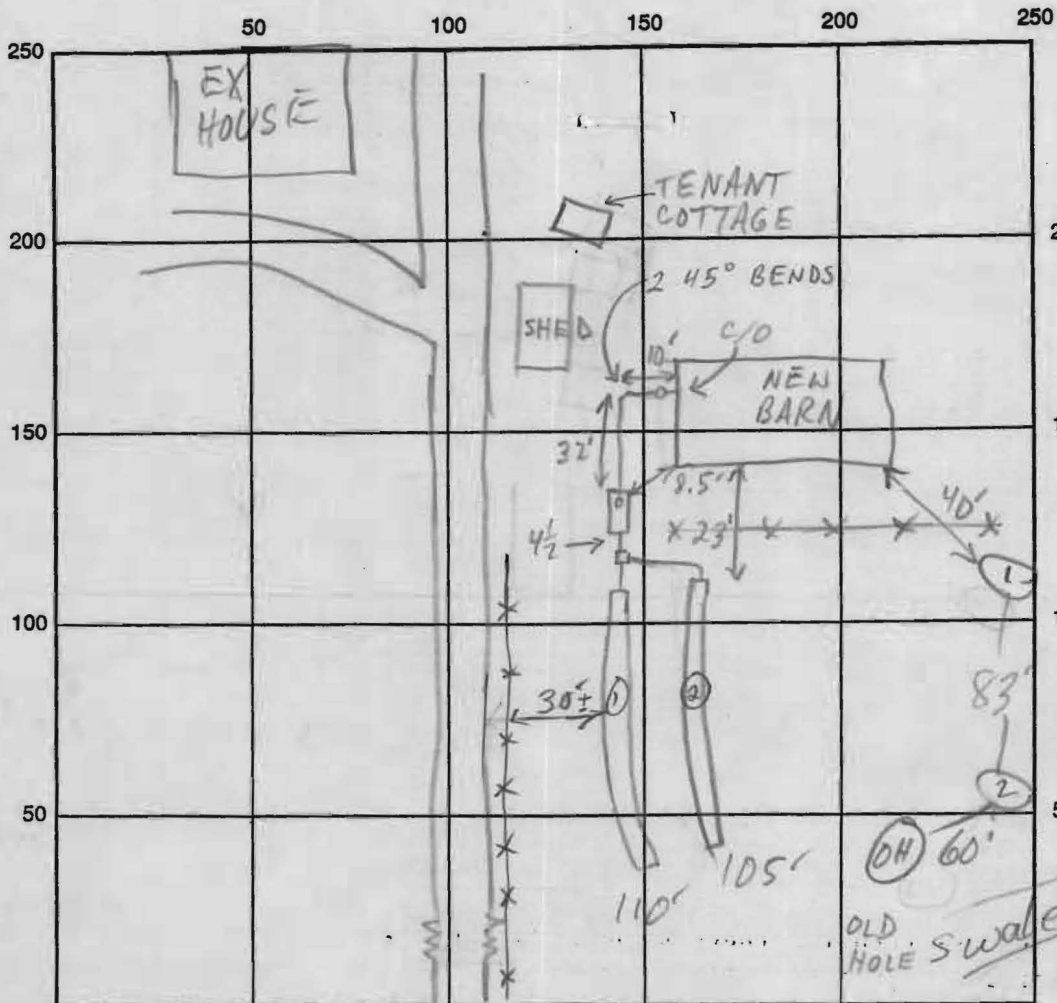

VISUAL HOLE
 ① 10 1/2
 DRY-OK
 ② 7'
 DRY
 SHOULD'VE
 GONE
 DEEPER-
 OK

TRIA RD INDICATE NORTH - NAME ADJOINING ROADWAY AS BASE LINE

SEPTIC TANK LEVEL 1000 GAL - OK CLEANOUTS OK
 DISTRIBUTION BOX LEVEL OK - BAFFLE IN
 DRAIN FIELD/TITLE DEPTH 5.5 / 5 FT. TRENCH WIDTH 3 FT. INLET DEPTH 3.5 / 3.5 FT.
 EFFECTIVE GRAVEL DEPTH 2 / 1.5 FT. TOTAL LENGTH 110 / 105 FT.
 NUMBER OF TRENCHES 2 ONE SIDEWALL/BOTTOM AREA 330 / 315 SQ. FT.
 DRYWALL INSIDE DIAMETER — FT. EFFECTIVE DEPTH BELOW INLET — FT.
 ABSORBENT AREA 645 SQ. FT.

REMARKS: 2/13/91 OK TO COVER ALL MR

DATE SYSTEM APPROVED 2/13/91 INSPECTOR M. Riskin