

Triadelphia Road ←

(Entrance from the Road)

605
 Dk. Brown
 2-7 sbk SL
 -----1.5'
 Lt.-Brown
 SCL, Mica
 Stony
 -----4'
 Red - Brown,
 Lt.-Brown, SL
 Mica
 -----7'
 Lt.-Brown
 Yellow, SL
 ↓
 Channers
 Mn Coatings
 -----13'

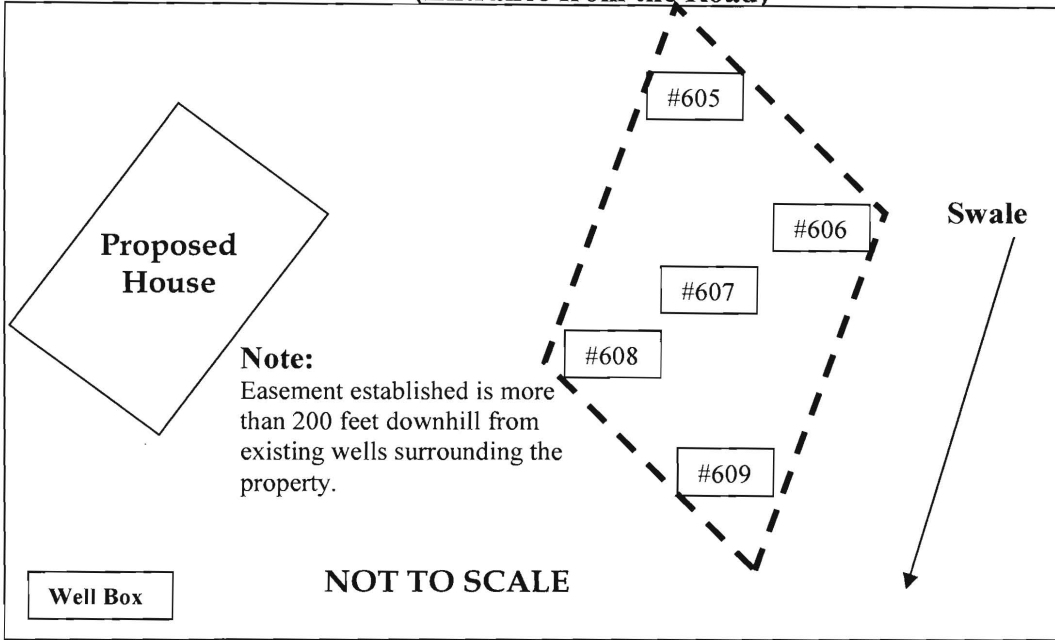

606
 Dk. Brown
 2-7 sbk SL
 -----1'
 Red-Brown
 SL
 Many Mica
 Heavy
 -----3'
 Lt. Brown
 Yellow
 SL
 ↓
 Flags,
 Channers
 Small Rocks
 -----12'

607
 Brown SL
 2-7 msbk
 -----2'
 Lt. Red-
 Brown
 SL
 Few Mica
 -----7'
 Yellow
 Brown SL
 ↓
 -----10'
 Lt. Brown
 SL, Flags
 10%
 Channers
 -----12'

Date	Test #	Depth	Start	Break 1" Drop	Break 2" Drop	Time of 2 nd Inch	P/F/H
12-16-08	605	4'/13'	9:26	9:31	9:36	5 min.	Pass
12-16-08	606	4.5'/12'	9:31	9:33	9:37	4 min.	Pass
12-16-08	607	12'	<i>Visual Center Hole</i>				Pass
12-16-08	608	4'/12'	9:42	9:44	9:47	3 min.	Pass
12-16-08	609	4'/14'	9:49	9:51	9:54	3 min.	Pass

608
 Dk. Brown
 sbk SL
 -----1.5'
 Lt. Brown
 Red-Yellow
 SL
 Stony
 Many Mica
 -----3'
 Red-Yellow
 Brown SL
 ↓
 5-10%
 Channers
 Flags
 -----12'

609
 Dk. Brown SL
 2-7 sbk
 -----1.5'
 Yellow Red-
 Brown
 SL, Mica
 -----4'
 Red - Brown
 SL
 Manganese
 Deposits
 -----6'
 Lt.-Brown
 FSL
 5-10% Flags
 Channers
 -----14'

#

Remarks: Tax Map 27, Parcel 127

Sanitarian DB & RB Backhoe Justin Others

Test Holes Used in Avg. Perc Time 4min. SQ.FT/BR

Trench Width Inlet Depth Max Bottom Depth Effective S/W

#605
 1/2" sub angular
 blk King
 Blk stone 3'
 Lt Brn 2' 3"
 Yellow 1' 3"
 Lt Brn 1' 3"
 1/2" Black 1'
 Yellow 1' 3"
 Yellow Lt Brn
 1/2" Channel
 Magnese Casting
 #

#606
 Brae Sub Angular Baking
 Rd 13 2'
 many mica
 Vlt Brn 3'
 IS
 Channel
 Vlt Brn 12'
 Small Rocks

#607
 Sub Blking
 Yel Lt Brn
 Rd 13 3'
 Yellow Lt Brn
 IS
 1/2" Flggs
 Vlt Brn 2'

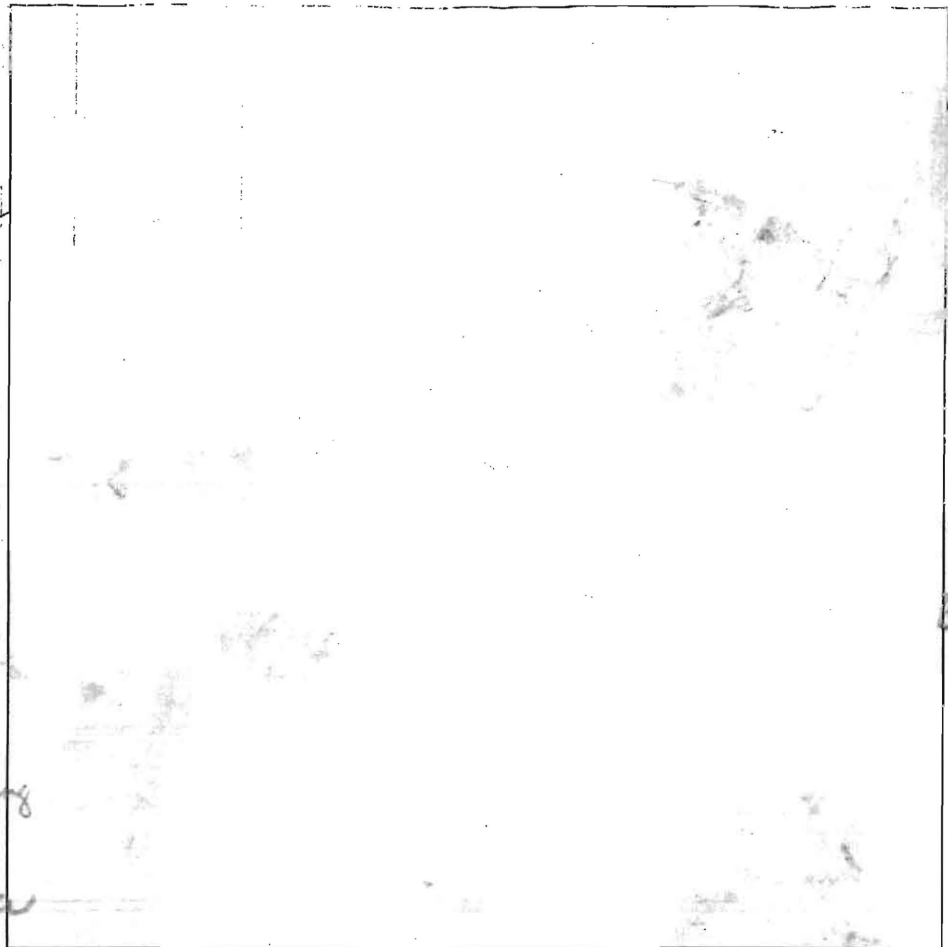

#608
 Brae Sub Angular
 Sh Ry
 Lt. Brown 2'
 stoney
 Lt Brn 3'
 mica
 Channel
 Flggs 12'
 #609
 Brae
 Yellow 5L
 Lt. Brown 3'
 Rd Brn
 2' Depos
 Flggs
 Channel
 Lt Brn
 Sh
 ↓

DATE	TEST #	DEPTH	START	BREAK 1" DROP	STOP 2" DROP	TIME OF 2ND INCH	P/F/H
12/16	605	4/13	0	5:45	5:55	5	P
12/16	606	4.5/12	9:31	9:33	9:37	4	P
12/16	608	4/12	9:42	9:44	9:47	3	P
12/16	609	4/14	9:49	9:51	9:54	3	P
12/16	607	12V	isual	center			P
				ble			

REMARKS _____

SANITARIAN _____ BACKHOE _____ OTHERS _____

TEST HOLES USED IN SDA _____ AVG. PERC TIME _____ SQ. FT/BR _____

TRENCH WIDTH _____ INLET DEPTH _____ MAX. BOT DEPTH _____ EFFECTIVE SW _____

SYMBOL	NAME / DESCRIPTION	SOIL GROUP
GqB	Glenelg loam, 3 to 8 percent slopes	B
GmB	Glenelg silt loam, 3 to 8 percent slopes	C
GnB	Glenville-Baile silt loams, 0 to 8 percent slopes	C
MaC	Manor loam, 8 to 15 percent slopes	B
MaD	Manor loam, 15 to 25 percent slopes	B
MkF	Manor-Brinklow complex, 25 to 65 percent slopes, very rocky	B

LOT NUMBER	GROSS AREA	PIPESTEM AREA	MINIMUM LOT SIZE
3	3,439 AC±	0.416 AC±	3,023 AC±

LEGEND

- Existing Contour
- Existing Trees to Remain
- Soil Boundary
- Existing Well
- Existing Septic Easement
- Proposed Septic Easement
- Proposed Well Area
- Moderate Slopes (15% - 24.99%)
- Percolation Test Pass
- Percolation Test Fail
- Existing Fence
- Proposed House

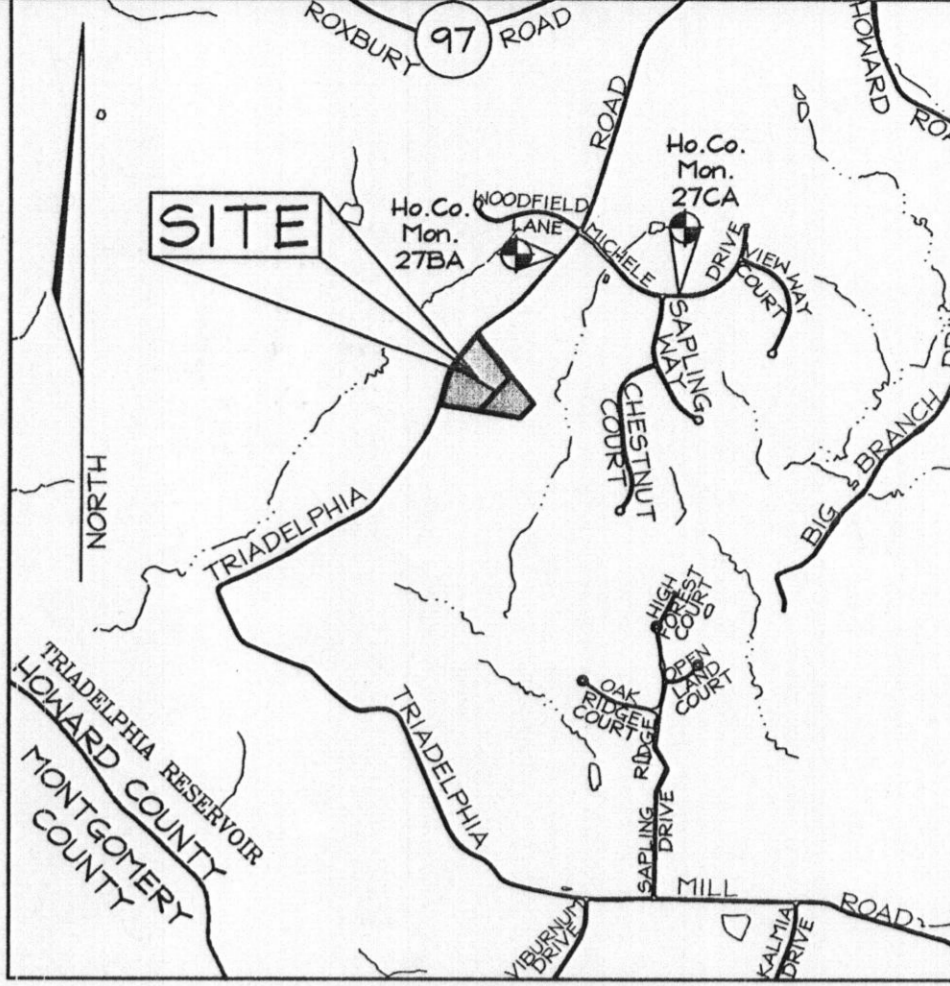

VICINITY MAP
 SCALE: 1" = 2000'
 HOWARD COUNTY ADC MAP 13 B1
GEODETIC SURVEY CONTROL
 Sta. 278A N 575,664.0689 E 1,305,908.9268 ELEV 524.540
 Sta. 27CA N 575,270.0519 E 1,307,150.2455 ELEV 530.836

GENERAL NOTES

1. Subject property zoned RC-DEO per 02/02/04 Comprehensive Zoning Plan and the "Comp. Lite" Zoning Amendments effective on 07/28/06.
2. Reference: Plat 4071
3. The topography shown hereon is based on a field run topographic survey performed by FSH Associates, Inc. in October, 2008. The project boundary is based on a field run boundary survey performed by FSH Associates, Inc. in October, 2008 by a professional surveyor.
4. Contractor to confirm all dimension, utilities and topography in the field. If any conflicts arise, contact Engineer before beginning any work.
5. Private water, and sewer will be used within this site.
6. This area designates a private sewage reserve area, of at least 10,000 SF, as required by the Maryland State Department of the Environment for individual sewage disposal (COMAR 26.04.03). Improvements of any nature in this area are restricted until public sewerage is available. These reserve areas shall become null and void upon connection to a public sewerage system. The County Health Officer shall have the authority to grant adjustments to the private sewage reserve area. Recordation of a modified sewage reserve area shall not be necessary.
7. All wells and septic fields within 100' of property's boundary have been shown.
8. Septic fields are located on soil types MaC and MaD as per the soil survey of Howard County.
9. Total Area of Site = 10.165 ac.±
10. Deed history:
 Lot 1 September, 2008-Present: Robert E. Hecht Jr. & Patricia A. Hecht
 Lot 2 December, 2006-Present: Robert E. Hecht Jr. & Patricia A. Hecht
11. Existing septic fields shown are taken from available record plats.
12. The lots shown hereon comply with the minimum ownership, width and lot area as required by the Maryland Department of the Environment.
13. All wells to be drilled prior to submittal of record plat for signature. It is the developer's responsibility to schedule the well drilling prior to final plat submission. It will not be considered 'government delay' if the well drilling holds up the Health Department signature of the record plat.
14. Any changes to a private sewage easement shall require a Revised Percolation Certification Plan.
15. All percolation test holes on Lot 3 have been field located by FSH Associates by a professional surveyor.

PERC. CHART 12/08 TEST

Number	Elevation
605	478.43
606	478.82
607	484.23
608	490.10
609	489.24

PERC. CHART 11/08 TEST

Number	Elevation
600	479.30
601	487.14
602	487.64
603	485.61
604	492.76
605	478.41
606	495.60



OWNER/ DEVELOPER
 BOB HECHT
 14895 Triadelphia Road
 Glenelg, Maryland 21737-9407
 (410) 442-1598

PERCOLATION CERTIFICATION PLAN #2
 A-530209
HECHT PROPERTY
 LOTS 1-3
 A RESUBDIVISION OF LOTS 1 AND 2 OF THE JEREMY STATION PLAT 4071
 TAX MAP 27 GRID 4 PARCEL 125
 5TH ELECTION DISTRICT HOWARD COUNTY, MARYLAND

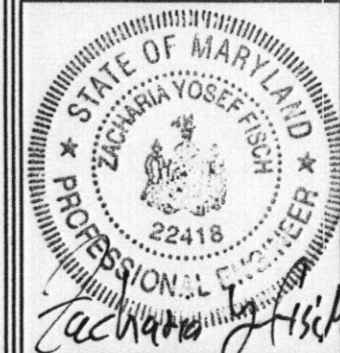

FSH Associates
 Engineers Planners Surveyors
 6339 Howard Lane Elkridge, MD 21075
 Tel: 410-567-5200 Fax: 410-796-1562
 E-mail: info@fshri.com

DESIGN BY: ZYF
 DRAWN BY: AY
 CHECKED BY: ZYF
 SCALE: 1" = 50'
 DATE: Feb. 9, 2009
 W.O. No.: 3574
 SHEET No.: 1 OF 1

PROFESSIONAL CERTIFICATION
 I hereby certify that these documents were prepared or approved by me, and that I am a duly licensed professional engineer under the laws of the State of Maryland, License No. #22418, Expiration Date: 07/29/09.

PLAN VIEW
 SCALE: 1" = 50'

APPROVED FOR PRIVATE WATER AND PRIVATE SEWERAGE SYSTEMS IN ACCORDANCE WITH THE MASTER PLAN OF HOWARD COUNTY
 B. Wilson for Peter Beilewson
 COUNTY HEALTH OFFICER
 HOWARD COUNTY HEALTH DEPARTMENT
 2/26/2009
 DATE