

<b>C1</b> <b>9783</b>		SEQUENCE NO. (MDE USE ONLY)	<b>STATE OF MARYLAND</b> <b>WELL COMPLETION REPORT</b> FILL IN THIS FORM COMPLETELY PLEASE PRINT OR TYPE		THIS REPORT MUST BE SUBMITTED WITHIN 45 DAYS AFTER WELL IS COMPLETED.	
1 2 3 6 (THIS NUMBER IS TO BE PUNCHED IN COLS. 3-6 ON ALL CARDS)				COUNTY NUMBER <b>W510214</b>		
ST/CO USE ONLY DATE Received MM DD YY 8 13		DATE WELL COMPLETED MM DD YY 6 25 98		Depth of Well 22 240 26 (TO NEAREST FOOT)		
OWNER <b>Crane</b> last name		first name <b>Earl</b>		PERMIT NO. FROM "PERMIT TO DRILL WELL" <b>H6-94-1601</b>		
STREET OR RFD <b>1150 Underwood Rd.</b>		TOWN <b>Sykesville</b>		21784		
SUBDIVISION <b>Caeser Knoll</b>		SECTION		LOT <b>3</b>		

<b>WELL LOG</b> Not required for driven wells		
STATE THE KIND OF FORMATIONS PENETRATED, THEIR COLOR, DEPTH, THICKNESS AND IF WATER BEARING		
DESCRIPTION (Use additional sheets if needed)	FEET FROM TO	check if water bearing
Sand	0 19	
Gray Granite	19 240	✓

<b>GROUTING RECORD</b>			
WELL HAS BEEN GROUTED (Circle Appropriate Box) <b>Y</b> <b>N</b>			
TYPE OF GROUTING MATERIAL (Circle one)			
CEMENT <b>CM</b>	BENTONITE CLAY <b>BC</b>		
NO. OF BAGS <b>6</b>	NO. OF POUNDS <b>564</b>		
GALLONS OF WATER <b>36</b>			
DEPTH OF GROUT SEAL (to nearest foot)			
from 48 TOP 52 ft. to 54 BOTTOM 58 ft. (enter 0 if from surface) <b>0</b> <b>20</b>			
<b>CASING RECORD</b>			
casing types insert appropriate code below	<b>ST</b>	<b>CO</b>	
	STEEL	CONCRETE	
	<b>PL</b>	<b>OT</b>	
	PLASTIC	OTHER	
MAIN CASING TYPE <b>ST</b>	Nominal diameter top (main) casing (nearest inch)! <b>6</b>	Total depth of main casing (nearest foot) <b>23</b>	
60 61	63 64	66 70	
<b>OTHER CASING (if used)</b>			
EACH CASING	diameter inch	depth (feet) from to	
<b>SCREEN RECORD</b>			
screen type or open hole	<b>ST</b>	<b>BR</b>	<b>HO</b>
(insert appropriate code below)	STEEL	BRASS	OPEN HOLE
		BRONZE	
	<b>PL</b>	<b>OT</b>	
	PLASTIC	OTHER	

<b>C3</b>		
<b>PUMPING TEST</b>		
HOURS PUMPED (nearest hour)	<b>3</b>	
PUMPING RATE (gal. per min.)	<b>15</b>	
METHOD USED TO MEASURE PUMPING RATE <b>air</b>		
WATER LEVEL (distance from land surface)		
BEFORE PUMPING	<b>30</b> ft.	
WHEN PUMPING	<b>180</b> ft.	
TYPE OF PUMP USED (for test)		
<b>A</b> air	<b>P</b> piston	<b>T</b> turbine
<b>C</b> centrifugal	<b>R</b> rotary	<b>O</b> other (describe below)
<b>J</b> jet	<b>S</b> submersible	

NUMBER OF UNSUCCESSFUL WELLS: <b>0</b>
WELL HYDROFRACTURED <b>Y</b> <b>N</b>
CIRCLE APPROPRIATE LETTER
<b>A</b> A WELL WAS ABANDONED AND SEALED WHEN THIS WELL WAS COMPLETED
<b>E</b> ELECTRIC LOG OBTAINED
<b>P</b> TEST WELL CONVERTED TO PRODUCTION WELL
I HEREBY CERTIFY THAT THIS WELL HAS BEEN CONSTRUCTED IN ACCORDANCE WITH COMAR 26.04.04 "WELL CONSTRUCTION" AND IN CONFORMANCE WITH ALL CONDITIONS STATED IN THE ABOVE CAPTIONED PERMIT, AND THAT THE INFORMATION PRESENTED HEREIN IS ACCURATE AND COMPLETE TO THE BEST OF MY KNOWLEDGE.
DRILLERS LIC. NO. <b>MSD024</b>
DRILLERS SIGNATURE (MUST MATCH SIGNATURE ON APPLICATION)
LIC. NO. <b>MSD027</b>
SITE SUPERVISOR (sign. of driller or journeyman responsible for sitework if different from permittee)

<b>C2</b>		
DEPTH (nearest ft.)		
1 <b>H6</b> 22 240		
8 9 11 15 17 21		
23 24 26 30 32 36		
38 39 41 45 47 51		
SLOT SIZE 1 2 3		
DIAMETER OF SCREEN (NEAREST INCH)		
56 60		
from to		
GRAVEL PACK IF WELL DRILLED WAS FLOWING WELL INSERT F IN BOX 68		
MDE USE ONLY (NOT TO BE FILLED IN BY DRILLER)		
T	(E.R.O.S.) W Q	
70 72		
TELESCOPE CASING	LOG INDICATOR	74 75 76 OTHER DATA

<b>PUMP INSTALLED</b>	
DRILLER WILL INSTALL PUMP	YES <b>NO</b>
(CIRCLE) (YES or NO)	
IF DRILLER INSTALLS PUMP, THIS SECTION MUST BE COMPLETED FOR ALL WELLS.	
TYPE OF PUMP INSTALLED PLACE (A,C,J,P,R,S,T,O) IN BOX 29	
CAPACITY: GALLONS PER MINUTE (to nearest gallon)	31 35
PUMP HORSE POWER	37 41
PUMP COLUMN LENGTH (nearest ft.)	43 47
CASING HEIGHT (circle appropriate box and enter casing height)	
<b>+</b> above	LAND SURFACE
<b>-</b> below	(nearest foot)
LOCATION OF WELL ON LOT	
SHOW PERMANENT STRUCTURE SUCH AS BUILDING, SEPTIC TANKS, AND /OR LANDMARKS AND INDICATE NOT LESS THAN TWO DISTANCES (MEASUREMENTS TO WELL)	
<b>See Attached -</b>	

B 1	6792	SEQUENCE NO. (MDE USE ONLY)	STATE OF MARYLAND PERMIT TO DRILL WELL please print or type	STATE PERMIT NUMBER 40-94-1601 fill in this form completely
-----	------	--------------------------------	---	---

Date Received (APA) 06/16/98

OWNER INFORMATION

8 MM DD YY 13

15 Last Name Crane Owner Earle First Name 34

36 1150 Underwood Rd. Street or RFD 55

57 Sykesville Md 21784 Town 70 State 72 Zip 76

DRILLER INFORMATION

Driller's Name Joseph L. Mayne M S D 24 76 License No. 81

Firm Name Joseph L. Mayne Well Drilling

Address 5512 Ridge Rd. Mt. Airy, Md. 21771

Signature Joseph L. Mayne Date 6/16/98

B 2 WELL INFORMATION

APPROX. PUMPING RATE 5 (GAL. PER MIN.) 8 12

AVERAGE DAILY QUANTITY NEEDED 500 (GAL. PER DAY) 14 20

USE FOR WATER (CIRCLE APPROPRIATE BOX)

☒ DOMESTIC POTABLE SUPPLY & RESIDENTIAL IRRIGATION

☐ FARMING (LIVESTOCK WATERING & AGRICULTURAL IRRIGATION)

☐ INDUSTRIAL, COMMERCIAL, DEWATERING

☐ PUBLIC WATER SUPPLY WELL

☐ TEST, OBSERVATION, MONITORING

☐ GEO-THERMAL

APPROXIMATE DEPTH OF WELL 240 FEET

APPROXIMATE DIAMETER OF WELL 6 INCH

METHOD OF DRILLING (circle one)

BORED (or Augered) JETTED Jetted & DRIVEN

AIR-ROTARY AIR-PERCussion ROTARY (Hydraulic Rotary)

CABLE REVERSE-ROTARY Drive-POINT

other

REPLACEMENT OR DEEPEMED WELLS (CIRCLE APPROPRIATE BOX)

☐ THIS WELL WILL NOT REPLACE AN EXISTING WELL

☐ THIS WELL WILL REPLACE A WELL THAT WILL BE ABANDONED AND SEALED

☒ THIS WELL WILL REPLACE A WELL THAT WILL BE USED AS A STANDBY-CONTACT LOCAL APPROVING AUTHORITY FOR POLICY ON STANDBY WELLS

☐ THIS WELL WILL DEEPEMED AN EXISTING WELL

PERMIT NUMBER OF WELL TO BE REPLACED OR DEEPEMED (IF AVAILABLE) 41 52

Not to be filled in by driller (MDE OR COUNTY USE ONLY)

APPROX. PERMIT NUMBER 54 G A P 63

PERMIT No. 40-94-1601

B 3 LOCATION OF WELL

8 COUNTY Howard 21

23 SUBDIVISION Gerber Knoll 42

SECTION 44 46 LOT 3 48 50

52 NEAREST TOWN Sykesville 71

MILES FROM TOWN (enter 0 if in town) 6 M I 73 76 77 78

B 4

1 2 DIRECTION OF WELL FROM TOWN (CIRCLE BOX)

11 22 Underwood Rd. 30

ON WHICH SIDE OF ROAD (CIRCLE APPROPRIATE BOX)

34 300 37 DISTANCE FROM ROAD ENTER FT OR MI 38 39 F1

TAX MAP: 9 BLK: 8 PARCEL 80

NOT TO BE FILLED IN BY DRILLER HEALTH DEPARTMENT APPROVAL

Howard W510214

COUNTY NAME COUNTY NO.

STATE SIGNATURE INSERT S

DATE ISSUED 06/19/98 Mark E. Liffkin 6/19/99

43 MM DD YY 48 CO SIGNATURE EXP. DATE

NORTH GRID 548 000 EAST GRID 0803 000

SHOW MAJOR FEATURES OF BOX & LOCATE WELL WITH AN X

SOURCES OF DRILLING WATER

1. Well

2.

3.

WRITE THE BOX NUMBER FROM THE MAP HERE

E 80X3

N 54X8

15 gal/min (No well TAG. Present)

23' casing

20' void

6 bags 2 6/25/98 H.O.

DRAW A SKETCH BELOW SHOWING LOCATION OF WELL IN RELATION TO NEARBY TOWNS AND ROADS AND GIVE DISTANCE FROM WELL TO NEAREST ROAD JUNCTION

Sykesville

Forsythe Rd.

Underwood Rd.

well

SPECIAL CONDITIONS

NOTE - APPROVING AUTHORITIES SHOULD USE SEPARATE SHEET IF NEEDED -



410-442-2247

Mrs. Crane

Spoke to Mrs. Crane  
she will call for  
sampling.

2/8/01

SRK

---

HOWARD COUNTY HEALTH DEPARTMENT

---

*Diane L. Matuszak, M.D., M.P.H., County Health Officer*

February 5, 2001

Earl Crane  
1150 Underwood Road  
Sykesville, MD 21784

RE: **Replacement Well Issues**  
1150 Underwood Road  
Well Permit #: HO-94-1601

Dear Mr. Crane:

File review indicates that this office has no documentation or inspection record of the installation and connection of the well pump, well water line and related plumbing in the referenced replacement well. If the well has been connected to the dwelling, it is suggested that you notify the licensed installer so that they may submit the appropriate documentation to this office. It is also suggested that you contact the Community Environmental Health Program at (410) 313-1773 to schedule an initial water sampling for the referenced replacement well, as required by the Maryland Well Construction Regulations (COMAR 26.04.04). **Currently, there is no charge for this sampling.**

It is preferred that the sample be collected from the primary indoor drinking tap, but if suitable scheduling is not possible, the sample may be taken from an outside tap to complete your sampling obligation. However, the potential for unsuccessful sample results increases when samples are collected from taps exposed to the outside environment.

If you have any questions, or would like to discuss these matters further please call me directly at (410) 313-2669. Thank you for your attention to these important matters.

Respectfully,

*Steven R. Krieg*  
Steven R. Krieg, Sanitarian  
Water and Sewerage Program

SRK

Enclosure

cc: Community Environmental Health Program  
File ✓

---

Bureau of Environmental Health

3525-H Ellicott Mills Drive • Ellicott City, Maryland 21043-4544

Water and Sewerage, Permits (410) 313-1771 Community Environmental Health Program (410) 313-1773  
(410) 313-2640 TDD(410) 313-2323 TOLL FREE - 1-877-4MD-DHMH



---

## HOWARD COUNTY HEALTH DEPARTMENT

---

*Joyce M. Boyd, M.D., County Health Officer*

*June 19, 1998*

Mr. Earl Crane  
1150 Underwood Road  
Sykesville, MD 21784

RE: Replacement Well Locations  
1150 Underwood Road  
Gerber Knoll, Lot 3

Dear Mr. Crane:

This is to advise you that the permit for a replacement well to be drilled at the above referenced address has been issued to Joseph Mayne Well Drilling.

This is also to advise you that an alternate well location was suggested at the site inspection on June 16, 1998 due to concerns about the limited area for septic system repairs. Wells should be located at least one hundred feet from any existing septic systems and future repair areas. Although the requested well site meets this standard with respect to the existing septic system, the one hundred foot setback severely limits areas available for septic repairs. The alternate well site sixty feet closer to the front of the lot makes significantly more lot area available for future septic system repairs.

This may be critical because the topography and terrain suggest that soil conditions suitable for septic systems are very limited on this lot. These soil conditions increase the potential that any future septic system repairs could be restricted to more expensive non-standard, non-gravity flow systems. Although nothing can be guaranteed, drilling the well at the alternate site increases the possibility that future septic system repairs would not be subject to this restriction, and conventional, gravity-flow repairs could be approved.

It is for these reasons that the alternate well site sixty feet closer to the front of the lot was suggested.

If you have any questions, please call me at (410) 313-2640.

Very truly yours,  
*Mark E. Rifkin*  
Mark E. Rifkin, R.S.  
Water and Sewerage Program

MR  
cc: Joseph Mayne  
File



OWNER: Crane, Earl E & WF

DATE REQUESTED: \_\_\_\_\_

ADDRESS: 1150 Underwood Rd

DRILLER: \_\_\_\_\_

Sykesville, MD 21784

WELL TAG # \_\_\_\_\_

COUNTY # \_\_\_\_\_

DISPOSAL: Replacement Well, low quantity

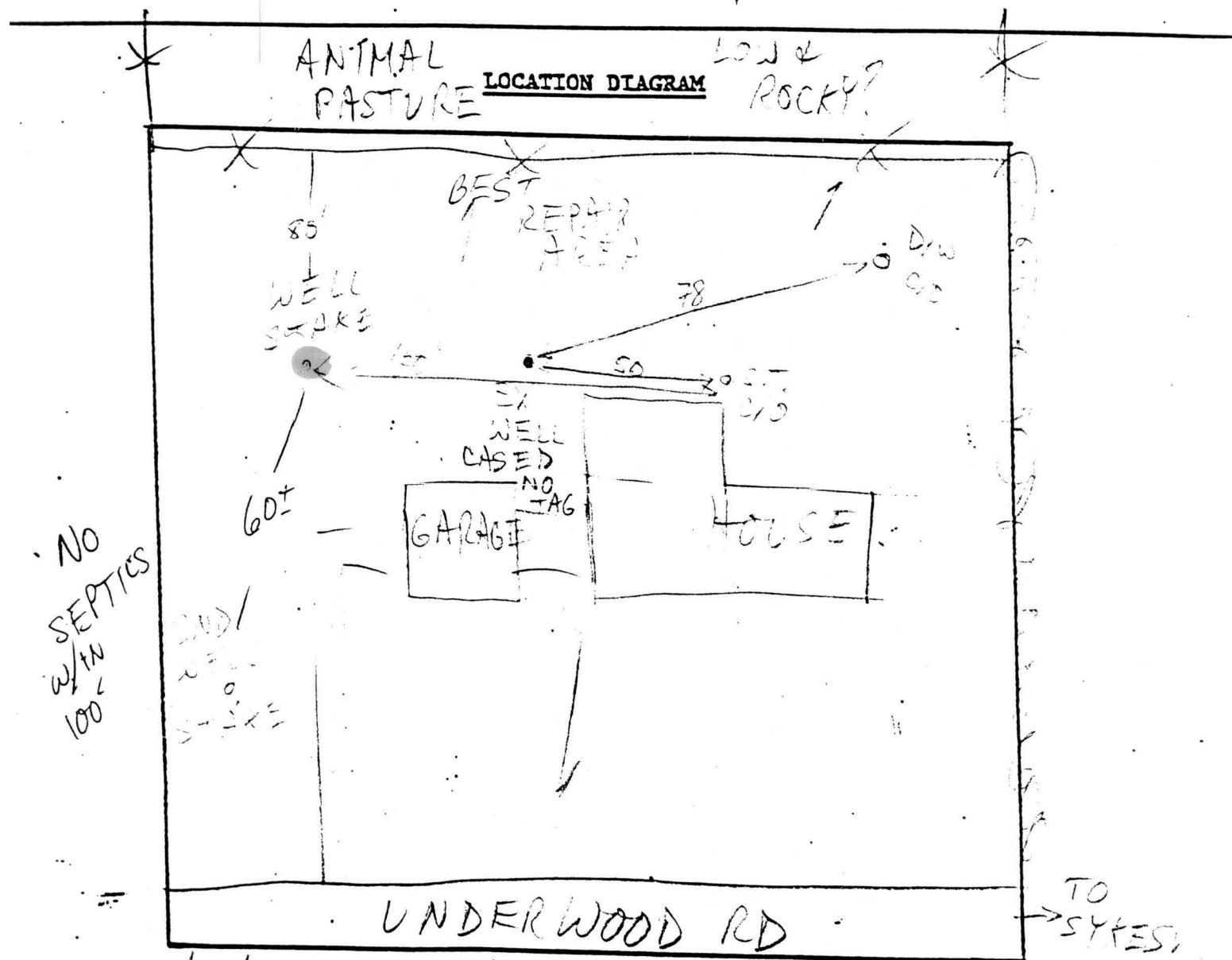

COMMENTS: 6/16/98 Well site technically OK but several restrictions already limited - septic repair area advised well-driller to suggest and site as shown to homeowner for max septic repair options. (MR)

DATE: \_\_\_\_\_ INSPECTOR: \_\_\_\_\_

OWNER: Crane, Earl E & WF

DATE REQUESTED: \_\_\_\_\_

ADDRESS: 1150 Underwood Rd

DRILLER: \_\_\_\_\_

Sykesville, MD 21784

WELL TAG # \_\_\_\_\_

COUNTY # \_\_\_\_\_

PROPOSAL: Replacement Well, low quantity

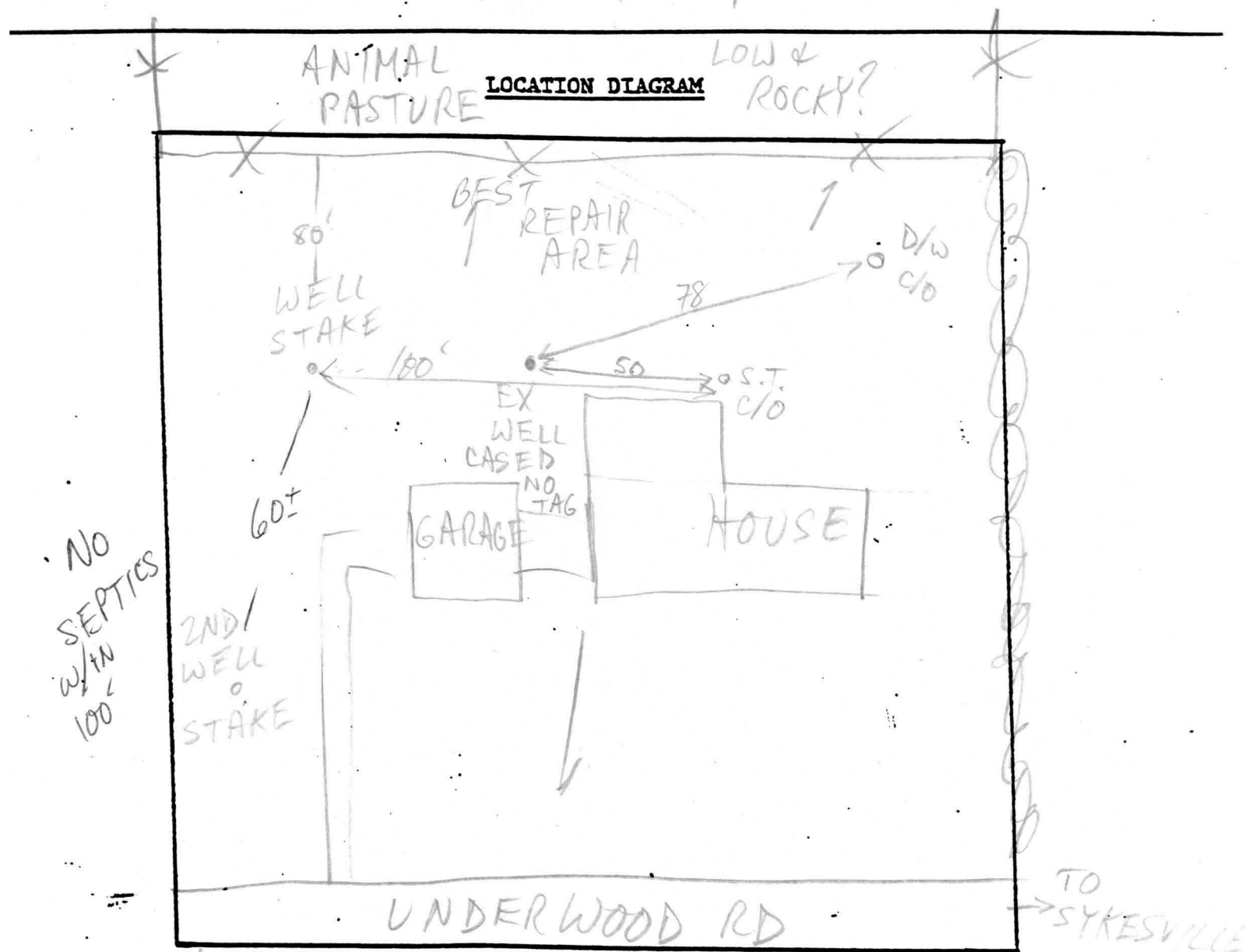

COMMENTS: 6/16/98 Well site technically OK, but severely restricts already limited septic repair area, advised well driller to suggest 2nd site as shown to homeowner for max septic repair options. (MR)

ATE: \_\_\_\_\_

INSPECTOR: \_\_\_\_\_

