

10/25/01 Follow Up 11:00

(443) 677-0627

ISSUE DATE: 9/6/01

APPROVAL DATE: 10/25/01

PERMIT INDEXED

P 516020

A REPAIR

ON-SITE SEWAGE DISPOSAL SYSTEM HOWARD COUNTY HEALTH DEPARTMENT BUREAU OF ENVIRONMENTAL HEALTH

04-334817

John Piorkowski Chuck Zepp

IS PERMITTED TO INSTALL ☐ ALTER ☒

ADDRESS: 587 W. Watersville Road 21771

PHONE NUMBER: 443-778-6372

SUBDIVISION:

LOT NUMBER:

ADDRESS: 587 W. Watersville Road

PROPERTY OWNER: John Piorkowski

SEPTIC TANK CAPACITY (GALLONS): 1500

PUMP CHAMBER CAPACITY (GALLONS): N/A

NUMBER OF BEDROOMS: 5 w/ADD'N

SQUARE FEET PER BEDROOM: 180

LINEAR FEET OF TRENCH REQUIRED: 130 + EX. D/W

TRENCHES:	Trench to be 2 feet wide. Inlet 1.5 feet below original grade. Bottom maximum depth 5.5 feet below original grade. Effective area begins at 3± feet below original grade. 4 feet of stone below distribution pipe.
LOCATION:	130' TRENCH DOWNHILL OF EX. D/W WITH 3/4" STONE ADD 5 1/2 - 6' SAND TO EX. D/W; 3/4" STONE ON TOP
PURPOSE:	In support of building permit #B00131929 Call for inspection when ground is opened so sanitarian can recommend repair.

PLANS APPROVED:

DATE:

NOTE: PERMIT VOID AFTER 2 YEARS

NOTE: CONTRACTOR RESPONSIBLE FOR SCHEDULING A PRE-CONSTRUCTION INSPECTION FOR ALL INSTALLATIONS

NOTE: WATERTIGHT SEPTIC TANKS REQUIRED

NOTE: ALL PARTS OF SEPTIC SYSTEM SHALL BE 100 FEET FROM ANY WATER WELL

NOTE: MANHOLE RISERS REQUIRED ON ALL SEPTIC TANKS AND PUMP CHAMBERS

NEITHER THE HOWARD COUNTY COUNCIL NOR THE HEALTH DEPARTMENT IS
RESPONSIBLE FOR THE SUCCESSFUL OPERATION OF ANY SYSTEM
PERMITTEE RESPONSIBLE FOR OBTAINING FINAL APPROVAL ON THIS PERMIT
CALL 410-313-2640 FOR INSPECTION OF SEPTIC SYSTEM

P 516020

NOT TO SCALE

FILL
1t. org
tan sct 1m
25-30% frags
tan sct 1m
30-40% frags
↑ w/ depth
8-9'

40-73-1498
EX WELL

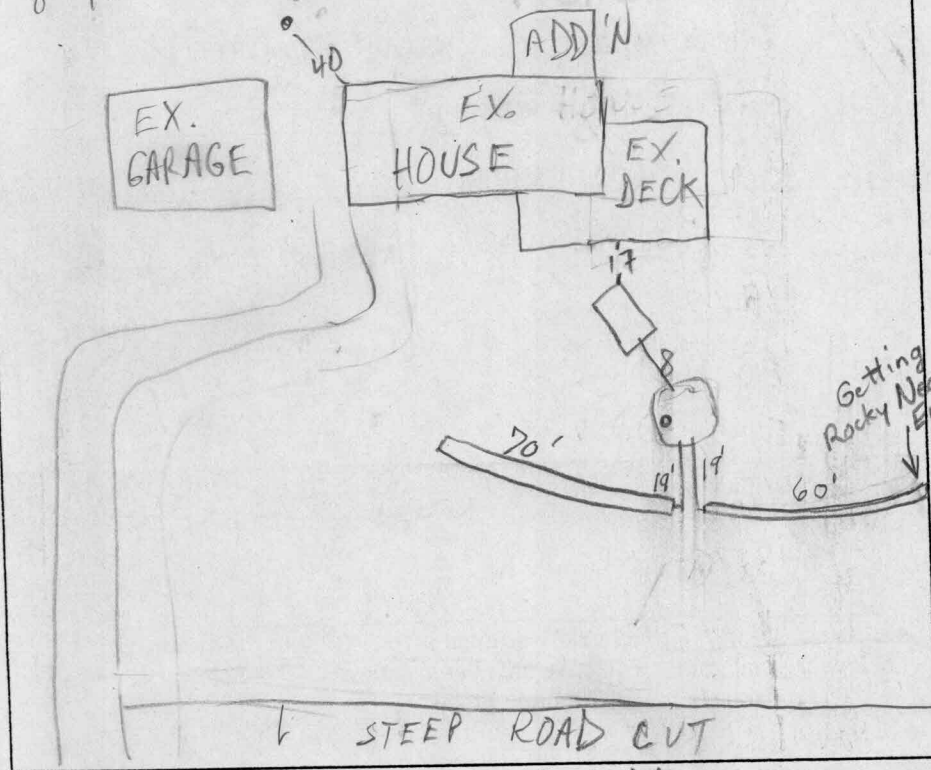

TRENCH DATA

TRENCH WIDTH 2'

TRENCH INLET DEPTH _____

TRENCH BOTTOM DEPTH _____

DEPTH OF STONE _____

NUMBER OF TRENCHES 2

TOTAL TRENCH LENGTH _____

ABSORBENT AREA _____

DISTRIBUTION BOX LEVEL N/A

BAFFLE IN DISTRIBUTION BOX N/A

SEPTIC TANK DATA

SEPTIC TANK Existing 1000 GALLONS

MANHOLE RISER _____

6 INCH INSPECTION PORT Yes

PUMP CHAMBER DATA

PUMP CHAMBER GALLONS _____

MANHOLE RISER _____

ALARM _____

PUMP PERFORMANCE TEST _____

PRE-CONSTRUCTION INSPECTION: 10/24/01 AM EX. D/W 100% DRY, TEST HOLE CONFIRMS
 ROCK SOLLS @ D/W VICINITY, OK TO START PER SPECS (MR)/KG

INSPECTION COMMENTS: 10/24/01 PM D/W OK TO COVER, CONTINUE (MR)

INSPECTOR

[Signature]

DATE SYSTEM APPROVED

10/25/01