

# APPLICATION

## PERCOLATION TESTING

A 58096

P \_\_\_\_\_

HOWARD COUNTY HEALTH DEPARTMENT  
BUREAU OF ENVIRONMENTAL HEALTH  
3525-H ELLICOTT MILLS DRIVE/ELLICOTT CITY, MARYLAND 21043  
TELEPHONE: 313-2640

PREVIOUS OK -  
PROPOSED RECONFIGURATION  
OF MULTIPLE PARCEL FARM  
THAT AS SUBDIVISION;  
POST-TEST REVIEW SHOULD  
INCLUDE CONSIDERATION  
OF PREVIOUS (1976?)  
TEST HISTORY ON THIS FARM (CW)

DISTRICT \_\_\_\_\_

DATE \_\_\_\_\_

TO: THE COUNTY HEALTH OFFICER  
ELLICOTT CITY, MARYLAND

I HEREBY APPLY FOR THE NECESSARY TEST PRIOR TO APPLICATION FOR PERMIT TO CONSTRUCT (OR RECONSTRUCT) A SEWAGE DISPOSAL SYSTEM.

PROPERTY OWNER D. Starn

ADDRESS West Waterville

PHONE \_\_\_\_\_

AGENT OR PROSPECTIVE BUYER C. Shamp

ADDRESS 3779 Shamp Rd Glenwood

PHONE 410 4894630

21738

PROPERTY LOCATION:

SUBDIVISION STIRN

LOT NO. (1)

ROAD AND DESCRIPTION Old Frederick Rd.

TAX MAP 2

PARCEL # 180

(Bpanel)

SIZE OF LOT 1.21 To 3 acs

TYPE BLDG. \_\_\_\_\_

(SINGLE FAMILY DWELLING OR COMMERCIAL)

THE SYSTEM INSTALLED UNDER THIS APPLICATION IS ACCEPTABLE ONLY UNTIL PUBLIC FACILITIES BECOME AVAILABLE. I FULLY UNDERSTAND THE FEE CONNECTED WITH THE FILING OF THIS PERC TEST APPLICATION IS NON-REFUNDABLE UNDER ANY CIRCUMSTANCES. I ALSO AGREE TO COMPLY WITH ALL M.O.S.H.A. REQUIREMENTS IN TESTING THIS LOT.

(SIGNATURE OF APPLICANT)

APPROVED BY \_\_\_\_\_

FOR \_\_\_\_\_

DATE \_\_\_\_\_

DISAPPROVED BY \_\_\_\_\_

FOR \_\_\_\_\_

DATE \_\_\_\_\_

HOLD PENDING FURTHER TESTS \_\_\_\_\_

REASONS FOR REJECTION OR HOLDING \_\_\_\_\_

PERCOLATION TEST PLAT/PRELIMINARY PLAT - TITLE OR I.D. # \_\_\_\_\_

DATE \_\_\_\_\_

SITE DEVELOPMENT PLAN/FINAL PLAT - TITLE OR I.D. # \_\_\_\_\_

DATE \_\_\_\_\_

# THIS IS NOT A PERMIT

580960

COUNTY #

## SOIL PROFILE

0' 1' topsoil  
red org  
brn  
cl 1m  
5' 14 org  
brn  
to tan  
si 1m  
12' 30%  
shale  
frag

②

0' 1' topsoil  
org brn  
cl 1m  
2' 14 org  
brn  
si 1m  
2.5' 25%  
frag

③

0' 1' topsoil  
org brn  
cl 1m  
14 org  
brn  
to beige  
si 1m  
20%  
frags

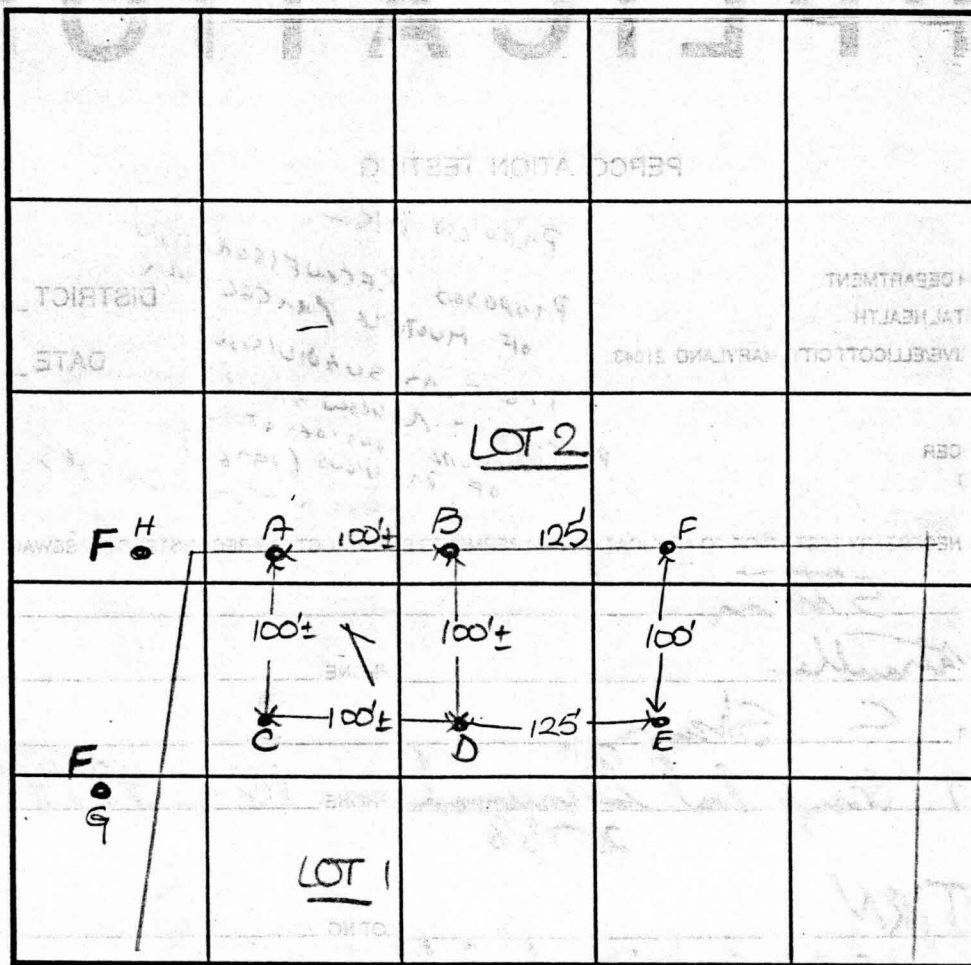

## SOIL PROFILE

0' 1' topsoil  
red org  
brn  
cl 1m  
3' 14 med red  
brn  
si 1m  
11.5' 20%  
frags

INDICATE NORTH - NAME ADJOINING ROADWAY AS BASE LINE.

West Waterville Road

DATE	TEST NO.	DEPTH	PRE-WET		TEST - 1" DROP		TIME
			START	STOP	START	STOP	
5-2-97	A	3' 4" S	10:40 <sub>3</sub>	10:41 <sub>3</sub>	10:41 <sub>3</sub>	10:43 <sub>3</sub>	2
		7.5' M	10:44	11:04	11:04	11:27	23
		12.0' D	Visual	OK			
	B	3' 4" S	10:52 <sub>3</sub>	10:53 <sub>3</sub>	10:53 <sub>3</sub>	10:55 <sub>3</sub>	~2
		10.0' D	Visual	OK			
	C	5.0' S	11:02	11:12	11:12	11:28	16
		12.5' D	Visual	OK			
	D	4' 2" S	10:57 <sub>3</sub>	10:59	10:59	11:01	2
		11.5' D	Visual	OK			

REMARKS

holes tested as staked

TYPE OF SOIL

TESTED BY

D. See

ALSO PRESENT

C. Sharp

TRENCH DESIGN DATA: AVERAGE PERCOLATION TIME

9

TRENCH WIDTH

3

INLET DEPTH

2.5

MAXIMUM BOTTOM DEPTH

4.5

SQ. FT./BEDROOM

210

# APPLICATION

PERCOLATION TESTING

A 58096

P \_\_\_\_\_

HOWARD COUNTY HEALTH DEPARTMENT  
BUREAU OF ENVIRONMENTAL HEALTH  
3525-H ELLICOTT MILLS DRIVE/ELLICOTT CITY, MARYLAND 21043  
TELEPHONE: 313-2640

PREVIEW OK -  
PROPOSED RECONFIGURATION  
OF MULTIPLE PARCEL FARM  
THAT AS SUBDIVISION;  
POST-TEST REVIEW SHOULD  
INCLUDE CONSIDERATION  
OF PREVIOUS (1976?)  
TEST HISTORY ON THIS FARM (CW)

DISTRICT \_\_\_\_\_

DATE \_\_\_\_\_

TO: THE COUNTY HEALTH OFFICER  
ELLICOTT CITY, MARYLAND

I HEREBY APPLY FOR THE NECESSARY TEST PRIOR TO APPLICATION FOR PERMIT TO CONSTRUCT (OR RECONSTRUCT) A SEWAGE DISPOSAL SYSTEM.

PROPERTY OWNER

D. Storn

ADDRESS

West Waterville

PHONE \_\_\_\_\_

AGENT OR PROSPECTIVE BUYER

C. Sharp

ADDRESS

3779 Sharp Rd Glenwood  
21738

PHONE

410 4894630

PROPERTY LOCATION:

SUBDIVISION

STIRN

LOT NO.

(1)

ROAD AND DESCRIPTION

Old Freeland Rd.

TAX MAP

2

PARCEL #

180

(Bpanel)

SIZE OF LOT

1.21 To 3 acs

TYPE BLDG.

(SINGLE FAMILY DWELLING OR COMMERCIAL)

THE SYSTEM INSTALLED UNDER THIS APPLICATION IS ACCEPTABLE ONLY UNTIL PUBLIC FACILITIES BECOME AVAILABLE. I FULLY UNDERSTAND THE FEE CONNECTED WITH THE FILING OF THIS PERC TEST APPLICATION IS NON-REFUNDABLE UNDER ANY CIRCUMSTANCES. I ALSO AGREE TO COMPLY WITH ALL M.O.S.H.A. REQUIREMENTS IN TESTING THIS LOT.

Charles C. Sharp

(SIGNATURE OF APPLICANT)

APPROVED BY \_\_\_\_\_

FOR \_\_\_\_\_

DATE \_\_\_\_\_

DISAPPROVED BY \_\_\_\_\_

FOR \_\_\_\_\_

DATE \_\_\_\_\_

HOLD PENDING FURTHER TESTS \_\_\_\_\_

REASONS FOR REJECTION OR HOLDING \_\_\_\_\_

PERCOLATION TEST PLAT/PRELIMINARY PLAT - TITLE OR I.D. # \_\_\_\_\_

DATE \_\_\_\_\_

SITE DEVELOPMENT PLAN/FINAL PLAT - TITLE OR I.D. # \_\_\_\_\_

DATE \_\_\_\_\_

## THIS IS NOT A PERMIT



58096

COUNTY #

SOIL PROFILE

(E)

0' topsoil  
 1' org brn  
 5' cl 1m  
 3' pale  
 org brn  
 to 14  
 8' org wh  
 si sa 1m  
 5' Rx patch  
 15-20%  
 Rx  
 5'

(F)

0' topsoil  
 1' org brn  
 5' cl 1m  
 3' pale  
 org brn  
 si sa  
 1m  
 5' >50%  
 Rx  
 11'

G/H

0' topsoil  
 1' org red  
 brn  
 cl 1m  
 5' pale org  
 brn  
 si sa 1m  
 >50%  
 Rx

SOIL PROFILE

0'

0' topsoil  
 1' org brn  
 5' cl 1m  
 3' pale  
 org brn  
 to 14  
 8' org wh  
 si sa 1m  
 5' Rx patch  
 15-20%  
 Rx  
 5'

INDICATE NORTH - NAME ADJOINING ROADWAY AS BASE LINE.

DATE	TEST NO.	DEPTH	PRE-WET		TEST - 1" DROP		TIME
			START	STOP	START	STOP	
6-4-97	E	4.0'S	10:58 <sub>3</sub>	11:00	11:00	11:03	3
		11.5'D	Visual	OK			
	F	3.5'S	11:07 <sub>3</sub>	11:09	11:09	11:11	2
		11.0'D	Visual	OK			
	G	10'8"D	Insuff depth to bedrock				F
	H	10.0'D	"	"	"	"	F

REMARKS

TYPE OF SOIL

TESTED BY

D. Soc

ALSO PRESENT

C Sharp

TRENCH DESIGN DATA: AVERAGE PERCOLATION TIME

TRENCH WIDTH

INLET DEPTH

MAXIMUM BOTTOM DEPTH

SQ. FT./BEDROOM

# APPLICATION

PERCOLATION TESTING

A 58096

HOWARD COUNTY HEALTH DEPARTMENT  
BUREAU OF ENVIRONMENTAL HEALTH  
3525-H ELLICOTT MILLS DRIVE/ELLICOTT CITY, MARYLAND 21043  
TELEPHONE: 313-2640

PREVIEW OK -  
PROPOSED RECONFIGURATION  
OF MULTIPLE PARCEL FARM  
THAT AS SUBDIVISION;  
POST-TEST REVIEW SHOULD  
INCLUDE CONSIDERATION  
OF PREVIOUS (1976?)  
TEST HISTORY ON THIS FARM (CW)

DISTRICT \_\_\_\_\_

DATE \_\_\_\_\_

TO: THE COUNTY HEALTH OFFICER  
ELLICOTT CITY, MARYLAND

I HEREBY APPLY FOR THE NECESSARY TEST PRIOR TO APPLICATION FOR PERMIT TO CONSTRUCT (OR RECONSTRUCT) A SEWAGE DISPOSAL SYSTEM.

PROPERTY OWNER D. Storn

ADDRESS West Waterville PHONE \_\_\_\_\_

AGENT OR PROSPECTIVE BUYER C. Sharp

ADDRESS 3779 Sharp Rd Glenwood PHONE 410 4894630  
21738

PROPERTY LOCATION:

SUBDIVISION STIRN

LOT NO. (2)

ROAD AND DESCRIPTION Old Frederick Rd.

TAX MAP 2 PARCEL # 180 (AB parcel)

SIZE OF LOT 1.21 to 3 acs

TYPE BLDG. \_\_\_\_\_

(SINGLE FAMILY DWELLING OR COMMERCIAL)

THE SYSTEM INSTALLED UNDER THIS APPLICATION IS ACCEPTABLE ONLY UNTIL PUBLIC FACILITIES BECOME AVAILABLE. I FULLY UNDERSTAND THE FEE CONNECTED WITH THE FILING OF THIS PERC TEST APPLICATION IS NON-REFUNDABLE UNDER ANY CIRCUMSTANCES. I ALSO AGREE TO COMPLY WITH ALL M.O.S.H.A. REQUIREMENTS IN TESTING THIS LOT.

(SIGNATURE OF APPLICANT)

APPROVED BY \_\_\_\_\_

FOR \_\_\_\_\_

DATE \_\_\_\_\_

DISAPPROVED BY \_\_\_\_\_

FOR \_\_\_\_\_

DATE \_\_\_\_\_

HOLD PENDING FURTHER TESTS \_\_\_\_\_

REASONS FOR REJECTION OR HOLDING \_\_\_\_\_

PERCOLATION TEST PLAT/PRELIMINARY PLAT - TITLE OR I.D. # \_\_\_\_\_

DATE \_\_\_\_\_

SITE DEVELOPMENT PLAN/FINAL PLAT - TITLE OR I.D. # \_\_\_\_\_

DATE \_\_\_\_\_

## THIS IS NOT A PERMIT

58096

COUNTY #

## SOIL PROFILE

0' (C)  
 1' topsoil  
 org red  
 brn  
 cl 1m  
 3'  
 org brn  
 si 1m  
 w/  
 >50%  
 shale  
 frags

0' (D)  
 1' topsoil  
 org brn  
 cl 1m  
 3'  
 red brn  
 to  
 14 org  
 brn  
 si 1m  
 25%  
 shale  
 frags

0' (E)  
 1' topsoil  
 red org  
 brn  
 cl 1m  
 2.5'  
 14 org  
 brn  
 si 1m

3' >50%  
 frags

## SOIL PROFILE

0' G  
 1' topsoil  
 red org  
 brn  
 cl 1m  
 2'  
 pale  
 org brn  
 si 3/4 1m  
 9.5'  
 >50%  
 Rx  
 10'

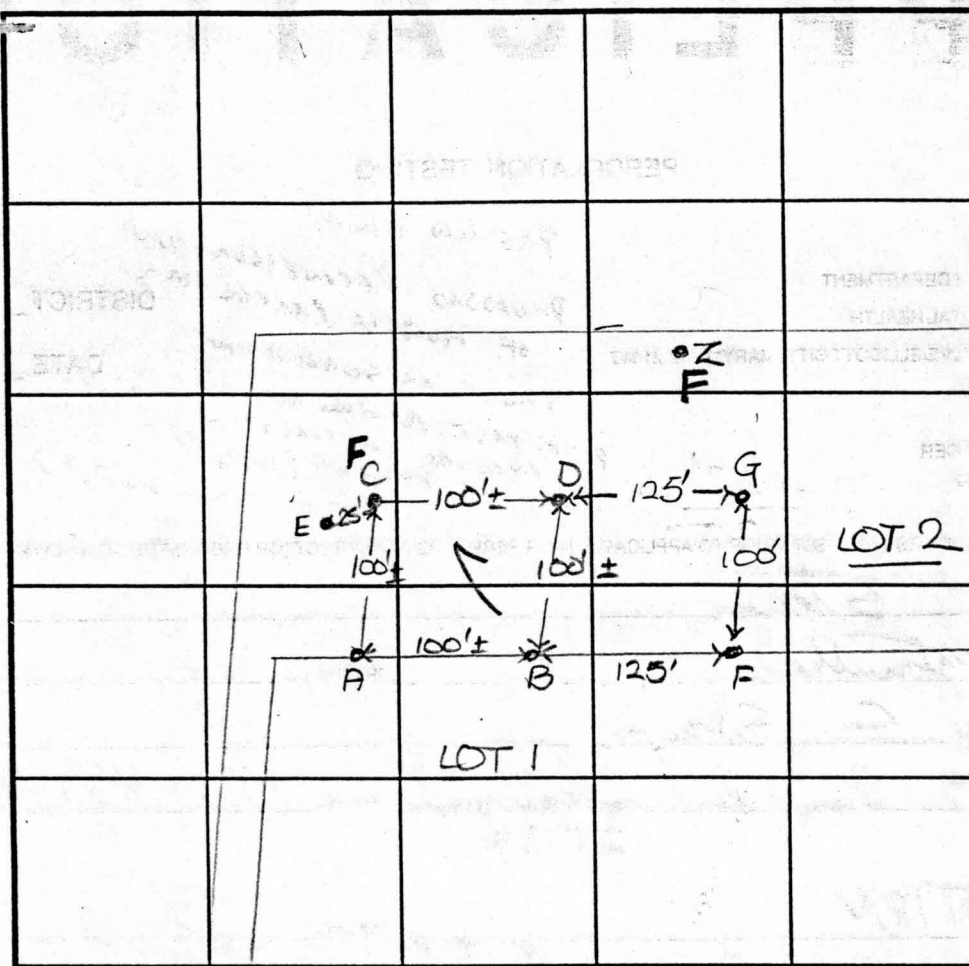

INDICATE NORTH - NAME ADJOINING ROADWAY AS BASE LINE.

West Waterville Road

DATE	TEST NO.	DEPTH	PRE-WET		TEST - 1" DROP		TIME
			START	STOP	START	STOP	
5-2-97	C	3'8"S	11:14 <sub>3</sub>	11:19	11:19	11:27	8
		11.0'D	See profile				
	D	3'2"S	11:31	11:35 <sub>3</sub>	11:35 <sub>3</sub>	11:44	9
		10.0'D	Visual OK				
	E	2.5'S	11:20	11:21	11:21	11:23	2
		10.0'D	Visual OK				
	Z	7.0'D	Refusal				F
6-4-97	G	3.0'S	11:13	11:15	11:15	11:18	3
		10.0'D	Visual OK				

REMARKS

holes tested as staked

TYPE OF SOIL

TESTED BY

D. Soe

ALSO PRESENT

C. Sharp

TRENCH DESIGN DATA: AVERAGE PERCOLATION TIME

5

TRENCH WIDTH

3'

INLET DEPTH

2.0

MAXIMUM BOTTOM DEPTH

4.0

SQ. FT./BEDROOM

180



DENISE DOERER SHARP  
 Liber 4252 Folio 338  
 2,221,560 sq. ft.  
 or  
 51.0000 Acres ±

