

# APPLICATION

PERCOLATION TESTING

A 58947L

P \_\_\_\_\_

HOWARD COUNTY HEALTH DEPARTMENT

BUREAU OF ENVIRONMENTAL HEALTH

3525-H ELLICOTT MILLS DRIVE/ELLICOTT CITY, MARYLAND 21043  
TELEPHONE: 313-2640

DISTRICT 04

DATE \_\_\_\_\_

TO: THE COUNTY HEALTH OFFICER  
ELLICOTT CITY, MARYLAND

I HEREBY APPLY FOR THE NECESSARY TEST PRIOR TO APPLICATION FOR PERMIT TO CONSTRUCT (OR RECONSTRUCT) A SEWAGE DISPOSAL SYSTEM.

PROPERTY OWNER Ray & JANE Cabbage

ADDRESS 14564 Dorsey Mill Rd Glenelg MD PHONE 410-451-7017

AGENT OR PROSPECTIVE BUYER Susquehanna LANDS <sup>21738</sup> Holding Co.

ADDRESS 1814 Hyman LN Crofton MD 21114 PHONE 410-451-3916

PROPERTY LOCATION:

SUBDIVISION Cabbage Sub LOT NO. 12 (9)

ROAD AND DESCRIPTION \_\_\_\_\_

TAX MAP 21 PARCEL # 31

SIZE OF LOT 1± AC. TYPE BLDG. SFD  
(SINGLE FAMILY DWELLING OR COMMERCIAL)

THE SYSTEM INSTALLED UNDER THIS APPLICATION IS ACCEPTABLE ONLY UNTIL PUBLIC FACILITIES BECOME AVAILABLE. I FULLY UNDERSTAND THE FEE CONNECTED WITH THE FILING OF THIS PERC TEST APPLICATION IS NON-REFUNDABLE UNDER ANY CIRCUMSTANCES. I ALSO AGREE TO COMPLY WITH ALL M.O.S.H.A. REQUIREMENTS IN TESTING THIS LOT.

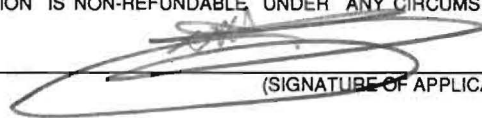

(SIGNATURE OF APPLICANT)

APPROVED BY \_\_\_\_\_ FOR \_\_\_\_\_ DATE \_\_\_\_\_

DISAPPROVED BY \_\_\_\_\_ FOR \_\_\_\_\_ DATE \_\_\_\_\_

HOLD PENDING FURTHER TESTS \_\_\_\_\_

REASONS FOR REJECTION OR HOLDING \_\_\_\_\_

PERCOLATION TEST PLAT/PRELIMINARY PLAT - TITLE OR I.D. # \_\_\_\_\_ DATE \_\_\_\_\_

SITE DEVELOPMENT PLAN/FINAL PLAT - TITLE OR I.D. # \_\_\_\_\_ DATE \_\_\_\_\_

## THIS IS NOT A PERMIT

58947 L

COUNTY #

## SOIL PROFILE

0'	12A
3.5'	or/br clay loam
7.0'	lt tan/ orange Silty Sand loam
10.5'	rock outcrop 20% ↓

12B

3.0'	or/br clay loam
7.0'	20% rock outcrop
10.0'	tan/pink powdery silt loam

12C

2.0'	red/or clay loam
11.5'	lt tan/ pink powdery silt loam 15% shale frags

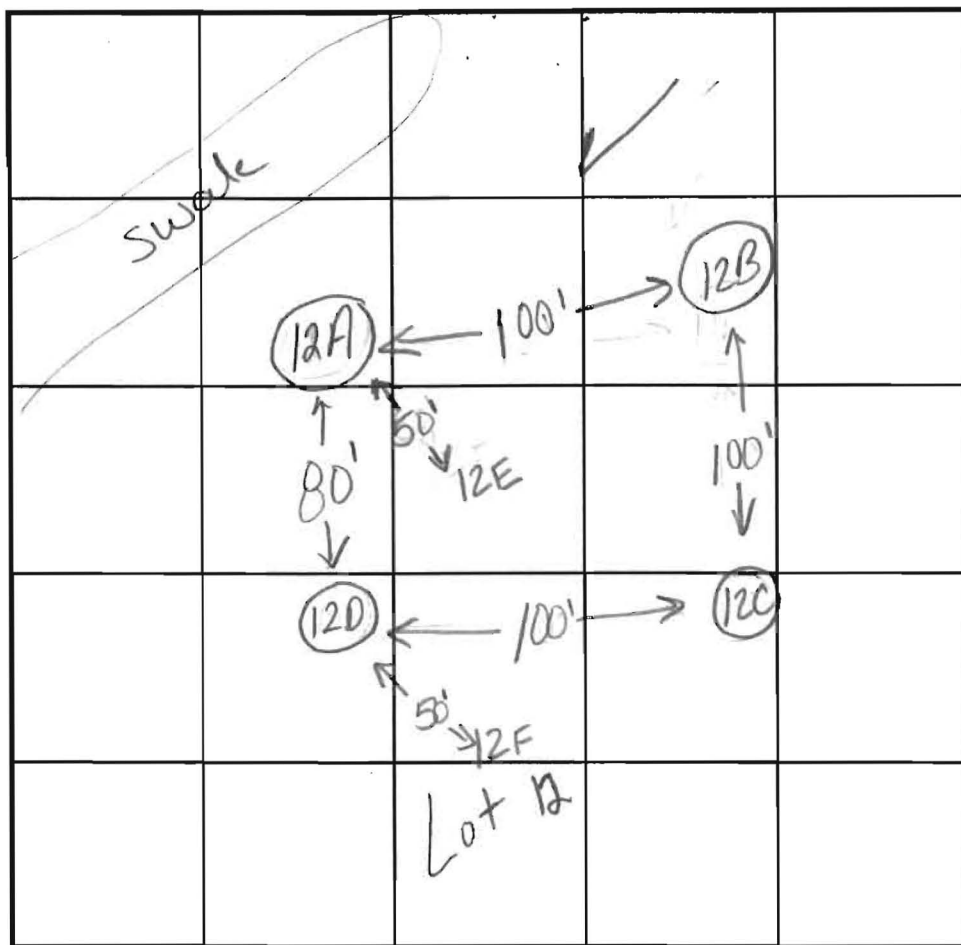

INDICATE NORTH - NAME ADJOINING ROADWAY AS BASE LINE.

## SOIL PROFILE

0'	12D
2.5'	or/br clay loam
12.0'	lt tan/ pink powdery silt loam 10% shale frags
11.0'	12E + 12F or/br clim br/or silt 10-15% rx frags

DATE	TEST NO.	DEPTH	PRE-WET		TEST - 1" DROP		TIME
			START	STOP	START	STOP	
10-6-97	12A	4.0'S	10:48	10:51	10:51	10:58	630
		10.5'D	Visual	ok	see profile		
	12B	3.0'S	11:10	11:11	11:11	11:13	2min
		10.0'D	Visual	ok	see profile		
	12C	2.5'S	11:03	11:05	11:05	11:08	3min
		6.0'S	11:03	11:05	11:05	11:08	3min
		11.5'D	Visual	ok	see profile		
	12D	12.0'D	Visual	ok	see profile		
4-28-98	12F	11.0'D	Visual	ok	see profile		
4-28-98	12E	3.0'S / 11.0'D	10:45	10:52	10:52	11:04	12min

REMARKS test holes staked

TYPE OF SOIL

TESTED BY

Kim Maiste / Amy McMillon

ALSO PRESENT

Hugo + Jeff Allen

TRENCH DESIGN DATA: AVERAGE PERCOLATION TIME

34 minutes

TRENCH WIDTH

3

INLET DEPTH

3

MAXIMUM BOTTOM DEPTH

5

SQ. FT./BEDROOM

180



## WINDRIDGE PERC HOLES

Lot 9 – 2D, 2G, 3A, 3B, 3D, 3E

Lot 10 – 4A, 4B, 4C, 4C2, 4D, 4D2, 4F

Lot 11 – 5A, 5B, 5B2, 5C, 5E, 6D

Lot 12 – 6B, 6C, 6G, 6F, ?, 7G

Lot 13 – 6F, ?, 7B, 7D, 7E, 7F, 7G, ?, 7I, 7H

Lot 14 – 8A, 8B, 8B2, 8C, ?, ?, ?, 8D

Lot 15 – 8B, 8B2, 8C, ?, ?, 9C, 9D, 10A

Lot 16 – 10A, ?, 10B/11A, ?, 10C/11D, 10E, 11B

Lot 17 – 10B/11A, ?, 11B, 11C, 12F, 14D, 15D/14C

Lot 18 – 12C, 13A, 13D, 14A, 14D

Lot 19 – 14A, 14B, 15D/14C, 14D

Lot 20 – 14B, 15D/14C, 15A, 15B, 16D/15C

Lot 21 – 15A, 15B, 16A, 16D/15C, 16B, 16C, 16E

Lot 22 – 19A, 19B, 19C, 19D, 19E

Lot 23 – 19B, 19C, 20A, 20B, 20C, 20D

Lot 24 – 20D, 20F, 20G, 21A

Lot 25 – 21A, 21B, 21C, 21D, 21E, 21F