

9/27/77 Checked with D.W.M.
9/15/78 Partially
PERMIT

SEWAGE DISPOSAL SYSTEM

MARYLAND STATE DEPARTMENT OF HEALTH*

HOWARD COUNTY

ELLICOTT CITY

DISTRICT 3rd

DATE

INDEXED

Pat Lendrim

IS PERMITTED TO INSTALL ☒ ALTER

ADDRESS 14010 Forsythe Road, Sykesville, Md. 21784

PHONE 442-2416

SUBDIVISION (Berndell Estates)

ROAD 875 Winderiver Road

LOT 11

PROPERTY OWNER Kenneth Strauss

ADDRESS 43 Peble Drive, Baltimore, Maryland 21225

Phone: 789-4500

SPECIFICATIONS 4 bedrooms

SEPTIC TANK CAPACITY 1250 GALLONS

DRAIN FIELD DEPTH FEET, BOTTOM AREA SQ. FT.

DEEP TRENCH DEPTH FEET, BOTTOM AREA SQ. FT.

SEEPAGE PITS ABSORBENT SIDE-WALL AREA SQ. FT.

INLET PIPE FT. BELOW ORIGINAL GRADE, MAXIMUM DEPTH FT. BELOW ORIGINAL GRADE

EFFECTIVE DEPTH AT FT. BELOW ORIGINAL GRADE.

LOCATE DISPOSAL AREA FT. FROM LOT LINE AND FT. FROM LOT LINE AS SEEN WHEN

FACING LOT FROM

DRY WELL AND TRENCH - System to have 200 sq. ft. effective sidewall absorption area per bedroom to begin below the first 4 ft. of non-porous soil. Maximum depth permitted for dry well or trench is 10 ft. below original grade. Place the dry well 175 ft. from the 1147 ft. long lot line and 120 ft. from the 488 ft. long lot line. Start the first trench after a 5 ft. earth buffer with the dry well and proceed to dig it on level ground. Start the second trench parallel to the first trench and 14 ft. away from the first trench.

NOTE: TRENCHES NOT TO BE CONNECTED IN SERIES. MUST USE DISTRIBUTION BOX OR T'S AND CONNECT TO END NEAREST SEPTIC TANK. NO TRENCH IS TO EXCEED 100 FEET IN LENGTH.

PLANS APPROVED BY Robert T. Moorefield & Frank Skinner

DATE 2/16/77 & 12/14/77

COVER NO WORK UNTIL INSPECTED AND APPROVED.

NEITHER THE HOWARD COUNTY COUNCIL NOR THE HEALTH DEPARTMENT IS RESPONSIBLE FOR THE SUCCESSFUL OPERATION OF ANY SYSTEM.

NOTE: IF TRENCH IS USED CALL FOR INSPECTION BEFORE PLACING GRAVEL IN TRENCH.

NOTE: NO DRY WELL SHALL EXCEED 16 FOOT IN DIAMETER.

NOTE: ALL PIPE FROM HOUSE TO DISPOSAL AREA MUST BE CAST IRON.

PERMIT VOID AFTER THREE YEARS.

NOTE: INSTALL STAND PIPE ON SEPTIC TANK AND DRY WELL. STAND PIPES MUST BE 6 INCHES IN DIAMETER. CAST IRON, CONCRETE OR TERRAZO ACCEPTED.

*INSTALLER IS RESPONSIBLE FOR OBTAINING FINAL APPROVAL ON THIS PERMIT.

HD - 23

BLDG. PERMIT SIGNED
AND RETURNED 4/9/84

Serial # 58326 P.H.

BLDG. PERMIT SIGNED
AND RETURNED 10/9/85

Serial # 67307 family home + patio

Bldg Permit OK
4/9/84 JS

43
11
60

(W)

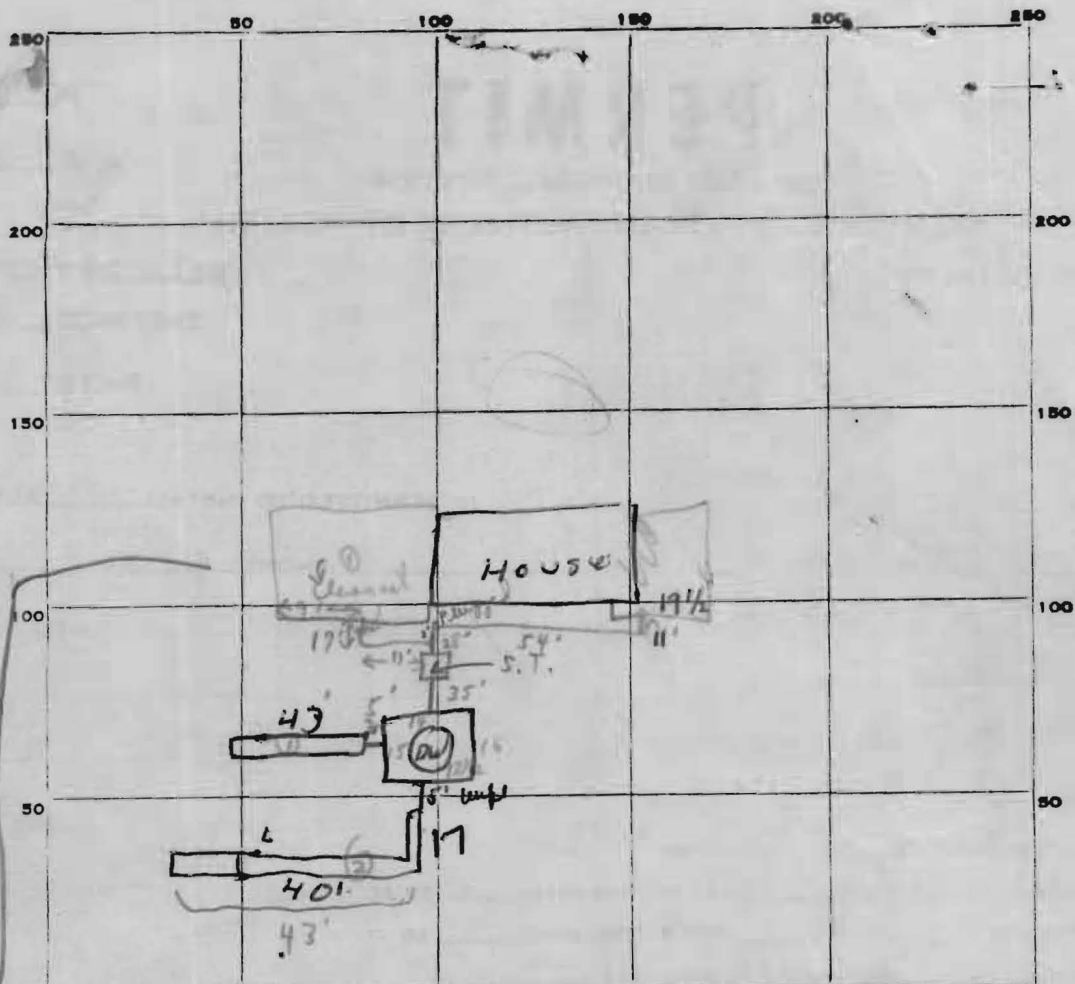

INDICATE NORTH. - NAME ADJOINING ROADWAY AS BASE LINE.

PERMIT CARD Yes

SEPTIC TANK, LEVEL ok

CLEANOUTS S.T. | D.W.
ok | ok
C.I. | C.I.

DISTRIBUTION BOX, LEVEL N/A

Trench ? ask D.W.M.

TILE FIELD, DEPTH 4' 6" FT. TRENCH WIDTH — FT.

GRAVEL DEPTH 4' 6" FT. TOTAL LENGTH 103 FT. (1) 618 $\frac{10\frac{1}{2}}{5}$

NUMBER OF TRENCHES 2 TOTAL BOTTOM AREA —

SEEPAGE PITS, INSIDE DIAMETER 58 1/2" FT. DEPTH BELOW INLET 5.5 FT. (2) 321

ABSORBENT AREA 939 ± SQ. FT.

REMARKS 1. Make trench nearest rd. 40' long. - ok to fill in trench. D ←

26 Sept '78. Hold for D.W.M. on depth of trench

Shovel in to 4 1/4" to 5' of surface on #1 with paper on

" " to 4' " " " #2 " " "

Shovel ok to 2nd system

DATE SYSTEM APPROVED 26 Sept. 78 INSPECTOR C.B. Stricker