

LAYOUT \_\_\_\_\_  
INSP 1 \_\_\_\_\_ INSP 3 \_\_\_\_\_  
INSP 2 \_\_\_\_\_ INSP 5 \_\_\_\_\_

ISSUE DATE: 9/8/2005

APPROVAL  
DATE:

11/21/2009

**PERMIT**  
**SHARED SEPTIC SYSTEM**  
**INDEXED**

P 523287

A

515236-A

**HOUSE SEWER LINE CONNECTION**

**HOWARD COUNTY HEALTH DEPARTMENT**  
**BUREAU OF ENVIRONMENTAL HEALTH**

NVR Inc. IS PERMITTED TO INSTALL  ALTER

ADDRESS: 6085 Marshalee Drive, Suite 130 PHONE NUMBER: 410-379-5956

SUBDIVISION Homeland LOT NUMBER: 11

ADDRESS: 12039 Windsor Moss PROPERTY OWNER: NVR Inc.

NUMBER OF BEDROOMS: 2 Was approved for only 2 bedrooms

**HOUSE SERVED BY PUBLIC WATER? YES**

LOCATION:	Install 4" house sewer line connection per the approved site plan.
NOTES:	This permit is limited to the installation of the individual house sewer line connection and installation of the grinder pump, if applicable. The Howard County Bureau of Utilities must be contacted for scheduling of inspection of these items, as well at 410-313-4900.

PLANS APPROVED: \_\_\_\_\_ DATE: \_\_\_\_\_

**PERMIT VOID AFTER 2 YEARS**

1. CONTRACTOR IS RESPONSIBLE FOR SCHEDULING A PRE-CONSTRUCTION INSPECTION FOR ALL INSTALLATIONS.
2. ALL PARTS OF SEPTIC SYSTEM SHALL BE 100 FEET FROM ANY WATER WELL UNLESS SPECIFICALLY AUTHORIZED.
3. MANHOLE RISERS REQUIRED ON ALL SEPTIC TANKS AND PUMP CHAMBERS UNLESS SPECIFICALLY AUTHORIZED.
4. CONTRACTOR RESPONSIBLE FOR COMPLIANCE WITH APPLICABLE REGULATIONS, GUIDELINES AND THE TERMS OF THIS PERMIT.
5. NEITHER THE HOWARD COUNTY COUNCIL OR THE HEALTH DEPARTMENT IS RESPONSIBLE FOR THE SUCCESSFUL OPERATION OF ANY SYSTEM.
6. PERMITTEE RESPONSIBLE FOR OBTAINING FINAL APPROVAL ON THIS PERMIT.

**CALL 410-313-1771 FOR INSPECTION HOUSE CONNECTION**

A 515236

NOT TO SCALE

TRENCH/DRAINFIELD DATA

WIDTH \_\_\_\_\_ INLET \_\_\_\_\_ BOTTOM \_\_\_\_\_

NUMBER OF TRENCHES \_\_\_\_\_

TOTAL LENGTH \_\_\_\_\_

ABSORPTION AREA \_\_\_\_\_

DISTRIBUTION BOX LEVEL \_\_\_\_\_

DISTRIBUTION BOX BAFFLE \_\_\_\_\_

DISTRIBUTION BOX PORT \_\_\_\_\_

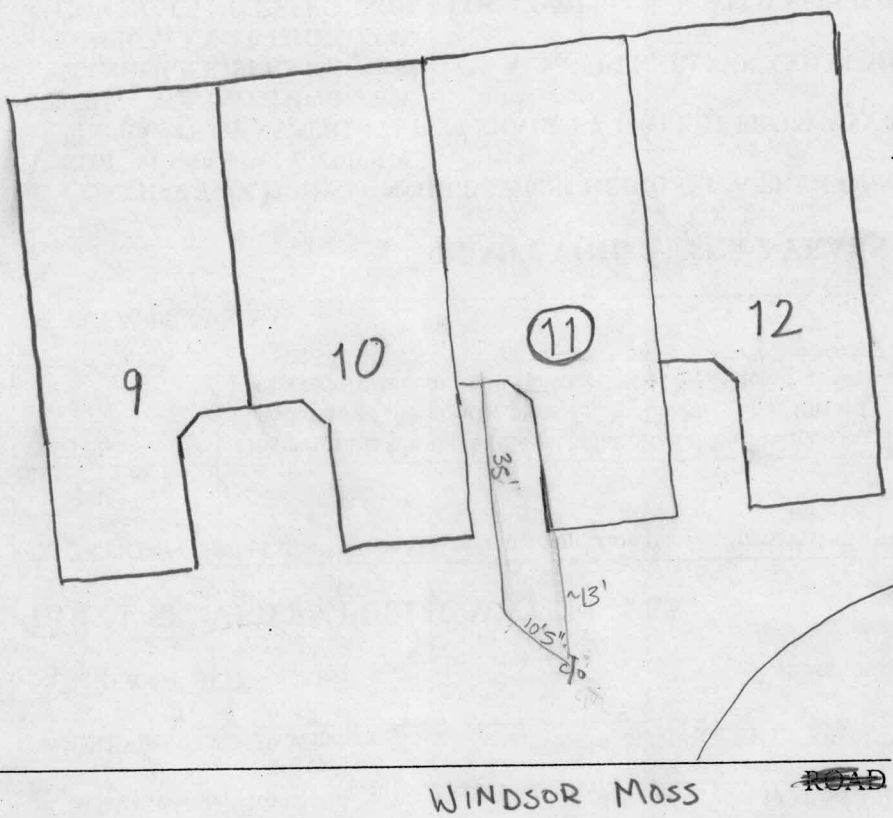

SEPTIC TANK DATA

SEPTIC TANK 1 LEVEL \_\_\_\_\_

CAPACITY \_\_\_\_\_ GAL

SEAM LOC \_\_\_\_\_

TANK LID DEPTH \_\_\_\_\_

BAFFLES \_\_\_\_\_

BAFFLE FILTER \_\_\_\_\_

MANHOLE LOC \_\_\_\_\_

6" PORT LOC \_\_\_\_\_

WATERTIGHT TEST \_\_\_\_\_

SEPTIC TANK 2 LEVEL \_\_\_\_\_

CAPACITY \_\_\_\_\_ GAL

SEAM LOC \_\_\_\_\_

TANK LID DEPTH \_\_\_\_\_

BAFFLES \_\_\_\_\_

BAFFLE FILTER \_\_\_\_\_

MANHOLE LOC \_\_\_\_\_

6" PORT LOC \_\_\_\_\_

WATERTIGHT TEST \_\_\_\_\_

PRE-CONSTRUCTION \_\_\_\_\_

INSTALLATION Sewer pipe installed - okay to cover. Depth to top of pipe from grade is ~12'. 11/21/05 (SF)

FINAL INSPECTOR

Heiril A. Cuyler

DATE OF APPROVAL

11/21/2005