

LAYOUT _____
INSP 1 _____ INSP 3 _____
INSP 2 _____ INSP 5 _____

ISSUE DATE: 9/8/2005

APPROVAL
DATE: 11/17/2005

PERMIT
SHARED SEPTIC SYSTEM
INDEXED

P 523287

A 515236-B

HOUSE SEWER LINE CONNECTION

HOWARD COUNTY HEALTH DEPARTMENT
BUREAU OF ENVIRONMENTAL HEALTH

NVR Inc. _____ IS PERMITTED TO INSTALL ALTER

ADDRESS: 6085 Marshalee Drive, Suite 130 PHONE NUMBER: 410-379-5956

SUBDIVISION Homeland LOT NUMBER: 12

ADDRESS: 12041 Windsor Moss PROPERTY OWNER: NVR Inc.

NUMBER OF BEDROOMS: 2 Was approved for only 2 bedrooms

HOUSE SERVED BY PUBLIC WATER? YES

LOCATION:	Install 4" house sewer line connection per the approved site plan.
NOTES:	This permit is limited to the installation of the individual house sewer line connection and installation of the grinder pump, if applicable. The Howard County Bureau of Utilities must be contacted for scheduling of inspection of these items, as well at 410-313-4900.

PLANS APPROVED: _____ DATE: _____

PERMIT VOID AFTER 2 YEARS

1. CONTRACTOR IS RESPONSIBLE FOR SCHEDULING A PRE-CONSTRUCTION INSPECTION FOR ALL INSTALLATIONS.
2. ALL PARTS OF SEPTIC SYSTEM SHALL BE 100 FEET FROM ANY WATER WELL UNLESS SPECIFICALLY AUTHORIZED.
3. MANHOLE RISERS REQUIRED ON ALL SEPTIC TANKS AND PUMP CHAMBERS UNLESS SPECIFICALLY AUTHORIZED.
4. CONTRACTOR RESPONSIBLE FOR COMPLIANCE WITH APPLICABLE REGULATIONS, GUIDELINES AND THE TERMS OF THIS PERMIT.
5. NEITHER THE HOWARD COUNTY COUNCIL OR THE HEALTH DEPARTMENT IS RESPONSIBLE FOR THE SUCCESSFUL OPERATION OF ANY SYSTEM.
6. PERMITTEE RESPONSIBLE FOR OBTAINING FINAL APPROVAL ON THIS PERMIT.

CALL 410-313-1771 FOR INSPECTION HOUSE CONNECTION

NOT TO SCALE

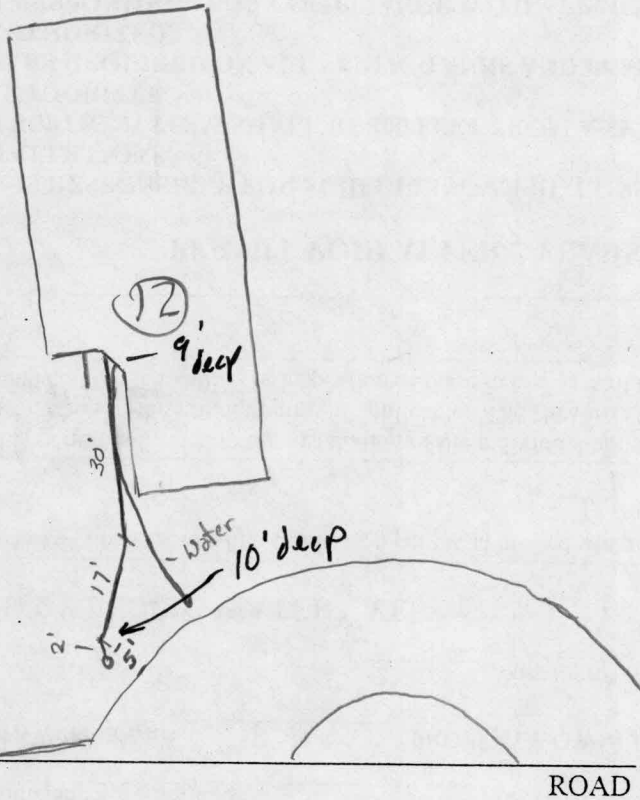

TRENCH/DRAINFIELD DATA

WIDTH	INLET	BOTTOM
_____	_____	_____
NUMBER OF TRENCHES _____		
TOTAL LENGTH _____		
ABSORPTION AREA _____		
DISTRIBUTION BOX LEVEL _____		
DISTRIBUTION BOX BAFFLE _____		
DISTRIBUTION BOX PORT _____		

SEPTIC TANK DATA

SEPTIC TANK 1 LEVEL _____

CAPACITY _____ GAL

SEAM LOC _____

TANK LID DEPTH _____

BAFFLES _____

BAFFLE FILTER _____

MANHOLE LOC _____

6" PORT LOC _____

WATERTIGHT TEST _____

SEPTIC TANK 2 LEVEL _____

CAPACITY _____ GAL

SEAM LOC _____

TANK LID DEPTH _____

BAFFLES _____

BAFFLE FILTER _____

MANHOLE LOC _____

6" PORT LOC _____

WATERTIGHT TEST _____

PRE-CONSTRUCTION House Connection for shared septic system.

INSTALLATION 11/17/2005 connection made ok. OK. to cover (GTC)

FINAL INSPECTOR Richard A. [Signature] DATE OF APPROVAL 11/17/2005

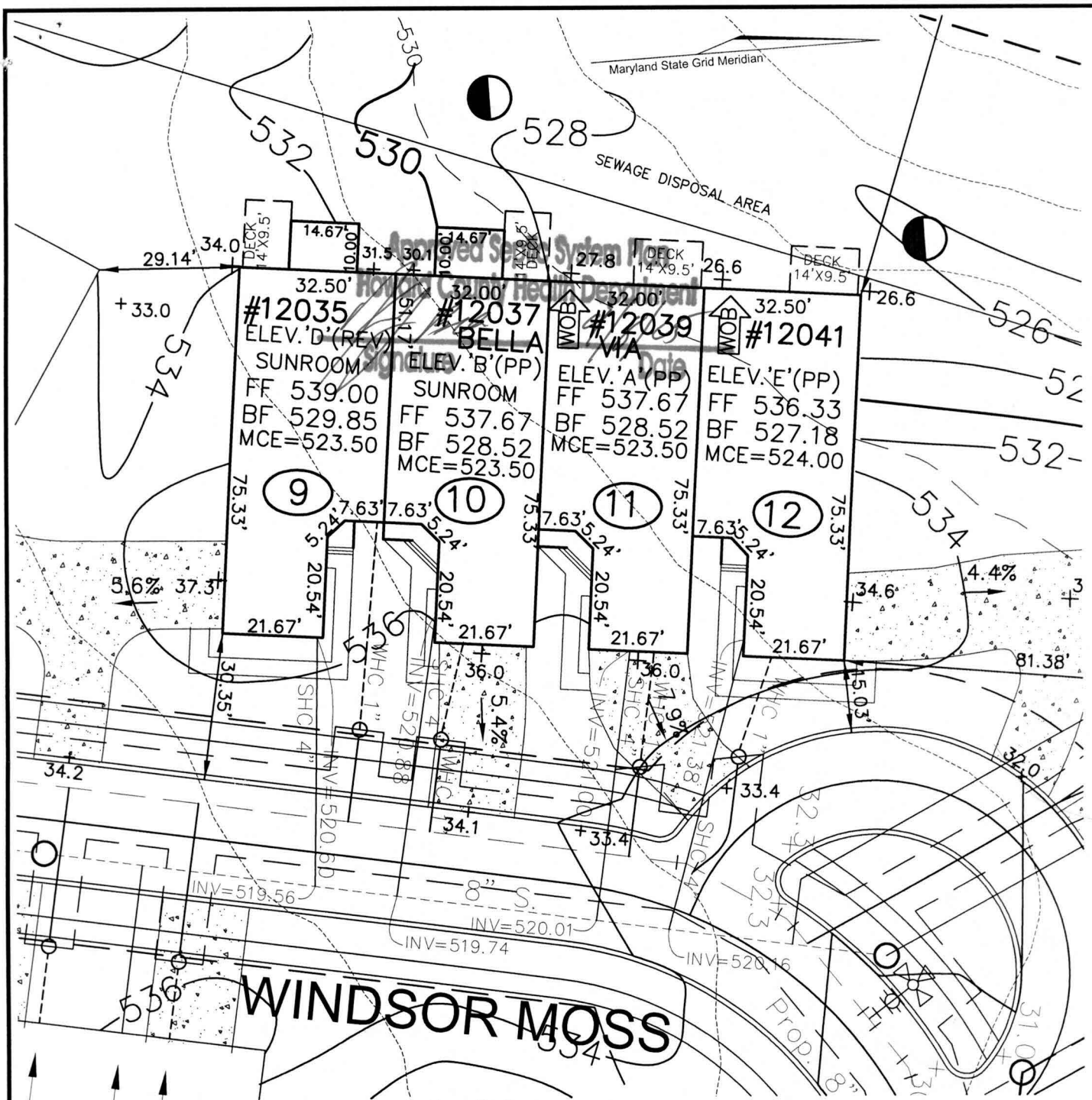

WINDSOR MOSS

VE ROBERT H. VOGEL ENGINEERING, INC.
 ENGINEERS • SURVEYORS • PLANNERS
 8407 MAIN STREET TEL: 410.461.7666
 ELLICOTT CITY, MD 21043 FAX: 410.461.8961

SCALE 1"=50'
 DRAWN BY JCO
 CHECKED BY RHV
 DATE AUGUST, 2005
 W. O. # 04-87.00
 SHEET# 1 OF 1

**NV HOMES
 ELLICOTT MEADOWS
 UNITS 9-12**

HOMELAND SDP-03-30
 TAX MAP 16
 3RD ELECTION DISTRICT

PARCEL 53,96,165&204
 HOWARD COUNTY, MARYLAND

ROBERT H. VOGEL ENGINEERING, INC.
ENGINEERS • SURVEYORS • PLANNERS

September 1, 2005

Mr. Kevin Bell
Howard County Health Department
7178 Columbia Gateway Drive
Columbia, MD 21046

Re: Homeland, Unit 12
SDP-03-30

Dear Mr. Bell,

On behalf of the builder, NV Homes, we would like to request a 6' waiver for the deck encroachment into the sewage disposal. Be advised that the deck does not have a foundation.

Should you have any questions or concerns please contact this office.

Sincerely,

ROBERT H. VOGEL ENGINEERING, INC.

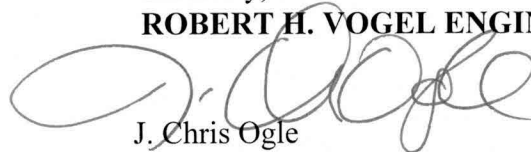

J. Chris Ogle
Project Manager

cc: NV Homes



HOWARD COUNTY HEALTH DEPARTMENT

Bureau of Environmental Health
7178 Columbia Gateway Drive, Columbia MD 21046
(410) 313-2640 FAX (410) 313-2648
TDD (410) 313-2323 Toll Free 1-877-4MD-DHMH

Penny E. Borenstein, M.D., M.P.H., County Health Officer

12/29/2005

NVR Inc. t/a Ryan Homes
6085 Marshalee Drive, Suite 140
Elkridge, Maryland 21075

SENT VIA FACSIMILE 410-796-7094 & 410-379-2430 & 410-531-9681

RE: Homeland, Lot 12
12041 Windsor Moss
Ellicott City, MD 21043
BP # B00155493
PUBLIC WATER

Dear Sirs or Madam:

This is to advise that the connection from the house to the street has been installed and inspected for the referenced property. A Community Septic System serves this dwelling. **Final approval was granted on 11/17/2005 by HCHD for the house connection.**

The property is served by public water and is therefore exempt from the Health Department water sampling requirements.

By issuance of this letter, this office recommends release of the Use and Occupancy permit for the referenced property.

RECOMMENDATION FOR USE AND OCCUPANCY

Respectfully,

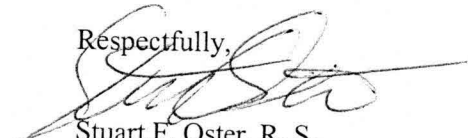

Stuart F. Oster, R. S.
Well and Septic Program

cc: DILP, Building Inspectors Office
File

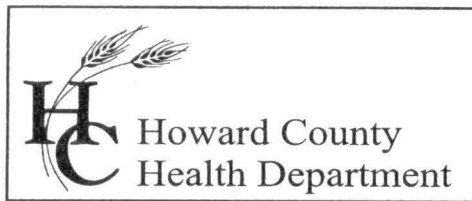

7178 Columbia Gateway Drive, Columbia, MD 21046
(410) 313-2640 Fax (410) 313-2648
TDD (410) 313-2323 Toll Free 1-866-313-6300
website: www.hchealth.org

Penny E. Borenstein, M.D., M.P.H., Health Officer

September 8, 2005

Chris Ogle
Robert H. Vogel Engineering, Inc.
8407 Main Street
Ellicott City, Maryland 21043

Re: Homeland Unit 12

Dear Mr. Ogle,

Our office received a variance letter for the above referenced property on September 1, 2005. The request is to encroach within the 10' setback from a deck to the sewage disposal area. The Howard County Health Department will grant a 6' encroachment into the sewage disposal area.

If you have any questions regarding the review of this property please feel free to contact our office at (410) 313-1771

Sincerely,

A handwritten signature in cursive script that reads 'Michael J. Davis'.

Michael J. Davis
Well and Septic Program Supervisor