

3/14/02 = 12pm
3/15/02 PM

PUB. SEWER STATUS VERIFIED BY SRK

RPS# NOT UNDER "8180"

ISSUE DATE: 3/13/2002

P 516867

APPROVAL DATE: 3/15/02

A Repair

PERMIT

INDEXED

ON-SITE SEWAGE DISPOSAL SYSTEM HOWARD COUNTY HEALTH DEPARTMENT BUREAU OF ENVIRONMENTAL HEALTH

Freedom Septic (Bruce) IS PERMITTED TO INSTALL ALTER

ADDRESS: 239 West Old Liberty Road PHONE NUMBER: 410-795-2947

SUBDIVISION: Bean Property LOT NUMBER: 7

ADDRESS: 8180 Stabean Drive PROPERTY OWNER: Mark Ganum (301) 604-7814

SEPTIC TANK CAPACITY (GALLONS): 1500 *Homeowner elects to install 1500 - Ex. 1000 gallons to be crushed/abandoned*

PUMP CHAMBER CAPACITY (GALLONS): N/A

NUMBER OF BEDROOMS: 3 (Existing) Potentially 4 in Future (This permit is to size for 4)

SQUARE FEET PER BEDROOM: 180

LINEAR FEET OF TRENCH REQUIRED: 150-200' (Depends on system)

TRENCHES:	Trench to be 3' feet wide. Inlet 5-7 feet below original grade. Bottom maximum depth 9-10 feet below original grade. Effective area begins at 3'5" feet below original grade. 2-4' feet of stone below distribution pipe.
LOCATION:	Place the distribution box as discussed in field. Run 1st trench 75' from ex. well. TRENCHES 10' CTC
PURPOSE:	To accomodate building permit. Call for inspection when ground is opened so sanitarian can recommend repair. and ex. failing system.

PLANS APPROVED: Steven R. Krieg OK SRK 2/13/02 DATE: 2/13/2002

- NOTE: PERMIT VOID AFTER 2 YEARS
- NOTE: CONTRACTOR RESPONSIBLE FOR SCHEDULING A PRE-CONSTRUCTION INSPECTION FOR ALL INSTALLATIONS
- NOTE: WATERTIGHT SEPTIC TANKS REQUIRED
- NOTE: ALL PARTS OF SEPTIC SYSTEM SHALL BE 100 FEET FROM ANY WATER WELL
- NOTE: MANHOLE RISERS REQUIRED ON ALL SEPTIC TANKS AND PUMP CHAMBERS

OLD PERMIT 72
AND RETURNED 3-28-02
000135174-ENLARGE 3rd plan
P516867

NEITHER THE HOWARD COUNTY COUNCIL NOR THE HEALTH DEPARTMENT IS RESPONSIBLE FOR THE SUCCESSFUL OPERATION OF ANY SYSTEM PERMITTEE RESPONSIBLE FOR OBTAINING FINAL APPROVAL ON THIS PERMIT CALL 410-313-2640 FOR INSPECTION OF SEPTIC SYSTEM

If Inlet into distribution box 5', 4' stone, 9' Bottom (3-50' trenches) 150' total
" " " " " 6', " 10' Bottom (") "
" " " " " 7', 2' stone 9' Bottom (4-50' trenches) 200' total
ALL SYSTEMS TO BE 3' WIDE & 10' CENTER TO CENTER

NOT TO SCALE

PROPERTY LINE

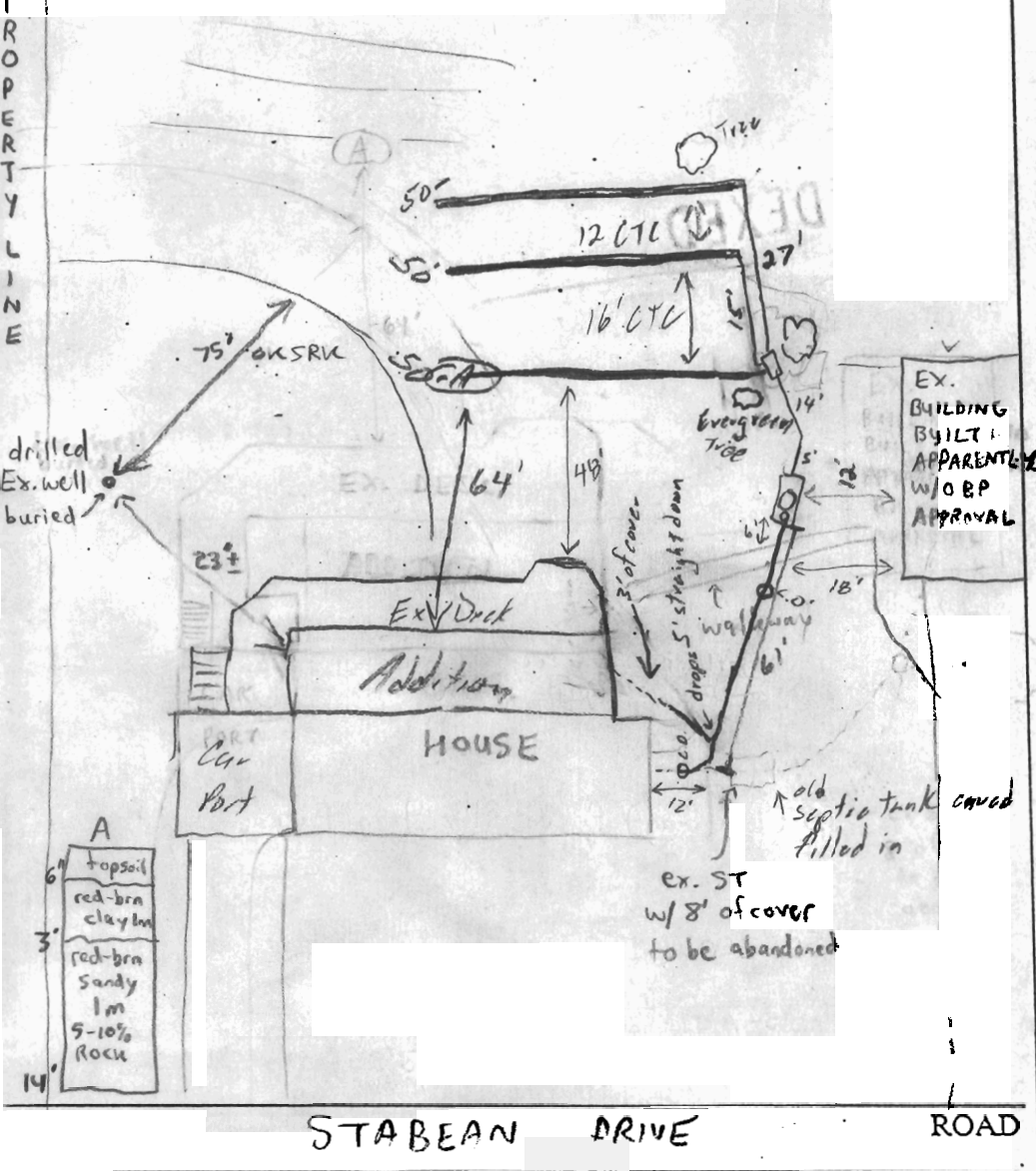

TRENCH/DRAINFIELD DATA		
WIDTH	INLET	BOTTOM
3	5-5.5'	9-9.5'
NUMBER OF TRENCHES		3
TOTAL LENGTH		150'
ABSORPTION AREA		600A
DISTRIBUTION BOX LEVEL		YES
DISTRIBUTION BOX BAFFLE		YES
DISTRIBUTION BOX PORT		-

SEPTIC TANK DATA	
SEPTIC TANK 1 LEVEL	✓
CAPACITY	2000 GAL
SEAM LOC	TOP
TANK LID DEPTH	5'
BAFFLES	YES
BAFFLE FILTER	NO
MANHOLE LOC	CENTER
6" PORT LOC	-
WATERTIGHT TEST	-
SEPTIC TANK 2 LEVEL	NA
CAPACITY	_____ GAL
SEAM LOC	_____
TANK LID DEPTH	_____
BAFFLES	_____
BAFFLE FILTER	_____
MANHOLE LOC	_____
6" PORT LOC	_____
WATERTIGHT TEST	_____

DARNOLDS

PRE-CONSTRUCTION 2/2/02 - MET HOMEOWNER & INSTALLER AT SITE, WORKING W/ EX. BASEMENT PLUMBING, EX. WELL LOCATION & PLANS FOR FUTURE ADDITION, DUG PERC HOLE IN LOCATION A (SEE SOIL PROFILE) INSTALL SYSTEM AS DISCUSSED (SYSTEM DESIGN MAY VARY DEPENDENT ON DEPTH OF INV. OUT OF SEPTIC TANK SEE FRONT) THE MOST EFFICIENT SYSTEM POSSIBLE IS PREFERRED. ABANDONMENT OF INSTALLATION EX. DRY WELLS MAY NOT BE POSSIBLE GIVEN THAT THEY MAY BE UNDERNEATH EX. BUILDING/GARAGE. (SRV)

3/13/02 - DISCUSSED W/ BRUCE FROM PREBORN SEPTIC IN OFFICE LAYOUT OF SEPTIC REPAIR - (SRV)

3/14/02 Tank set 3/14/02 System installed up to S.T. OK to cover (SRV)

3/15/02 OK to cover all work (SRV)

FINAL INSPECTOR: Steve De... DATE OF APPROVAL: 3/15/02

2/2/02
Repair 10:00

PUBLIC SEWER AVAILABLE : YES (NO)

ISSUE DATE: 02/13/02

PERMIT

P 516512

APPROVAL DATE: _____

A REPAIR

ON-SITE SEWAGE DISPOSAL SYSTEM HOWARD COUNTY HEALTH DEPARTMENT BUREAU OF ENVIRONMENTAL HEALTH

~~Arnold's Backhoe & Septic Service, Inc~~

Arnold's Backhoe & Septic Service, Inc IS PERMITTED TO INSTALL ALTER

ADDRESS: P O Box 15, Woodbine PHONE NUMBER: 410-795-7853

SUBDIVISION: Bean Bass Property LOT NUMBER: 7

ADDRESS: 8180 Stabean Drive PROPERTY OWNER: Mark Ganium

SEPTIC TANK CAPACITY (GALLONS): 1500 Top Seam

PUMP CHAMBER CAPACITY (GALLONS): NA

NUMBER OF BEDROOMS: ex. 3 (Potentially 4 in future)

SQUARE FEET PER BEDROOM: 180

LINEAR FEET OF TRENCH REQUIRED: 150-200

TRENCHES:	Trench to be <u>3</u> feet wide. Inlet <u>5-7</u> feet below original grade. Bottom maximum depth <u>9-10'</u> feet below original grade. Effective area begins at <u>3'5"</u> feet below original grade. <u>2-4</u> feet of stone below distribution pipe.
LOCATION:	
PURPOSE:	To accommodate building permit. Call for inspection when ground is opened so sanitarian can recommend repair. <u>and ex. failing system</u>

PLANS APPROVED: Steven Krieg ON SRK 2/13/02 DATE: 02/13/2002

- NOTE: PERMIT VOID AFTER 2 YEARS
- NOTE: CONTRACTOR RESPONSIBLE FOR SCHEDULING A PRE-CONSTRUCTION INSPECTION FOR ALL INSTALLATIONS
- NOTE: WATERTIGHT SEPTIC TANKS REQUIRED
- NOTE: ALL PARTS OF SEPTIC SYSTEM SHALL BE 100 FEET FROM ANY WATER WELL
- NOTE: MANHOLE RISERS REQUIRED ON ALL SEPTIC TANKS AND PUMP CHAMBERS

NEITHER THE HOWARD COUNTY COUNCIL NOR THE HEALTH DEPARTMENT IS RESPONSIBLE FOR THE SUCCESSFUL OPERATION OF ANY SYSTEM PERMITTEE RESPONSIBLE FOR OBTAINING FINAL APPROVAL ON THIS PERMIT CALL 410-313-2640 FOR INSPECTION OF SEPTIC SYSTEM

NOT TO SCALE

TRENCH/DRAINFIELD DATA

WIDTH _____ INLET _____ BOTTOM _____

NUMBER OF TRENCHES _____

TOTAL LENGTH _____

ABSORPTION AREA _____

DISTRIBUTION BOX LEVEL _____

DISTRIBUTION BOX BAFFLE _____

DISTRIBUTION BOX PORT _____

SEPTIC TANK DATA

SEPTIC TANK 1 LEVEL _____

CAPACITY _____ GAL

SEAM LOC _____

TANK LID DEPTH _____

BAFFLES _____

BAFFLE FILTER _____

MANHOLE LOC _____

6" PORT LOC _____

WATERTIGHT TEST _____

SEPTIC TANK 2 LEVEL _____

CAPACITY _____ GAL

SEAM LOC _____

TANK LID DEPTH _____

BAFFLES _____

BAFFLE FILTER _____

MANHOLE LOC _____

6" PORT LOC _____

WATERTIGHT TEST _____

ROAD

PRE-CONSTRUCTION 2/21/02

INSTALLATION _____

FINAL INSPECTOR _____

DATE OF APPROVAL _____