

LAYOUT 10/13/04 INSP 4 \_\_\_\_\_

INSP 2 \_\_\_\_\_ INSP 5 \_\_\_\_\_

INSP 3 \_\_\_\_\_ INSP 6 \_\_\_\_\_

ISSUE DATE: 10/13/04APPROVAL DATE: 11/4/04**PERMIT**P 521535A 51857203-281019

**ON-SITE SEWAGE DISPOSAL SYSTEM  
HOWARD COUNTY HEALTH DEPARTMENT  
BUREAU OF ENVIRONMENTAL HEALTH  
3525-H ELLICOTT MILLS DRIVE, ELLICOTT CITY, MD 21043**

**INDEXED**IS PERMITTED TO INSTALL ☐ ALTER ☐

ADDRESS: \_\_\_\_\_ PHONE NUMBER: \_\_\_\_\_

SUBDIVISION: Donnie Brown Property LOT NUMBER: TM 22, p/o P 185ADDRESS: 13301 Triadelphia Road PROPERTY OWNER: Donnie Lee BrownSEPTIC TANK CAPACITY (GALLONS): 1500 OUTLET BAFFLE FILTER REQUIRED ☐PUMP CHAMBER CAPACITY (GALLONS): N/A COMPARTMENTED TANK REQUIRED ☐NUMBER OF BEDROOMS: 5SQUARE FEET PER BEDROOM: 210LINEAR FEET OF TRENCH REQUIRED: 300 HOUSE SERVED BY PUBLIC WATER ☐

TRENCHES:	Trench to be 2.0 feet wide. Inlet 4.0 feet below original grade. Bottom maximum depth 9.0 feet below original grade. Effective area begins at 7.0 feet below original grade. 5.0 feet of stone below distribution pipe.
LOCATION:	Place distribution box in the center of the staked SDA as shown. Run <sup>6</sup> 50' trenches on contour in either direction. <i>Alternate dist box location: closest staked cor of SDA.</i>
NOTES:	Contractor encouraged to bring top of stone to 2-3' below grade to increase oxygen infiltration.

PLANS APPROVED: MER DATE: 11/03/03

## NOTES: PERMIT VOID AFTER 2 YEARS

CONTRACTOR IS RESPONSIBLE FOR SCHEDULING A PRE-CONSTRUCTION INSPECTION FOR ALL INSTALLATIONS

WATERTIGHT SEPTIC TANKS REQUIRED

ALL PARTS OF SEPTIC SYSTEM SHALL BE 100 FEET FROM ANY WATER WELL UNLESS SPECIFICALLY AUTHORIZED

MANHOLE RISERS REQUIRED ON ALL SEPTIC TANKS AND PUMP CHAMBERS UNLESS SPECIFICALLY AUTHORIZED

CONTRACTOR RESPONSIBLE FOR COMPLIANCE WITH APPLICABLE REGULATIONS, GUIDELINES AND THE TERMS OF THIS PERMIT

**NEITHER THE HOWARD COUNTY COUNCIL NOR THE HEALTH DEPARTMENT IS  
RESPONSIBLE FOR THE SUCCESSFUL OPERATION OF ANY SYSTEM  
PERMITTEE RESPONSIBLE FOR OBTAINING FINAL APPROVAL ON THIS PERMIT  
CALL 410-313-2640 FOR INSPECTION OF SEPTIC SYSTEM  
DO NOT LEAVE ANY REQUEST FOR INSPECTION ON VOICEMAIL**

A518572

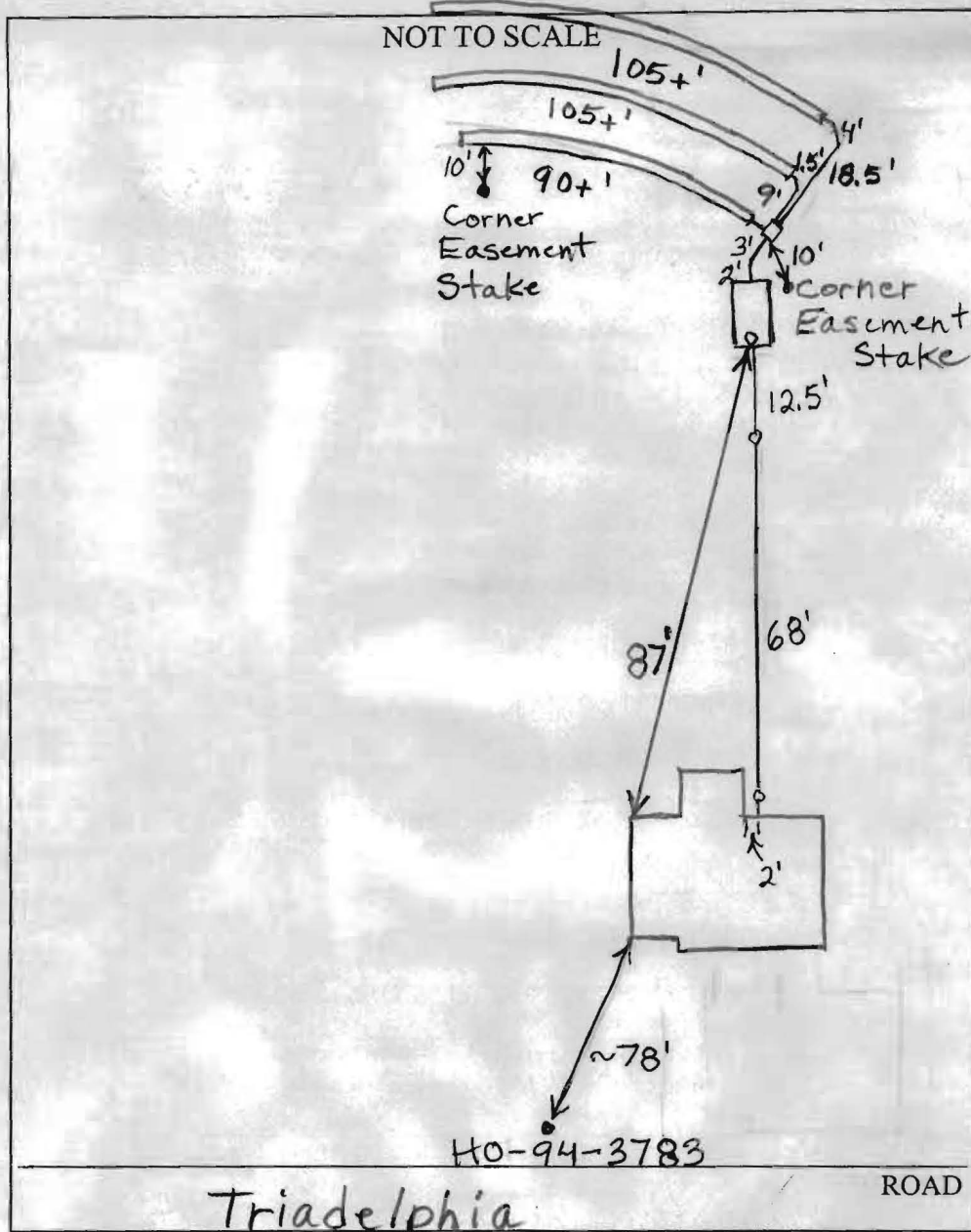

TRENCH/DRAINFIELD DATA		
WIDTH	INLET	BOTTOM
2'	4'	9'
NUMBER OF TRENCHES 3		
TOTAL LENGTH 300+		
ABSORPTION AREA 600+ sq. ft.		
DISTRIBUTION BOX LEVEL Yes		
DISTRIBUTION BOX BAFFLE Yes		
DISTRIBUTION BOX PORT No		

SEPTIC TANK DATA		
SEPTIC TANK 1 LEVEL ✓		
2 Comp. Mayer	CAPACITY	1500 GAL
	SEAM LOC	Top
	TANK LID DEPTH	1 1/2'
	BAFFLES	?
	BAFFLE FILTER	No
	MANHOLE LOC	?
	6" PORT LOC	Front
WATERTIGHT TEST No		
SEPTIC TANK 2 LEVEL N/A		
CAPACITY _____ GAL		
SEAM LOC _____		
TANK LID DEPTH _____		
BAFFLES _____		
BAFFLE FILTER _____		
MANHOLE LOC _____		
6" PORT LOC _____		
WATERTIGHT TEST _____		

PRE-CONSTRUCTION 10/19/04 Met with homeowner. We checked elevations at the house connection and the septic easement. Should be able

INSTALLATION to place the distribution box at the upper left corner of the easement and use gravity. Keep fall between 1-2%.

Homeowner/installer not familiar with septic installations. Will need to spend more time on site during installation. (BB)

11/4/04 Homeowner (Brown) helped install trenches - they looked good. Tank may not have front baffle - lid cemented shut.

Mr. Brown wasn't present when plumbing to tank done. Told Mr. Brown to install rear baffle. I also suggested that he put

FINAL INSPECTOR Brian Baber

DATE OF APPROVAL 11/4/04

levelers in dist. box. He said he would do this and also put a manhole on the rear of the tank. Tank has built in baffle in middle. Raining fairly heavily. Trenches got wet. (BB)