

Recorded
8/1/69
9:30

APPLICATION

A 1466

SEWAGE DISPOSAL TESTING

P

MARYLAND STATE DEPARTMENT OF HEALTH

HOWARD COUNTY *Septic Tank - 750 gal.*

ELLICOTT CITY

Dry Well - 300 sq. ft. absorbent sidewall to area to begin below the first 5 ft. of non-absorbent soil. Maximum depth permitted for ^{dry} well is 11 ft. below original grade. Locate dry well 53 ft. from left side line and 86 ft. from rear property line as seen from West Waterville Rd.

DISTRICT 4

DATE 7/2/69

TO: THE COUNTY HEALTH OFFICER
ELLICOTT CITY, MARYLAND

I, HEREBY, APPLY FOR THE NECESSARY TESTS IN ORDER TO CONSTRUCT (OR RECONSTRUCT) A SEWAGE DISPOSAL SYSTEM.

PROPERTY OWNER Richard H. Dorsey

ADDRESS West Waterville Road, Mt. Airy, Md. PHONE 829-0098

PROPERTY LOCATION:

SUBDIVISION _____ LOT NO. _____

ROAD AND DESCRIPTION West Waterville Road - off Rt. 40 - approx. 1 mile look for brick house then woods - same side as woods. North

OCCUPANT _____ PHONE _____

PERSON TO CONSTRUCT SYSTEM _____

ADDRESS _____ PHONE _____

SIZE OF LOT 0.999 acres TYPE BLDG. _____ NUMBER OF BEDROOMS 3

IF NOT SINGLE RESIDENCE DESCRIBE _____

SIGNATURE OF APPLICANT _____

✓ APPROVED BY Robert V. Tove FOR Dry Well DATE 1 Aug 69
(KIND OF SYSTEM)

REJECTED BY _____ FOR _____ DATE _____
(KIND OF SYSTEM)

HOLD PENDING FURTHER TESTS _____ DATE _____

REASONS FOR REJECTION OR HOLDING _____

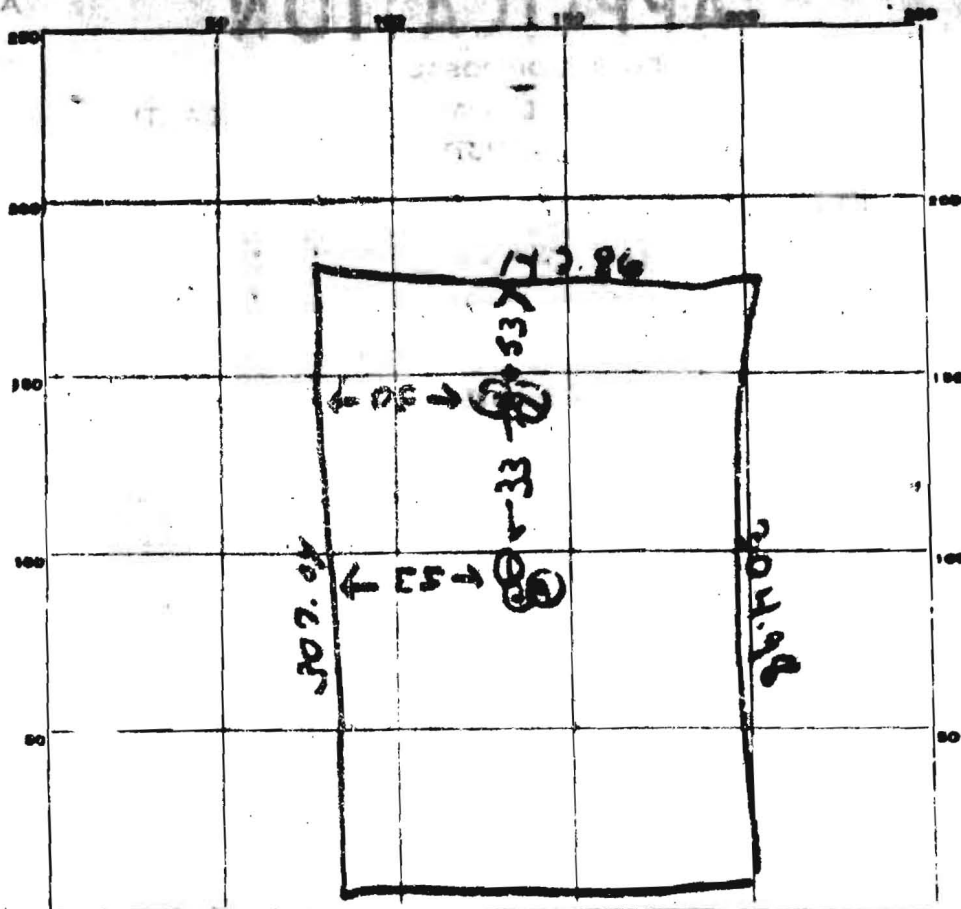

INDICATE NORTH. - NAME ADJOINING ROADWAY AS BASE LINE.

W. Waterworks Rd

DATE	TEST NO.	DEPTH	PRE-WET		TEST - 1" DROP		TIME
			START	STOP	START	STOP	
9/11/69	1	9 3/4"		9 39	9 37	9 41	2 min
	2	3 3/4"		No	Pass		
	3	9 1/4"	9 44	9 45	9 45	9 46	1 min
	4	3 3/4"	9 44	No	Pass		
	2A	5 ft	10 58	10 04	10 04	10 16	12 min
		hard ^{wood} sandy shale at 5 ft.					