

APPLICATION

SEWAGE DISPOSAL TESTING

MARYLAND STATE DEPARTMENT OF HEALTH

HOWARD COUNTY *Septic tank 1000 gallons* ELLICOTT CITY

Dry well; to be 552 sq ft of abascent sidewalk DISTRICT _____

also below the inlet pipe. Inlet pipe to be 5 ft below original grade. DATE _____

5 ft below ~~manhole~~ *manhole* ~~inlet pipe~~ *inlet pipe* ~~to be 5 ft below original grade~~ *original grade*

Locate Dry well: 2.62 ft from rear lot line and 69 ft from right side line, as seen from facing lot standing on Route 94.

Minimum Depth of Dry well 12 1/2 ft.

TO: THE COUNTY HEALTH OFFICER
ELLICOTT CITY, MARYLAND

I, HEREBY, APPLY FOR THE NECESSARY TESTS IN ORDER TO CONSTRUCT (OR RECONSTRUCT) A SEWAGE DISPOSAL SYSTEM.

PROPERTY OWNER Charles R. Thompson

ADDRESS _____ PHONE _____

PROPERTY LOCATION:

SUBDIVISION _____ LOT NO. _____

ROAD AND DESCRIPTION Rt. 94 - So. of District

OCCUPANT _____ PHONE _____

PERSON TO CONSTRUCT SYSTEM _____

ADDRESS _____ PHONE _____

SIZE OF LOT _____ TYPE BLDG. _____

NUMBER OF BEDROOMS

IF NOT SINGLE RESIDENCE DESCRIBE _____

SIGNATURE OF APPLICANT _____

APPROVED BY Jessie T. Wright FOR Dry well DATE 10/3/68
(KIND OF SYSTEM)

REJECTED BY _____ FOR _____ DATE _____
(KIND OF SYSTEM)

HOLD PENDING FURTHER TESTS _____ DATE _____

REASONS FOR REJECTION OR HOLDING _____

THIS IS NOT A PERMIT

10/13/68
10/13/68

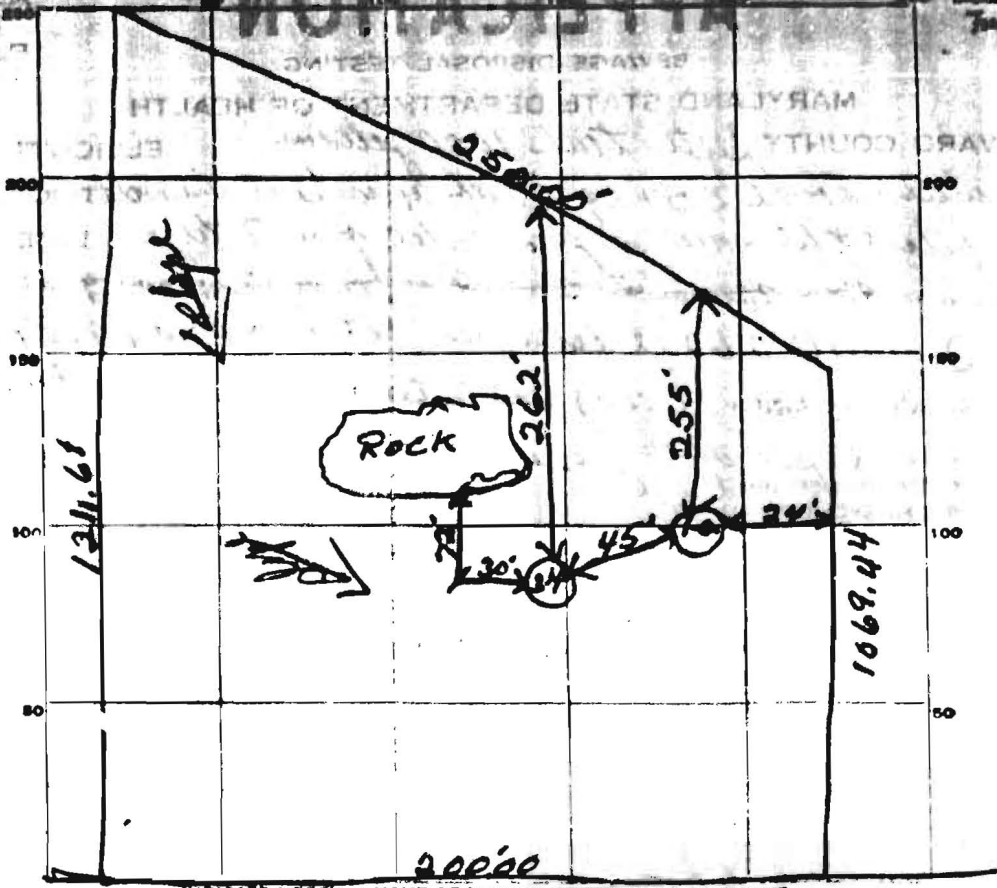

INDICATE NORTH - NAME ADJOINING ROADWAY AS BASE LINE.

Route #94

DATE	TEST NO.	DEPTH	PRE-WET		TEST - 1" DROP		TIME
			START	STOP	START	STOP	
10/13/68	1	10'	9 49	9 55	9 55	10 05	10 min
	2	4 1/2'	9 50	10 02	10 02	10 26	24 min
	3	1 1/2'	10 07	10 08	10 08	10 10	2 min
	4	4'	10 11	10 20	10 20	10 41	21 min

14 min AV

55

SOIL AUGER FINDING

TESTED BY *J. W. 10/13/68*

REMARKS *first 5 ft man-applied*