

# APPLICATION

## FOR PERCOLATION TESTING AND SITE EVALUA

TEST DATE(S) \_\_\_\_\_ TEST TIME \_\_\_\_\_

520030  
AP  
DATE 1/21/04

AGENCY REVIEW: \_\_\_\_\_

DO NOT WRITE ABOVE THIS LINE

I HEREBY APPLY FOR THE NECESSARY TESTING/EVALUATION PRIOR TO ISSUANCE OF SEWAGE DISPOSAL SYSTEM PERMIT(S) TO:

CHECK AS NEEDED:

- CONSTRUCT NEW SEPTIC SYSTEM(S)
- REPAIR/ADD TO AN EXISTING SEPTIC SYSTEM
- REPLACE AN EXISTING SEPTIC SYSTEM

CHECK AS NEEDED:

- NEW STRUCTURE(S)
- ADDITION TO AN EXISTING STRUCTURE
- REPLACE AN EXISTING STRUCTURE

CHECK ONE:

- CREATE NEW LOT(S)
- BUILD ON AN EXISTING LOT IN A SUBDIVISION
- BUILD ON AN EXISTING PARCEL OF RECORD

IS THE PROPERTY WITHIN 2500' OF ANY RESERVOIR?

- YES
- NO

THE TYPE OF STRUCTURE IS:

- RESIDENTIAL WITH \_\_\_\_\_ PROPOSED BEDROOMS IN THE COMPLETED STRUCTURE (NOTE **UNKNOWN** IF APPROPRIATE)
- COMMERCIAL (PROVIDE DETAIL OF NUMBERS AND TYPES OF EMPLOYEES/ CUSTOMERS ON ACCOMPANYING)
- INSTITUTIONAL/GOVERNMENT (PROVIDE DETAIL OF NUMBERS AND TYPES OF EMPLOYEES/USERS ON ACCOMPANYING)

PROPERTY OWNER(S) John Klein

DAYTIME PHONE 410 463 4455 CELL \_\_\_\_\_ FAX \_\_\_\_\_

MAILING ADDRESS 1140 Underwood Rd Sykesville md  
STREET CITY/TOWN STATE

APPLICANT Ken Hatfield Hatfield's Equipment

DAYTIME PHONE 410 631-6773 CELL 410 984 0101 FAX 410 489 4905

MAILING ADDRESS 13785 Burntwoods Rd Glenelg md  
STREET CITY/TOWN STATE

APPLICANT'S ROLE: DEVELOPER BUILDER BUYER RELATIVE (FRIEND) REALTOR CONSUL  
*septic installer*

PROPERTY LOCATION  
SUBDIVISION/PROPERTY NAME Kline Property LOT NO. \_\_\_\_\_

PROPERTY ADDRESS 1140 Underwood Rd Sykesville Md 21784  
STREET TOWN/POST OFFICE

TAX MAP PAGE(S) \_\_\_\_\_ GRID \_\_\_\_\_ PARCEL(S) \_\_\_\_\_ PROPOSED LOT SIZE \_\_\_\_\_

AS APPLICANT, I UNDERSTAND THE FOLLOWING: THE SYSTEM INSTALLED SUBSEQUENT TO THIS APPLICATION IS AVAILABLE ONLY UNTIL PUBLIC SEWERAGE IS AVAILABLE. THIS APPLICATION IS COMPLETE WHEN ALL APPLICABLE FEES AND SUITABLE SITE PLAN HAVE BEEN RECEIVED. I ACCEPT THE RESPONSIBILITY FOR COMPLIANCE WITH ALL M.O.S.H.A. "MISS UTILITY" REQUIREMENTS. APPROVAL IS BASED UPON SATISFACTORY REVIEW OF A PERC CERTIFICATION PLAN. TEST RESULTS WILL BE MAILED TO APPLICANT.

Ken Hatfield  
SIGNATURE OF APPLICANT

AP  
101  
Brown Loam 2'  
Brown Yellow Brown gravelly clay loam 6'  
Heavy Red Silty loam  
Clay loam 10'  
Yellow Brown silty loam w/ 25% rock 13'

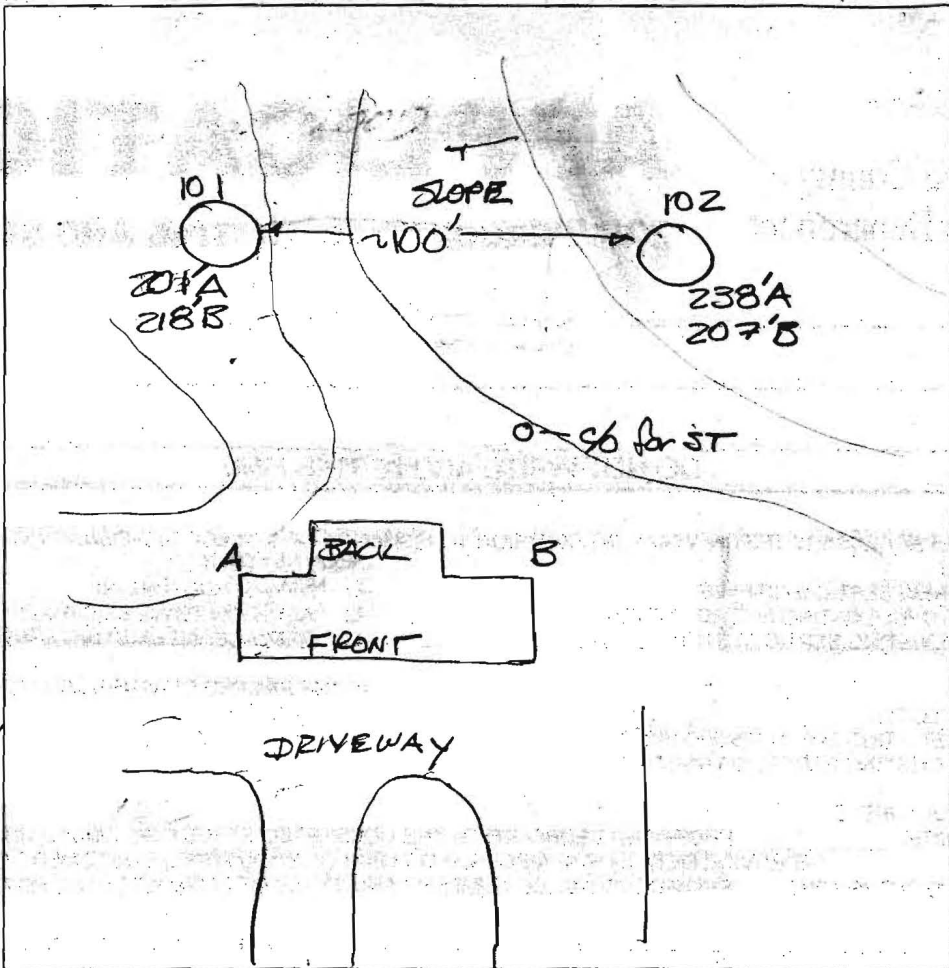

102  
Brown Loam 1/2'  
Brown Yellow gravelly clay loam 6'  
Yellow Brown silty loam w/ 4% 5% gravelly quartz 14'

1140 UNDERWOOD RD

DATE	TEST #	DEPTH	START	BREAK 1" DROP	STOP 2" DROP	TIME OF 2nd INCH	P/F/H
1/28/04	101	6' / 13'	11:30	12:45	12:00	STOPPED & NOT FINISHED	F
	102	6' / 14'	12:45	11:53	12:00	7 min	P

REMARKS \_\_\_\_\_  
 SANITARIAN FA BACKHOE Jeff Tom Hatfields OTHERS Mr. John Klein, Jr. Eddie  
 TEST HOLES USED IN SDA \_\_\_\_\_ AVG. PERC TIME \_\_\_\_\_ SQ. FT/BR \_\_\_\_\_  
 TRENCH WIDTH \_\_\_\_\_ INLET DEPTH \_\_\_\_\_ MAX. BOT DEPTH \_\_\_\_\_ EFFECTIVE SW \_\_\_\_\_