

3/23 - PM

PUB. SEWER STATUS VERIFIED BY _____

ISSUE DATE:

3/9/2004P 520083

APPROVAL DATE:

3/23/04A REPAIR**PERMIT****INDEXED****ON-SITE SEWAGE DISPOSAL SYSTEM
HOWARD COUNTY HEALTH DEPARTMENT
BUREAU OF ENVIRONMENTAL HEALTH**03-297144

Jack Fyock Septic Service

IS PERMITTED TO

INSTALL ☐ALTER ☒ADDRESS: PO Box 89, Glenelg 21737PHONE NUMBER: 410-988-9270SUBDIVISION: Evergreen Valley EstatesLOT NUMBER: 6ADDRESS: 11821 Triadelphia RdPROPERTY OWNER: Jack Crumrine

SEPTIC TANK CAPACITY (GALLONS):

Ex 750

PUMP CHAMBER CAPACITY (GALLONS):

—

NUMBER OF BEDROOMS:

341.5" stone
3 4

SQUARE FEET PER BEDROOM:

210

LINEAR FEET OF TRENCH REQUIRED:

130174149199

| | |
|-----------|--|
| TRENCHES: | Trench to be <u>3</u> feet wide. Inlet/feet below original grade. Bottom maximum depth <u>3</u> feet below original grade. Effective area begins at <u>2</u> feet below original grade. <u>2</u> feet of stone below distribution pipe. |
| LOCATION: | |
| PURPOSE: | Existing septic system has failed. Call for inspection when ground is opened so sanitarian can recommend repair. |

PLANS APPROVED:

DATE:

3/10/04

NOTE: PERMIT VOID AFTER 2 YEARS

NOTE: CONTRACTOR RESPONSIBLE FOR SCHEDULING A PRE-CONSTRUCTION INSPECTION FOR ALL INSTALLATIONS

NOTE: WATERTIGHT SEPTIC TANKS REQUIRED

NOTE: ALL PARTS OF SEPTIC SYSTEM SHALL BE 100 FEET FROM ANY WATER WELL

NOTE: MANHOLE RISERS REQUIRED ON ALL SEPTIC TANKS AND PUMP CHAMBERS

**NEITHER THE HOWARD COUNTY COUNCIL OR THE HEALTH DEPARTMENT IS
RESPONSIBLE FOR THE SUCCESSFUL OPERATION OF ANY SYSTEM
PERMITTEE RESPONSIBLE FOR OBTAINING FINAL APPROVAL ON THIS PERMIT
CALL 410-313-2640 FOR INSPECTION OF SEPTIC SYSTEM**

P 520083

NOT TO SCALE

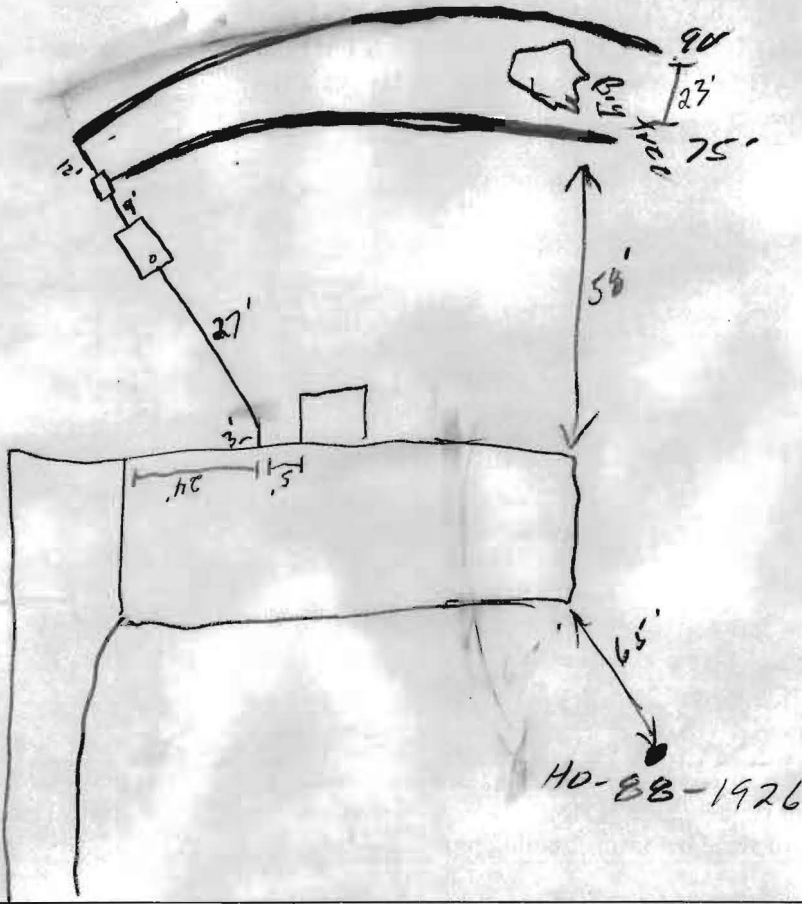

| TRENCH/DRAINFIELD DATA | | |
|-------------------------|-------|--------|
| WIDTH | INLET | BOTTOM |
| 3 | 1 | 3 |
| NUMBER OF TRENCHES | | 2 |
| TOTAL LENGTH | | 165 |
| ABSORPTION AREA | | |
| DISTRIBUTION BOX LEVEL | | ✓ |
| DISTRIBUTION BOX BAFFLE | | ✓ |
| DISTRIBUTION BOX PORT | | — |

| SEPTIC TANK DATA | |
|---------------------|----------|
| SEPTIC TANK 1 LEVEL | ✓ |
| CAPACITY | 1250 GAL |
| SEAM LOC | Top |
| TANK LID DEPTH | 1' |
| BAFFLES | ✓ |
| BAFFLE FILTER | — |
| MANHOLE LOC | — |
| 6" PORT LOC | Front |
| WATERTIGHT TEST | — |
| SEPTIC TANK 2 LEVEL | — |
| CAPACITY | — GAL |
| SEAM LOC | — |
| TANK LID DEPTH | — |
| BAFFLES | N/A |
| BAFFLE FILTER | — |
| MANHOLE LOC | — |
| 6" PORT LOC | — |
| WATERTIGHT TEST | — |

PRE-CONSTRUCTION 3/10/04 - See specs & pre sheet

INSTALLATION 3/23/04 - OK to cover all work (SD)

FINAL INSPECTOR [Signature] DATE OF APPROVAL 3/23/04