

4/30/04 about Noon

PUB. SEWER STATUS VERIFIED BY \_\_\_\_\_

ISSUE DATE: 4/7/2004

APPROVAL DATE: 5/3/04

**PERMIT  
INDEXED**

P 520138- c

A REPAIR

**ON-SITE SEWAGE DISPOSAL SYSTEM  
HOWARD COUNTY HEALTH DEPARTMENT  
BUREAU OF ENVIRONMENTAL HEALTH**

**05-403170**

Fyock Septic Service

IS PERMITTED TO INSTALL ☐ ALTER ☒

ADDRESS: PO Box 89, Glenelg MD 21737

PHONE NUMBER: 410-988-9270

SUBDIVISION: Bruffey

LOT NUMBER: 1

ADDRESS: 14730 Triadelphia Mill Road

PROPERTY OWNER: Robert Learmouth

SEPTIC TANK CAPACITY (GALLONS): Ex 1500

PUMP CHAMBER CAPACITY (GALLONS): \_\_\_\_\_

NUMBER OF BEDROOMS: \_\_\_\_\_

SQUARE FEET PER BEDROOM: \_\_\_\_\_

LINEAR FEET OF TRENCH REQUIRED: \_\_\_\_\_

TRENCHES:	Trench to be _____ feet wide. Inlet _____ feet below original grade. Bottom maximum depth _____ feet below original grade. Effective area begins at _____ feet below original grade. _____ feet of stone below distribution pipe.
LOCATION:	
PURPOSE:	In support of building permit. Call for inspection when ground is opened so sanitarian can recommend repair.

PLANS APPROVED: \_\_\_\_\_

DATE: \_\_\_\_\_

NOTE: PERMIT VOID AFTER 2 YEARS

NOTE: CONTRACTOR RESPONSIBLE FOR SCHEDULING A PRE-CONSTRUCTION INSPECTION FOR ALL INSTALLATIONS

NOTE: WATERTIGHT SEPTIC TANKS REQUIRED

NOTE: ALL PARTS OF SEPTIC SYSTEM SHALL BE 100 FEET FROM ANY WATER WELL

NOTE: MANHOLE RISERS REQUIRED ON ALL SEPTIC TANKS AND PUMP CHAMBERS

**NEITHER THE HOWARD COUNTY COUNCIL OR THE HEALTH DEPARTMENT IS  
RESPONSIBLE FOR THE SUCCESSFUL OPERATION OF ANY SYSTEM**

**BUILDING PERMIT SIGNED AND RETURNED**  
**PERMITTEE RESPONSIBLE FOR OBTAINING FINAL APPROVAL ON THIS PERMIT**  
**CALL 410-313-2640 FOR INSPECTION OF SEPTIC SYSTEM**

**10-25-04 B00150408- Family Room**

P520138-C

NOT TO SCALE

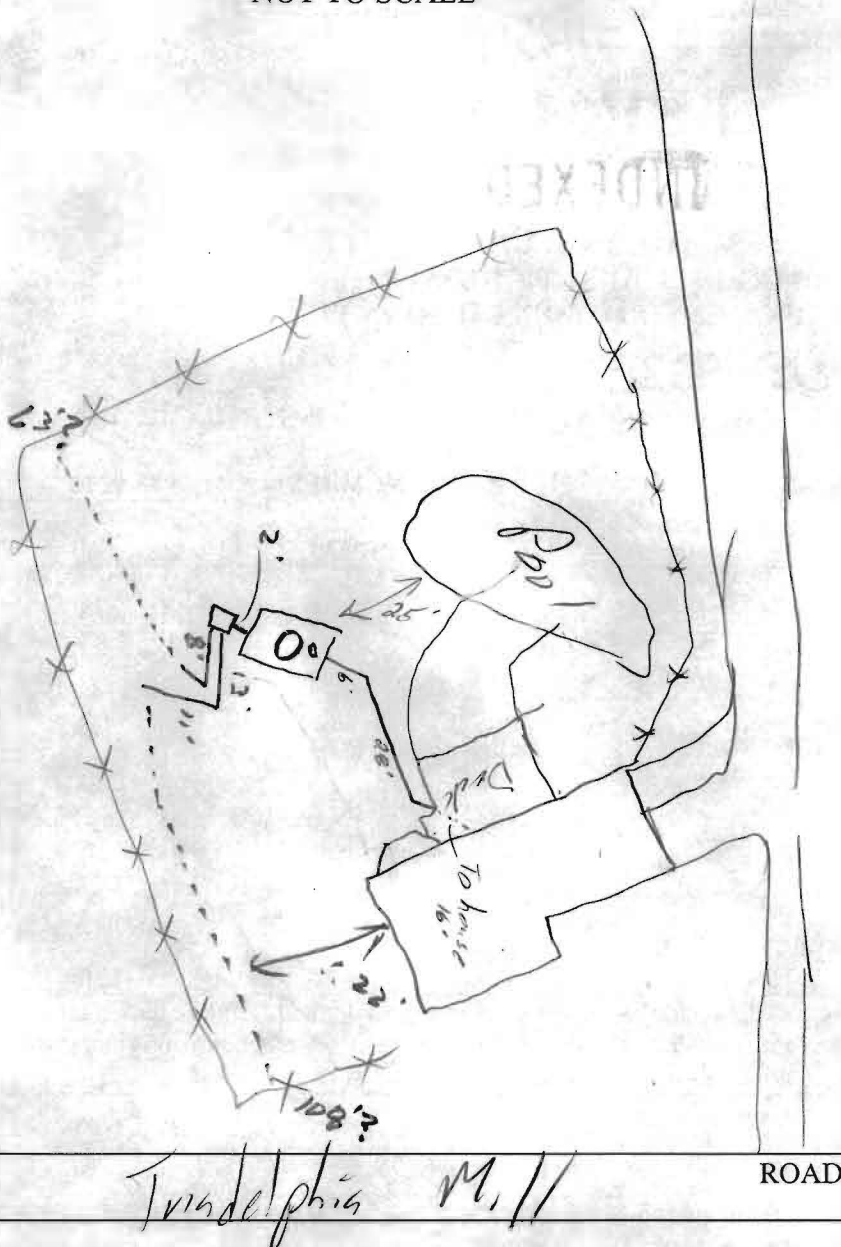

TRENCH/DRAINFIELD DATA		
WIDTH	INLET	BOTTOM
_____	_____	_____
NUMBER OF TRENCHES _____		
TOTAL LENGTH _____		
ABSORPTION AREA _____		
DISTRIBUTION BOX LEVEL _____		
DISTRIBUTION BOX BAFFLE _____		
DISTRIBUTION BOX PORT _____		

SEPTIC TANK DATA	
SEPTIC TANK 1 LEVEL <input checked="" type="checkbox"/>	
CAPACITY	1500 GAL
SEAM LOC	Top
TANK LID DEPTH	2-3'
BAFFLES	<input checked="" type="checkbox"/>
BAFFLE FILTER	_____
MANHOLE LOC	Center
6" PORT LOC	Front
WATERTIGHT TEST	_____
SEPTIC TANK 2 LEVEL _____	
CAPACITY	_____ GAL
SEAM LOC	_____
TANK LID DEPTH	_____
BAFFLES	N/A
BAFFLE FILTER	_____
MANHOLE LOC	_____
6" PORT LOC	_____
WATERTIGHT TEST	_____

PRE-CONSTRUCTION

INSTALLATION 4/30/04 - Tank set, trenches are not where they are supposed to be. Will need to dig around to find D.B. & trench ends, Contr. will draw final as build & send in (50) 5/3/04 - Contr. abandoned  $\therefore$  10' of trench furthest from house. Reconnected to 2 existing trenches

BUILDING PERMIT SIGNED  
AND RETURNED

FINAL INSPECTOR

*[Signature]*

DATE OF APPROVAL

5/3/04

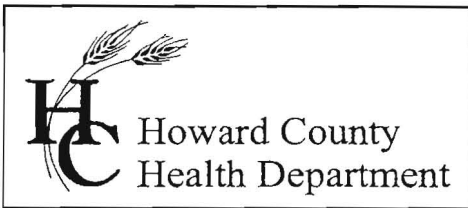

3525 H Ellicott Mills Drive, Ellicott City, MD 21043  
(410) 313-2640 Fax (410) 313-2648  
TDD (410) 313-2323 Toll Free 1-866-313-6300  
website: [www.hchealth.org](http://www.hchealth.org)

---

Penny E. Borenstein, M.D., M.P.H., Health Officer

October 25, 2004

Robert H. Learmouth  
14730 Triadelphia Mill Road  
Dayton, MD 21036

RE: 14730 Triadelphia Mill Road E:

Dear Mr. Learmouth;

We have received a variance requesting the required 20' setback to a foundation for a foundation to the septic easement at the above referenced property be waived to 10'. This agency will grant your **approval** for the variance at the property as long as no part of the foundation overhang is within 10' of the septic easement and post and pier footers are utilized.

Any questions regarding this decision may be directed to the Well and Septic Program of the Howard County Health Department.

Respectfully,

John A. Boris, Jr., R.S., Supervisor  
Well and Septic Program

cc: File



NO FT. DODGES WIRELESS  
COUNCILS TO TRIADOPHIA  
MILL ROAD

10/13/04  
Need to write a  
variance letter to set  
the 20' sep.  
to the pavement.  
- also need the  
type of foundation.  
KJB

☒ SHOWS THAT improvements are located as indicated within or on the perimeter of property

☐ There are no encroachments of existing improvements located on said land nor any assessment thereon nor onto any adjoining land

☐ There are no encroachments onto said land of existing improvements nor on adjoining land

*(Handwritten notes on graph paper)*

MILL  
2000  
1068  
10610  
106

LABOR AND DESIGN  
LOT 1 BUREAU SUBDIVISION  
PLAT NO. 7082

LOCATION SURVEY

10730 TOWADELLA ST. MILL RD  
HERNANDO COUNTY, FL 34424

SCALE

100%

DATE

7/22/1988

100.000

518795

NOTE: This Plan cannot be used to establish property held in common.

WYOMARK, CENTER  
MAIN STREET  
STERSTOWN, MD.  
-21136

