

3/30/04 4/8/04-noon
PUB. SEWER STATUS VERIFIED BY _____

ISSUE DATE: 3/25/04

APPROVAL DATE: 4/8/04

PERMIT

P 520117

A REPAIR

ON-SITE SEWAGE DISPOSAL SYSTEM HOWARD COUNTY HEALTH DEPARTMENT BUREAU OF ENVIRONMENTAL HEALTH

03-302946

Jack Fyock Septic Service

IS PERMITTED TO INSTALL ☐ ALTER ☒

ADDRESS: 13775 Triadelphia Rd., Glenelg

PHONE NUMBER: 410-988-9270

SUBDIVISION: Eagles Loft

LOT NUMBER: 27

ADDRESS: 13119 Williamfield Drive

PROPERTY OWNER: Richard Hoffman

SEPTIC TANK CAPACITY (GALLONS):

Ex 1250

PUMP CHAMBER CAPACITY (GALLONS):

N/A

NUMBER OF BEDROOMS:

4

SQUARE FEET PER BEDROOM:

210

LINEAR FEET OF TRENCH REQUIRED:

113'

TRENCHES:	Trench to be 2 feet wide. Inlet 4 feet below original grade. Bottom maximum depth 10 feet below original grade. Effective area begins at 4 feet below original grade. 6 feet of stone below distribution pipe.
LOCATION:	(2) 57' trenches on contour off D.W. w/ D.B.
PURPOSE:	Existing septic system has failed. Call for inspection when ground is opened so sanitarian can recommend repair.

PLANS APPROVED: 

DATE: 3/30/04

NOTE: PERMIT VOID AFTER 2 YEARS

NOTE: CONTRACTOR RESPONSIBLE FOR SCHEDULING A PRE-CONSTRUCTION INSPECTION FOR ALL INSTALLATIONS

NOTE: WATERTIGHT SEPTIC TANKS REQUIRED

NOTE: ALL PARTS OF SEPTIC SYSTEM SHALL BE 100 FEET FROM ANY WATER WELL

NOTE: MANHOLE RISERS REQUIRED ON ALL SEPTIC TANKS AND PUMP CHAMBERS

NEITHER THE HOWARD COUNTY COUNCIL OR THE HEALTH DEPARTMENT IS
RESPONSIBLE FOR THE SUCCESSFUL OPERATION OF ANY SYSTEM
PERMITTEE RESPONSIBLE FOR OBTAINING FINAL APPROVAL ON THIS PERMIT
CALL 410-313-2640 FOR INSPECTION OF SEPTIC SYSTEM

NOT TO SCALE

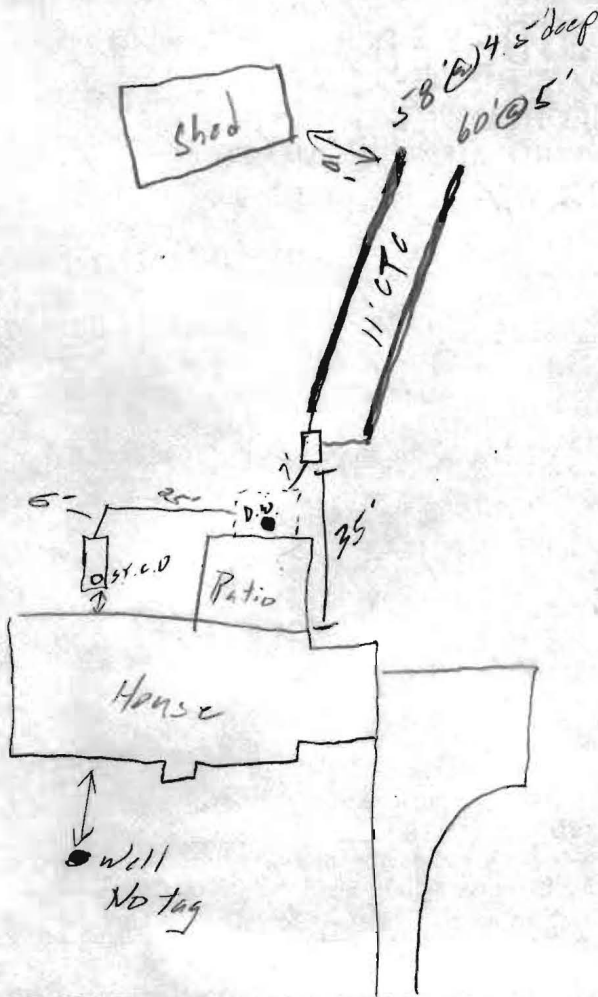

TRENCH/DRAINFIELD DATA		
WIDTH	INLET	BOTTOM
2	4.5/5	10/10.5
NUMBER OF TRENCHES		2
TOTAL LENGTH		118'
ABSORPTION AREA		
DISTRIBUTION BOX LEVEL		✓
DISTRIBUTION BOX BAFFLE		✓
DISTRIBUTION BOX PORT		

SEPTIC TANK DATA	
SEPTIC TANK 1 LEVEL	EX 1500
CAPACITY	GAL
SEAM LOC	
TANK LID DEPTH	
BAFFLES	
BAFFLE FILTER	
MANHOLE LOC	
6" PORT LOC	
WATERTIGHT TEST	
SEPTIC TANK 2 LEVEL	
CAPACITY	GAL
SEAM LOC	
TANK LID DEPTH	
BAFFLES	
BAFFLE FILTER	
MANHOLE LOC	
6" PORT LOC	
WATERTIGHT TEST	

PRE-CONSTRUCTION

3/30/04 - See prev sheet

INSTALLATION

4/8/04 - Invert on D.W. deeper than we thought. Trenches kept as high as possible. Lines from S.T. to D.W. replaced. D.W. to cover all work (SC)

FINAL INSPECTOR

[Signature]

DATE OF APPROVAL

4/8/04