

APPLICATION

A 22095

SEWAGE DISPOSAL TESTING

P _____

STATE OF MARYLAND - DEPARTMENT OF HEALTH AND MENTAL HYGIENE

HOWARD COUNTY HEALTH DEPARTMENT
ENVIRONMENTAL HEALTH SERVICES
P. O. BOX 478, ELLICOTT CITY, MARYLAND 21043
TELEPHONE: 469-5300, EXT. 398

DISTRICT 4th

DATE 9-1-75

TO: THE COUNTY HEALTH OFFICER
ELLICOTT CITY, MARYLAND

I, HEREBY, APPLY FOR THE NECESSARY TEST IN ORDER TO CONSTRUCT (OR RECONSTRUCT) A SEWAGE DISPOSAL SYSTEM.

PROPERTY OWNER JOHN WILLIAM & CORNELIA SCHULZE

ADDRESS 1685 ST MICHAEL'S RD PHONE 489-7072

PROPERTY LOCATION: West on I-70. Exit on Rt 94 about 2 miles property lies on left side of Rt 94

SUBDIVISION _____ LOT NO. _____

ROAD AND DESCRIPTION East side of Rt 94 with a 25ft fee simple, bordering the road leading to the Castello property adjoining the Castello property on the east side

SIZE OF LOT 5.69 ACRES TYPE R.D. 2 NUMBER OF BEDROOMS _____

IF NOT SINGLE RESIDENCE DESCRIBE _____

THE SYSTEM INSTALLED UNDER THIS APPLICATION IS ACCEPTABLE ONLY UNTIL PUBLIC FACILITIES BECOME AVAILABLE.

SIGNATURE OF APPLICANT John W. Schulz & Cornelia Schulz

APPROVED BY _____ FOR _____ DATE _____
(KIND OF SYSTEM)

REJECTED BY _____ FOR _____ DATE _____
(KIND OF SYSTEM)

HOLD PENDING FURTHER TESTS _____ DATE _____

REASONS FOR REJECTION OR HOLDING _____

THIS IS NOT A PERMIT

22098

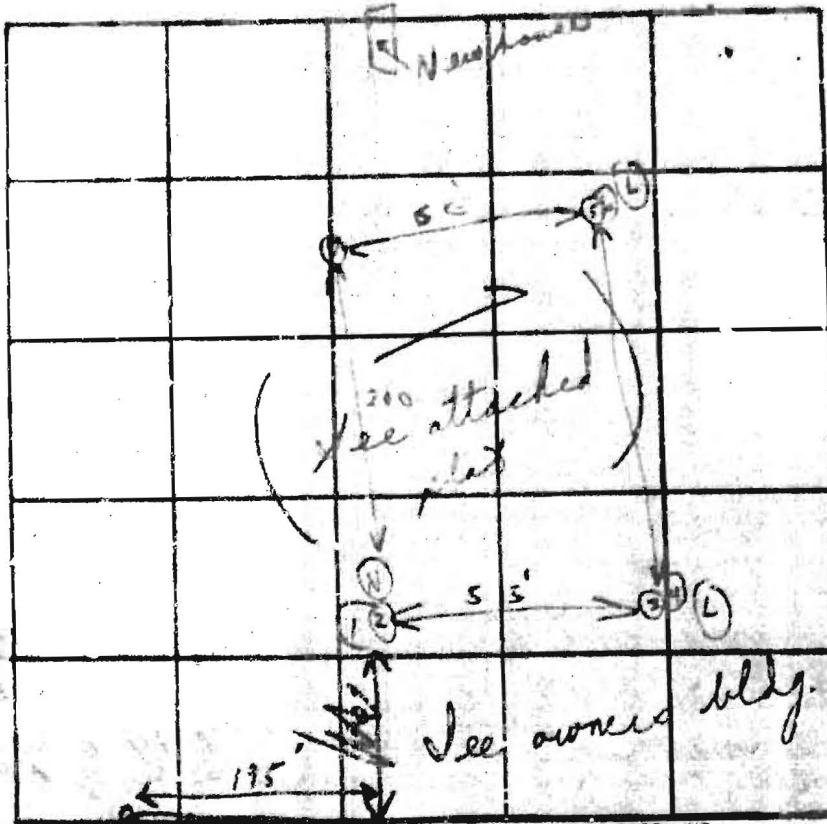

Schultz
persons with holes located

INDICATE NORTH - NAME ADJOINING ROADWAY AS BASE LINE

DATE	TEST NO.	DEPTH	PRE-WET		TEST - 1" PROP		T-5
			START	STOP	START	STOP	
4/30/25	1	4 1/2'	2:33	2:38	2:38	2:45	9m
	④ 2	12'	2:33	2:27	2:39	2:50	11m
	3	4 1/2'	2:36	2:40	2:40	2:49	9m
	② 4	12 1/2'	2:37	2:40	2:40	2:46	6m
	5	5'	2:51	3:01	3:01	3:29	28m
	⑥ 6	12 1/2'	2:52	2:55	2:55	3:01	6m
	⑦ 7	11 1/2'	Vertical		similar to 7m		

28
37
6:07/12m

REMARKS

TYPE OF SOIL

(granular below clay)

TESTED BY

C.R.S.

ALSO PRESENT

Leck + G

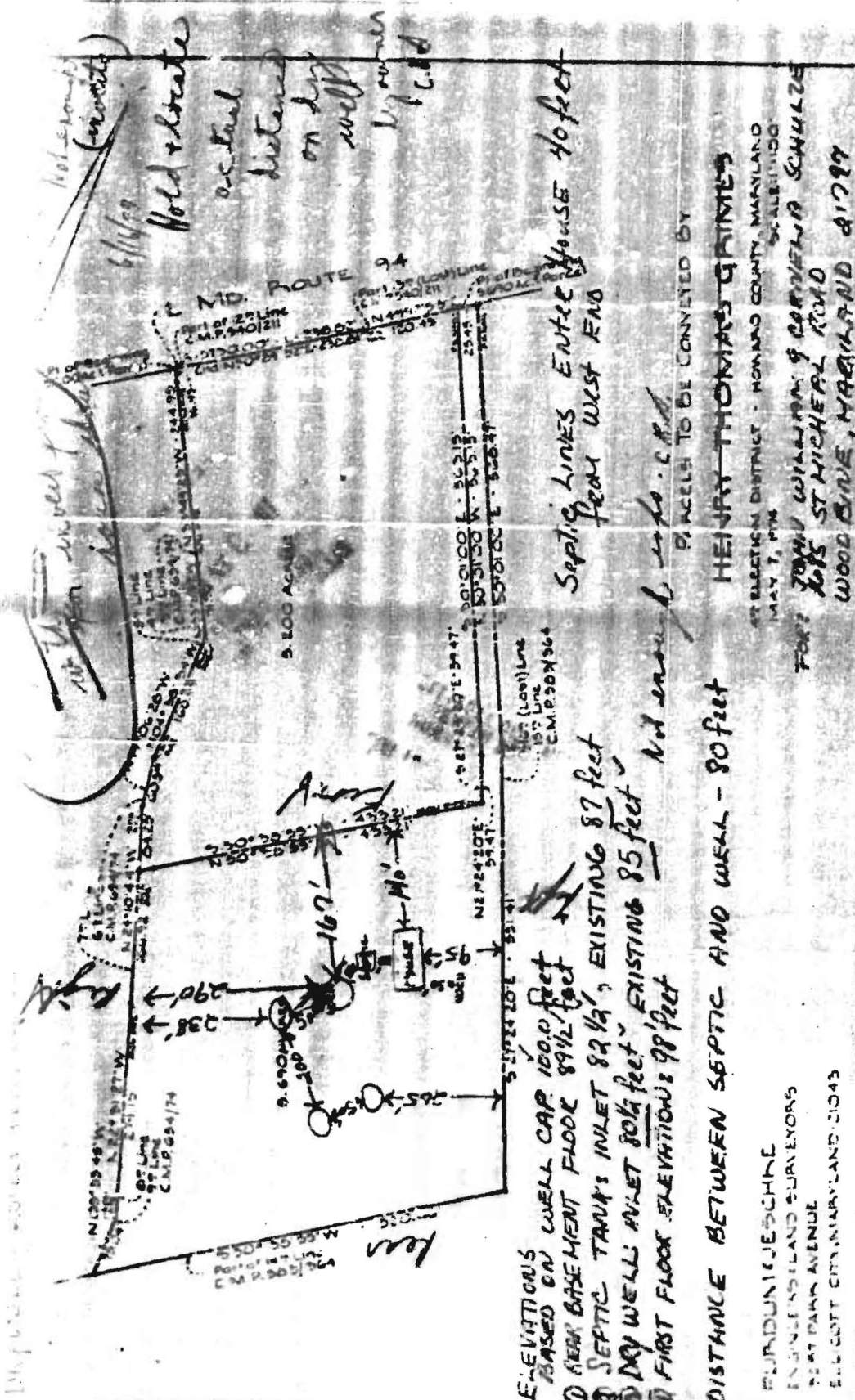

86020

ELEVATIONS
BASED ON WELL CAP 100.0 feet
① NEAR BASEMENT FLOOR 89 1/2 feet
② SEPTIC TANK'S INLET 82 1/2 feet, EXISTING 87 feet
③ DRY WELL'S INLET 80 1/2 feet, EXISTING 85 feet
④ FIRST FLOOR ELEVATION: 98 feet

DISTANCE BETWEEN SEPTIC AND WELL - 80 feet

BURDUNICKESCHKE
ENGINEERS AND SURVEYORS
25 EAST PARK AVENUE
ELLICOTT CITY, MARYLAND 21043

WHEN PERX TEST WAS MADE THE MEASUREMENTS FOR HOLDS WERE
TAKEN FROM WRONG BOUNDARIES — location per statement

② ACTUAL well measurements

6-10-77 *Sumner*

PLACELS TO BE CONVEYED BY
~~HENRY THOMAS GRIMES~~
ELECTION DISTRICT - HOWARD COUNTY, MARYLAND
MAY 7, PM
SCALE 1:100
FOR: JOHN WILLIAM & CORNELIA SCHULZE
205 ST MICHAEL ROAD
WOOD BURY, MARYLAND 21787

Hold + locate
0.5' actual distance on dry well
6/10/77

Septic LINES ENTER HOUSE 40 feet from west end

Not enough info. C.P.A.