



APPLICATION

FOR PERCOLATION TESTING AND SITE EVALUATION

TEST DATE(S) _____ TEST TIME _____

AP 522460

AGENCY REVIEW: _____

DATE 5/11/06

DO NOT WRITE ABOVE THIS LINE

I HEREBY APPLY FOR THE NECESSARY TESTING/EVALUATION PRIOR TO ISSUANCE OF SEWAGE DISPOSAL SYSTEM PERMIT(S) TO:

CHECK AS NEEDED:

- ☐ CONSTRUCT NEW SEPTIC SYSTEM(S)
☒ REPAIR/ADD TO AN EXISTING SEPTIC SYSTEM
☒ REPLACE AN EXISTING SEPTIC SYSTEM

CHECK AS NEEDED:

- ☐ NEW STRUCTURE(S)
☒ ADDITION TO AN EXISTING STRUCTURE
☐ REPLACE AN EXISTING STRUCTURE

CHECK ONE:

- ☐ CREATE NEW LOT(S)
☒ BUILD ON AN EXISTING LOT IN A SUBDIVISION
☐ BUILD ON AN EXISTING PARCEL OF RECORD

IS THE PROPERTY WITHIN 2500' OF ANY RESERVOIR?

- ☐ YES
☒ NO

THE TYPE OF STRUCTURE IS:

- ☒ RESIDENTIAL WITH unknown PROPOSED BEDROOMS IN THE COMPLETED STRUCTURE (NOTE UNKNOWN IF APPROPRIATE)
☐ COMMERCIAL (PROVIDE DETAIL OF NUMBERS AND TYPES OF EMPLOYEES/ CUSTOMERS ON ACCOMPANYING PLAN)
☐ INSTITUTIONAL/GOVERNMENT (PROVIDE DETAIL OF NUMBERS AND TYPES OF EMPLOYEES/USERS ON ACCOMPANYING PLAN)

PROPERTY OWNER(S) Bill Marcinick

DAYTIME PHONE _____ CELL _____ FAX _____

MAILING ADDRESS 13132 Williamfield Dr Ellicott City MD
STREET CITY/TOWN STATE ZIP

APPLICANT Ronnie Heaps (JM Contracting) LLC

DAYTIME PHONE (443) 277-7526 CELL ← FAX _____

MAILING ADDRESS 425 OBracht Rd Sykesville MD 21784
STREET CITY/TOWN STATE ZIP

APPLICANT'S ROLE: DEVELOPER Septic Contractor BUILDER BUYER RELATIVE/FRIEND REALTOR CONSULTANT

PROPERTY LOCATION Eagles Left
SUBDIVISION/PROPERTY NAME See Above 13132 Williamfield LOT NO. 24

PROPERTY ADDRESS 13132 Williamfield Dr Ellicott City 21042
STREET TOWN/POST OFFICE

TAX MAP PAGE(S) _____ GRID _____ PARCEL(S) _____ PROPOSED LOT SIZE _____

AS APPLICANT, I UNDERSTAND THE FOLLOWING: THE SYSTEM INSTALLED SUBSEQUENT TO THIS APPLICATION IS ACCEPTABLE ONLY UNTIL PUBLIC SEWERAGE IS AVAILABLE. THIS APPLICATION IS COMPLETE WHEN ALL APPLICABLE FEES AND A SUITABLE SITE PLAN HAVE BEEN RECEIVED. I ACCEPT THE RESPONSIBILITY FOR COMPLIANCE WITH ALL M.O.S.H.A. AND "MISS UTILITY" REQUIREMENTS. APPROVAL IS BASED UPON SATISFACTORY REVIEW OF A PERC CERTIFICATION PLAN.

TEST RESULTS WILL BE MAILED TO APPLICANT.

SIGNATURE OF APPLICANT

HOWARD COUNTY HEALTH DEPARTMENT, BUREAU OF ENVIRONMENTAL HEALTH, WELL AND SEPTIC PROGRAM
7178 COLUMBIA GATEWAY DRIVE COLUMBIA, MARYLAND 21046 (410) 313-2640 FAX (410) 313-2648
TDD (410) 313-2323 TOLL FREE 1-877-4MD-DHMH

①
0' Orange Brown
SaCl
3' Yellow Brown
Salm
w/veins
of Biotite
< 20%
8' Orange Brown
Salm
Very micac.
Fine grained
< 10%
Biotite or
weathered
Mico
13' 35% Very weak
Saprolite

②
1' Topsoil
3' Orange
SaCl
Brown
Fine
grained
Salm
Very Micac.

③
0' Orange Brown
2' Red Orange
SaCl 20%
Cobbly Rx
4.5' Micaceous
Orange
Silm
9' Yellow Brown
micac.
Salm
25%
Very weak
Saprolite
12'

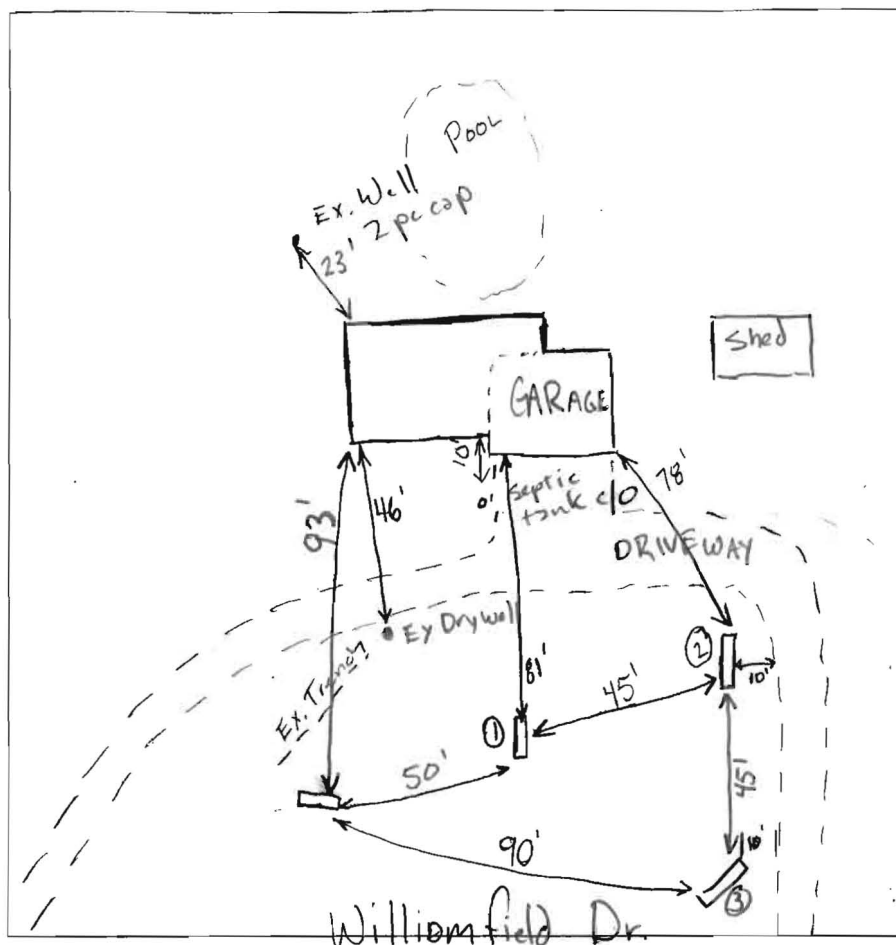

④
Brown/Red
SaCl
3' Yellow
SaCl
5' Red
Very micac.
Silm
12'

DATE	TEST #	DEPTH	START	BREAK 1" DROP	STOP 2" DROP	TIME OF 2ND INCH	P/F/H
5/18/06	①	4.5'/13'	11:56	11:56	11:59	2 1/2 m	P
	②	4'/12'	12:09:50	12:10:40	12:11:30	—	Repair
	Re ② Pour	4'/12'	12:13:00	12:14:00	12:16:05	4th in 2m	P
	③	5'/12'	12:19:25	12:22:40	12:27:20	5m ⁺	P
	④	4'/11.5'	12:31:11	12:32:10	12:33:30	—	Repair
	④ Repair	4'/12'	12:35	12:37:05		3rd in 2m	P

REMARKS - Consistently good at inconsistent depths
 SANITARIAN GAC BACKHOE Ronnie Hays OTHERS Homeowner, Chris
 TEST HOLES USED IN SDA 1, 2, 3, 4 AVG. PERC TIME 2-7 m SQ. FT/BR 180
 TRENCH WIDTH 3 INLET DEPTH 4 MAX. BOT DEPTH 8 EFFECTIVE SW 3 1/2'
 $5 \times 180 = 900 / 3 = 300 \times .45 = 135'$ of trench
 Add 1 500 gallons

