

C1 3844

SEQUENCE NO. (MDE USE ONLY)

STATE OF MARYLAND WELL COMPLETION REPORT

THIS REPORT MUST BE SUBMITTED WITHIN 45 DAYS AFTER WELL IS COMPLETED.

COUNTY NUMBER A513272-B

(THIS NUMBER IS TO BE PUNCHED IN COLS. 3-6 ON ALL CARDS)

DATE RECEIVED 09/15/03

DATE WELL COMPLETED 9/10/03

DEPTH OF WELL 70 (TO NEAREST FOOT)

PERMIT NO. FROM "PERMIT TO DRILL WELL" 40-94-3787

OWNER Shakoorzadeh Kamdin STREET OR RFD Brighton Dam TOWN Clarksville SUBDIVISION Shakoorzadeh Prop SECTION LOT 2

WELL LOG Not required for driven wells

STATE THE KIND OF FORMATIONS PENETRATED, THEIR COLOR, DEPTH, THICKNESS AND IF WATER BEARING

Table with columns: DESCRIPTION, FEET (FROM, TO), check if water bearing. Rows: SAND 0-60, Grey Mica 60-70.

GROUTING RECORD yes no

WELL HAS BEEN GROUTED (Circle Appropriate Box) Y N

TYPE OF GROUTING MATERIAL (Circle one) CEMENT BENTONITE CLAY

NO. OF BAGS 15 NO. OF POUNDS 42.50

GALLONS OF WATER 270

DEPTH OF GROUT SEAL (to nearest foot) from 0 ft. to 60 ft.

CASING RECORD casing types insert appropriate code below

ST STEEL CO CONCRETE PL PLASTIC OT OTHER

MAIN CASING TYPE Nominal diameter top (main) casing (nearest inch)! Total depth of main casing (nearest foot)

OTHER CASING (if used) diameter inch depth (feet) from to

SCREEN RECORD screen type or open hole

ST STEEL BR BRASS PL PLASTIC HO OPEN HOLE OT OTHER

NUMBER OF UNSUCCESSFUL WELLS: 0

WELL HYDROFRACTURED Y N

CIRCLE APPROPRIATE LETTER A WELL WAS ABANDONED AND SEALED WHEN THIS WELL WAS COMPLETED

I HEREBY CERTIFY THAT THIS WELL HAS BEEN CONSTRUCTED IN ACCORDANCE WITH COMAR 26.04.04 "WELL CONSTRUCTION" AND IN CONFORMANCE WITH ALL CONDITIONS STATED IN THE ABOVE CAPTIONED PERMIT...

DRILLERS LIC. NO. 1 M S D 0 2 4 DRILLERS SIGNATURE

LIC. NO. 1 D

SITE SUPERVISOR (sign. of driller or journeyman responsible for sitework if different from permittee)

DEPTH (nearest ft.)

Table with columns: E A C H S R E E N, 1-3, DIAMETER OF SCREEN (NEAREST INCH) 56 60

GRAVEL PACK IF WELL DRILLED WAS FLOWING WELL INSERT F IN BOX 68

MDE USE ONLY (NOT TO BE FILLED IN BY DRILLER) T (E.R.O.S.) W Q

C 3

PUMPING TEST

HOURS PUMPED (nearest hour) 3

PUMPING RATE (gal. per min.) 15

METHOD USED TO MEASURE PUMPING RATE bucket

WATER LEVEL (distance from land surface)

BEFORE PUMPING 10 ft.

WHEN PUMPING 49 ft.

TYPE OF PUMP USED (for test)

A air P piston T turbine C centrifugal R rotary O other J jet S submersible

PUMP INSTALLED

DRILLER INSTALLED PUMP (CIRCLE) (YES or NO) YES NO

IF DRILLER INSTALLS PUMP, THIS SECTION MUST BE COMPLETED FOR ALL WELLS.

TYPE OF PUMP INSTALLED PLACE (A,C,J,P,R,S,T,O) IN BOX 29

CAPACITY: GALLONS PER MINUTE (to nearest gallon) 31 35

PUMP HORSE POWER 37 41

PUMP COLUMN LENGTH (nearest ft.) 43 47

CASING HEIGHT (circle appropriate box and enter casing height)

LAND SURFACE (nearest foot) 2

LOCATION OF WELL ON LOT SHOW PERMANENT STRUCTURE SUCH AS BUILDING, SEPTIC TANKS, AND/OR LANDMARKS AND INDICATE NOT LESS THAN TWO DISTANCES (MEASUREMENTS TO WELL)

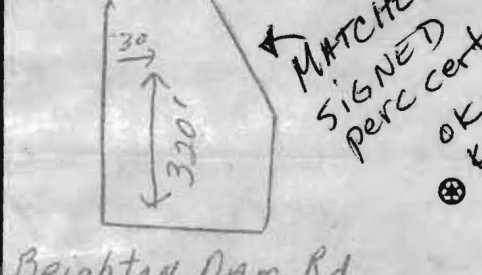

B 1 2207

SEQUENCE NO. (MDE USE ONLY)

STATE OF MARYLAND APPLICATION FOR PERMIT TO DRILL WELL

STATE PERMIT NUMBER

40-94-3787

519 075

please type

fill in this form completely

Date Received (APA)

080503

OWNER INFORMATION

Shakoorzadeh Kamdin, 12970 Brighton Dam Rd, Clarksville Md 21039

LOCATION OF WELL

Howard County, Shakoorzadeh Property, Clarksville, 2 miles from town

DRILLER INFORMATION

Joseph E. Wayne, MS Do 24, Joseph E. Wayne Well Drilling, 5512 Ridge Rd Mt Airy Md 21777, 8/1/03

DIRECTION OF WELL FROM TOWN (CIRCLE BOX)

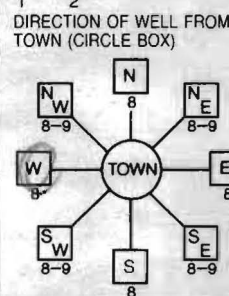

Brighton Dam Rd

ON WHICH SIDE OF ROAD (CIRCLE APPROPRIATE BOX)

400 FT

DISTANCE FROM ROAD

TAX MAP: 34 BLK: 10 PARCEL 14

WELL INFORMATION

APPROX. PUMPING RATE 4 GAL. PER MIN., AVERAGE DAILY QUANTITY NEEDED 500 GAL. PER DAY

USE FOR WATER (CIRCLE APPROPRIATE BOX)

- Domestic Potable Supply & Residential Irrigation, Farming, Industrial, Commercial, Dewatering, Public Water Supply Well, Test, Observation, Monitoring, Geo-thermal

NOT TO BE FILLED IN BY DRILLER HEALTH DEPARTMENT APPROVAL

Howard County, Mark E. Riffin, 8/28/04, North Grid 499, East Grid 0810

APPROXIMATE DEPTH OF WELL 300 FEET

APPROXIMATE DIAMETER OF WELL 6 INCH

METHOD OF DRILLING (circle one)

- Bored (or Augered), Jetted, Jetted & Driven, Air-Rotary, Air-PerCussion, Rotary (Hydraulic Rotary), Cable, Reverse-Rotary, Drive-Point

REPLACEMENT OR DEEPEMED WELLS (CIRCLE APPROPRIATE BOX)

- This well will not replace an existing well, This well will replace a well that will be abandoned and sealed, This well will replace a well that will be used as a standby-contact local approving authority for policy on standby wells, This well will deepen an existing well

PERMIT NUMBER OF WELL TO BE REPLACED OR DEEPEMED (IF AVAILABLE)

Not to be filled in by driller (MDE OR COUNTY USE ONLY)

APPROX. PERMIT NUMBER G, PERMIT No. 40-94-3787

SPECIAL CONDITIONS

NOTE - APPROVING AUTHORITIES SHOULD USE SEPARATE SHEET IF NEEDED

SHOW MAJOR FEATURES OF BOX & LOCATE WELL WITH AN X, SOURCES OF DRILLING WATER

WRITE THE BOX NUMBER FROM THE MAP HERE, E 810, N 49x9

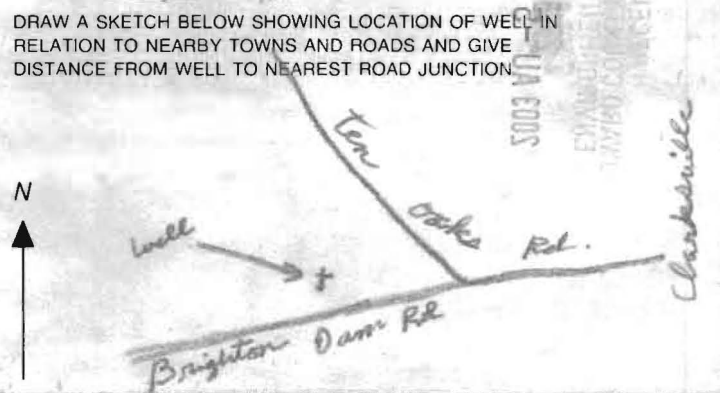

HOWARD COUNTY HEALTH DEPARTMENT  
PUBLIC HEALTH DIVISION  
WATER AND WASTE PROGRAMS  
P.O. BOX 113 2448 FAX: (410) 313-2434

For your information, the following is a list of the Well Point, Filter, Adapter, and Connections...

NOTE: The installer is responsible for requesting an inspection prior to placement of the device and inspection. No work shall be covered until approved by the Health Department. All installations must comply with the National Standard Plumbing Code (NSPC) as amended locally and COMAR 26.04.04 MD Well Construction Regulations. Submittal of a complete form is required prior to list and installation approval.

Custom Ply & Htg Co  
6482 Grohman Drive  
Blacksburg Md 21025  
410.796.8358

Michael Ormiston 8444

Kandis Shakeradeh  
Shakeradeh  
12982 Brighton Dam Road  
Clarksville Md 21029  
301.286.6008  
94 3787

Goulds 10  
15  
Markman B107  
36

Roll 160  
26

Michael Ormiston 3/15/06

8/23/05  
O.K.  
BB





## HOWARD COUNTY HEALTH DEPARTMENT

Bureau of Environmental Health  
7178 Columbia Gateway Drive, Columbia Maryland 21046  
(410) 313-2640 FAX (410) 313-2648  
TDD (410) 313-2323 Toll Free 1-877-4MD-DHMH

*Penny E. Borenstein, M.D., M.P.H., County Health Officer*  
September 11, 2006

Kamden Shakoorzadeh  
12970 Brighton Dam Road  
Clarksville, MD 21029

**SENT VIA FACSIMILE 410-472-4789**

RE: Shakoorzadeh Property, Lot 2  
12982 Brighton Dam Road  
Clarksville, MD 21029  
BP #: B00144561  
Well Permit # HO-94-3787

Dear Sir:

This is to advise you that the septic system for the above referenced property has been installed and inspected. **Final approval of the septic system was granted on 06/09/2006. Final approval of the well line connection to the dwelling was approved on 08/23/2005.**

The water sample results indicate that the water samples submitted for testing were free of coliform and fecal coliform bacteria at the time of sampling and are bacteriologically safe for drinking. The water sample results were found to be in compliance with COMAR water quality standards.

### INTERIM CERTIFICATE OF POTABILITY

This certifies that the initial sampling requirements of COMAR 26.04.04 "Well Regulations" have been met for the water supply system installed under well permit #HO-94-3787. Although the submitted sample results are in compliance with COMAR standards, the Health Department does not guarantee water supplies. Based upon satisfactory investigation and evaluation, the Howard County Health Department as authorized by the Maryland Department of the Environment accepts this well system as required by COMAR 26.04.04.

This certificate may become final upon completion of the second bacteriological test, which is to be taken by the county health department within six months of receipt of this letter. **Please contact (410) 313-1773 to schedule a final water sample appointment. Currently, there is no charge for this final sampling.**

Date of Water Samples: 12/27/2005 & 09/01/2006  
Date of Well Completion: 09/10/2003

Approving Authority,

*Brian Baker*

Brian Baker, R. S.  
Well & Septic Program

cc: Building Inspector's Office  
Community Health Services  
File

**FOUNTAIN VALLEY ANALYTICAL LABORATORY, INC.**  
 1413 Old Taneytown Rd. Westminster, MD (410) 848-1014 (410) 876-4554 FAX (410) 848-0298

**REPORT OF ANALYSIS**

Laboratory ID #:	60461	Account #:	7426
Reference:	Kandin Shakoorzadeh	Company:	CASH ACCOUNT
Location:	12982 Brighton Dam Road Clarksville, MD 21029	Requested By:	Kandin Shakoorzadeh
Date/ Time Collected:	9/1/2006 1158	Source:	Well Water
Date/Time Rec'd:	9/1/2006 1253	Site:	Pressure Tank
Chlorine ppm:	Free: ND Total: ND	Treatment:	Sediment Filter**
Collected By:	J.Yeager 6176JY	pH:	6.0
		Well #:	HO-94-3787

PARAMETERS	RESULTS	UNITS	REFERENCE	METHOD	DATE/TIME/ANALYST
Turbidity	0.81	NTU	<10	SM18 2130B	9/1/2006 / 1330 / GN

**NOTES:**

- 1 \*\*Sample collected prior to treatment
- 2 NTU = Nephelometric Turbidity Units
- 3 Results less than or within the reference range are considered satisfactory and within potable water limits at the time of sampling.
- 4 ND:None Detected
- 5 Visual well check: Scaled, vented cap
- 6 pH tested on-site

Reason for Test : Use & Occupancy retest 57574  
 Building Permit # : B00144561

Date Reported: 9/5/2006

**FOUNTAIN VALLEY ANALYTICAL LABORATORY, INC.**  
 1413 Old Taneytown Rd. Westminster, MD (410) 848-1014 (410) 876-4553 FAX (410) 848-0298

**REPORT OF ANALYSIS**

Laboratory ID #:	57574	Account #:	7426
Reference:	Kandin Shakoorzadeh	Company:	CASH ACCOUNT
Location:	12982 Brighton Dam Road Clarksville, MD 21029	Requested By:	Kandin Shakoorzadeh
Date/ Time Collected:	12/27/2005 1025	Source:	Well Water
Date/Time Rec'd:	12/27/2005 1246	Site:	Pressure Tank
Chlorine ppm:	Free: ND Total: ND	Treatment:	None
Collected By:	J.Yeager 6176JY	pH:	6.1
		Well #:	HO-94-3787

PARAMETERS	RESULTS	UNITS	REFERENCE	METHOD	DATE/TIME/ANALYST
Bacteria, Coliform, Total, MPN	<1.0	MPN/ 100 ml	<1.0	SM18 9223 B.	12/28/2005 / 0800 / BCD
Bacteria, E. coli, MPN	<1.0	MPN/ 100 ml	<1.0	SM18 9223 B.	12/28/2005 / 0800 / BCD
Nitrate	<1.0	mg/L	10	601	12/28/2005 / 0820 / BCD
Turbidity	127	NTU	<10	SM18 2130B	12/28/2005 / 0818 / BCD
Sand	NS	mg/L	5	Visual/Gravimetric	12/28/2005 / 0818 / BCD

**NOTES:**

- 1 mg/L = milligrams per liter (also, parts per million)
- 2 MPN/ 100 ml = Most Probable Number [of viable bacteria] per 100 ml of sample.
- 3 NS = None Seen (NS indicates less than 5 mg/L)
- 4 NTU = Nephelometric Turbidity Units
- 5 Results less than or within the reference range are considered satisfactory and within potable water limits at the time of sampling.
- 6 ND:None Detected
- 7 Visual well check: Sealed, vented cap
- 8 pH tested on-site

Reason for Test : Use & Occupancy  
 Building Permit # : B00144561

Date Reported: 12/28/2005

Laboratory Director:

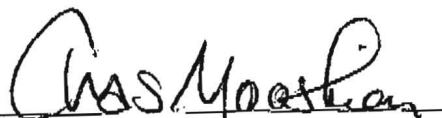

Charles Mooshian, B.S., M.T.