

LAYOUT _____

INSP 1 _____ INSP 3 _____

INSP 2 _____ INSP 4 _____

ISSUE DATE: 9/12/06

P 52554-C

APPROVAL
DATE:

10/3/06

PERMIT

INDEXED

A _____

TAXID # 03-348199

**COMMUNITY SEPTIC SYSTEM
COMMUNITY CENTER SEWER LINE CONNECTION**

**HOWARD COUNTY HEALTH DEPARTMENT
BUREAU OF ENVIRONMENTAL HEALTH**

Ryan Homes - Adam Bennett IS PERMITTED TO INSTALL ALTER

ADDRESS: 6085 Marshalee Drive PHONE NUMBER: 410-796-0980

SUBDIVISION Homeland Unit # 28

ADDRESS: 12087 Windsor Moss PROPERTY OWNER: NVR. Inc. t/a Ryan Homes

**COMMUNITY BUILDING SERVED BY A COMMUNITY SEPTIC SYSTEM & PUBLIC
WATER SUPPLY.**

LOCATION:	Install 4" house sewer line connection per the approved site plan. Final acceptance of the sewer system will be subject to the approval of the Maryland Dept. of the Environment.
NOTES:	This permit is limited to the installation of the individual house sewer line connection.

PLANS APPROVED: Gabriel A. Creighton DATE: 8/11/06

PERMIT VOID AFTER 2 YEARS

1. CONTRACTOR IS RESPONSIBLE FOR SCHEDULING A PRE-CONSTRUCTION INSPECTION FOR ALL INSTALLATIONS.
2. ALL PARTS OF SEPTIC SYSTEM SHALL BE 100 FEET FROM ANY WATER WELL UNLESS SPECIFICALLY AUTHORIZED.
3. CONTRACTOR RESPONSIBLE FOR COMPLIANCE WITH APPLICABLE REGULATIONS, GUIDELINES AND THE TERMS OF THIS PERMIT.
4. NEITHER THE HOWARD COUNTY COUNCIL OR THE HEALTH DEPARTMENT IS RESPONSIBLE FOR THE SUCCESSFUL OPERATION OF ANY SYSTEM.
5. PERMITTEE RESPONSIBLE FOR OBTAINING FINAL APPROVAL ON THIS PERMIT.

CALL 410-313-1771 FOR INSPECTION OF SEPTIC CONNECTION

P 52554-C

NOT TO SCALE

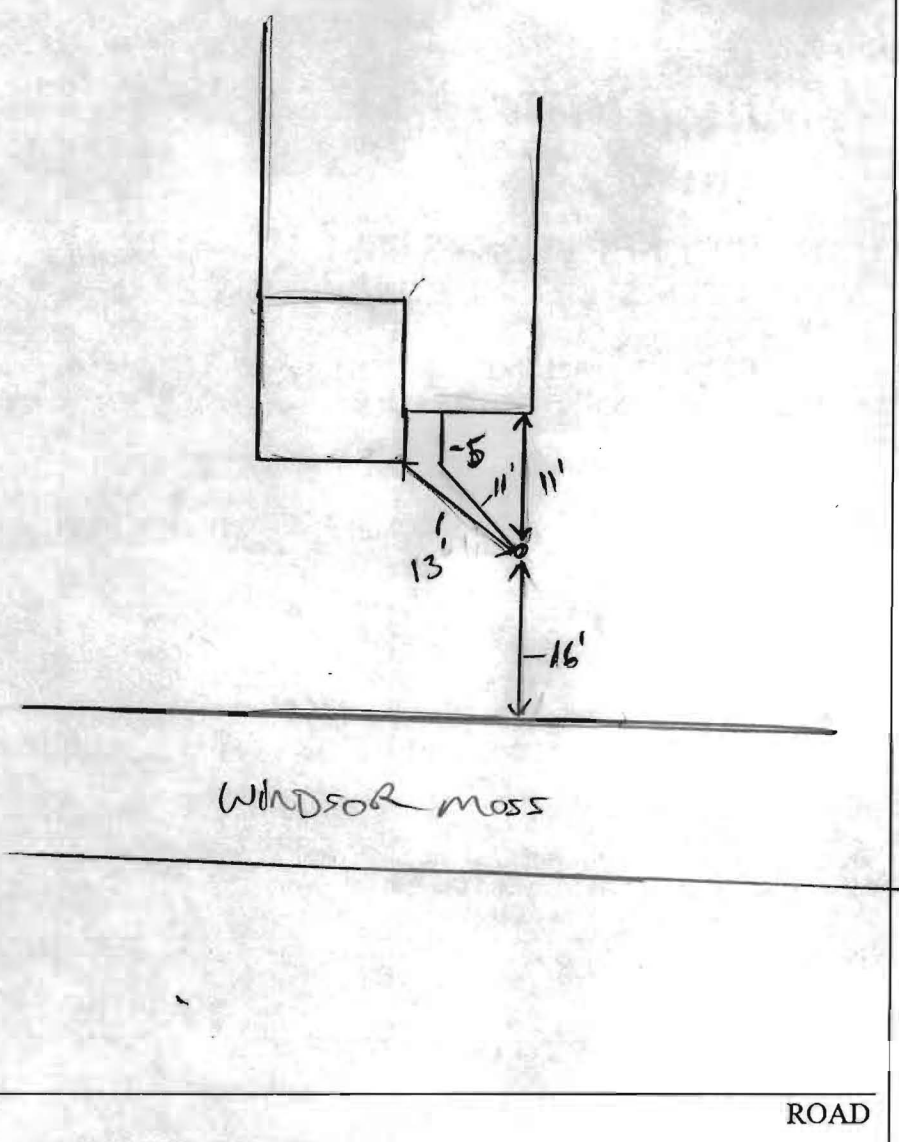

TRENCH/DRAINFIELD DATA

WIDTH _____ INLET _____ BOTTOM _____

NUMBER OF TRENCHES _____

TOTAL LENGTH _____

ABSORPTION AREA _____

DISTRIBUTION BOX LEVEL _____

DISTRIBUTION BOX BAFFLE _____

DISTRIBUTION BOX PORT _____

SEPTIC TANK DATA

SEPTIC TANK 1 LEVEL _____

CAPACITY _____ GAL

SEAM LOC _____

TANK LID DEPTH _____

BAFFLES _____

BAFFLE FILTER _____

MANHOLE LOC _____

6" PORT LOC _____

WATERTIGHT TEST _____

SEPTIC TANK 2 LEVEL _____

CAPACITY _____ GAL

SEAM LOC _____

TANK LID DEPTH _____

BAFFLES _____

BAFFLE FILTER _____

MANHOLE LOC _____

6" PORT LOC _____

WATERTIGHT TEST _____

PRE-CONSTRUCTION _____

INSTALLATION 10/31/06 system OK to backfill

FINAL INSPECTOR [Signature] DATE OF APPROVAL 10/31/06

Refer to sheets 6 & 11 for Curb Details.
 All offsets along Frederick Road are from the Existing \varnothing Road.
 Locations of Storm Drain Structures are Presented within the Structure Schedule Sheet 18.
 For \varnothing Road Curve Data, See Sheet 6.
 For Standard SDP Legend See Sheet 1.

8.) Min. Driveway width for attached units which share driveways =
 9.) \varnothing of all swales to be located 15' from unit "box".
 10.) I-5 and I-30 may require adjustment. As field location of MA line may be less than 25'. There shall be 25' min. between MA line and
 11.) See Sheet 21 for Md. Rte 144 Widening details.
 12.) Refer to Sheet 21 for MSHA Type "A" curb detail.

MATCHLINE SHEET 5

Public Water

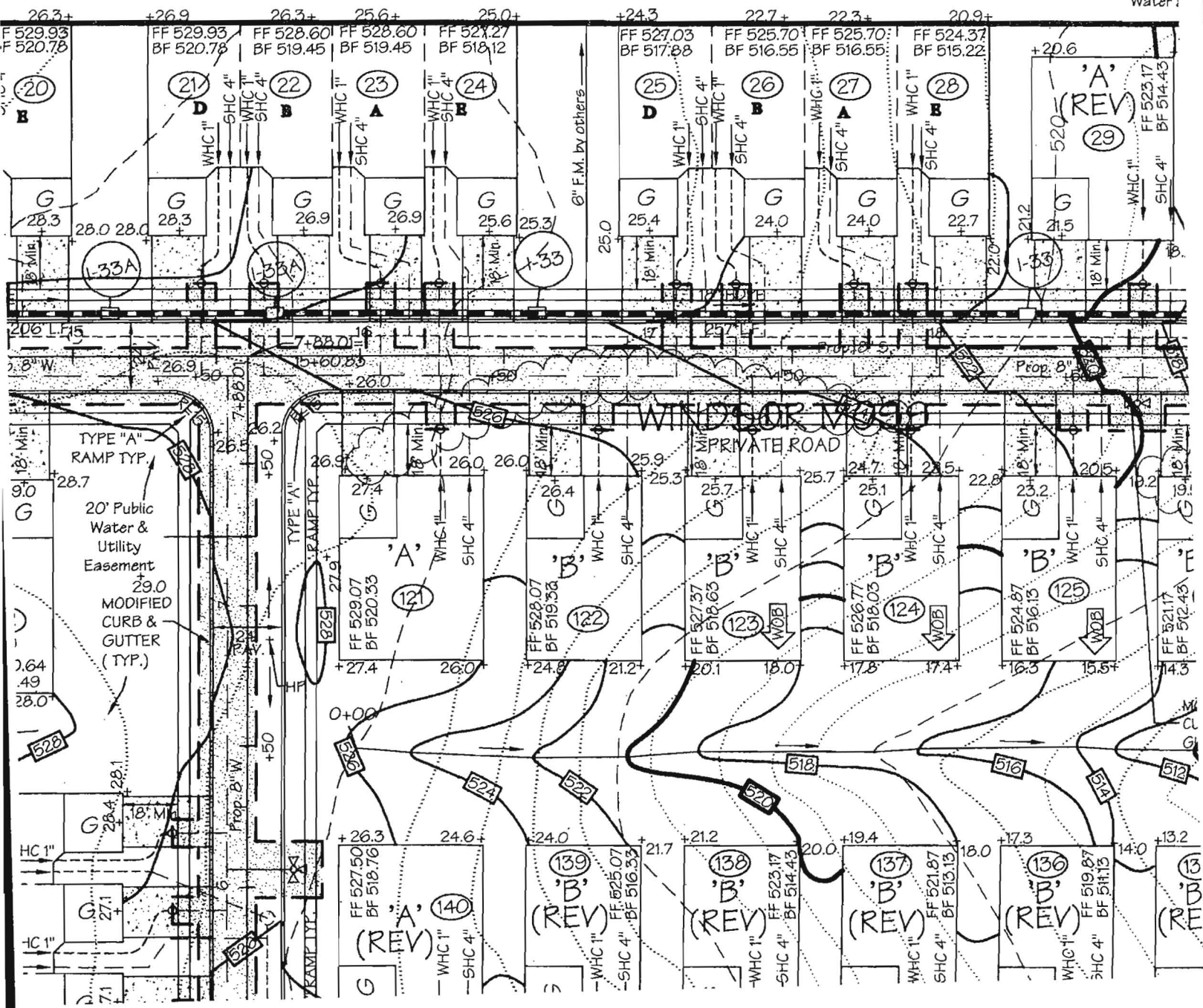

24D (28)

Lot _____ Block _____

Community Ellicott Meadows (EI)

BEDROOM RESTRICTION ACKNOWLEDGMENT
Hearthstone at Ellicott Meadows

The undersigned Purchaser has entered into a Purchase Agreement for the Property known as EI 24D (28) and located in the Ellicott Meadows Community (the "Property").

By signing below, Purchaser acknowledges they have been informed of and understand the following information relating to the Property:

The Hearthstone at Ellicott Meadows is served by a community private sewage disposal system which can only accommodate a maximum of two bedrooms per Unit. Howard County will enforce this restriction and will not issue any building permits for modifications to any Unit where the number of bedrooms will be increased beyond two.

ACKNOWLEDGED BY PURCHASER

Purchaser:

Peter Fitzpatrick

Purchaser's

Date:

7/2/06

12087 WINDSOR NESS



HOWARD COUNTY HEALTH DEPARTMENT

Bureau of Environmental Health
7178 Columbia Gateway Drive, Columbia MD 21046
(410) 313-2640 FAX (410) 313-2648
TDD (410) 313-2323 Toll Free 1-877-4MD-DHMH

Penny E. Borenstein, M.D., M.P.H., County Health Officer

01/19/2007

NVR Inc. t/a Ryan Homes
6085 Marshalee Drive, Suite 140
Elkridge, Maryland 21075

RE: Homeland, Lot 28
12087 Windsor Moss
Ellicott City, MD 21043
BP # B00159893
PUBLIC WATER

Dear Sirs or Madam:

This is to advise that the connection from the house to the street has been installed and inspected for the referenced property. A Community Septic System serves this dwelling. **Final approval was granted on 10/31/2006 by HCHD for the house connection.**

The property is served by public water and is therefore exempt from the Health Department water sampling requirements.

By issuance of this letter, this office recommends release of the Use and Occupancy permit for the referenced property.

RECOMMENDATION FOR USE AND OCCUPANCY

Respectfully,

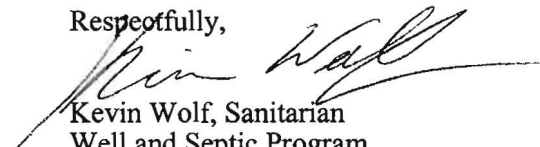

Kevin Wolf, Sanitarian
Well and Septic Program

cc: DILP, Building Inspectors Office
File