

LAYOUT _____

INSP 1 _____ INSP 3 _____

INSP 2 _____ INSP 4 _____

ISSUE DATE: 9/12/06

P 525553-B

APPROVAL
DATE: 11/1/06

PERMIT

INDEXED

A _____

TAX ID # _____

**COMMUNITY SEPTIC SYSTEM
COMMUNITY CENTER SEWER LINE CONNECTION**

**HOWARD COUNTY HEALTH DEPARTMENT
BUREAU OF ENVIRONMENTAL HEALTH**

Ryan Homes - Adam Bennett IS PERMITTED TO INSTALL ALTER

ADDRESS: 6085 Marshalee Drive PHONE NUMBER: 410-796-0980

SUBDIVISION Homeland Unit # 26

ADDRESS: 12083 Windsor Moss PROPERTY OWNER: NVR. Inc. t/a Ryan Homes

**COMMUNITY BUILDING SERVED BY A COMMUNITY SEPTIC SYSTEM & PUBLIC
WATER SUPPLY.**

LOCATION:	Install 4" house sewer line connection per the approved site plan. Final acceptance of the sewer system will be subject to the approval of the Maryland Dept. of the Environment.
NOTES:	This permit is limited to the installation of the individual house sewer line connection.

PLANS APPROVED: Gabriel A. Creighton DATE: 8/11/06

PERMIT VOID AFTER 2 YEARS

1. CONTRACTOR IS RESPONSIBLE FOR SCHEDULING A PRE-CONSTRUCTION INSPECTION FOR ALL INSTALLATIONS.
2. ALL PARTS OF SEPTIC SYSTEM SHALL BE 100 FEET FROM ANY WATER WELL UNLESS SPECIFICALLY AUTHORIZED.
3. CONTRACTOR RESPONSIBLE FOR COMPLIANCE WITH APPLICABLE REGULATIONS, GUIDELINES AND THE TERMS OF THIS PERMIT.
4. NEITHER THE HOWARD COUNTY COUNCIL OR THE HEALTH DEPARTMENT IS RESPONSIBLE FOR THE SUCCESSFUL OPERATION OF ANY SYSTEM.
5. PERMITTEE RESPONSIBLE FOR OBTAINING FINAL APPROVAL ON THIS PERMIT.

CALL 410-313-1771 FOR INSPECTION OF SEPTIC CONNECTION

0525553-B

NOT TO SCALE

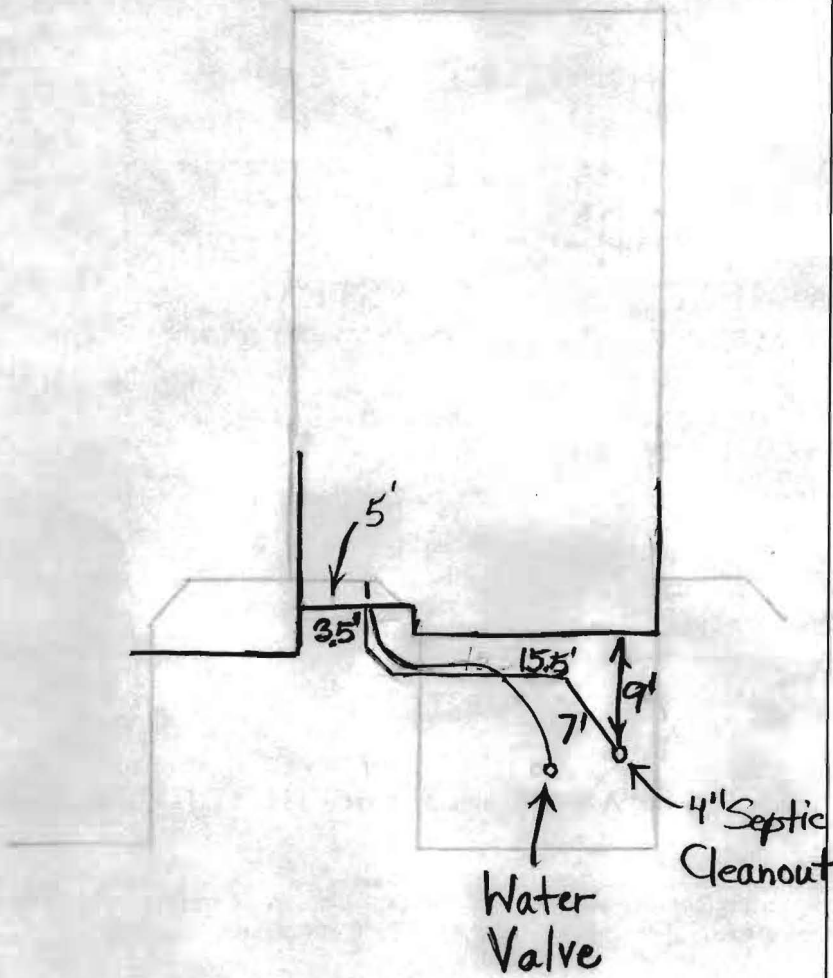

Windsor Moss

TRENCH/DRAINFIELD DATA

WIDTH	INLET	BOTTOM
_____	_____	_____
NUMBER OF TRENCHES _____		
TOTAL LENGTH _____		
ABSORPTION AREA _____		
DISTRIBUTION BOX LEVEL _____		
DISTRIBUTION BOX BAFFLE _____		
DISTRIBUTION BOX PORT _____		

SEPTIC TANK DATA

SEPTIC TANK 1 LEVEL _____

CAPACITY _____ GAL

SEAM LOC _____

TANK LID DEPTH _____

BAFFLES _____

BAFFLE FILTER _____

MANHOLE LOC _____

6" PORT LOC _____

WATERTIGHT TEST _____

SEPTIC TANK 2 LEVEL _____

CAPACITY _____ GAL

SEAM LOC _____

TANK LID DEPTH _____

BAFFLES _____

BAFFLE FILTER _____

MANHOLE LOC _____

6" PORT LOC _____

WATERTIGHT TEST _____

PRE-CONSTRUCTION 11/1/06

INSTALLATION 11/1/06 Septic and water hookups made, (BB)

FINAL INSPECTOR B. Baker DATE OF APPROVAL 11/1/06

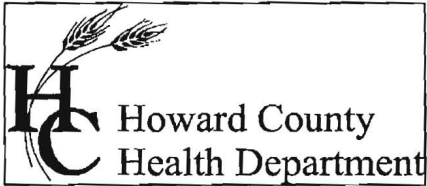

Bureau of Environmental Health
7178 Columbia Gateway Drive Columbia, Maryland 21046-2132
(410) 313-2640 Fax (410) 313-2648
TDD (410) 313-2323 Toll Free 1-866-313-6300
website: www.hchealth.org

Penny E. Borenstein, M.D., M.P.H., Health Officer

November 9, 2006

NVR, Inc./Ryan Homes
6085 Marshalee Drive, Suite 130
Elkridge, MD 21075

RE: Homeland, Lot 26
12083 Windsor Moss
Ellicott City, MD 21042
BP# B00159891
PUBLIC WATER

Dear Sir/Madam:

This is to advise you that the septic system for the above referenced property has been installed and inspected. **Final approval of the septic system was granted on 11/01/2006.**

The property is served by public water and is therefore exempt from the Health Department water sampling requirements.

By issuance of this letter, this office recommends release of the Use and Occupancy permit for the referenced property.

Approving Authority,

Stuart Oster, R. S.
Well & Septic Program

mlb
cc: Building Inspector's Office
File

Refer to Sheets 6 & 11 for Curb Details.

All offsets along Frederick Road are from the Existing C Road.

Locations of Storm Drain Structures are Presented within the Structure Schedule Sheet 18.

For C Road Curve Data, See Sheet 6.

For Standard SDP Legend See Sheet 1.

8.) Min. Driveway width for attached units which share driveways =

9.) C of all swales to be located 15' from unit "box".

10.) I-5 and I-30 may require adjustment. As field location of MA in may be less than 25'. There shall be 25' min. between MA:

11.) See Sheet 21 for Md. Rte 144 Widening details.

12.) Refer to Sheet 21 for MSHA Type "A" curb detail.

MATCHLINE SHEET 5

Public Water

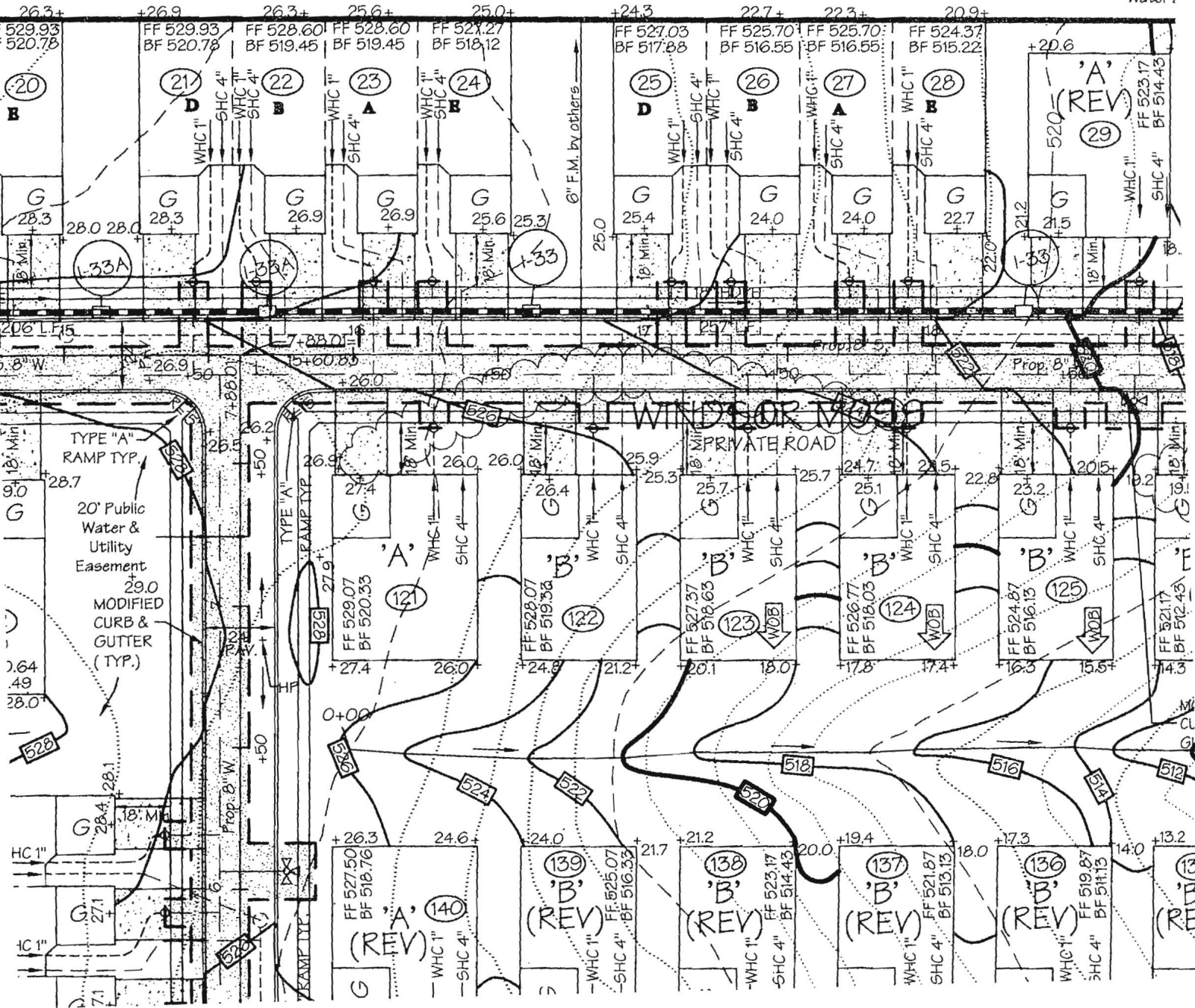

248 (25)

Lot _____ Block _____

Community Ellicott Meadows (EI)

BEDROOM RESTRICTION ACKNOWLEDGMENT
Hearthstone at Ellicott Meadows

The undersigned Purchaser has entered into a Purchase Agreement for the Property known as EI 248 (25) and located in the Ellicott Meadows Community (the "Property").

By signing below, Purchaser acknowledges they have been informed of and understand the following information relating to the Property:

The Hearthstone at Ellicott Meadows is served by a community private sewage disposal system which can only accommodate a maximum of two bedrooms per Unit. Howard County will enforce this restriction and will not issue any building permits for modifications to any Unit where the number of bedrooms will be increased beyond two.

ACKNOWLEDGED BY PURCHASER

Purchaser: [Signature]

Purchaser: _____

Date: 7/27/06

12083 WINDSOR NESS