

STATE OF MARYLAND

WATER RESOURCES ADMINISTRATION

TAWES STATE OFFICE BLDG., ANNAPOLIS, MARYLAND 21401

APPLICATION FOR PERMIT TO DRILL WELL

WRA PERMIT NUMBER

40-23-1634

FILL IN THIS FORM COMPLETELY

B 1 2375 SEQUENCE NO. (WRA USE ONLY) 1 2 3 (SEQ. NO.) 6 (THIS NUMBER IS TO BE PUNCHED IN COLS. 3-6 ON ALL CARDS)

DATE RECEIVED (WRA USE ONLY) OWNER SCOTT, ELIZABETH COL 15 LAST NAME FIRST NAME COL. 34 STREET OR RFD 6791 RT32 COL 36 COL. 55 POST OFFICE CLARKSVILLE, MD 21029 COL 57 COL. 76

B 1 CONTINUED DRILLER INFORMATION 1 2 3 (SEQ. NO.) 6 DATE AUGUST 19, 1976 LICENSE NUMBER 120 77 80 G. EDGAR HARRISONS' CORP FIRST NAME DRILLER LAST NAME SIGNATURE

B 3 LOCATION OF WELL 1 2 3 (SEQ. NO.) 6 COUNTY HOWARD (DO NOT ABBREVIATE COUNTY NAME) 21 SUBDIVISION 23 42 SECTION 44 46 LOT 48 50 NEAREST TOWN CLARKSVILLE 52 71 MILES FROM TOWN (ENTER 0 IF IN TOWN) 73 76 77 78

B 2 WELL INFORMATION 1 2 3 (SEQ. NO.) 6 MAXIMUM PUMPING RATE (GALLONS PER MINUTE) 5 8 12 AVERAGE DAILY QUANTITY NEEDED (GALLONS PER DAY) 750 14 20 USE FOR WATER (CIRCLE APPROPRIATE BOX) D HOME (SINGLE OR DOUBLE HOUSEHOLD UNIT ONLY) F FARMING, AGRICULTURE, IRRIGATION I INDUSTRIAL, COMMERCIAL, STATE AND FEDERAL GOVERNMENT. M MUNICIPAL WATER SUPPLY P PRIVATE WATER COMPANY T TEST MUST HAVE STATE HEALTH DEPT. APPROVAL

B 4 DIRECTION FROM TOWN (CIRCLE APPROPRIATE BOX) N NORTH E EAST NE NORTHEAST SE SOUTHEAST S SOUTH W WEST NW NORTHWEST SW SOUTHWEST NEAR WHAT ROAD 6485 TROTTER ROAD ON WHICH SIDE OF ROAD (CIRCLE APPROPRIATE BOX) N S E W DISTANCE FROM ROAD (ENTER DISTANCE AND CIRCLE APPROPRIATE BOX) 80 34 37 38 39

APPROXIMATE DEPTH OF WELL 150 FEET 24 26

APPROXIMATE DIAMETER OF WELL 6 (NEAREST INCH)

METHOD OF DRILLING USED (CIRCLE APPROPRIATE METHOD) BORED (OR AUGERED) JETTED DRIVEN 30-37 AIR-ROTARY AIR-PERCUSSION ROTARY (HYDRAULIC ROTARY) CABLE REVERSE-ROTARY DRIVE-POINT OTHER (DESCRIBE)

REPLACEMENT OR DEEPEMED WELLS (CIRCLE APPROPRIATE BOX) N THIS WELL WILL NOT REPLACE AN EXISTING WELL Y THIS WELL WILL REPLACE A WELL THAT WILL BE ABANDONED AND SEALED S THIS WELL WILL REPLACE A WELL THAT WILL BE USED AS A STANDBY D THIS WELL WILL DEEPEM AN EXISTING WELL PERMIT NUMBER OF WELL TO BE REPLACED OR DEEPEMED (IF AVAILABLE)

NOT TO BE FILLED IN BY DRILLER (WRA USE ONLY) APPROPRIATION PERMIT NUMBER ENGINEER REVIEW DISTRICT NO. FORCE WRITE INITIALS IN BOX CONDITIONS

B 4 CONTINUED HEALTH DEPARTMENT APPROVAL 1 2 3 (SEQ. NO.) 6 STATE HEALTH (CIRCLE BOX) COUNTY NAME COUNTY NO. DATE APPROVED BY

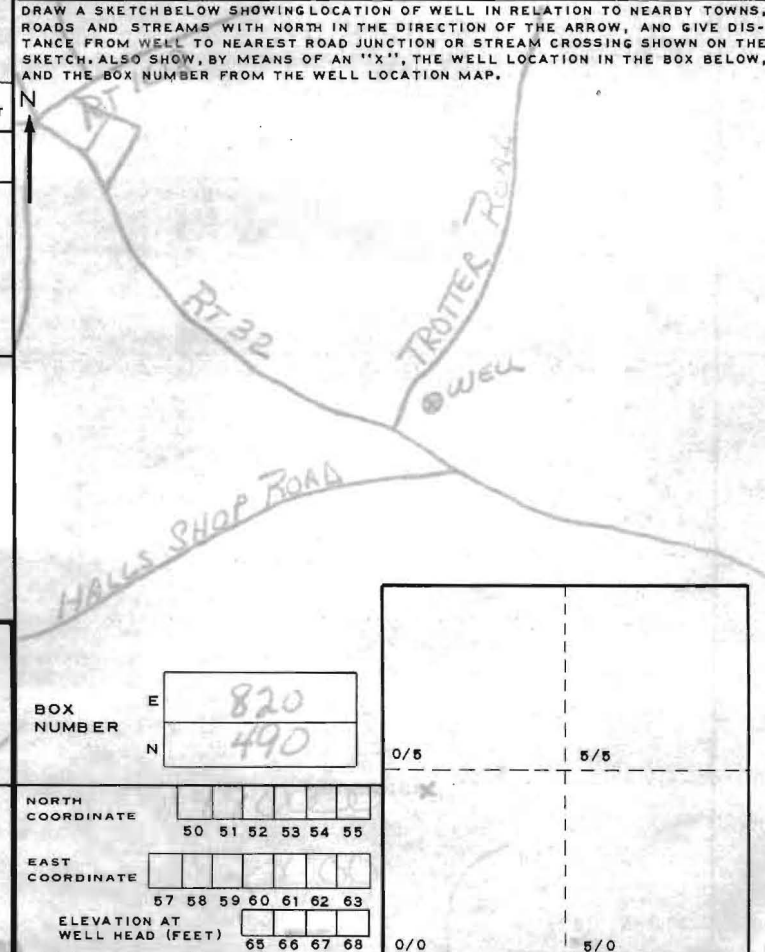

B 5 SPECIAL CONDITIONS 8-63 (WRA USE ONLY) 1 2 3 (SEQ. NO.) 6

531-7602

HEALTH

B 1

1 2 3 (SEQ. NO.) 6

(THIS NUMBER IS TO BE PUNCHED IN COLS. 3-6 ON ALL CARDS)

SEQUENCE NO. (WRA USE ONLY)

STATE OF MARYLAND  
 WATER RESOURCES ADMINISTRATION  
 TAWES STATE OFFICE BLDG., ANNAPOLIS, MARYLAND 21401  
 APPLICATION FOR PERMIT TO DRILL WELL

WRA PERMIT NUMBER

FILL IN THIS FORM COMPLETELY

DATE RECEIVED (WRA USE ONLY)

OWNER

COL 15 LAST NAME FIRST NAME COL. 34

STREET OR RFO COL 36 COL. 65

POST OFFICE COL 57 COL. 76

B 1 CONTINUED

1 2 3 (SEQ. NO.) 6

DRILLER INFORMATION

DATE LICENSE NUMBER 77 80

FIRST NAME DRILLER LAST NAME

SIGNATURE

B 3

1 2 3 (SEQ. NO.) 6

LOCATION OF WELL

COUNTY 8 (DO NOT ABBREVIATE COUNTY NAME) 21

SUBDIVISION 23 42

SECTION 44 46 LOT 48 50

NEAREST TOWN 52 71

MILES FROM TOWN (ENTER 0 IF IN TOWN) 73 76 77 78

B 2

1 2 3 (SEQ. NO.) 6

WELL INFORMATION

MAXIMUM PUMPING RATE (GALLONS PER MINUTE) 8 12

AVERAGE DAILY QUANTITY NEEDED (GALLONS PER DAY) 14 20

USE FOR WATER (CIRCLE APPROPRIATE BOX)

D HOME (SINGLE OR DOUBLE HOUSEHOLD UNIT ONLY)

F FARMING, AGRICULTURE, IRRIGATION

I INDUSTRIAL, COMMERCIAL, STATE AND FEDERAL GOVERNMENT.

M MUNICIPAL WATER SUPPLY

P PRIVATE WATER COMPANY } MUST HAVE STATE HEALTH DEPT. APPROVAL

T TEST

B 4

1 2 3 (SEQ. NO.) 6

DIRECTION FROM TOWN (CIRCLE APPROPRIATE BOX)

N NORTH  E EAST  NE NORTHEAST  SE SOUTHEAST

S SOUTH  W WEST  NW NORTHWEST  SW SOUTHWEST

NEAR WHAT ROAD 11 NORTH SOUTH EAST WEST 30

ON WHICH SIDE OF ROAD (CIRCLE APPROPRIATE BOX)  N  S  E  W

DISTANCE FROM ROAD (ENTER DISTANCE AND CIRCLE APPROPRIATE BOX) 34 37 38 39

APPROXIMATE DEPTH OF WELL 24 28 FEET

APPROXIMATE DIAMETER OF WELL (NEAREST INCH)

METHOD OF DRILLING USED (CIRCLE APPROPRIATE METHOD)

BORED (OR AUGERED)  JETTED  DRIVEN

30-37  AIR-ROTARY  AIR-PERCUSSION  ROTARY (HYDRAULIC ROTARY)

CABLE  REVERSE-ROTARY  DRIVE-POINT

OTHER (DESCRIBE)

REPLACEMENT OR DEEPEINED WELLS (CIRCLE APPROPRIATE BOX)

N THIS WELL WILL NOT REPLACE AN EXISTING WELL

Y THIS WELL WILL REPLACE A WELL THAT WILL BE ABANDONED AND SEALED

S THIS WELL WILL REPLACE A WELL THAT WILL BE USED AS A STANDBY

D THIS WELL WILL DEEPEIN AN EXISTING WELL PERMIT NUMBER OF WELL TO BE REPLACED OR DEEPEINED (IF AVAILABLE)

NOT TO BE FILLED IN BY DRILLER (WRA USE ONLY)

APPROPRIATION PERMIT NUMBER 54 ENGINEER REVIEW DISTRICT NO. 63 65

FORCE WRITE INITIALS IN BOX CONDITIONS A E N S G W Q C L U

67 68 70 71 72 73 74 75 76 77 78 79

B 4 CONTINUED

1 2 3 (SEQ. NO.) 6

HEALTH DEPARTMENT APPROVAL

41  S STATE HEALTH (CIRCLE BOX) COUNTY NAME COUNTY NO.

MO. DAY YR.

DATE APPROVED BY

43 48

DRAW A SKETCH BELOW SHOWING LOCATION OF WELL IN RELATION TO NEARBY TOWNS, ROADS AND STREAMS WITH NORTH IN THE DIRECTION OF THE ARROW, AND GIVE DISTANCE FROM WELL TO NEAREST ROAD JUNCTION OR STREAM CROSSING SHOWN ON THE SKETCH. ALSO SHOW, BY MEANS OF AN "X", THE WELL LOCATION IN THE BOX BELOW, AND THE BOX NUMBER FROM THE WELL LOCATION MAP.

BOX NUMBER

NORTH COORDINATE 50 51 52 53 54 55

EAST COORDINATE 57 58 59 60 61 62 63

ELEVATION AT WELL HEAD (FEET) 65 66 67 68

0/5 5/5

0/0 5/0

B 5

1 2 3 (SEQ. NO.) 6

SPECIAL CONDITIONS 8-63 (WRA USE ONLY)

SEQUENCE NO. (WRA USE ONLY)

1 2 3 (SEQ. NO.) 6

(THIS NUMBER IS TO BE PUNCHED IN COLS. 3-6 ON ALL CARDS)

**STATE OF MARYLAND**  
**WATER RESOURCES ADMINISTRATION**  
**TAWES STATE OFFICE BLDG., ANNAPOLIS, MARYLAND 21401**  
**APPLICATION FOR PERMIT TO DRILL WELL**

**WRA PERMIT NUMBER**

FILL IN THIS FORM COMPLETELY

DATE RECEIVED (WRA USE ONLY)

OWNER

COL 15 LAST NAME FIRST NAME COL. 34

STREET OR RFD

COL 36 COL. 55

POST OFFICE

COL 57 COL. 76

**DRILLER INFORMATION**

DATE LICENSE NUMBER 77 80

FIRST NAME DRILLER LAST NAME

SIGNATURE

**LOCATION OF WELL**

COUNTY 8 (DO NOT ABBREVIATE COUNTY NAME) 21

SUBDIVISION 23 42

SECTION 44 46 LOT 48 50

NEAREST TOWN 52 71

MILES FROM TOWN (ENTER 0 IF IN TOWN) 73 76 77 78 71 MI

**WELL INFORMATION**

MAXIMUM PUMPING RATE (GALLONS PER MINUTE) 6 12

AVERAGE DAILY QUANTITY NEEDED (GALLONS PER DAY) 14 20

**USE FOR WATER (CIRCLE APPROPRIATE BOX)**

HOME (SINGLE OR DOUBLE HOUSEHOLD UNIT ONLY)

FARMING, AGRICULTURE, IRRIGATION

INDUSTRIAL, COMMERCIAL, STATE AND FEDERAL GOVERNMENT.

MUNICIPAL WATER SUPPLY } MUST HAVE STATE HEALTH DEPT. APPROVAL

PRIVATE WATER COMPANY

TEST

**DIRECTION FROM TOWN (CIRCLE APPROPRIATE BOX)**

N NORTH  E EAST  NE NORTHEAST  SE SOUTHEAST

S SOUTH  W WEST  NW NORTHWEST  SW SOUTHWEST

NEAR WHAT ROAD 11 NORTH SOUTH EAST WEST 30

ON WHICH SIDE OF ROAD (CIRCLE APPROPRIATE BOX)  N  S  E  W

DISTANCE FROM ROAD (ENTER DISTANCE AND CIRCLE APPROPRIATE BOX) 34 37 38 39 FT MI

APPROXIMATE DEPTH OF WELL 24 28 FEET

APPROXIMATE DIAMETER OF WELL (NEAREST INCH)

**METHOD OF DRILLING USED (CIRCLE APPROPRIATE METHOD)**

BORED (OR AUGERED)  JETTED  DRIVEN

AIR-ROTARY  AIR-PERCUSSION  ROTARY (HYDRAULIC ROTARY)

CABLE  REVERSE-ROTARY  DRIVE-POINT

OTHER (DESCRIBE)

**REPLACEMENT OR DEEPEINED WELLS (CIRCLE APPROPRIATE BOX)**

THIS WELL WILL NOT REPLACE AN EXISTING WELL

THIS WELL WILL REPLACE A WELL THAT WILL BE ABANDONED AND SEALED

THIS WELL WILL REPLACE A WELL THAT WILL BE USED AS A STANDBY

THIS WELL WILL DEEPEIN AN EXISTING WELL PERMIT NUMBER OF WELL TO BE REPLACED OR DEEPEINED (IF AVAILABLE)

**NOT TO BE FILLED IN BY DRILLER (WRA USE ONLY)**

APPROPRIATION PERMIT NUMBER 54 ENGINEER REVIEW DISTRICT NO. 63 65

FORCE WRITE INITIALS IN BOX CONDITIONS A E N S G W Q C L U 70 71 72 73 74 75 76 77 78 79

**HEALTH DEPARTMENT APPROVAL**

STATE HEALTH (CIRCLE BOX) COUNTY NAME COUNTY NO.

MO. DAY YR.

DATE APPROVED BY

DRAW A SKETCH BELOW SHOWING LOCATION OF WELL IN RELATION TO NEARBY TOWNS, ROADS AND STREAMS WITH NORTH IN THE DIRECTION OF THE ARROW, AND GIVE DISTANCE FROM WELL TO NEAREST ROAD JUNCTION OR STREAM CROSSING SHOWN ON THE SKETCH. ALSO SHOW, BY MEANS OF AN "X", THE WELL LOCATION IN THE BOX BELOW, AND THE BOX NUMBER FROM THE WELL LOCATION MAP.

BOX NUMBER

NORTH COORDINATE 50 51 52 53 54 55

EAST COORDINATE 57 58 59 60 61 62 63

ELEVATION AT WELL HEAD (FEET) 65 66 67 68

0/5 5/5

0/0 5/0

**SPECIAL CONDITIONS 8-63 (WRA USE ONLY)**

1 2 3 (SEQ. NO.) 6

FILE Illegal Well Grout DATE REPORTED 11-12-76.  
PROPERTY OWNER Elizabeth Scott  
P.O. ADDRESS 6485 Trotter Rd. TELEPHONE \_\_\_\_\_

11-12-76. Janice - Sec. G. Edgar Harr Co.

She informed me that this well was grouted yesterday, Holiday  
Nov. 11. Stated that well was finished Wed. Nov. 10<sup>th</sup>.

I told her the well would not be approved by this office  
since we were not contacted & no inspector had seen  
the well. I also told her this office could not  
sign a use & occupancy permit for this property  
until the well & septic system were inspected & approved F.F.

11-12-76. Mr. G. E. Harr called & I informed him the same as above.

He said the well had to be grouted because we were off due to a  
holiday

11-12-76. Called Mr. Hennessy, State, informed him of situation F.F.

11-16-76. Mr. Hahn, atty. for Mr. Harr called for a meeting to resolve the  
unapproved well F.F.

FILE Illegal Well Grout DATE REPORTED 11-12-76.  
PROPERTY OWNER Elizabeth Scott  
P.O. ADDRESS 6485 Trotter Rd. TELEPHONE \_\_\_\_\_

11-12-76. Janice - Sec. G. Edgar Harr Co.

She informed me that this well was grouted yesterday, Holiday Nov. 11. Stated that well was finished Wed. Nov. 10<sup>th</sup>.

I told her the well would not be approved by this office since we were not contacted & no inspector had seen the well. I also told her this office could not sign a use & occupancy permit for this property until the well & septic system were inspected & approved F.F.

11-12-76. Mr. G. E. Harr called & I informed him the same as above.

He said the well had to be grouted because we were off due to a holiday

11-12-76. Called Mr. Hennessy, State, informed him of situation F.F.

11-16-76. Mr. Hahn, atty for Mr. Harr called for a meeting to resolve the unapproved well F.F.

FILE Illegal Well Grout DATE REPORTED 11-12-76.  
PROPERTY OWNER Elizabeth Scott  
P.O. ADDRESS 6485 Trotter Rd. TELEPHONE \_\_\_\_\_

11-12-76. Janice - Sec. G. Edgar Harr Co.  
She informed me that this well was grouted yesterday, Holiday  
Nov. 11. Stated that well was finished Wed. Nov. 10<sup>th</sup>.  
I told her the well would not be approved by this office  
since we were not contacted & no inspector had seen  
the well. I also told her this office could not  
sign a use & occupancy permit for this property  
until the well & septic system were inspected & approved F.F.

11-12-76. Mr. G. E. Harr called & I informed him the same as above.  
He said the well had to be grouted because we were off due to a  
holiday

11-12-76. Called Mr. Hennessy, State, informed him of situation F.F.

11-16-76. Mr. Hahn, atty for Mr. Harr called for a meeting to resolve the  
unapproved well F.F.

FILE Illegal Well Grout DATE REPORTED 11-12-76.  
PROPERTY OWNER Elizabeth Scott  
P.O. ADDRESS 6485 Trotter Rd. TELEPHONE \_\_\_\_\_

11-12-76. Janice - Sec. G. Edgar Harr Co.

She informed me that this well was grouted yesterday, Holiday  
Nov. 11. Stated that well was finished Wed. Nov. 10<sup>th</sup>.

I told her the well would not be approved by this office  
since we were not contacted & no inspector had seen  
the well. I also told her this office could not  
sign a use & occupancy permit for this property  
until the well & septic system were inspected & approved F.F.

11-12-76. Mr. G. E. Harr called & I informed him the same as above.

He said the well had to be grouted because we were off due to a  
holiday

11-12-76. Called M. Hennessy, State, informed him of situation F.F.

11-16-76. Mr. Hahn, atty. for Mr. Harr called for a meeting to resolve the  
unapproved well F.F.