

LAYOUT \_\_\_\_\_

INSP 1 \_\_\_\_\_ INSP 3 \_\_\_\_\_

INSP 2 \_\_\_\_\_ INSP 5 \_\_\_\_\_

ISSUE DATE: 6/13/06  
~~5/11/2006~~

525106  
P 52484D

APPROVAL  
DATE:

7/6/06

**PERMIT**  
**SHARED SEPTIC SYSTEM**  
**INDEXED**

A

Tax ID# 03-346471

**HOUSE SEWER LINE CONNECTION**

**HOWARD COUNTY HEALTH DEPARTMENT**  
**BUREAU OF ENVIRONMENTAL HEALTH**

NVR \_\_\_\_\_ IS PERMITTED TO INSTALL  ALTER

ADDRESS: 6085 Marshalee Drive, Elkridge MD 21075 PHONE NUMBER: 410-379-5956

SUBDIVISION Homeland (Ellicott Meadows) LOT NUMBER: 31

ADDRESS: 12099 Windsor Moss PROPERTY OWNER: NVR, Inc.

NUMBER OF BEDROOMS: 2

**HOUSE SERVED BY PUBLIC WATER? Yes**

LOCATION:	Install 4" house sewer line connection per the approved site plan.
NOTES:	This permit is limited to the installation of the individual house sewer line connection and installation of the grinder pump, if applicable. The Howard County Bureau of Utilities must be contacted for scheduling of inspection of these items, as well at 410-313-4900.

PLANS APPROVED: Mike Davis DATE: 6/1/06

**PERMIT VOID AFTER 2 YEARS**

1. CONTRACTOR IS RESPONSIBLE FOR SCHEDULING A PRE-CONSTRUCTION INSPECTION FOR ALL INSTALLATIONS.
2. ALL PARTS OF SEPTIC SYSTEM SHALL BE 100 FEET FROM ANY WATER WELL UNLESS SPECIFICALLY AUTHORIZED.
3. MANHOLE RISERS REQUIRED ON ALL SEPTIC TANKS AND PUMP CHAMBERS UNLESS SPECIFICALLY AUTHORIZED.
4. CONTRACTOR RESPONSIBLE FOR COMPLIANCE WITH APPLICABLE REGULATIONS, GUIDELINES AND THE TERMS OF THIS PERMIT.
5. NEITHER THE HOWARD COUNTY COUNCIL OR THE HEALTH DEPARTMENT IS RESPONSIBLE FOR THE SUCCESSFUL OPERATION OF ANY SYSTEM.
6. PERMITTEE RESPONSIBLE FOR OBTAINING FINAL APPROVAL ON THIS PERMIT.

**CALL 410-313-1771 FOR INSPECTION HOUSE CONNECTION**

P525106

NOT TO SCALE

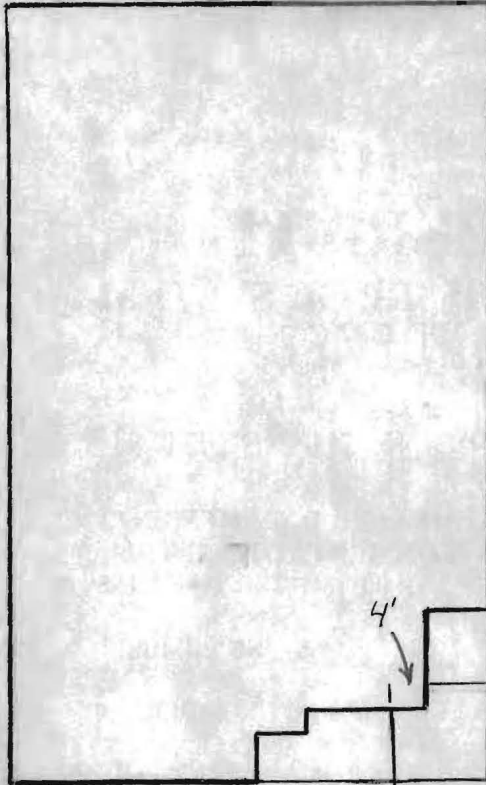

Water Valve

4" Septic Cleanout

Windsor Moss

ROAD

**TRENCH/DRAINFIELD DATA**

WIDTH \_\_\_\_\_ INLET \_\_\_\_\_ BOTTOM \_\_\_\_\_

NUMBER OF TRENCHES \_\_\_\_\_

TOTAL LENGTH \_\_\_\_\_

ABSORPTION AREA \_\_\_\_\_

DISTRIBUTION BOX LEVEL \_\_\_\_\_

DISTRIBUTION BOX BAFFLE \_\_\_\_\_

DISTRIBUTION BOX PORT \_\_\_\_\_

**SEPTIC TANK DATA**

SEPTIC TANK 1 LEVEL \_\_\_\_\_

CAPACITY \_\_\_\_\_ GAL

SEAM LOC \_\_\_\_\_

TANK LID DEPTH \_\_\_\_\_

BAFFLES \_\_\_\_\_

BAFFLE FILTER \_\_\_\_\_

MANHOLE LOC \_\_\_\_\_

6" PORT LOC \_\_\_\_\_

WATERTIGHT TEST \_\_\_\_\_

SEPTIC TANK 2 LEVEL \_\_\_\_\_

CAPACITY \_\_\_\_\_ GAL

SEAM LOC \_\_\_\_\_

TANK LID DEPTH \_\_\_\_\_

BAFFLES \_\_\_\_\_

BAFFLE FILTER \_\_\_\_\_

MANHOLE LOC \_\_\_\_\_

6" PORT LOC \_\_\_\_\_

WATERTIGHT TEST \_\_\_\_\_

PRE-CONSTRUCTION \_\_\_\_\_

INSTALLATION 7/6/06 *Septic connection about 6.5' below brick ledge. Water connection not finished. O.K. to backfill. (BB)*

FINAL INSPECTOR B. Baker DATE OF APPROVAL 7/6/06

Methods.  
 Operator's Operation and Maintenance Manuals

provide operations and maintenance

and at least 60 days prior to the date set for  
 to the Owner five (5) Operation and  
 and electrical systems and equipment  
 include all installation, operation, start-up and  
 and in the manuals shall consist of catalogs,  
 files, parts, lists, assembly drawings, wiring  
 and maintenance measures, approved working  
 drawings for the Owner to establish an effective

and in 3-ring loose-leaf binders and indexed.  
 above dimensions and placed in envelopes

Operator and/or Owner in understanding the  
 operations of the equipment as well as to  
 performance. Technical and maintenance information  
 and electrical components shall be included  
 but not limited to, Operation Responsibilities,  
 Design Criteria, Operational Modifications,  
 Component Equipment O&M, System Equipment  
 and As-Builts.

Completion of the facilities will not be undertaken until  
 all manuals have been submitted. Partial approvals.

NH <sub>3</sub> -N	35	mg/L	
Alkalinity (as CaCO <sub>3</sub> )	100	mg/L	
pH	6.0 - 9.0	S.U.	
Water Temperature Min.	15	°C	
Water Temperature Max	28	°C	
Air Temperature Min.	0	°F	SBR R
Air Temperature Max	100	°F	
Site Elevation	442	ft	
<b>Effluent Characteristics</b>			M
BOD <sub>5</sub> (20°C)	30	mg/ L	T
Total Suspended Solids	30	mg/L	
NH <sub>3</sub> -N	1.0	mg/L	
Total Nitrogen (N)	10.0	mg/l	D
<b>Influent Pumping</b>			
Average design rate in	15.3	gpm	Dosing
Peak rate in	61.2	gpm @ 4 x Avg.	
Pump rate provided	70	gpm 1 pump (28' TDH)	

PUBLIC WATER +  
 PRIVATE SHARED SEPTIC  
 SYSTEM

HOMELAND SENIOR CENTER  
 147 UNITS TOTAL  
 EACH UNIT CAN ONLY  
 BE A TOTAL OF 2 BEDROOMS

Approved Septic System Plan MDE  
 Howard County Health Department

Approved Septic System Plan  
 Howard County Health Department

*[Signature]*  
 Signature Date 9-2-03

*Steven Roger King*  
 Signature Date 9/2/03

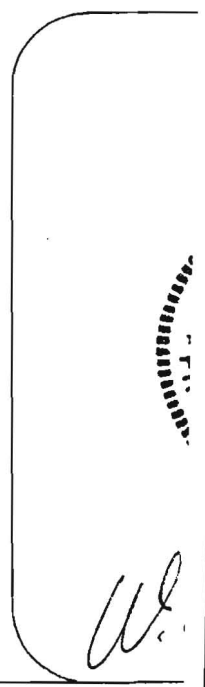

*[Handwritten initials]*

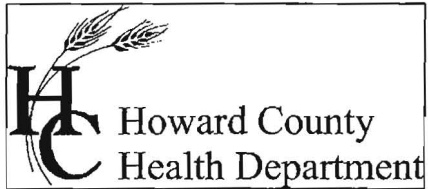

Bureau of Environmental Health  
7178 Columbia Gateway Drive Columbia, Maryland 21046-2132  
(410) 313-2640 Fax (410) 313-2648  
TDD (410) 313-2323 Toll Free 1-866-313-6300  
website: www.hchealth.org

Penny E. Borenstein, M.D., M.P.H., Health Officer

July 7, 2006

NVR, Inc.  
6085 Marshalee Drive, Suite 130  
Elkridge, MD 21075

RE: Homeland, Lot 31  
12099 Windsor Moss  
Ellicott City, MD 21042  
BP# B00159575  
**PUBLIC WATER**

Dear Sir/Madam:

This is to advise you that the septic system for the above referenced property has been installed and inspected. **Final approval of the septic system was granted on 07/06/2006.**

The property is served by public water and is therefore exempt from the Health Department water sampling requirements.

By issuance of this letter, this office recommends release of the Use and Occupancy permit for the referenced property.

Approving Authority,

Brian Baker, R. S.  
Well & Septic Program

mlb  
cc: Building Inspector's Office  
File

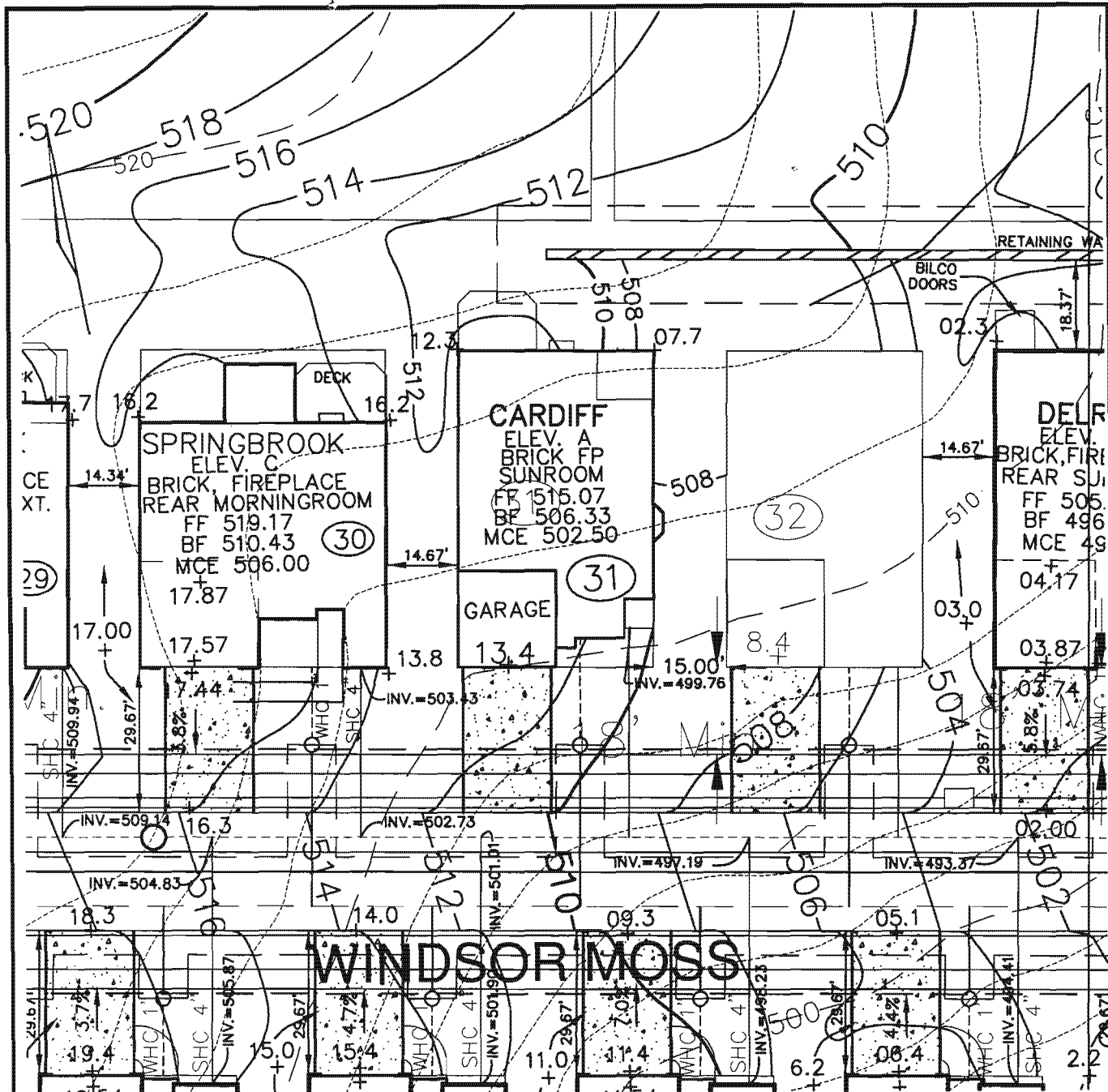

**ROBERT H. VOGEL  
ENGINEERING, INC.**  
ENGINEERS • SURVEYORS • PLANNERS

8407 MAIN STREET TEL: 410.461.7666  
ELLICOTT CITY, MD 21043 FAX: 410.461.8961

NOTE:  
ALL DIMENSIONS ARE FROM  
ARCHITECTURAL BRICK LEDGE.

SCALE 1"=30'  
DRAWN BY DRN  
CHECKED BY LJT  
DATE MAY, 2006  
W. O. # 04-87.00  
SHEET# 1 OF 1

**RYAN HOMES  
ELLICOTT MEADOWS  
UNIT 31**

HOMELAND SDP-03-30  
TAX MAP 16  
3RD ELECTION DISTRICT

PARCEL 53,96,165&204  
HOWARD COUNTY, MARYLAND