

LAYOUT _____
INSP 1 6/21/06 INSP 3 _____
INSP 2 _____ INSP 5 _____

ISSUE DATE: 6/26/06

APPROVAL
DATE:

6/21/06

**PERMIT
SHARED SEPTIC SYSTEM**

INDEXED

P 5 25129

A

HOUSE SEWER LINE CONNECTION

**HOWARD COUNTY HEALTH DEPARTMENT
BUREAU OF ENVIRONMENTAL HEALTH**

NVR Inc. _____ IS PERMITTED TO INSTALL ALTER

ADDRESS: 6085 Marshalee Drive, Suite 130, Elkridge PHONE NUMBER: 410-379-5956
21075 _____

SUBDIVISION Homeland (Ellicott Meadows) LOT NUMBER: 109

ADDRESS: 12060 Windsor Moss PROPERTY OWNER: NVR. Inc.

NUMBER OF BEDROOMS: 2

HOUSE SERVED BY PUBLIC WATER? Yes

LOCATION:	Install 4" house sewer line connection per the approved site plan.
NOTES:	This permit is limited to the installation of the individual house sewer line connection and installation of the grinder pump, if applicable. The Howard County Bureau of Utilities must be contacted for scheduling of inspection of these items, as well at 410-313-4900.

PLANS APPROVED: Michael J. Davis DATE: 5/8/06

PERMIT VOID AFTER 2 YEARS

1. CONTRACTOR IS RESPONSIBLE FOR SCHEDULING A PRE-CONSTRUCTION INSPECTION FOR ALL INSTALLATIONS.
2. ALL PARTS OF SEPTIC SYSTEM SHALL BE 100 FEET FROM ANY WATER WELL UNLESS SPECIFICALLY AUTHORIZED.
3. MANHOLE RISERS REQUIRED ON ALL SEPTIC TANKS AND PUMP CHAMBERS UNLESS SPECIFICALLY AUTHORIZED.
4. CONTRACTOR RESPONSIBLE FOR COMPLIANCE WITH APPLICABLE REGULATIONS, GUIDELINES AND THE TERMS OF THIS PERMIT.
5. NEITHER THE HOWARD COUNTY COUNCIL OR THE HEALTH DEPARTMENT IS RESPONSIBLE FOR THE SUCCESSFUL OPERATION OF ANY SYSTEM.
6. PERMITTEE RESPONSIBLE FOR OBTAINING FINAL APPROVAL ON THIS PERMIT.

CALL 410-313-1771 FOR INSPECTION HOUSE CONNECTION

P525129

NOT TO SCALE

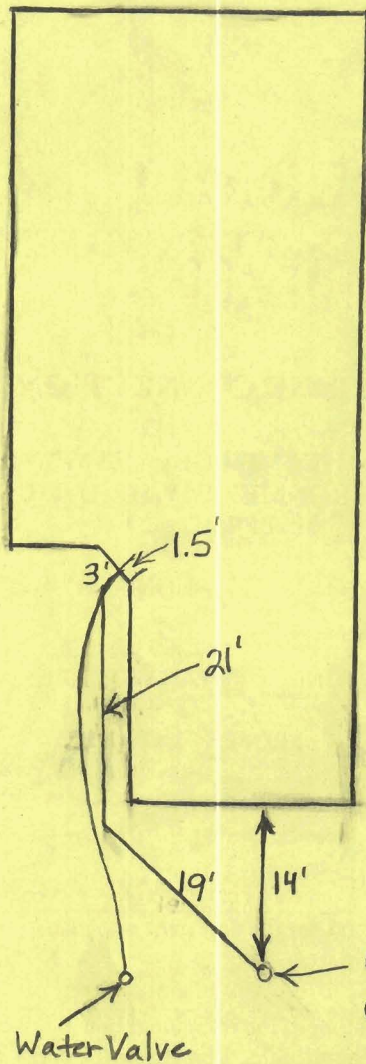

Windsor Moss

ROAD

TRENCH/DRAINFIELD DATA

WIDTH	INLET	BOTTOM
_____	_____	_____
NUMBER OF TRENCHES _____		
TOTAL LENGTH _____		
ABSORPTION AREA _____		
DISTRIBUTION BOX LEVEL _____		
DISTRIBUTION BOX BAFFLE _____		
DISTRIBUTION BOX PORT _____		

SEPTIC TANK DATA

SEPTIC TANK 1 LEVEL _____

CAPACITY _____ GAL

SEAM LOC _____

TANK LID DEPTH _____

BAFFLES _____

BAFFLE FILTER _____

MANHOLE LOC _____

6" PORT LOC _____

WATERTIGHT TEST _____

SEPTIC TANK 2 LEVEL _____

CAPACITY _____ GAL

SEAM LOC _____

TANK LID DEPTH _____

BAFFLES _____

BAFFLE FILTER _____

MANHOLE LOC _____

6" PORT LOC _____

WATERTIGHT TEST _____

PRE-CONSTRUCTION _____

INSTALLATION 6/21/06 Well and septic connections ~ 8' below brick ledge. O.K. to cover. (BB)

FINAL INSPECTOR Brian Baker DATE OF APPROVAL 6/21/06

HOMELAND, WAY

WINDSOR MOSS

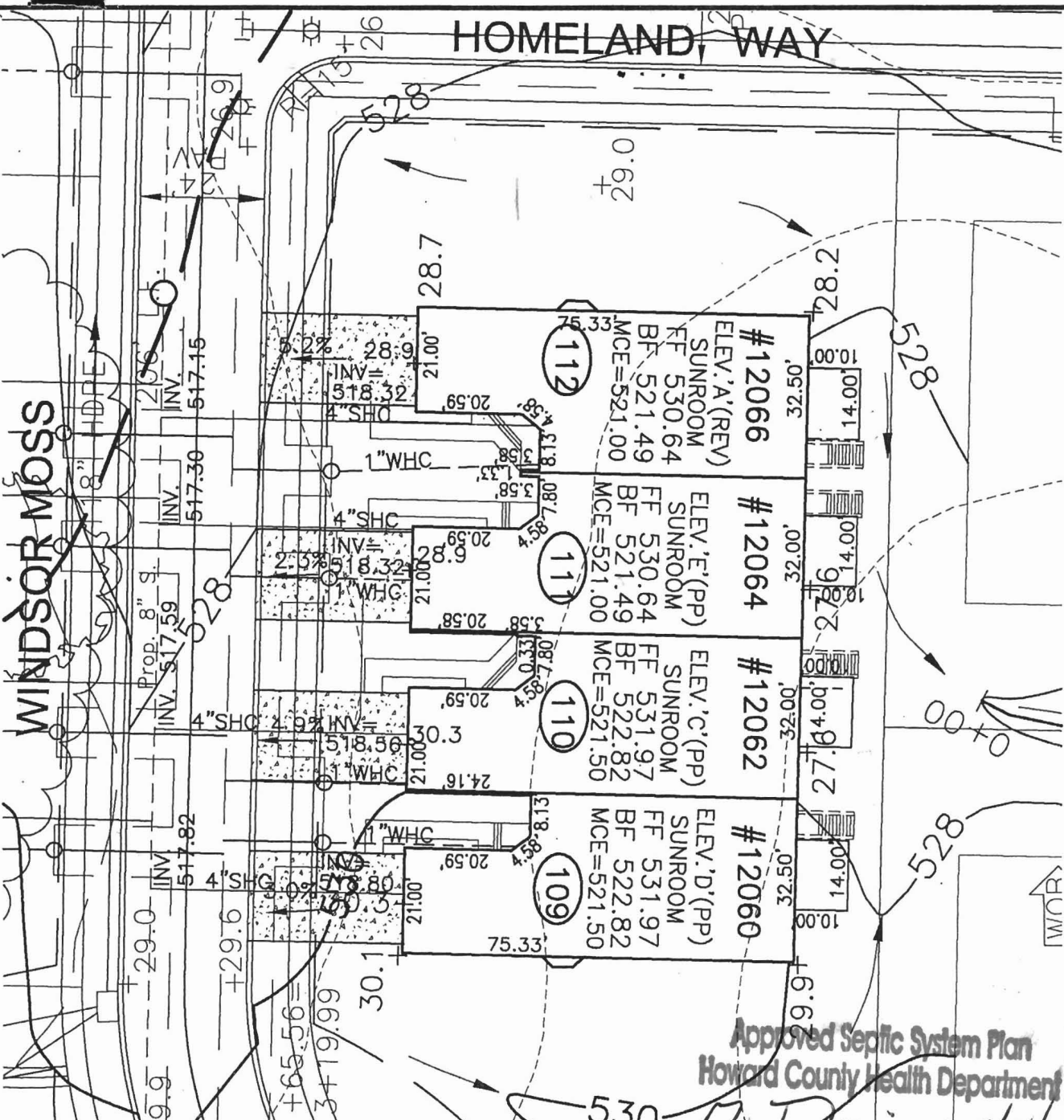

Approved Septic System Plan
Howard County Health Department

M. Dan
Signature
3/13/06
Date



**ROBERT H. VOGEL
ENGINEERING, INC.**

ENGINEERS • SURVEYORS • PLANNERS
8407 MAIN STREET TEL: 410.461.7666
ELLICOTT CITY, MD 21043 FAX: 410.461.8961

SCALE 1"=30'
 DRAWN BY MY
 CHECKED BY RHV
 DATE FEB. 2006
 W. O. # 04-87.00
 SHEET# 1 OF 1

NV HOMES
 ELLICOTT MEADOWS
 UNITS 109-112

RSA
3-13-06

HOMELAND SDP-03-30
TAX MAP 16
3RD ELECTION DISTRICT

PARCEL 53,96,165&204
HOWARD COUNTY, MARYLAND

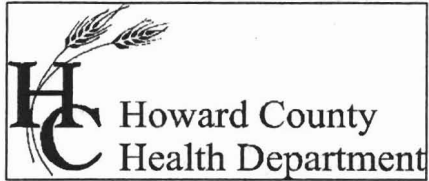

Bureau of Environmental Health
7178 Columbia Gateway Drive Columbia, Maryland 21046-2132
(410) 313-2640 Fax (410) 313-2648
TDD (410) 313-2323 Toll Free 1-866-313-6300
website: www.hchealth.org

Penny E. Borenstein, M.D., M.P.H., Health Officer

June 28, 2006

NVR, Inc.
6085 Marshalee Drive, Suite 130
Elkridge, MD 21075

RE: Homeland, Lot 109
12060 Windsor Moss
Ellicott City, MD 21042
BP# B00158658
PUBLIC WATER

Dear Sir/Madam:

This is to advise you that the septic system for the above referenced property has been installed and inspected. **Final approval of the septic system was granted on 06/21/2006.**

The property is served by public water and is therefore exempt from the Health Department water sampling requirements.

By issuance of this letter, this office recommends release of the Use and Occupancy permit for the referenced property.

Approving Authority,

Brian Baker, R. S.
Well & Septic Program

mlb
cc: Building Inspector's Office
File