

LAYOUT _____

INSP 1 11/28/05 INSP 3 _____

INSP 2 _____ INSP 4 _____

ISSUE DATE: 11/14/2005

P 523644

APPROVAL DATE: _____

11/28/05

A _____

PERMIT INDEXED

TAX ID # 03-344649

**COMMUNITY SEPTIC SYSTEM
HOUSE SEWER LINE CONNECTION**

**HOWARD COUNTY HEALTH DEPARTMENT
BUREAU OF ENVIRONMENTAL HEALTH**

NVR _____ IS PERMITTED TO INSTALL ALTER

ADDRESS: 6085 Marshalee Dr., Suite 140 PHONE NUMBER: 410-796-0980

SUBDIVISION Homeland Unit # 33

ADDRESS: 12107 Windsor Moss PROPERTY OWNER: NVR Inc.

NUMBER OF BEDROOMS: 2

HOUSE SERVED BY PUBLIC WATER

LOCATION:	Install 4" house sewer line connection per the approved site plan. Final acceptance of the sewer system will be subject to the approval of the Maryland Dept. of the Environment.
NOTES:	This permit is limited to the installation of the individual house sewer line connection.

PLANS APPROVED: Kevin J. Bell DATE: 11/03/05

PERMIT VOID AFTER 2 YEARS

1. CONTRACTOR IS RESPONSIBLE FOR SCHEDULING A PRE-CONSTRUCTION INSPECTION FOR ALL INSTALLATIONS.
2. ALL PARTS OF SEPTIC SYSTEM SHALL BE 100 FEET FROM ANY WATER WELL UNLESS SPECIFICALLY AUTHORIZED.
3. CONTRACTOR RESPONSIBLE FOR COMPLIANCE WITH APPLICABLE REGULATIONS, GUIDELINES AND THE TERMS OF THIS PERMIT.
4. NEITHER THE HOWARD COUNTY COUNCIL OR THE HEALTH DEPARTMENT IS RESPONSIBLE FOR THE SUCCESSFUL OPERATION OF ANY SYSTEM.
5. PERMITTEE RESPONSIBLE FOR OBTAINING FINAL APPROVAL ON THIS PERMIT.

CALL 410-313-1771 FOR INSPECTION OF SEPTIC CONNECTION

P523644

NOT TO SCALE

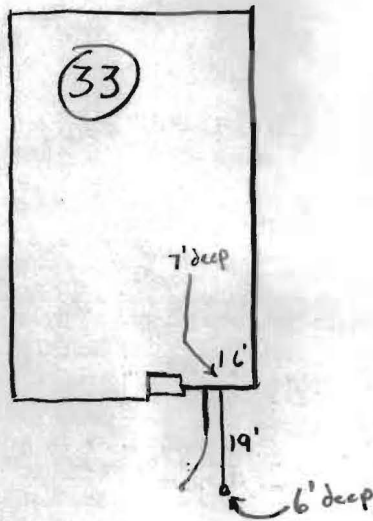

ROAD

TRENCH/DRAINFIELD DATA

WIDTH _____ INLET _____ BOTTOM _____

NUMBER OF TRENCHES _____

TOTAL LENGTH _____

ABSORPTION AREA _____

DISTRIBUTION BOX LEVEL _____

DISTRIBUTION BOX BAFFLE _____

DISTRIBUTION BOX PORT _____

SEPTIC TANK DATA

SEPTIC TANK 1 LEVEL _____

CAPACITY _____ GAL

SEAM LOC _____

TANK LID DEPTH _____

BAFFLES _____

BAFFLE FILTER _____

MANHOLE LOC _____

6" PORT LOC _____

WATERTIGHT TEST _____

SEPTIC TANK 2 LEVEL _____

CAPACITY _____ GAL

SEAM LOC _____

TANK LID DEPTH _____

BAFFLES _____

BAFFLE FILTER _____

MANHOLE LOC _____

6" PORT LOC _____

WATERTIGHT TEST _____

PRE-CONSTRUCTION ^{11/28/05} OK to backfill House Connection (GAC)

INSTALLATION _____

FINAL INSPECTOR Gabriel A. Creighton DATE OF APPROVAL 11/28/05

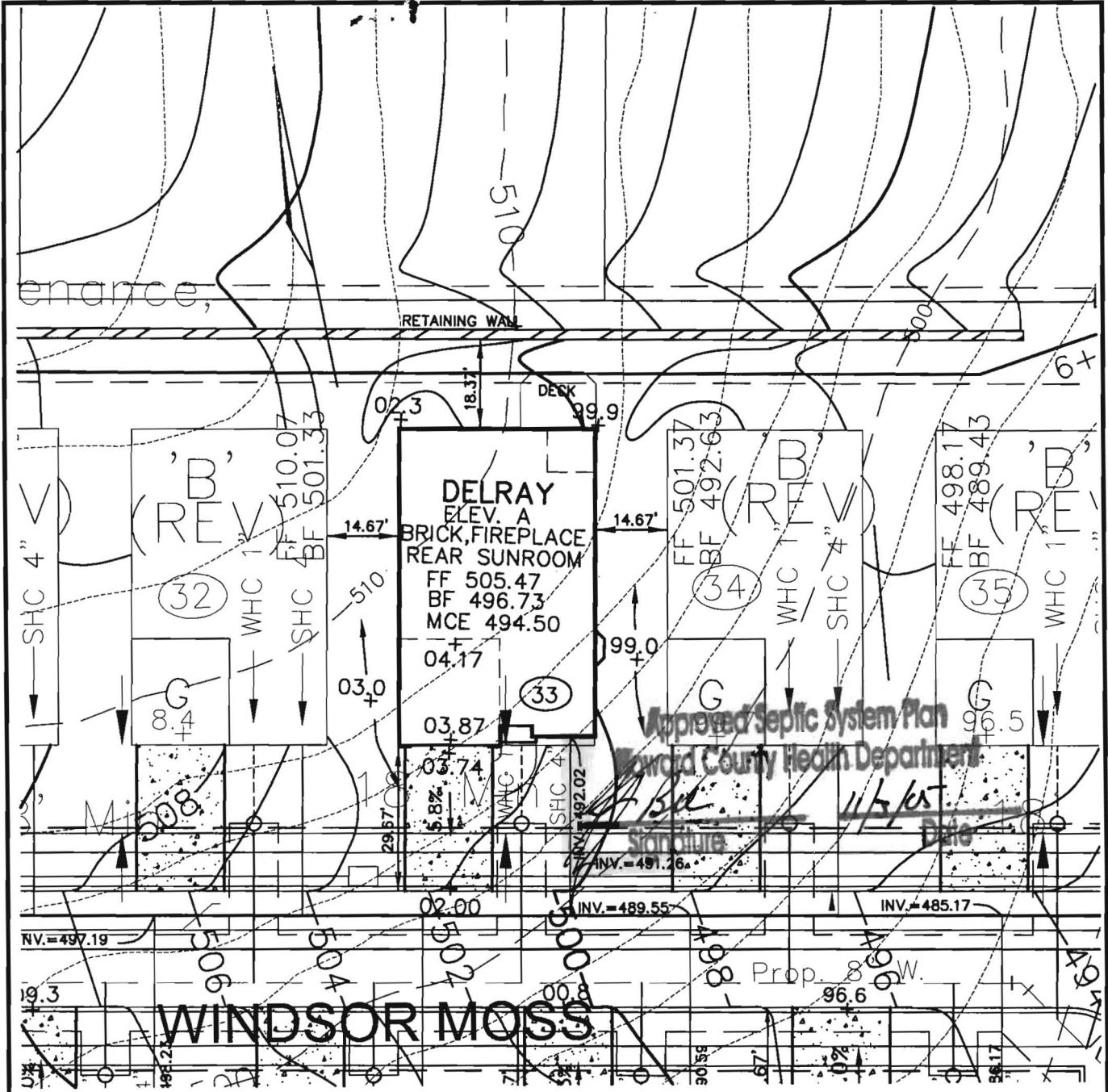

VE **ROBERT H. VOGEL**
ENGINEERING, INC.
 ENGINEERS • SURVEYORS • PLANNERS
 8407 MAIN STREET TEL: 410.461.7666
 ELLICOTT CITY, MD 21043 FAX: 410.461.8961

NOTE:
 ALL DIMENSION ARE FROM
 ARCHITECTURAL BRICK LEDGE.

SCALE 1"=30'
 DRAWN BY JCO
 CHECKED BY RHV
 DATE SEPTEMBER, 2005
 W. O. # 04-87.00
 SHEET# 1 OF 1

RYAN HOMES
ELLICOTT MEADOWS
UNIT 33

HOMELAND SDP-03-30
 TAX MAP 16
 3RD ELECTION DISTRICT

PARCEL 53,96,165&204
 HOWARD COUNTY, MARYLAND