

LAYOUT _____

INSP 1 _____ INSP 3 _____

INSP 2 _____ INSP 5 _____

ISSUE DATE: 2/10/07

P 526214

APPROVAL
DATE:

1/25/07

A 515326

PERMIT SHARED SEPTIC SYSTEM

INDEXED

Tax ID # 03-348377

HOUSE SEWER LINE CONNECTION

HOWARD COUNTY HEALTH DEPARTMENT
BUREAU OF ENVIRONMENTAL HEALTH

NVR _____ IS PERMITTED TO INSTALL ALTER

ADDRESS: 6085 Marshalee Drive, Elkridge MD 21075 PHONE NUMBER: 410-379-5956

SUBDIVISION Homeland (Ellicott Meadows) LOT NUMBER: 122

ADDRESS: 12078 Windsor Moss PROPERTY OWNER: NVR, Inc. Koo H. Cho

NUMBER OF BEDROOMS: 2

HOUSE SERVED BY PUBLIC WATER? Yes

| | |
|-----------|---|
| LOCATION: | Install 4" house sewer line connection per the approved site plan. |
| NOTES: | This permit is limited to the installation of the individual house sewer line connection and installation of the grinder pump, if applicable. The Howard County Bureau of Utilities must be contacted for scheduling of inspection of these items, as well at 410-313-4900. |

PLANS APPROVED: Mike Davis DATE: 6/1/06

PERMIT VOID AFTER 2 YEARS

1. CONTRACTOR IS RESPONSIBLE FOR SCHEDULING A PRE-CONSTRUCTION INSPECTION FOR ALL INSTALLATIONS.
2. ALL PARTS OF SEPTIC SYSTEM SHALL BE 100 FEET FROM ANY WATER WELL UNLESS SPECIFICALLY AUTHORIZED.
3. MANHOLE RISERS REQUIRED ON ALL SEPTIC TANKS AND PUMP CHAMBERS UNLESS SPECIFICALLY AUTHORIZED.
4. CONTRACTOR RESPONSIBLE FOR COMPLIANCE WITH APPLICABLE REGULATIONS, GUIDELINES AND THE TERMS OF THIS PERMIT.
5. NEITHER THE HOWARD COUNTY COUNCIL OR THE HEALTH DEPARTMENT IS RESPONSIBLE FOR THE SUCCESSFUL OPERATION OF ANY SYSTEM.
6. PERMITTEE RESPONSIBLE FOR OBTAINING FINAL APPROVAL ON THIS PERMIT.

CALL 410-313-1771 FOR INSPECTION HOUSE CONNECTION

526214

NOT TO SCALE

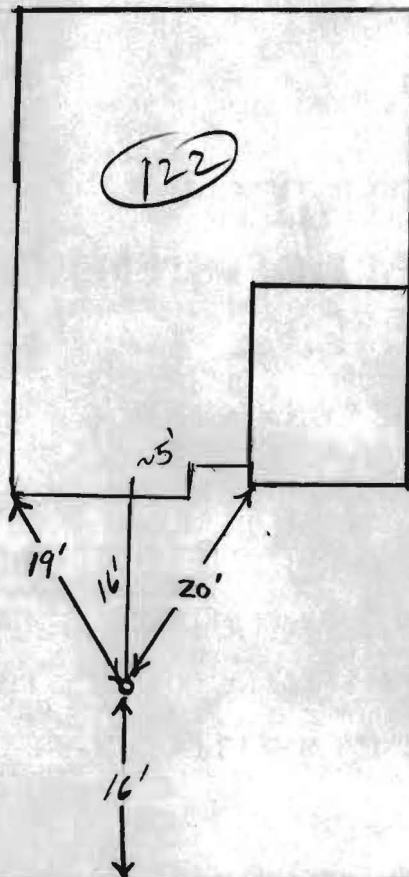

WINDSOR MESS

ROAD

TRENCH/DRAINFIELD DATA

| WIDTH | INLET | BOTTOM |
|-------------------------------|-------|--------|
| _____ | _____ | _____ |
| NUMBER OF TRENCHES _____ | | |
| TOTAL LENGTH _____ | | |
| ABSORPTION AREA _____ | | |
| DISTRIBUTION BOX LEVEL _____ | | |
| DISTRIBUTION BOX BAFFLE _____ | | |
| DISTRIBUTION BOX PORT _____ | | |

SEPTIC TANK DATA

SEPTIC TANK 1 LEVEL _____

CAPACITY _____ GAL

SEAM LOC _____

TANK LID DEPTH _____

BAFFLES _____

BAFFLE FILTER _____

MANHOLE LOC _____

6" PORT LOC _____

WATERTIGHT TEST _____

SEPTIC TANK 2 LEVEL _____

CAPACITY _____ GAL

SEAM LOC _____

TANK LID DEPTH _____

BAFFLES _____

BAFFLE FILTER _____

MANHOLE LOC _____

6" PORT LOC _____

WATERTIGHT TEST _____

PRE-CONSTRUCTION _____

INSTALLATION 1/25/07 OK. to backfill (RM)

FINAL INSPECTOR R. Way DATE OF APPROVAL 1/25/07

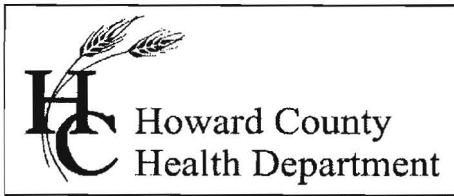

Bureau of Environmental Health
7178 Gateway Drive Columbia, MD 21046
(410) 313-2640 Fax (410) 313-2648
TDD (410) 313-2323 Toll Free 1-866-313-6300
website: www.hchealth.org

Peter L. Beilenson, M.D., M.P.H., Health Officer1

April 3, 2007

NVR, Inc./Ryan Homes
6085 Marshalee Drive, Suite 130
Elkridge, MD 21075

RE: Homeland, Lot 122
12078 Windsor Moss
Ellicott City, MD 21042
BP# B06008485
PUBLIC WATER

Dear Sir/Madam:

This is to advise you that the septic system for the above referenced property has been installed and inspected. **Final approval of the septic system was granted on 01/25/2007.**

The property is served by public water and is therefore exempt from the Health Department water sampling requirements.

By issuance of this letter, this office recommends release of the Use and Occupancy permit for the referenced property.

Approving Authority,

Brian Baker, R. S.
Well & Septic Program

mlb
cc: Building Inspector's Office
File