

LAYOUT _____

INSP 1 _____ INSP 3 _____

INSP 2 _____ INSP 5 _____

ISSUE DATE: 5/22/07

P 526724

APPROVAL DATE: 4/9/07

PERMIT COMMUNITY SEPTIC SYSTEM INDEXED

A _____

HOUSE SEWER LINE CONNECTION

HOWARD COUNTY HEALTH DEPARTMENT BUREAU OF ENVIRONMENTAL HEALTH

NV Homes IS PERMITTED TO INSTALL ALTER

ADDRESS: 6085 Marshalee Drive, Suite 130, Elkridge PHONE NUMBER: _____

SUBDIVISION Homeland - Ellicott Meadows LOT NUMBER: 17

ADDRESS: 12061 Windsor Moss PROPERTY OWNER: NV Homes

NUMBER OF BEDROOMS: 2

HOUSE SERVED BY PUBLIC WATER

LOCATION:	Install 4" house sewer line connection per the approved site plan. Final acceptance of the sewer system will be subject to the approval of the Maryland Department of the Environment.
NOTES:	This permit is limited to the installation of the individual house sewer line connection.

PLANS APPROVED: _____ DATE: _____

PERMIT VOID AFTER 2 YEARS

1. CONTRACTOR IS RESPONSIBLE FOR SCHEDULING A PRE-CONSTRUCTION INSPECTION FOR ALL INSTALLATIONS.
2. ALL PARTS OF SEPTIC SYSTEM SHALL BE 100 FEET FROM ANY WATER WELL UNLESS SPECIFICALLY AUTHORIZED.
3. CONTRACTOR RESPONSIBLE FOR COMPLIANCE WITH APPLICABLE REGULATIONS, GUIDELINES AND THE TERMS OF THIS PERMIT.
4. NEITHER THE HOWARD COUNTY COUNCIL NOR THE HEALTH DEPARTMENT IS RESPONSIBLE FOR THE SUCCESSFUL OPERATION OF ANY SYSTEM.
5. PERMITTEE RESPONSIBLE FOR OBTAINING FINAL APPROVAL ON THIS PERMIT.

CALL 410-313-1771 FOR INSPECTION OF SEPTIC SYSTEM

P526724

NOT TO SCALE

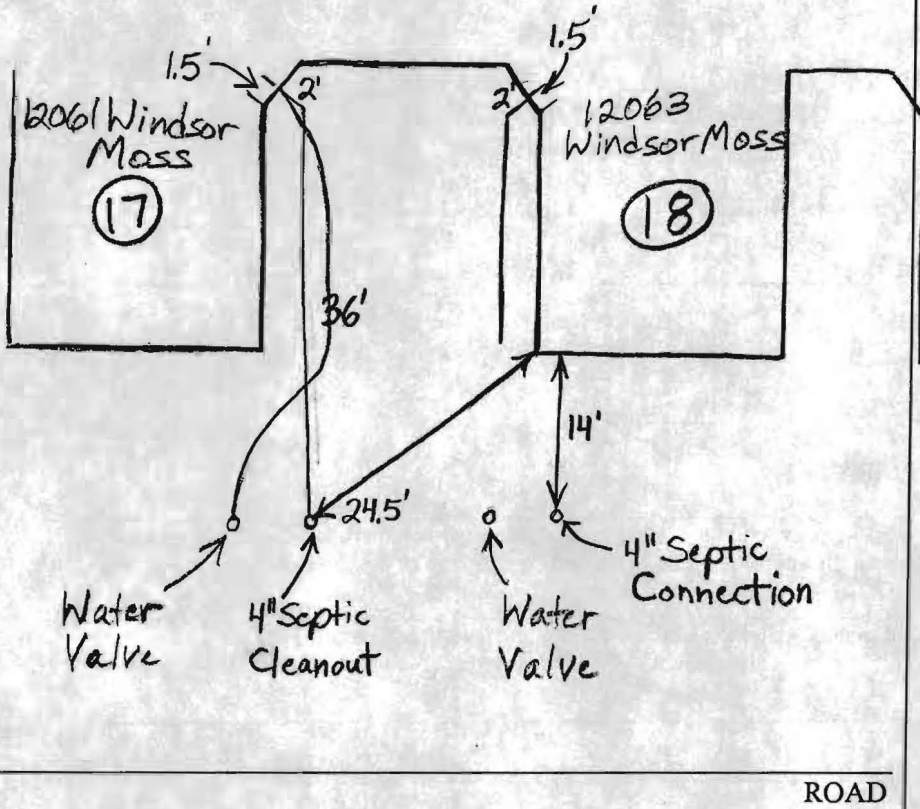

TRENCH/DRAINFIELD DATA

WIDTH	INLET	BOTTOM
_____	_____	_____
NUMBER OF TRENCHES _____		
TOTAL LENGTH _____		
ABSORPTION AREA _____		
DISTRIBUTION BOX LEVEL _____		
DISTRIBUTION BOX BAFFLE _____		
DISTRIBUTION BOX PORT _____		

SEPTIC TANK DATA

SEPTIC TANK 1 LEVEL _____	
CAPACITY _____	GAL
SEAM LOC _____	
TANK LID DEPTH _____	
BAFFLES _____	
BAFFLE FILTER _____	
MANHOLE LOC _____	
6" PORT LOC _____	
WATERTIGHT TEST _____	
SEPTIC TANK 2 LEVEL _____	
CAPACITY _____	GAL
SEAM LOC _____	
TANK LID DEPTH _____	
BAFFLES _____	
BAFFLE FILTER _____	
MANHOLE LOC _____	
6" PORT LOC _____	
WATERTIGHT TEST _____	

PRE-CONSTRUCTION _____

INSTALLATION 4/9/07 Water lines 8' below brick ledges. Not finished with lot 18. O.K. to backfill. Permit fees collected? BB

FINAL INSPECTOR _____

BB

DATE OF APPROVAL _____

4/9/07

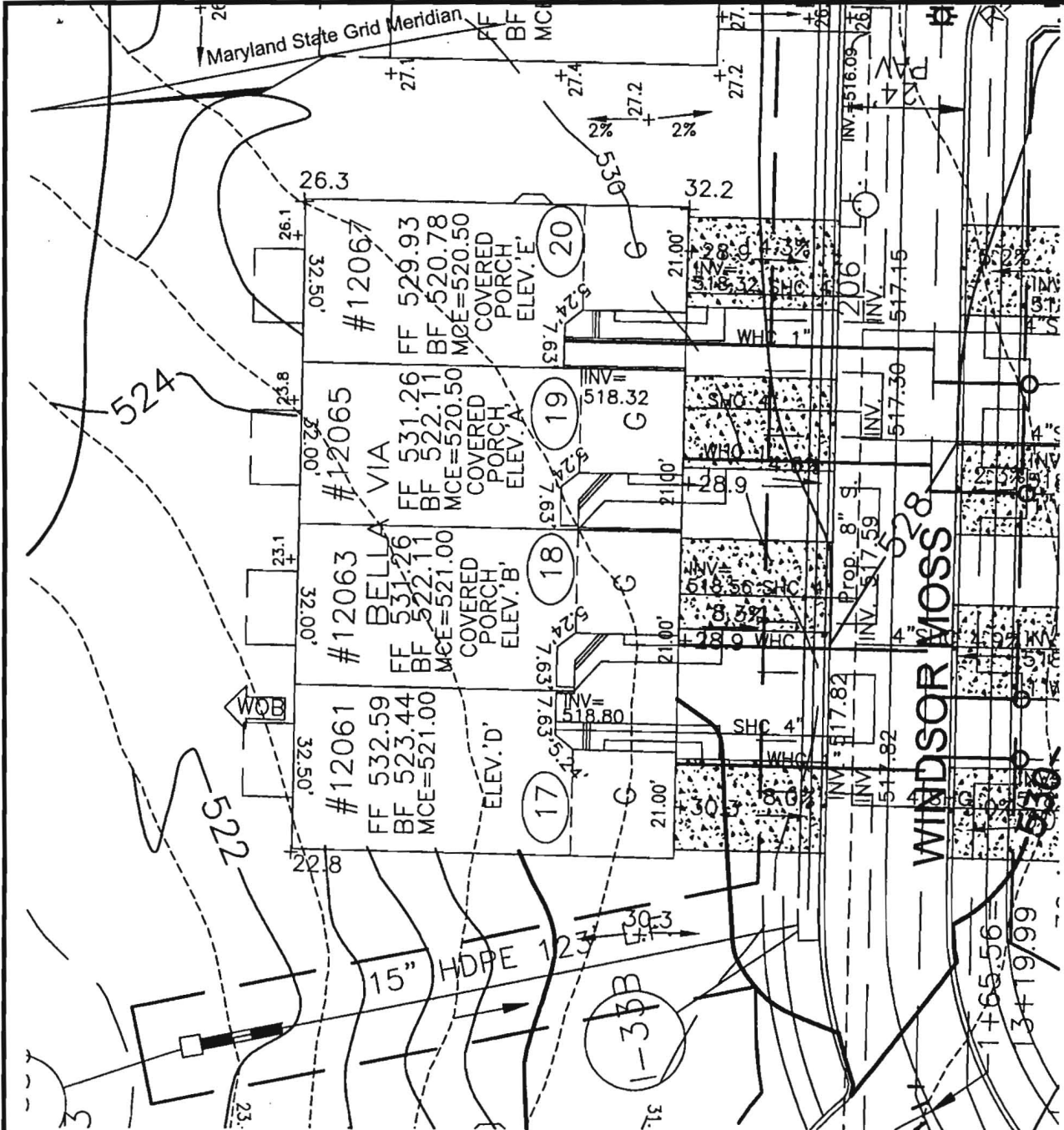

**ROBERT H. VOGEL
ENGINEERING, INC.**

ENGINEERS • SURVEYORS • PLANNERS
8407 MAIN STREET TEL: 410.461.7666
ELlicOTT CITY, MD 21043 FAX: 410.461.8981

SCALE 1"=30'
DRAWN BY MY
CHECKED BY RHV
DATE OCTOBER 4, 2006
W. O. # 04-87.00
SHEET# 1 OF 1

**NV HOMES
ELlicOTT MEADOWS
UNITS 17-20**

HOMELAND SDP-03-30
TAX MAP 16
3RD ELECTION DISTRICT

PARCEL 53,96,165&204
HOWARD COUNTY, MARYLAND

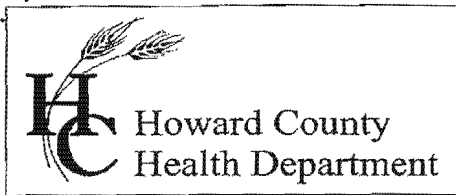

Bureau of Environmental Health
7178 Gateway Drive Columbia, MD 21046
(410) 313-2640 Fax (410) 313-2648
TDD (410) 313-2323 Toll Free 1-866-313-6300
website: www.hchealth.org

Peter L. Beilenson, M.D., M.P.H., Health Officer

June 20, 2007

NVR, Inc./NV Homes
6085 Marshalee Drive, Suite 130
Elkridge, MD 21075

SENT BY FACSIMILE 301-854-9632

RE: Homeland—Ellicott Meadows, Lot 17
12061 Windsor Moss
Ellicott City, MD 21042
BP# B06006070
PUBLIC WATER

Dear Sir/Madam:

This is to advise you that the septic system for the above referenced property has been installed and inspected. **Final approval of the septic system was granted on 04/09/2007.**

The property is served by public water and is therefore exempt from the Health Department water sampling requirements.

By issuance of this letter, this office recommends release of the Use and Occupancy permit for the referenced property.

Approving Authority,

Stuart Oster, R. S.
Well & Septic Program

mlb
cc: Building Inspector's Office
File