

LAYOUT \_\_\_\_\_  
INSP 1 1/12/06 INSP 3 \_\_\_\_\_  
INSP 2 \_\_\_\_\_ INSP 5 \_\_\_\_\_

ISSUE DATE: 11/30/05

P 523743

APPROVAL  
DATE:

1/12/06

# PERMIT

## SHARED SEPTIC SYSTEM

A

INDEXED

### HOUSE SEWER LINE CONNECTION

HOWARD COUNTY HEALTH DEPARTMENT  
BUREAU OF ENVIRONMENTAL HEALTH

NVR/RYAN HOMER

IS PERMITTED TO INSTALL  ALTER

ADDRESS: \_\_\_\_\_ PHONE NUMBER: 410-796-0980

SUBDIVISION Homeland (Ellicott Meadows) LOT NUMBER: 30

ADDRESS: 12095 Windsor Moss PROPERTY OWNER: NVR. Inc.

NUMBER OF BEDROOMS: 2

HOUSE SERVED BY PUBLIC WATER? **Yes**

LOCATION:	Install 4" house sewer line connection per the approved site plan.
NOTES:	This permit is limited to the installation of the individual house sewer line connection and installation of the grinder pump, if applicable. The Howard County Bureau of Utilities must be contacted for scheduling of inspection of these items, as well at 410-313-4900.

PLANS APPROVED: Kevin J. Bell DATE: 11/08/05

### PERMIT VOID AFTER 2 YEARS

1. CONTRACTOR IS RESPONSIBLE FOR SCHEDULING A PRE-CONSTRUCTION INSPECTION FOR ALL INSTALLATIONS.
2. ALL PARTS OF SEPTIC SYSTEM SHALL BE 100 FEET FROM ANY WATER WELL UNLESS SPECIFICALLY AUTHORIZED.
3. MANHOLE RISERS REQUIRED ON ALL SEPTIC TANKS AND PUMP CHAMBERS UNLESS SPECIFICALLY AUTHORIZED.
4. CONTRACTOR RESPONSIBLE FOR COMPLIANCE WITH APPLICABLE REGULATIONS, GUIDELINES AND THE TERMS OF THIS PERMIT.
5. NEITHER THE HOWARD COUNTY COUNCIL OR THE HEALTH DEPARTMENT IS RESPONSIBLE FOR THE SUCCESSFUL OPERATION OF ANY SYSTEM.
6. PERMITTEE RESPONSIBLE FOR OBTAINING FINAL APPROVAL ON THIS PERMIT.

CALL 410-313-1771 FOR INSPECTION HOUSE CONNECTION

P 523743

NOT TO SCALE

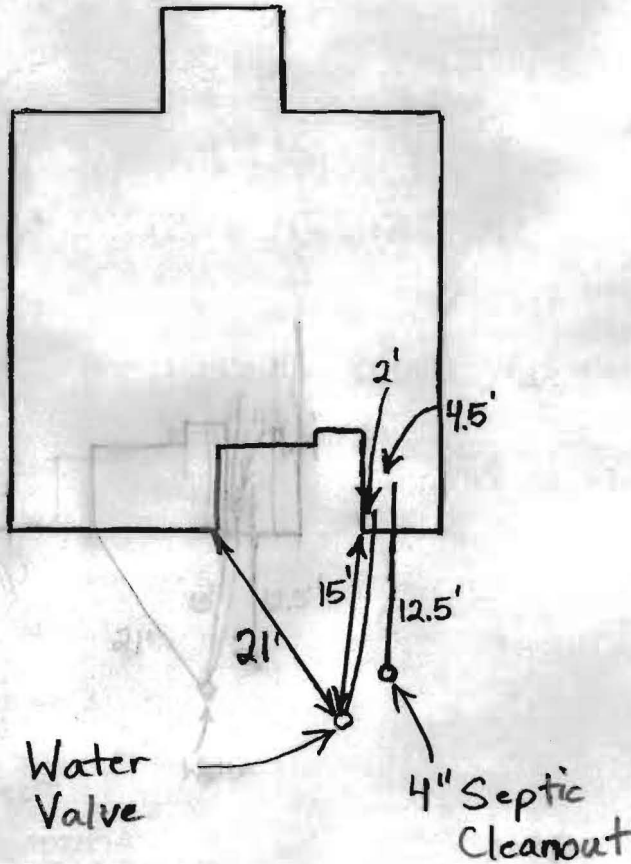

Windsor Moss

ROAD

TRENCH/DRAINFIELD DATA		
WIDTH	INLET	BOTTOM
_____	_____	_____
NUMBER OF TRENCHES _____		
TOTAL LENGTH _____		
ABSORPTION AREA _____		
DISTRIBUTION BOX LEVEL _____		
DISTRIBUTION BOX BAFFLE _____		
DISTRIBUTION BOX PORT _____		

SEPTIC TANK DATA	
SEPTIC TANK 1 LEVEL	_____
CAPACITY	_____ GAL
SEAM LOC	_____
TANK LID DEPTH	_____
BAFFLES	_____
BAFFLE FILTER	_____
MANHOLE LOC	_____
6" PORT LOC	_____
WATERTIGHT TEST	_____
SEPTIC TANK 2 LEVEL	_____
CAPACITY	_____ GAL
SEAM LOC	_____
TANK LID DEPTH	_____
BAFFLES	_____
BAFFLE FILTER	_____
MANHOLE LOC	_____
6" PORT LOC	_____
WATERTIGHT TEST	_____

PRE-CONSTRUCTION Septic 7.5' below ledge

INSTALLATION 1/12/2006 Water and septic connections done. Septic connection 7.5' below brick ledge. Water connection 5' below brick ledge (BB)

FINAL INSPECTOR B. Baker

DATE OF APPROVAL 1/12/2006

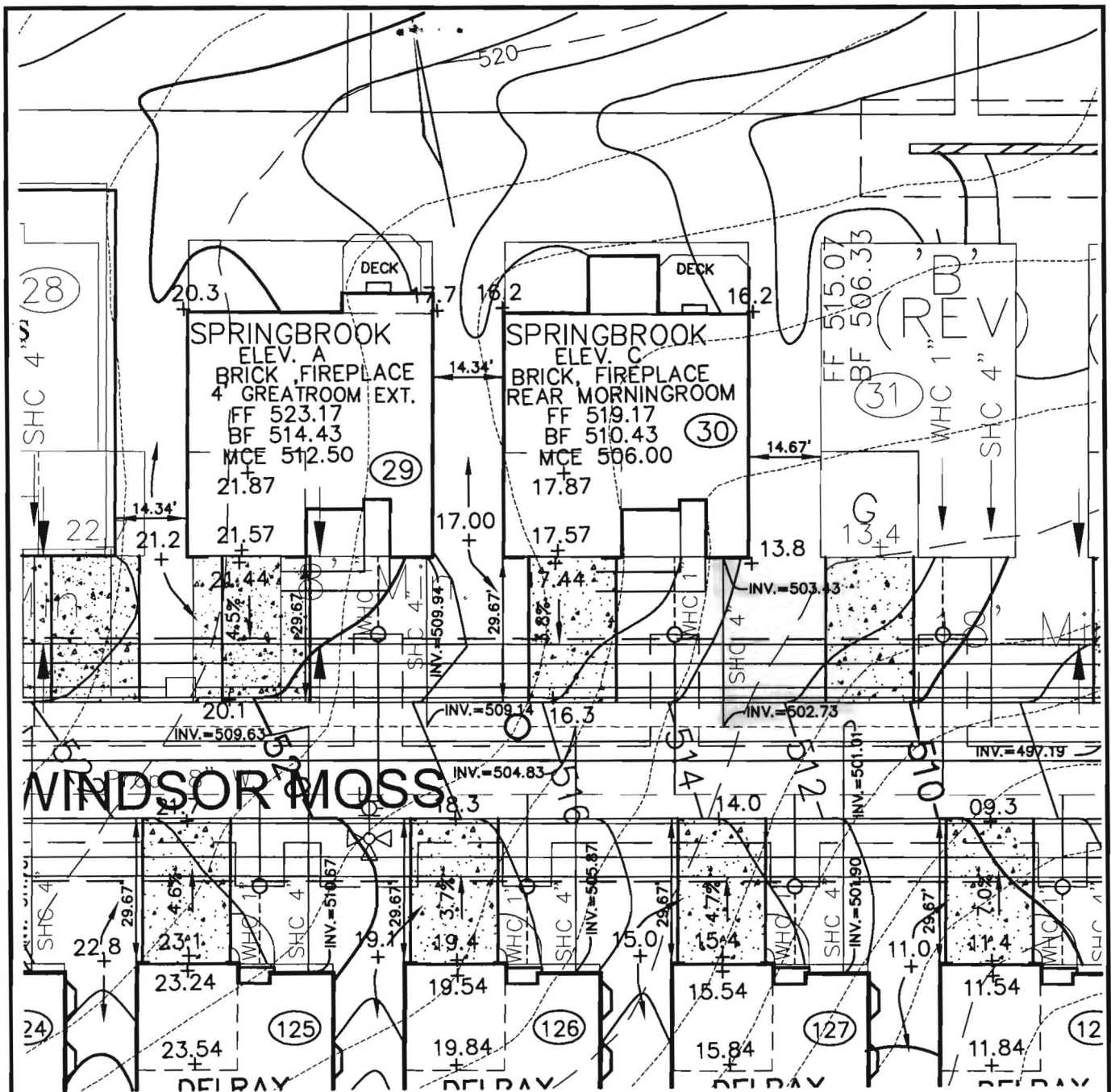

**ROBERT H. VOGEL**  
**ENGINEERING, INC.**  
 ENGINEERS • SURVEYORS • PLANNERS  
 8407 MAIN STREET TEL: 410.461.7666  
 ELLICOTT CITY, MD 21043 FAX: 410.461.8961

Approved Septic System Plan  
 ALL DIMENSION ARE FROM  
 HOWARD COUNTY HEALTH DEPARTMENT

*[Signature]*  
 Signature  
 11/8/05  
 Date

SCALE 1"=30'  
 DRAWN BY JCO  
 CHECKED BY RHV  
 DATE NOVEMBER, 2005  
 W. O. # 04-87.00  
 SHEET# 1 OF 1

**RYAN HOMES**  
**ELLICOTT MEADOWS**  
**UNIT 30**

HOMELAND SDP-03-30  
 TAX MAP 16  
 3RD ELECTION DISTRICT

PARCEL 53.96, 165&204  
 HOWARD COUNTY, MARYLAND



## HOWARD COUNTY HEALTH DEPARTMENT

Bureau of Environmental Health  
7178 Columbia Gateway Drive, Columbia MD 21046  
(410) 313-2640 FAX (410) 313-2648  
TDD (410) 313-2323 Toll Free 1-877-4MD-DHMH

---

*Penny E. Borenstein, M.D., M.P.H., County Health Officer*

March 17, 2006

NVR Inc.  
6085 Marshalee Drive, Suite 140  
Elkridge, Maryland 21075

**SENT VIA FACSIMILE 410-379-2430**

RE: Homeland, Lot 30  
12095 Windsor Moss  
Ellicott City, MD 21042  
BP # B00156891  
**PUBLIC WATER**

Dear Sirs or Madam:

This is to advise that the connection from the house to the street has been installed and inspected for the referenced property. A Community Septic System serves this dwelling. **Final approval was granted on 01/12/2006 by HCHD for the house connection.**

The property is served by public water and is therefore exempt from the Health Department water sampling requirements.

By issuance of this letter, this office recommends release of the Use and Occupancy permit for the referenced property.

### RECOMMENDATION FOR USE AND OCCUPANCY

Respectfully,

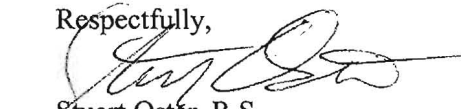

Stuart Ostér, R.S.  
Well and Septic Program

cc: DILP, Building Inspectors Office  
File