

LAYOUT \_\_\_\_\_

INSP 1 1/12/2006 INSP 3 \_\_\_\_\_

INSP 2 \_\_\_\_\_ INSP 4 \_\_\_\_\_

ISSUE DATE: 12/9/2005

P 523788

APPROVAL DATE: 1/12/2006

A \_\_\_\_\_

# PERMIT

INDEXED

TAX ID# 03-344827

## COMMUNITY SEPTIC SYSTEM HOUSE SEWER LINE CONNECTION

HOWARD COUNTY HEALTH DEPARTMENT  
BUREAU OF ENVIRONMENTAL HEALTH

NVR - NV HOMES IS PERMITTED TO INSTALL  ALTER

ADDRESS: \_\_\_\_\_ PHONE NUMBER: 301-290-0002

SUBDIVISION Homeland Unit # 4

ADDRESS: 12021 Windsor Moss PROPERTY OWNER: NVR Inc.

NUMBER OF BEDROOMS: 2

### HOUSE SERVED BY PUBLIC WATER

LOCATION:	Install 4" house sewer line connection per the approved site plan. Final acceptance of the sewer system will be subject to the approval of the Maryland Dept. of the Environment.
NOTES:	This permit is limited to the installation of the individual house sewer line connection.

PLANS APPROVED: Kevin J. Bell DATE: 10/27/05

### PERMIT VOID AFTER 2 YEARS

1. CONTRACTOR IS RESPONSIBLE FOR SCHEDULING A PRE-CONSTRUCTION INSPECTION FOR ALL INSTALLATIONS.
2. ALL PARTS OF SEPTIC SYSTEM SHALL BE 100 FEET FROM ANY WATER WELL UNLESS SPECIFICALLY AUTHORIZED.
3. CONTRACTOR RESPONSIBLE FOR COMPLIANCE WITH APPLICABLE REGULATIONS, GUIDELINES AND THE TERMS OF THIS PERMIT.
4. NEITHER THE HOWARD COUNTY COUNCIL OR THE HEALTH DEPARTMENT IS RESPONSIBLE FOR THE SUCCESSFUL OPERATION OF ANY SYSTEM.
5. PERMITTEE RESPONSIBLE FOR OBTAINING FINAL APPROVAL ON THIS PERMIT.

CALL 410-313-1771 FOR INSPECTION OF SEPTIC CONNECTION

**BUILDING PERMIT SIGNED  
AND RETURNED**

3/15/06 BOD 158544-DECK

P 523788

NOT TO SCALE

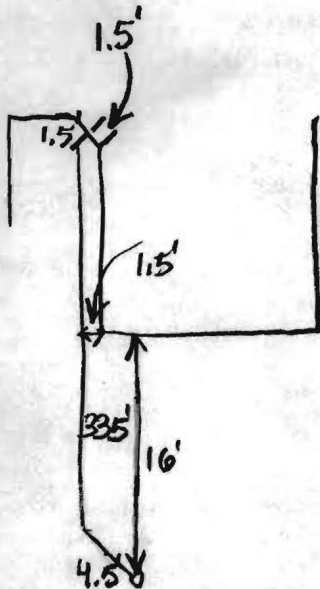

Area of Water Valve (Buried)

Windsor Moss

ROAD

TRENCH/DRAINFIELD DATA

WIDTH	INLET	BOTTOM
NUMBER OF TRENCHES		
TOTAL LENGTH		
ABSORPTION AREA		
DISTRIBUTION BOX LEVEL		
DISTRIBUTION BOX BAFFLE		
DISTRIBUTION BOX PORT		

SEPTIC TANK DATA

SEPTIC TANK 1 LEVEL	
CAPACITY	GAL
SEAM LOC	
TANK LID DEPTH	
BAFFLES	
BAFFLE FILTER	
MANHOLE LOC	
6" PORT LOC	
WATERTIGHT TEST	
SEPTIC TANK 2 LEVEL	
CAPACITY	GAL
SEAM LOC	
TANK LID DEPTH	
BAFFLES	
BAFFLE FILTER	
MANHOLE LOC	
6" PORT LOC	
WATERTIGHT TEST	

PRE-CONSTRUCTION

INSTALLATION 1/12/2006 Water and septic connections coming out of house at same location. Water line 8' below brick ledge and septic connection 8.5' below brick ledge.

BUILDING PERMIT SIGNED AND RETURNED

FINAL INSPECTOR B. Baker

DATE OF APPROVAL 1/12/2006

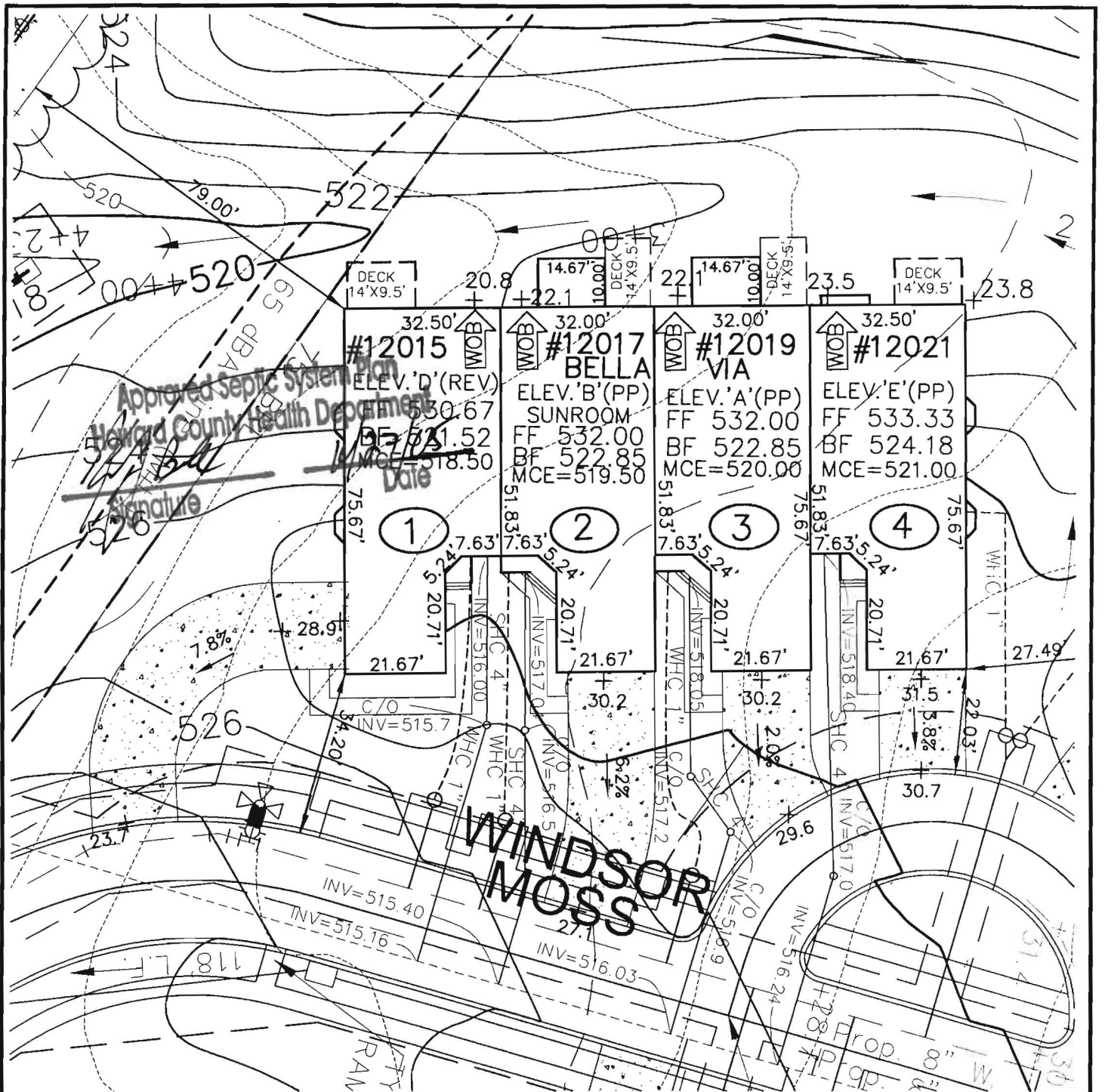

**ROBERT H. VOGEL  
ENGINEERING, INC.**

ENGINEERS • SURVEYORS • PLANNERS

8407 MAIN STREET TEL: 410.461.7666  
ELLCOTT CITY, MD 21043 FAX: 410.461.8961

SCALE \_\_\_\_\_ 1"=30'  
DRAWN BY \_\_\_\_\_ JCO  
CHECKED BY \_\_\_\_\_ RHV  
DATE \_\_\_\_\_ SEPT., 2005  
W. O. # \_\_\_\_\_ 04-139.00  
SHEET# \_\_\_\_\_ 1 OF 1

**NV HOMES  
ELLCOTT MEADOWS  
UNITS 1-4**

REV. 9/13/05  
HOMELAND SDP-03-30  
TAX MAP 16  
3RD ELECTION DISTRICT

PARCEL 53,96,165&204  
HOWARD COUNTY, MARYLAND

oods.

er's Operation and Maintenance Manuals

provide operations and maintenance

and at least 60 days prior to the date set for to the Owner five (5) Operation and id electrical systems and equipment include all installation, operation, start-up and ned in the manuals shall consist of catalogs, files, parts, lists, assembly drawings, wiring ve maintenance measures, approved working ary for the Owner to establish an effective

und in 3-ring loose-leaf binders and indexed. ove dimensions and placed in envelopes

Operator and/or Owner in understanding the mitations of the equipment as well as to nance. Technical and maintenance information and electrical components shall be included but not limited to, Operation Responsibilities, ss Design Criteria, Operational Modifications, mponent Equipment O&M, System Equipment and As-Built.

nce of the facilities will not be undertaken until nuals have been submitted. Partial approvals.

NH <sub>3</sub> -N	35	mg/L
Alkalinity (as CaCO <sub>3</sub> )	100	mg/L
pH	6.0 - 9.0	S.U.
Water Temperature Min.	15	°C
Water Temperature Max	28	°C
Air Temperature Min.	0	°F
Air Temperature Max	100	°F
Site Elevation	442	ft
<b>Effluent Characteristics</b>		
BOD <sub>5</sub> (20°C)	30	mg/L
Total Suspended Solids	30	mg/L
NH <sub>3</sub> -N	1.0	mg/L
Total Nitrogen (N)	10.0	mg/l
<b>Influent Pumping</b>		
Average design rate in	15.3	gpm
Peak rate in	61.2	gpm @ 4 x Avg.
Pump rate provided	70	gpm 1 pump (28'TDHD)

SBR R

M

T

D

Dosing

PUBLIC WATER +  
PRIVATE SHARED SEPTIC SYSTEM

SDP-03-030

HOMELAND SENIOR CENTER  
147 UNITS TOTAL  
EACH UNIT CAN ONLY  
BE A TOTAL OF 2 BEDROOMS

Approved Septic System Plan MDE  
~~Howard County Health Department~~

Approved Septic System Plan  
Howard County Health Department

  
Signature 9-2-03  
Date

  
Signature 9/2/03  
Date

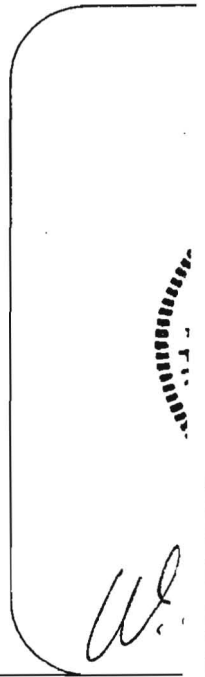



## HOWARD COUNTY HEALTH DEPARTMENT

Bureau of Environmental Health  
7178 Columbia Gateway Drive, Columbia MD 21046  
(410) 313-2640 FAX (410) 313-2648  
TDD (410) 313-2323 Toll Free 1-877-4MD-DHMH

*Penny E. Borenstein, M.D., M.P.H., County Health Officer*

2/24/2006

NVR Inc.  
6085 Marshalee Drive, Suite 140  
Elkridge, Maryland 21075

**SENT VIA FACSIMILE 410-379-2430**

RE: Homeland, Lot 4  
12021 Windsor Moss  
Ellicott City, MD 21043  
BP # B00155823  
**PUBLIC WATER**

Dear Sirs or Madam:

This is to advise that the connection from the house to the street has been installed and inspected for the referenced property. A Community Septic System serves this dwelling. **Final approval was granted on 1/12/2006 by HCHD for the house connection.**

The property is served by public water and is therefore exempt from the Health Department water sampling requirements.

By issuance of this letter, this office recommends release of the Use and Occupancy permit for the referenced property.

### RECOMMENDATION FOR USE AND OCCUPANCY

Respectfully,

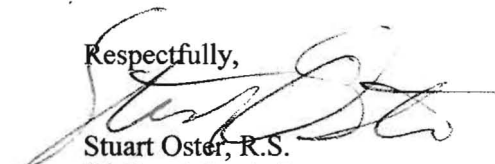

Stuart Oster, R.S.  
Well and Septic Program

cc: DILP, Building Inspectors Office  
File