

# APPLICATION

## FOR PERCOLATION TESTING AND SITE EVALUATION

TEST DATE(S) \_\_\_\_\_ TEST TIME \_\_\_\_\_ AP 523873

AGENCY REVIEW: \_\_\_\_\_ DATE 1/4/06

DO NOT WRITE ABOVE THIS LINE

I HEREBY APPLY FOR THE NECESSARY TESTING/EVALUATION PRIOR TO ISSUANCE OF SEWAGE DISPOSAL SYSTEM PERMIT(S) TO:

CHECK AS NEEDED:

- CONSTRUCT NEW SEPTIC SYSTEM(S)
- REPAIR/ADD TO AN EXISTING SEPTIC SYSTEM
- REPLACE AN EXISTING SEPTIC SYSTEM

CHECK AS NEEDED:

- NEW STRUCTURE(S)
- ADDITION TO AN EXISTING STRUCTURE
- REPLACE AN EXISTING STRUCTURE

CHECK ONE:

- CREATE NEW LOT(S)
- BUILD ON AN EXISTING LOT IN A SUBDIVISION
- BUILD ON AN EXISTING PARCEL OF RECORD

IS THE PROPERTY WITHIN 2500' OF ANY RESERVOIR?

- YES
- NO

THE TYPE OF STRUCTURE IS:

- RESIDENTIAL WITH 3 PROPOSED BEDROOMS IN THE COMPLETED STRUCTURE (NOTE **UNKNOWN** IF APPROPRIATE)
- COMMERCIAL (PROVIDE DETAIL OF NUMBERS AND TYPES OF EMPLOYEES/ CUSTOMERS ON ACCOMPANYING PLAN)
- INSTITUTIONAL/GOVERNMENT (PROVIDE DETAIL OF NUMBERS AND TYPES OF EMPLOYEES/USERS ON ACCOMPANYING PLAN)

PROPERTY OWNER(S) Gregory Gibson

DAYTIME PHONE 240 304-6088 CELL \_\_\_\_\_ FAX \_\_\_\_\_

MAILING ADDRESS 6017 Tulane Drive Clarksville md 21029  
STREET CITY/TOWN STATE ZIP

APPLICANT Fyock septic service

DAYTIME PHONE 240-882-4025 CELL 240 882-4025 FAX 410 531 1256

MAILING ADDRESS PO Box 89 Glenelg md 21737  
STREET CITY/TOWN STATE ZIP

APPLICANT'S ROLE: DEVELOPER BUILDER BUYER RELATIVE/FRIEND REALTOR CONSULTANT

PROPERTY LOCATION  
SUBDIVISION/PROPERTY NAME \_\_\_\_\_ LOT NO. \_\_\_\_\_

PROPERTY ADDRESS 6017 Tulane Dr E.C 21029  
STREET TOWN/POST OFFICE

TAX MAP PAGE(S) \_\_\_\_\_ GRID \_\_\_\_\_ PARCEL(S) \_\_\_\_\_ PROPOSED LOT SIZE \_\_\_\_\_

AS APPLICANT, I UNDERSTAND THE FOLLOWING: THE SYSTEM INSTALLED SUBSEQUENT TO THIS APPLICATION IS ACCEPTABLE ONLY UNTIL PUBLIC SEWERAGE IS AVAILABLE. THIS APPLICATION IS COMPLETE WHEN ALL APPLICABLE FEES AND A SUITABLE SITE PLAN HAVE BEEN RECEIVED. I ACCEPT THE RESPONSIBILITY FOR COMPLIANCE WITH ALL M.O.S.H.A. AND "MISS UTILITY" REQUIREMENTS. APPROVAL IS BASED UPON SATISFACTORY REVIEW OF A PERC CERTIFICATION PLAN.

TEST RESULTS WILL BE MAILED TO APPLICANT.

Robert Fyock  
SIGNATURE OF APPLICANT

HOWARD COUNTY HEALTH DEPARTMENT, BUREAU OF ENVIRONMENTAL HEALTH, WELL AND SEPTIC PROGRAM  
3525-H ELLICOTT MILLS DRIVE, ELLICOTT CITY, MARYLAND 21043-4544 (410) 313-1771 FAX (410) 313-2648  
TDD (410) 313-2323 TOLL FREE 1-877-4MD-DHMH

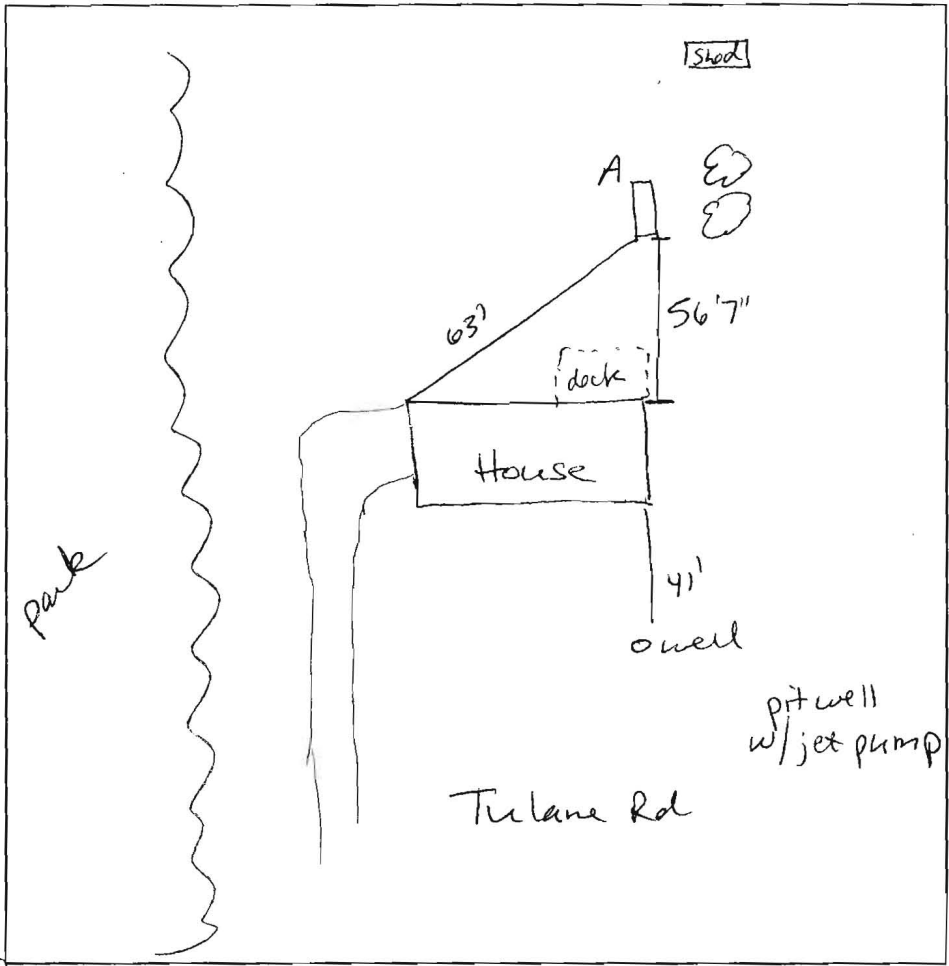
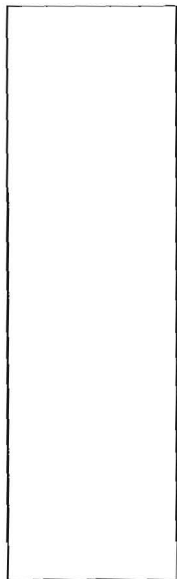

A

brown L  
 rot S  
 red  
 fine sl  
 sbk  
 micaceous  
 reddish yellow  
 fine sl  
 sg  
 micaceous  
 brownish yellow  
 coarse sl  
 sg  
 micaceous

5' solo sample ?

12.5' white/reddish yellow  
 15' sg



DATE	TEST #	DEPTH	START	BREAK 1" DROP	STOP 2" DROP	TIME OF 2nd INCH	P/F/H
1/6/06	A	54" / 15'	10:47 <sup>30</sup>	—	—	—	—
		6'	11:02 <sup>55</sup>	11:14	11:38	24	P

REMARKS NO gray water as seen in 1985 lines hooked up  
 SANITARIAN SF BACKHOE Fyock OTHERS to cement optic.  
 TEST HOLES USED IN SDA \_\_\_\_\_ AVG. PERC TIME \_\_\_\_\_ SQ. FT/BR \_\_\_\_\_  
 TRENCH WIDTH \_\_\_\_\_ INLET DEPTH \_\_\_\_\_ MAX. BOT DEPTH \_\_\_\_\_ EFFECTIVE SW \_\_\_\_\_

# FILE INQUIRY FORM

Property Address: \_\_\_\_\_

12/8/05 Site needs repair area established.  
Also needs to verify if there is  
a second system for wash water, excavate  
if needed. (SF) Owner is aware of this (SF)

12/6/06 = per completed repair area  
established. No gray to all lines  
hooked up to main sewer (SF)