

**TRACE LABORATORIES, INC**

5 North Park Drive

Hunt Valley, MD 21030 USA

Telephone: 410/584-9099 / Fax: 410/584-9117

Website: www.tracelabs.com / Email: [info@tracelabs.com](mailto:info@tracelabs.com)

Maryland State Certified Laboratory #318

**CERTIFICATE OF ANALYSIS****Requester:**

Brent Hanauer  
Rule 4 Building Group  
7081 Dorsey Run Road  
Elkridge, Maryland 21075

**S/O Number:** 84384**Report Date:** February 27, 2012

**Property Sampled:** 11715 Teri Lynn Drive, 20759  
**Sample Location:** Upstairs Bathroom Tap  
**Residual Chlorine:** <0.1 mg/L

**Building Permit #:** B1100333  
**Sampler ID #:** 0765AR  
**Samples Iced:** Yes

**County:** Howard  
**Map:** 41

**Subdivision:** Mooresfield  
**Parcel:** 416

**Lot #:** 4

**Date/Time Collected in Field:** February 24, 2012 @ 9:45 AM  
**Date/Time Received in Lab:** February 24, 2012 @ 11:45 AM

**Well Tag #:** HO-81-0105  
**Well Condition:** 2-Piece Cap, Satisfactory

**Water Treatment/Conditioning:** Softener

PARAMETER	METHOD	MCL/*SMCL	RESULT	PASS/FAIL
Total Coliform	SM 9223B	Absent	Absent	Pass
<i>E. coli</i>	SM 9223B	Absent	Absent	Pass

The results in this report relate only to those items tested. If any additional information or clarification of this report is required, please contact us. This test report shall not be reproduced except in full without the written approval of Trace Laboratories Inc.

  
Amanda Ragan  
Drinking Water Testing

MCL: Maximum Contamination Level, an enforceable level established by the EPA

\*SMCL: Secondary Maximum Contamination Level, a level recommended by the EPA

\*\*\*A non-enforceable parameter that may cause cosmetic effects or aesthetic effects (such as taste, color or odor) in drinking water.

**TRACE LABORATORIES, INC**

5 North Park Drive  
Hunt Valley, MD 21030 USA  
Telephone: 410/584-9099 / Fax: 410/584-9117  
Website: [www.tracelabs.com](http://www.tracelabs.com) / Email: [info@tracelabs.com](mailto:info@tracelabs.com)

Maryland State Certified Laboratory #318

**CERTIFICATE OF ANALYSIS****Requester:**

Brent Hanauer  
Rule 4 Building Group  
7081 Dorsey Run Road  
Elkridge, Maryland 21075

**S/O Number:** 84237**Report Date:** February 13, 2012

**Property Sampled:** 11715 Teri Lynn Drive, 20759  
**Sample Location:** Upstairs Bathroom Tap  
**Residual Chlorine:** <0.1 mg/L

**Building Permit #:** B1100333  
**Sampler ID #:** 0765AR  
**Samples Iced:** Yes

**County:** Howard  
**Map:** 41

**Subdivision:** Mooresfield  
**Parcel:** 416

**Lot #:** 4

**Date/Time Collected in Field:** February 10, 2012 @ 11:20 am  
**Date/Time Received in Lab:** February 10, 2012 @ 2:40 pm

**Well Tag #:** HO-81-0105  
**Well Condition:** 1-Piece Cap, Loose

**Water Treatment/Conditioning:** Softener

PARAMETER	METHOD	MCL/*SMCL	RESULT	PASS/FAIL
Total Coliform	SM 9223B	Absent	PRESENT	FAIL
<i>E. coli</i>	SM 9223B	Absent	Absent	Pass
Nitrate	SM 4500D	10 mg/L as N	4.6 mg/L as N	Pass
Turbidity	EPA 180.1	10 NTU	2.9 NTU	Pass
pH	EPA 150.1	*6.5-8.5 Units	6.6 Units	***
Sand		Absent	Absent	Pass

The results in this report relate only to those items tested. If any additional information or clarification of this report is required, please contact us. This test report shall not be reproduced except in full without the written approval of Trace Laboratories Inc.

Katherine C. Higgs  
Manager – Drinking Water Testing

MCL: Maximum Contamination Level, an enforceable level established by the EPA

\*SMCL: Secondary Maximum Contamination Level, a level recommended by the EPA

\*\*\*A non-enforceable parameter that may cause cosmetic effects or aesthetic effects (such as taste, color or odor) in drinking water.

SITE INSPECTION SHEET

OWNER: \_\_\_\_\_ PHONE #: \_\_\_\_\_  
ADDRESS: \_\_\_\_\_ CONTRACTOR: \_\_\_\_\_  
\_\_\_\_\_ WELL TAG #: \_\_\_\_\_  
SUBDIVISION: \_\_\_\_\_ LOT: \_\_\_\_\_ COUNTY #: \_\_\_\_\_  
PROPOSAL: \_\_\_\_\_

LOCATION DIAGRAM

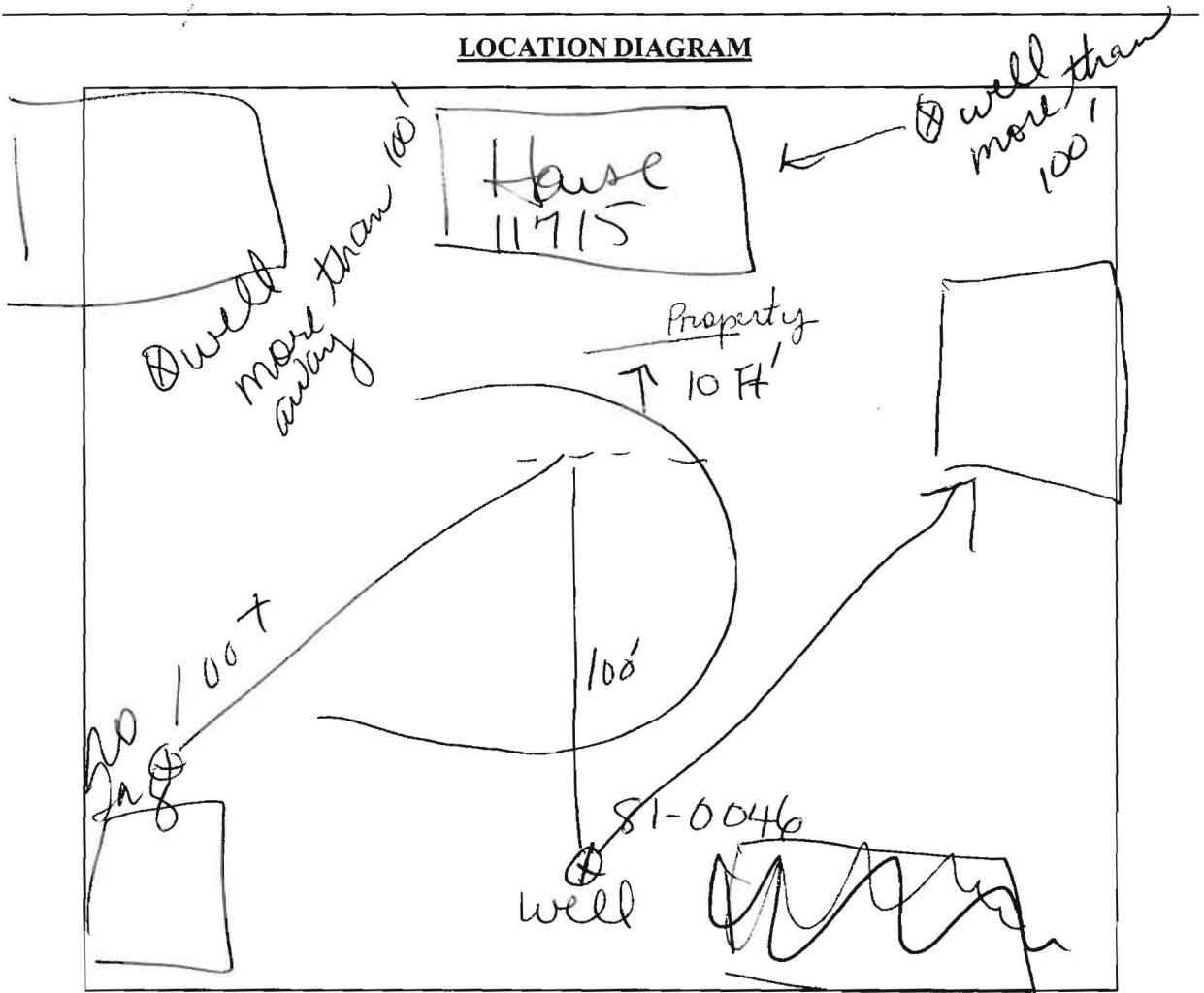

COMMENTS: \_\_\_\_\_  
\_\_\_\_\_  
\_\_\_\_\_  
\_\_\_\_\_

DATE: \_\_\_\_\_ INSPECTOR: \_\_\_\_\_