



Bureau of Environmental Health  
7178 Columbia Gateway Drive  
Columbia, MD 21046-2147  
(410) 313-2640 Fax (410) 313-2648  
TDD (410) 313-2323 Toll Free 1-866-313-6300  
website: [www.hchealth.org](http://www.hchealth.org)

---

Peter L. Beilenson, M.D., M.P.H., Health Officer

March 26, 2012

Richard Warfield  
6160 TEN OAKS ROAD  
CLARKSVILLE, MD 21029

**RE: Water Sample Results**  
**6160 TEN OAKS ROAD**  
**Invoice #: 26054**

Dear Richard Warfield,

We have received the results from the testing of the water sample(s) taken from the above referenced property on March 08, 2012. A description of the results and the established standards for each test is included below. Standards such as maximum contaminant levels (MCL), secondary maximum contaminant levels (SMCL), and drinking water equivalency levels (DWEL) are established by the EPA and other agencies to provide a reference for determining when action should be taken. These standards help to improve the overall quality of your water or ensure that steps are taken to treat the water to prevent you and your family from getting sick. Typically, no water is completely free of contamination but you should be concerned if the level of contamination for a particular test exceeds the standard.

The results from the **Bacteria** testing found that your well water sampled from the powder room faucet contains no bacteria at this time and is considered safe for all uses. According to drinking water standards there should be no bacteria present.

A sample was collected to determine the **Nitrate** level in your water supply. The nitrate level was 4.86 parts per million. The MCL for nitrate is 10.0 parts per million.

The results from the **Bacteria** testing found that your well water sampled from the bathroom faucet contains no bacteria at this time and is considered safe for all uses. According to drinking water standards there should be no bacteria present.

A sample was collected to determine the **Nitrate** level in your water supply. The nitrate level was 0.56 parts per million. The MCL for nitrate is 10.0 parts per million.

Please contact the Health Department at (410) 313-1773 between 8:30 a.m. and 4:30 p.m., Monday through Friday if you have any questions regarding these test results.



Bureau of Environmental Health  
7178 Columbia Gateway Drive  
Columbia, MD 21046-2147  
(410) 313-2640 Fax (410) 313-2648  
TDD (410) 313-2323 Toll Free 1-866-313-6300  
website: [www.hchealth.org](http://www.hchealth.org)

---

Peter L. Beilenson, M.D., M.P.H., Health Officer

Sincerely,

Ramar Martin, R.S.  
Community Hygiene Program

Enclosures

**STATE OF MARYLAND  
DEPARTMENT OF HEALTH AND MENTAL HYGIENE  
LABORATORIES ADMINISTRATION**

201 W. Preston Street  
P.O. Box 2355, Baltimore, MD 21203  
John M. DeBoy, Dr. P.H., Director

160884

Category Code 4G

Lab. No. \_\_\_\_\_

**Bacteriological Drinking Water Report**

NV#: 26055

**Field Record**

<b>Sample Type:</b> Community <input type="checkbox"/> Non-Community <input type="checkbox"/> Non-Transient <input type="checkbox"/> Private <input checked="" type="checkbox"/> Check Sample <input type="checkbox"/> C.O.P. <input type="checkbox"/>	Source <u>RICHARD WARFIELD</u>
	Location <u>6160 TEN OAKS ROAD, CLARKVILLE, MD</u>
	Iced: Yes <input checked="" type="checkbox"/> No <input type="checkbox"/> <span style="float:right"><input checked="" type="checkbox"/> a.m. <input type="checkbox"/> p.m.</span>
	Treated: Yes <input checked="" type="checkbox"/> No <input type="checkbox"/> Time Collected <u>10:00</u>
	Collector# <u>656920</u> Bottle No. <u>HC 6160</u>
Collector Name <u>LORESANYA</u> County <u>HOWARD</u>	

<b>Test Requested:</b> Quantitative <input checked="" type="checkbox"/> P/A <input type="checkbox"/> MTF <input type="checkbox"/> SPC <input type="checkbox"/>	1 3				03 08 12
	County	Plant No.	Sampling Station	Date Collected	
	pH <u>6.5</u>	Res. Cl: Free <u>000</u>	Total <u>00</u>	Card#	

**LABORATORY RECORD**

Thiosulfate: Pres. ☒ Absent ☐ Undetermined ☐

**PRESUMPTIVE MTF • P/A TEST\***

ml of Sample	10 ml.	100 ml.
Gas, 24 hours		
Gas, 48 hours		

**CONFIRMED • P/A TEST**

ml of Sample	10 ml.	100 ml.	No. of +
Coliforms +			
Fecal Coliforms +			

**P/A TEST (CONFIRMED) \*\*\***

ml. of Sample	100 ml.
Total Coliforms	
E. coli	

**QUANTITATIVE TEST (CONFIRMED) \*\*\***

100 ml. of Sample	No. of Pos	MPN
Total Coliforms	0	<1
E. coli	0	<1

SPC Plate:

A

B

24.48.72 hrs/Heterotrophic Plate Count (HPC/ml)§ =

Temp. Control

3.5°C

- \* using Lauryl Sulfate Trypticase Broth at 35° C incubation
- † using Brilliant Green Lactose Bile Broth at 35° C incubation
- ‡ using EC Broth at 44.5° C incubation
- § using Plate Count Agar at 35° C incubation
- \*\*\* using ONPG-MUG at 35° C incubation

Remarks

COL-18

Date & Hour  
MAR 8 '12 PM 2:44

MAR 8 '12 PM 6:59

MAR 9 '12 PM 1:18

Laboratory

Rec'd

E. SHORE REG. ☐

Exam

CENTRAL ☒

W. MD REG. ☐

Rep

Bacteriologist

E. Kung

**Howard County Health Department**  
**Bureau of Environmental Health**  
**7178 Columbia Gateway Drive**  
**Columbia, Maryland 21046**

## DEPARTMENT OF HEALTH AND MENTAL HYGIENE

**Laboratories Administration**  
201 W. Preston St.  
P.O. Box 2365, Baltimore, Maryland 21203



E12004706002

Received: 03/08/2012

Inorganic

HC 6160

## WATER ANALYSIS

File #: 26055

SAMPLE ID	Bottle Number	HC 6160		Name	RICHARD WARFIELD		County	HOWARD		County Code	13	
	Source	6160 TEN OAKS ROAD CLARKSVILLE, MD. 21029						Data Category Code	44			
	Collected: Date	03-08-2012		Time	10:00AM		Collector & Phone	/DANU 095ANYA		Submitter Code		
	CHECK (one per box)											
	Drinking Water	<input checked="" type="checkbox"/>	Community	<input type="checkbox"/>	Source (new water)	<input type="checkbox"/>	Emergency	<input type="checkbox"/>	Federal Project	S		
Landfill	<input type="checkbox"/>	Non-community	<input type="checkbox"/>	Distribution (treated)	<input type="checkbox"/>	Routine	<input type="checkbox"/>					
Stream	<input type="checkbox"/>	Private	<input type="checkbox"/>	MCL	<input type="checkbox"/>	Backlog	<input type="checkbox"/>					
Other	<input type="checkbox"/>	Other	<input type="checkbox"/>			Special	<input type="checkbox"/>					

FIELD

Plant No.      Sampling Station      Preservation: Iced ☒ Acid ☒ Type of Acid H<sub>2</sub>SO<sub>4</sub>

pH  6.5 Chlorine: Free  0.0 Total  0.0 Specific Conductance      93

Notes to Lab/Remarks: SAMPLE IS TAKEN FROM THE FIRST FLOOR POWDER ROOM.

[illegible]

\* Results reported in Units, all others in milligrams per liter (ppm)

Number of  
Tests Requested

0	1
---	---

Section Chief

Date  
Reported

DMMH 90-A 7/04

**SUBMITTER'S COPY**

State of Maryland  
DHMH-Laboratories Administration  
Division of Environmental Chemistry  
**INORGANICS ANALYTICAL LABORATORY**  
201 W. Preston Street, Baltimore, Maryland 21201  
Robert Myers, Ph.D., Director

**Certificate of Analysis**

HOWARD CO ENVIRONMENTAL HLTH  
7178 COLUMBIA GATEWAY DRIVE  
COLUMBIA, MD 21046

Lab Project No E12004706 Date Coll. 03/08/2012 Date Received: 03/08/2012 Submitted By: I. Oresanya

Field ID: HC 6160  
Lab No.: E12004706002

<u>Analyte</u>	<u>Method</u>	<u>Result</u>	<u>Units</u>	<u>Date Analyzed</u>
Nitrate + Nitrite, as N	EPA 353.2	4.86	mg N/L	03/12/2012

**Comments:**

RECEIVED  
HOWARD COUNTY  
2012 MAR 20 PM 2:06

Approved by:

*Shahin Amini*

Approval date: 03/13/2012

This document contains confidential health information that is privileged, confidential and exempt from disclosure under law. If you have received this information in error, please call (410) 767-5034 and arrange for return or destruction.

Telephone: (410) 767 - 5034

Fax: (410) 225 - 7297

S:\EnviroFinal-InorganicsA.rpt

STATE OF MARYLAND  
DEPARTMENT OF HEALTH AND MENTAL HYGIENE  
LABORATORIES ADMINISTRATION

201 W. Preston Street  
P.O. Box 2355, Baltimore, MD 21203  
John M. DeBoy, Dr. P.H., Director

160883

Category Code 4G Lab. No. \_\_\_\_\_

Bacteriological Drinking Water Report

NV #: 26054

Field Record

Sample Type:  
Community ☐  
Non-Community ☐  
Non-Transient ☐  
Private ☒  
Check Sample ☐  
C.O.P. ☐

Source RICHARD WARFIELD  
Location 12825 BRIGHTON DAM RD. CLARKSVILLE, MD  
Iced: Yes ☒ No ☐ a.m. ☒ p.m. ☐  
Treated: Yes ☒ No ☐ Time Collected 10:30  
Collector# 656910 Bottle No. HC 12825  
Collector Name LORESANYA County HOWARD

Test Requested:  
Quantitative ☒  
P/A ☐  
MTF ☐  
SPC ☐

pH 8.0 Res. Cl: Free 000 Total 00 Card# 03 08 12

County 13 Plant No. 0000 Sampling Station 0000 Date Collected 03 08 12

LABORATORY RECORD

Thiosulfate: Pres. ☒ Absent ☐ Undetermined ☐

PRESUMPTIVE MTF • P/A TEST\*

ml of Sample	10 ml.	100 ml.
Gas. 24 hours		
Gas. 48 hours		

CONFIRMED • P/A TEST

ml of Sample	10 ml.	100 ml.	No. of +
Coliforms +			
Fecal Coliforms +			

P/A TEST (CONFIRMED) \*\*\*

ml. of Sample	100 ml.
Total Coliforms	
E. coli	

QUANTITATIVE TEST (CONFIRMED) \*\*\*

100 ml. of Sample	No. of Pos	MPN
Total Coliforms	0	<1
E. coli	0	<1

SPC Plate: A            B             
24.48.72 hrs/Heterotrophic Plate Count (HPC/ml)§ =           

Temp. 35°C  
Control           

- \* using Lauryl Sulfate Trypticase Broth at 35° C incubation
- † using Brilliant Green Lactose Rik Broth at 35° C incubation
- ‡ using EC Broth at 44.5° C incubation
- § using Plate Count Agar at 35° C incubation
- \*\*\* using ONPG-MUG at 35° C incubation

Remarks COL-1A  
Date & Hour R 8:12 PM 2:44  
Laboratory           

Rec'd            E. SHORE REG. ☐  
Exam            CENTRAL ☒ W. MD REG. ☐  
Rept.            Bacteriologist E. Kinney

MAR 8:12 PM 6:59  
MAR 9:12 PM 1:18

**Howard County Health Department**  
**Bureau of Environmental Health**  
**7178 Columbia Gateway Drive**  
**Columbia, Maryland 21046**

## DEPARTMENT OF HEALTH AND MENTAL HYGIENE

**Laboratories Administration**  
201 W. Preston St.  
P.O. Box 2355, Baltimore, Maryland 21203



**E12004706003**

Received: 03/08/2012

## Inorganic

HC 12825

## WATER ANALYSIS

S A M P L E  I D	Bottle Number	HC 12825	Name	RICHARD WARFIELD	County	HOWARD	County Code	13	
	Source	12825 BRIGHTON DAM ROAD CLARKSVILLE, MD 21029					Date Category	44	
	Collected: Date	03/08/2012	Time	10:30AM	Collector & Phone	100W4 OREGANYA		Submitter Code	
	CHECK (one per box)	410-313-4259							
	Drinking Water	<input checked="" type="checkbox"/>	Community	<input type="checkbox"/>	Source (raw water)	<input type="checkbox"/>	Emergency	<input type="checkbox"/>	
Landfill	<input type="checkbox"/>	Non-Community	<input type="checkbox"/>	Distribution (treated)	<input checked="" type="checkbox"/>	Routing	<input type="checkbox"/>		
Stream	<input type="checkbox"/>	Private	<input type="checkbox"/>	MCL	<input type="checkbox"/>	Backlog	<input type="checkbox"/>		
Other	<input type="checkbox"/>	Other	<input type="checkbox"/>			Special	<input type="checkbox"/>		
							Federal Project	5	

FIELD	Plant No.	<div></div> <div></div> <div></div> <div></div>	Sampling Station	<div></div> <div></div> <div></div> <div></div>	Preservation: Iced	<input checked="" type="checkbox"/>	Acid	<input checked="" type="checkbox"/>	Type of Acid	H <sub>2</sub> SO <sub>4</sub>
	pH	<div>8.0</div>	Chlorine: Free	<div>0.0</div>	Total	<div>0.0</div>	Specific Conductance	<div></div> <div></div> <div></div> <div></div>		
	Notes to Lab/Remarks: SAMPLE IS TAKEN FROM THE BATHROOM SINK.									

[illegible]

\* Results reported in Units, all others in milligrams per liter (ppm)

Number of  
Tests Requested

0	1
---	---

Section Chief

Date  
Reported

DHMH 90-A 7/04

**SUBMITTER'S COPY**

RECEIVED  
HOWARD COUNTY HEALTH DEPT  
FIVE DOWNEY  
2012 MAR 20 PM 2:06

State of Maryland  
DHMH-Laboratories Administration  
Division of Environmental Chemistry  
**INORGANICS ANALYTICAL LABORATORY**  
201 W. Preston Street, Baltimore, Maryland 21201  
Robert Myers, Ph.D., Director

**Certificate of Analysis**

HOWARD CO ENVIRONMENTAL HLTH  
7178 COLUMBIA GATEWAY DRIVE  
COLUMBIA, MD 21046

Lab Project No E12004706 Date Coll. 03/08/2012 Date Received: 03/08/2012 Submitted By: I. Oresanya

Field ID: HC 12825

Lab No.: E12004706003

<u>Analyte</u>	<u>Method</u>	<u>Result</u>	<u>Units</u>	<u>Date Analyzed</u>
Nitrate + Nitrite, as N	EPA 353.2	0.56	mg N/L	03/12/2012

**Comments:**

RECEIVED  
HOWARD COUNTY HEALTH DEPARTMENT  
2012 MAR 20 PM 2:06

Approved by:

Shahin Ali

Approval date: 03/13/2012

This document contains confidential health information that is privileged, confidential and exempt from disclosure under law. If you have received this information in error, please call (410) 767-5034 and arrange for return or destruction.

Telephone: (410) 767 - 5034

Fax: (410) 225 - 7297

S:\EnviroFinal-InorganicsA.rpt



SITE INSPECTION SHEET

Primary Residence

OWNER: Richard Warfield

PHONE #: \_\_\_\_\_

ADDRESS: 6160 Ten Oaks

CONTRACTOR: \_\_\_\_\_

Clarks ville

21029

WELL TAG #: \_\_\_\_\_

SUBDIVISION: Tax Map 34

LOT: Parcel 43

COUNTY #: \_\_\_\_\_

PROPOSAL: Frank Warfield Property (Persimmon Bottom Farm)

Replace old addition with new addition (2-story; -2 Bedroom + 1 Bedroom) Net (-1) Bedroom

LOCATION DIAGRAM

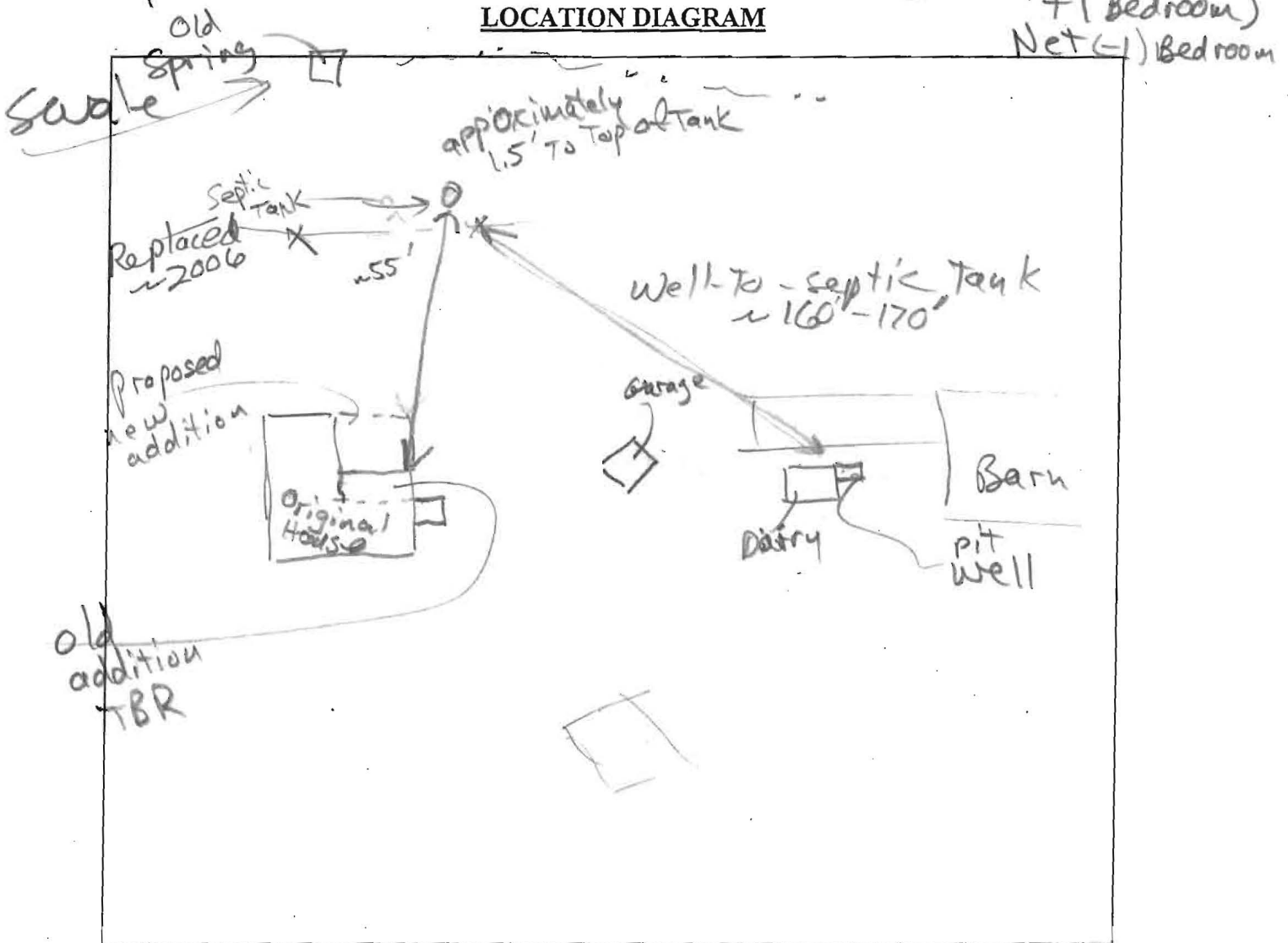

COMMENTS: Pit well ~6' deep; Casing (metal) extends ~3 1/2' above concrete floor; Concrete block enclosure (~5' x 5') with metal covered top and lid. Pitless adapter ~10"-12" above floor. Electrical conductor thru cap; submersible pump. Pressure tank in Pit.

DATE: 5/7/2012

INSPECTOR: R. Buick

walk over of septic system area; no evidence of waste water on surface

SITE INSPECTION SHEET

OWNER: Richard Warfield PHONE #: \_\_\_\_\_  
ADDRESS: 12825 Brighton Dam CONTRACTOR: \_\_\_\_\_  
WELL TAG #: \_\_\_\_\_  
SUBDIVISION: Tax Map 34 LOT: Parcel 43 COUNTY #: \_\_\_\_\_  
PROPOSAL: Tenant House\*

LOCATION DIAGRAM

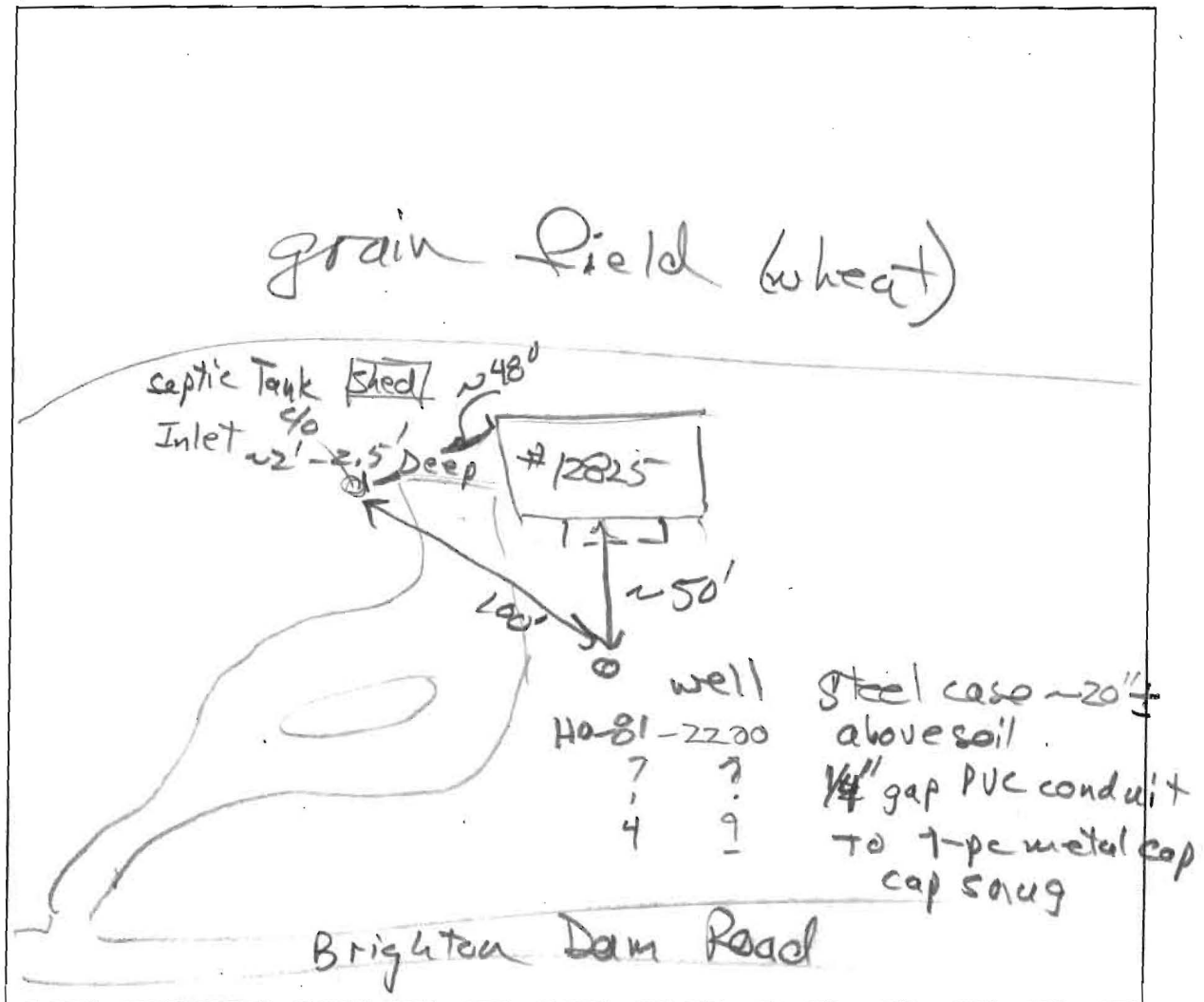

COMMENTS: Well casing was extended from only 3'-4" above soil  
Septic System Distribution not observed,  
however no evidence of breakout on or  
near soil surface

DATE: 5/7/2012 INSPECTOR: R. Buda