

The information shown on this plan is correct to the best of my knowledge and belief.

W. Bender

Date *12/12/07*

Approved for Private Water and Sewerage Systems

Michael J. Janni

Date *12/21/07*

for *Howard County Health Officer*

GAC

Notes:

- 1) Topography shown on the plan is from Howard County GIS and is field verified.
- 2) The existing structure will remain
- 3) The proposed addition is shown on the drawing.
- 4) Well and Septic Systems on the property are shown on the drawing.
- 5) Adjacent wells and septic systems will not be impacted by this proposal. The adjacent wells are greater than 100 feet from the proposed septic reserve area. No wells exist within 200 feet downslope.
- 6) Any changes to a private sewage easement shall require a revised percolation certification plan.

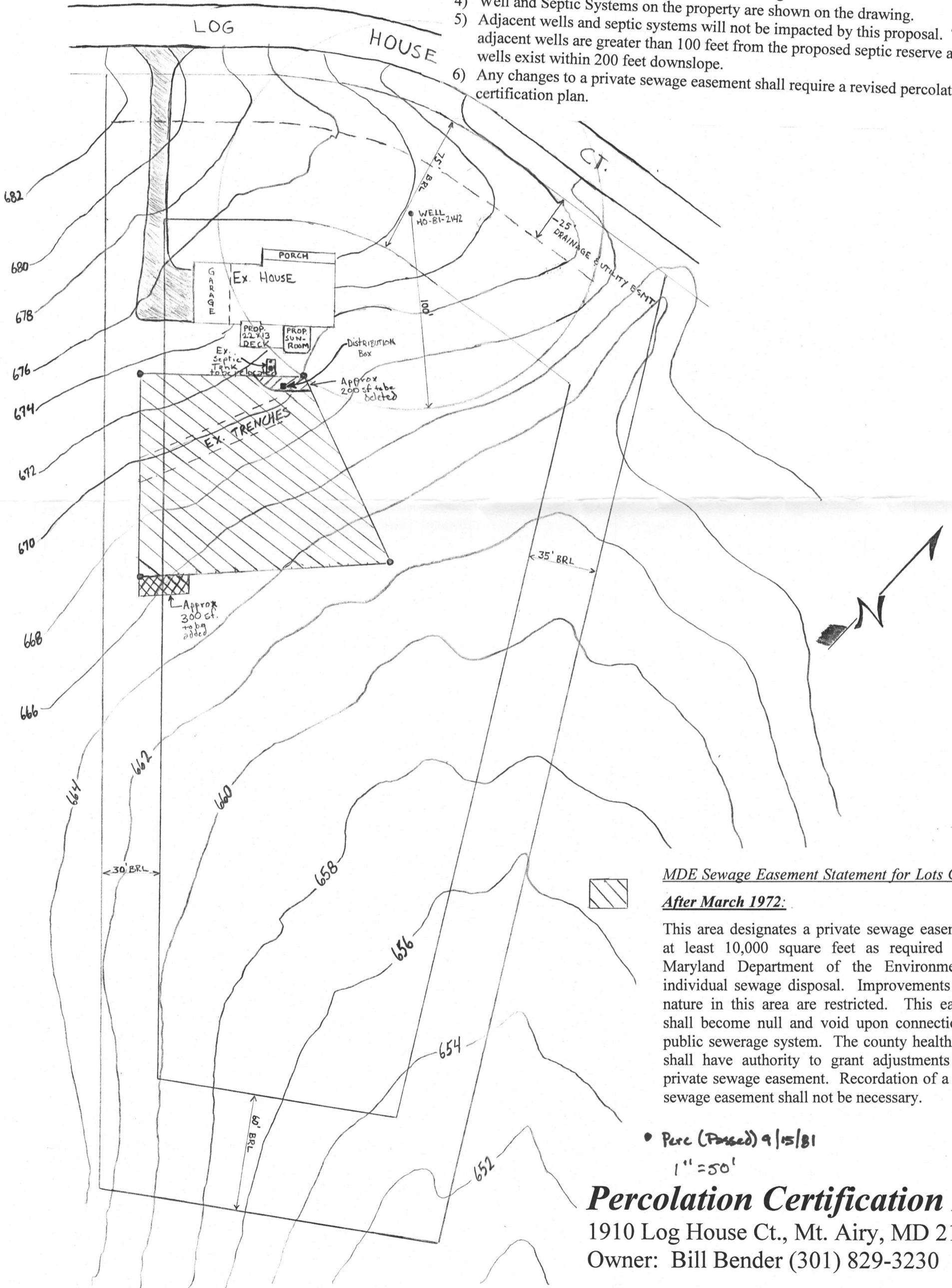

MDE Sewage Easement Statement for Lots Created After March 1972:

This area designates a private sewage easement of at least 10,000 square feet as required by the Maryland Department of the Environment for individual sewage disposal. Improvements of any nature in this area are restricted. This easement shall become null and void upon connection to a public sewerage system. The county health officer shall have authority to grant adjustments to the private sewage easement. Recordation of a revised sewage easement shall not be necessary.

• Perc (Passed) 9/15/81

1" = 50'

Percolation Certification Plan

1910 Log House Ct., Mt. Airy, MD 21771

Owner: Bill Bender (301) 829-3230

The information shown on this plan is correct to the best of my knowledge and belief.

Bill Bender

Date 12/12/07

Approved for Private Water and Sewerage Systems

Richard J. Davis

Date 12/21/07

For Howard County Health Officer

GAZ

Notes:

- 1) Topography shown on the plan is from Howard County GIS and is field verified.
- 2) The existing structure will remain
- 3) The proposed addition is shown on the drawing.
- 4) Well and Septic Systems on the property are shown on the drawing.
- 5) Adjacent wells and septic systems will not be impacted by this proposal. The adjacent wells are greater than 100 feet from the proposed septic reserve area. No wells exist within 200 feet downslope.
- 6) Any changes to a private sewage easement shall require a revised percolation certification plan.

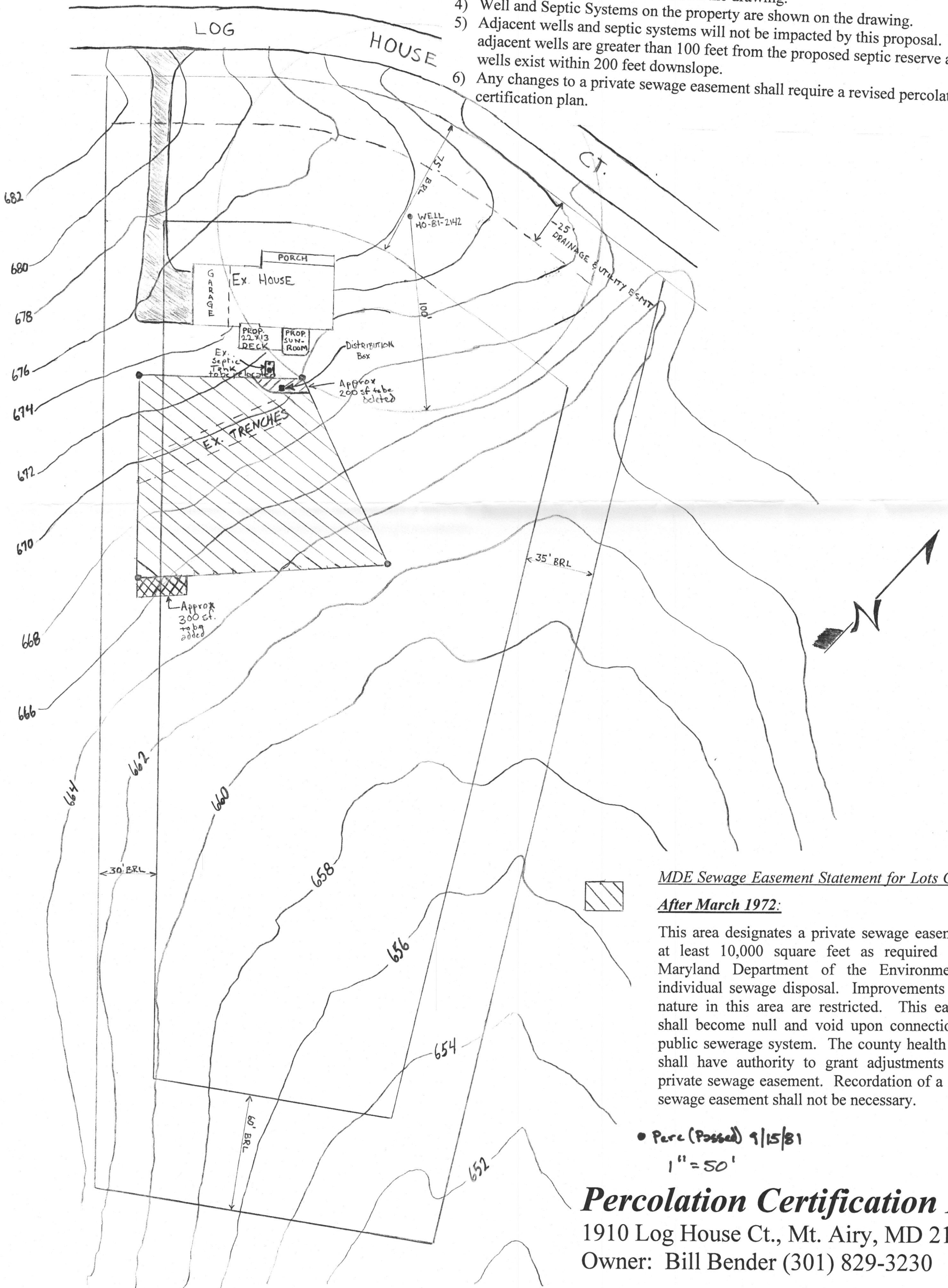

MDE Sewage Easement Statement for Lots Created After March 1972:

This area designates a private sewage easement of at least 10,000 square feet as required by the Maryland Department of the Environment for individual sewage disposal. Improvements of any nature in this area are restricted. This easement shall become null and void upon connection to a public sewerage system. The county health officer shall have authority to grant adjustments to the private sewage easement. Recordation of a revised sewage easement shall not be necessary.

• Perc (Passed) 9/15/81
1" = 50'

Percolation Certification Plan
1910 Log House Ct., Mt. Airy, MD 21771
Owner: Bill Bender (301) 829-3230