

Building Permit Application

Howard County Maryland
Department of Inspections, Licenses and Permits
3430 Court House Drive
Permits: 410-313-2455
www.howardcountymd.gov

Date Received: _____

Permit No.: _____

Building Address: 13722 Wye River Dr.
City: Dayton State: MD Zip Code: 21036
Suite/Apt. # _____ SDP/WP/BA #: _____
Census Tract: _____ Subdivision: _____
Section: _____ Area: _____ Lot: _____
Tax Map: _____ Parcel: _____ Grid: _____
Zoning: _____ Map Coordinates: _____ Lot Size: _____

Existing Use: storage
Proposed Use: finished basement space
Estimated Construction Cost: \$ 19,000
Description of Work: Framing and drywalling
unfinished storage space in basement
Will be used as theater room.

Occupant or Tenant: _____
Was tenant space previously occupied? ☐ Yes ☐ No
Contact Name: _____
Address: _____
City: _____ State: _____ Zip Code: _____
Phone: _____ Fax: _____
Email: _____

Property Owner's Name: Aaron Vernon
Address: 13722 Wye River Dr.
City: Dayton State: MD Zip Code: 21036
Phone: 732-672-1842 Fax: _____
Email: _____

Applicant's Name & Mailing Address, (If other than stated herein)
Applicant's Name: Joe Nordvedt
Address: 13720 Howard Rd.
City: Dayton State: MD Zip Code: 21036
Phone: 443-531-5567 Fax: _____
Email: _____

Contractor Company: Chestnut Pines Contracting
Contact Person: Joe Nordvedt
Address: 13720 Howard Rd.
City: Dayton State: MD Zip Code: 21036
License No.: 103795
Phone: 443-745-0330 Fax: _____
Email: _____

Engineer/Architect Company: _____
Responsible Design Prof.: _____
Address: _____
City: _____ State: _____ Zip Code: _____
Phone: _____ Fax: _____
Email: _____

Commercial Building Characteristics	Residential Building Characteristics
Height:	<input checked="" type="checkbox"/> SF Dwelling <input type="checkbox"/> SF Townhouse
No. of stories:	Depth Width
Gross area, sq. ft./floor:	1 st floor:
	2 nd floor:
Area of construction (sq. ft.):	Basement:
	<input checked="" type="checkbox"/> Finished Basement
Use group:	<input type="checkbox"/> Unfinished Basement
	<input type="checkbox"/> Crawl Space
Construction type:	<input type="checkbox"/> Slab on Grade
<input type="checkbox"/> Reinforced Concrete	No. of Bedrooms:
<input type="checkbox"/> Structural Steel	Multi-family Dwelling
<input type="checkbox"/> Masonry	No. of efficiency units:
<input type="checkbox"/> Wood Frame	No. of 1 BR units:
<input type="checkbox"/> State Certified Modular	No. of 2 BR units:
	No. of 3 BR units:
	Other Structure:
	Dimensions:
➤ Roadside Tree Project Permit	Footings:
<input type="checkbox"/> Yes <input type="checkbox"/> No	Roof:
Roadside Tree Project Permit #	<input type="checkbox"/> State Certified Modular
	<input type="checkbox"/> Manufactured Home

Utilities
Water Supply
<input type="checkbox"/> Public
<input checked="" type="checkbox"/> Private
Sewage Disposal
<input type="checkbox"/> Public
<input checked="" type="checkbox"/> Private
Electric: <input type="checkbox"/> Yes <input type="checkbox"/> No
Gas: <input type="checkbox"/> Yes <input type="checkbox"/> No
Heating System
<input checked="" type="checkbox"/> Electric <input type="checkbox"/> Oil
<input type="checkbox"/> Natural Gas <input type="checkbox"/> Propane Gas
Other:
Sprinkler System:
<input type="checkbox"/> Yes <input type="checkbox"/> No
Grading Permit Number:
Building Shell Permit Number:

THE UNDERSIGNED HEREBY CERTIFIES AND AGREES AS FOLLOWS: (1) THAT HE/SHE IS AUTHORIZED TO MAKE THIS APPLICATION; (2) THAT THE INFORMATION IS CORRECT; (3) THAT HE/SHE WILL COMPLY WITH ALL REGULATIONS OF HOWARD COUNTY WHICH ARE APPLICABLE THERETO; (4) THAT HE/SHE WILL PERFORM NO WORK ON THE ABOVE REFERENCED PROPERTY NOT SPECIFICALLY DESCRIBED IN THIS APPLICATION; (5) THAT HE/SHE GRANTS COUNTY OFFICIALS THE RIGHT TO ENTER ONTO THIS PROPERTY FOR THE PURPOSE OF INSPECTING THE WORK PERMITTED AND POSTING NOTICES.

Applicant's Signature: Joe Nordvedt
Email Address: Joe@chestnutpinescontracting.com
Owner/Company: Chestnut Pines Contracting

Print Name: Joe Nordvedt
Date: 7/2/15

Checks Payable to: DIRECTOR OF FINANCE OF HOWARD COUNTY
PLEASE WRITE NEATLY & LEGIBLY
-FOR OFFICE USE ONLY-

AGENCY	DATE	SIGNATURE OF APPROVAL
State Highways		
Building Officials		
PSZA (Zoning)		
PSZA (Engineering)		
Health	<u>7/2/15</u>	<u>[Signature]</u>
Is Sediment Control approval required for issuance? <input type="checkbox"/> Yes <input checked="" type="checkbox"/> No		
<input type="checkbox"/> CONTINGENCY CONSTRUCTION START		

DPZ SETBACK INFORMATION
Front:
Rear:
Side:
Side St.:
All minimum setbacks met? <input type="checkbox"/> Yes <input type="checkbox"/> No
Is Entrance Permit Required? <input type="checkbox"/> Yes <input type="checkbox"/> No
Historic District? <input type="checkbox"/> Yes <input type="checkbox"/> No
Lot Coverage for New Town Zone:
SDP/Red-line approval date:

Filing Fee	\$
Permit Fee	\$
Tech Fee	\$
Excise Tax	\$
PSFS	\$
Guaranty Fund	\$
Add'l per Fee	\$
Total Fees	\$
Sub-Total Paid	\$
Balance Due	\$
Check	#

Distribution of Copies: White: Building Officials

Green: PSZA,Zoning

Yellow: PSZA,Engineering

Pink: Health

Gold: SHA

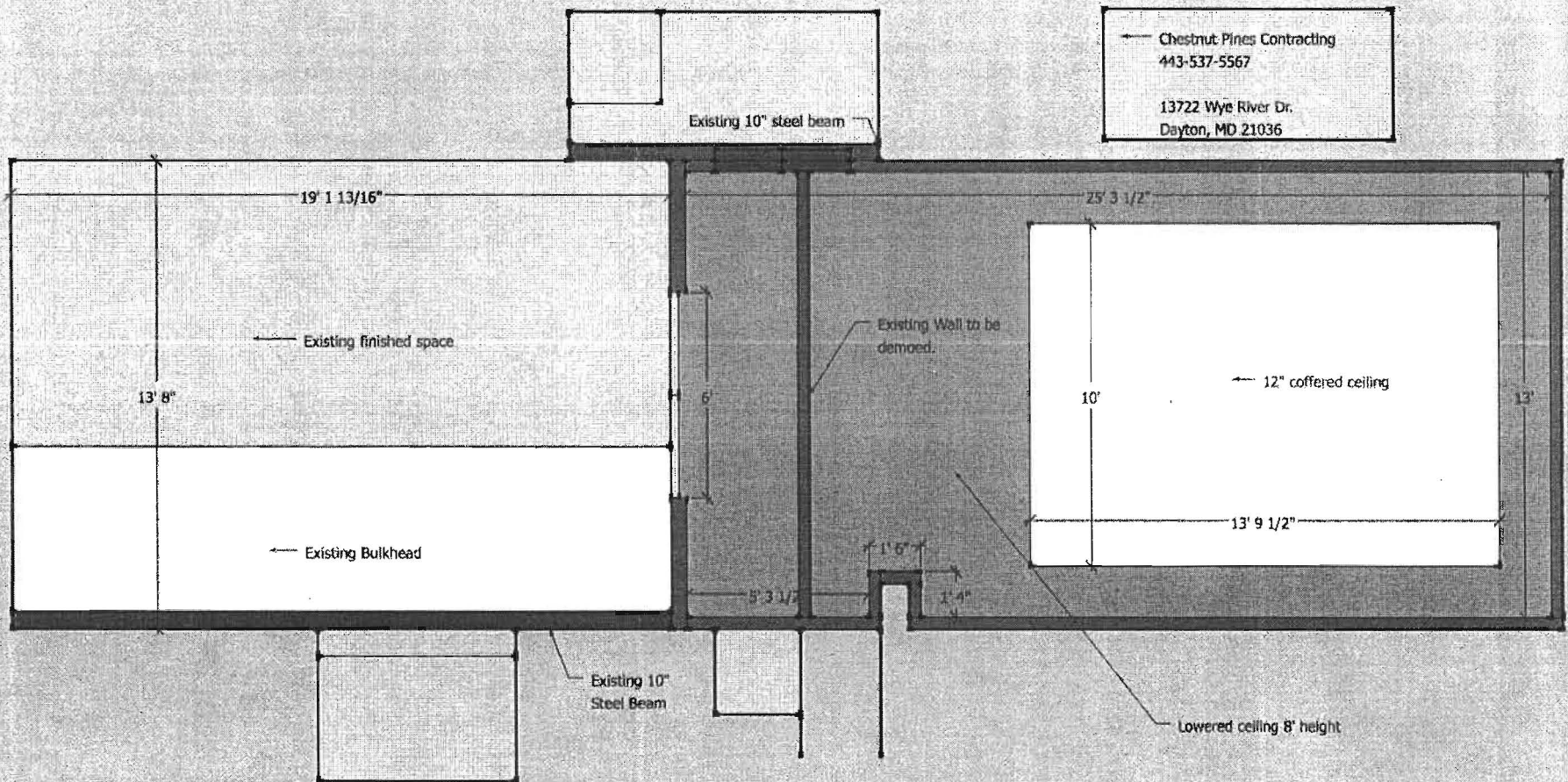

← Chestnut Pines Contracting
443-537-5567

13722 Wye River Dr.
Dayton, MD 21036

APPROVED

WALKTHRU BUILDING PERMIT

BP# _____ A# _____

APP. SAN W. M. W. P. DATE: 7/2/15

DESC. OF WORK: Proposed interior renovation to unused space use as theater room