

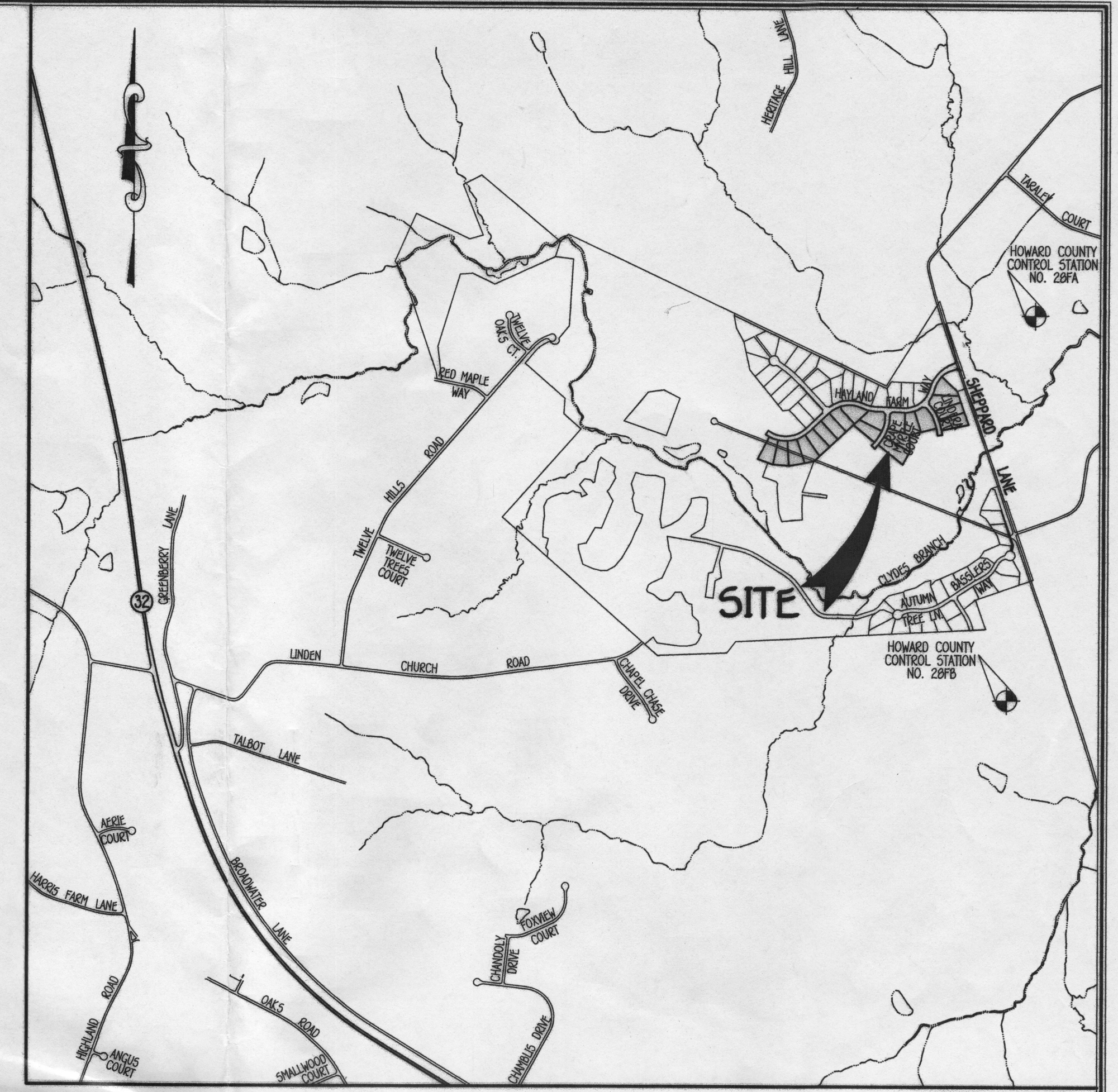

# SITE DEVELOPMENT AND SEDIMENT/EROSION CONTROL PLAN WALNUT CREEK PHASE TWO LOTS 48 THRU 67



**VICINITY MAP**  
SCALE: 1" = 1200'

ADDRESS CHART	
LOT NUMBER	STREET ADDRESS
48	12175 HAYLAND FARM WAY
49	12169 HAYLAND FARM WAY
50	12165 HAYLAND FARM WAY
51	12161 HAYLAND FARM WAY
52	12157 HAYLAND FARM WAY
53	12153 HAYLAND FARM WAY
54	12149 HAYLAND FARM WAY
55	12145 HAYLAND FARM WAY
56	12135 HAYLAND FARM WAY
57	5002 CRAPE MYRTLE COURT
58	5006 CRAPE MYRTLE COURT
59	5011 CRAPE MYRTLE COURT
60	5007 CRAPE MYRTLE COURT
61	5003 CRAPE MYRTLE COURT
62	12119 HAYLAND FARM WAY
63	12115 HAYLAND FARM WAY
64	5009 LINDERA COURT
65	5005 LINDERA COURT
66	5001 LINDERA COURT
67	12107 HAYLAND FARM WAY

LEGEND	
SYMBOL	DESCRIPTION
	EXISTING CONTOUR 2" INTERVAL
	PROPOSED CONTOUR 2" INTERVAL
	362.5 SPOT ELEVATION
	SILT FENCE
	SUPER SILT FENCE
	WALKOUT BASEMENT
	LIMITS OF DISTURBANCE
	EROSION CONTROL MATTING
	STONE CONSTRUCTION ENTRANCE

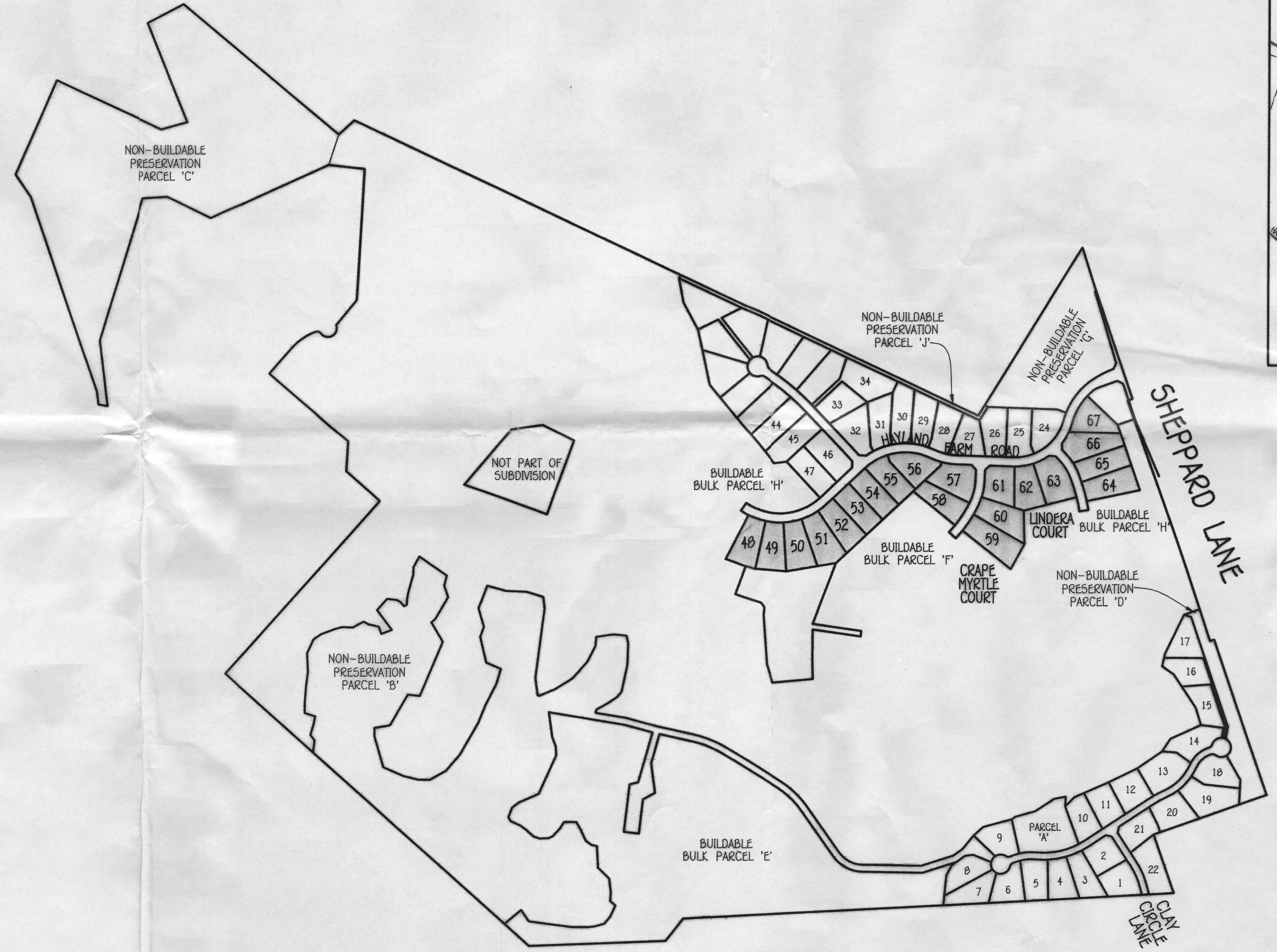

**VICINITY MAP**  
SCALE: 1" = 200'

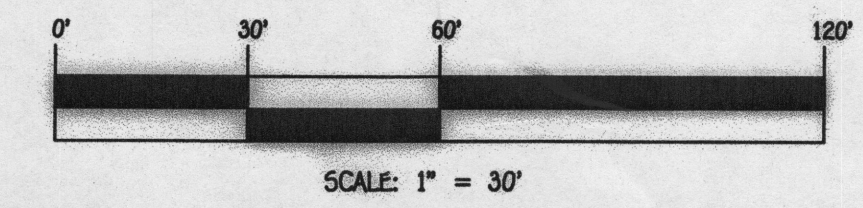

**GENERAL NOTES**

- SUBJECT PROPERTY ZONED: RC-DEO & RR-DEO
- TOTAL AREA OF PROPERTY: 38.10 ACRES
- SEPTIC EASEMENT SUBJECT TO HOWARD COUNTY HEALTH DEPARTMENT REVIEW.
- LENGTH OF TRENCH TO BE DETERMINED AT TIME OF SEPTIC PERMIT ISSUANCE.
- CONTRACTOR/BUILDER TO VERIFY ELEVATION IN THE FIELD BEFORE BEGINNING ANY CONSTRUCTION.
- TOPOGRAPHIC CONTOURS BASED ON HARFORD AERIAL SURVEYS, INC.
- STORMWATER MANAGEMENT IS PROVIDED PER F-07-076.

INDEX CHART	
SHEET	DESCRIPTION
SHEET 1	TITLE SHEET
SHEET 2	SITE DEVELOPMENT & SEDIMENT/EROSION CONTROL PLAN
SHEET 3	SITE DEVELOPMENT & SEDIMENT/EROSION CONTROL PLAN
SHEET 4	SITE DEVELOPMENT & SEDIMENT/EROSION CONTROL PLAN
SHEET 5	SITE DEVELOPMENT & SEDIMENT/EROSION CONTROL PLAN
SHEET 6	SEDIMENT/EROSION CONTROL NOTES & DETAILS

**PROFESSIONAL CERTIFICATION**  
I HEREBY CERTIFY THAT THESE DOCUMENTS WERE PREPARED OR APPROVED BY ME AND THAT I AM A DULY LICENSED PROFESSIONAL ENGINEER UNDER THE LAWS OF THE STATE OF MARYLAND, LICENSE NO. 9753, EXPIRATION DATE: 2/28/14.  
*Earl D. Collins* 4-30-13  
EARL D. COLLINS DATE

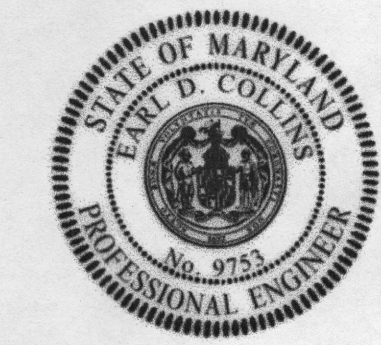

**DEVELOPER'S CERTIFICATE**

"I/WE CERTIFY THAT ALL DEVELOPMENT AND CONSTRUCTION WILL BE DONE ACCORDING TO THIS PLAN AND THAT ANY RESPONSIBLE PERSONNEL INVOLVED IN THE CONSTRUCTION PROJECT WILL HAVE A CERTIFICATE OF ATTENDANCE AT A DEPARTMENT OF THE ENVIRONMENT APPROVED TRAINING PROGRAM FOR THE CONTROL OF SEDIMENT AND EROSION BEFORE BEGINNING THE PROJECT. I ALSO AUTHORIZE PERIODIC ON-SITE INSPECTION BY THE HOWARD SOIL CONSERVATION DISTRICT."  
*David Pastva* 5/13/13  
HOWARD SOIL CONSERVATION DISTRICT DATE

**ENGINEER'S CERTIFICATE**

"I HEREBY CERTIFY THAT THIS PLAN FOR EROSION AND SEDIMENT CONTROL REPRESENTS A PRACTICAL AND WORKABLE PLAN BASED ON MY PERSONAL KNOWLEDGE OF THE SITE CONDITION AND THAT IT WAS PREPARED IN ACCORDANCE WITH THE REQUIREMENTS OF THE HOWARD SOIL CONSERVATION DISTRICT."  
*Earl D. Collins* 4-30-13  
EARL D. COLLINS DATE

**OWNER/DEVELOPER**

CRAFTMARK HOMES  
1359 BEVERLY ROAD  
SUITE 330  
MCLEAN, VIRGINIA 22101  
703-928-8535

# B14003320  
TITLE SHEET  
WALNUT CREEK  
PHASE TWO  
LOTS 48 THRU 67  
ZONED: RC-DEO AND RR-DEO  
TAX MAP NO.: 28 GRID NO.: 17 & 18 PARCEL NO.: 49  
5TH ELECTION DISTRICT HOWARD COUNTY, MARYLAND  
SCALE: AS SHOWN DATE: APRIL 6, 2013  
SHEET 1 OF 6

I:\2004\CH001\Draw\PHASE TWO\PLANS\CH001-5007-5007-SHEET1 (CONFORM) 4/29/2013 2:19:08 PM \\YCC08.Mkr 36

**FISHER, COLLINS & CARTER, INC.**  
CIVIL ENGINEERING CONSULTANTS & LAND SURVEYORS  
CENTRAL SQUARE OFFICE PARK - 10772 BALTIMORE NATIONAL PIKE  
ELLETTT CITY, MARYLAND 21742  
(410) 451-2200

NO.	REVISION	DATE

**HOWARD SOIL CONSERVATION DISTRICT  
STANDARD SEDIMENT CONTROL NOTES**

- A MINIMUM OF 48 HOURS NOTICE MUST BE GIVEN TO THE HOWARD COUNTY DEPARTMENT OF INSPECTIONS, LICENSES AND PERMITS, SEDIMENT CONTROL DIVISION PRIOR TO THE START OF ANY CONSTRUCTION (410-313-1855).
- ALL VEGETATIVE AND STRUCTURAL PRACTICES ARE TO BE INSTALLED ACCORDING TO THE PROVISIONS OF THIS PLAN AND ARE TO BE IN CONFORMANCE WITH THE MOST CURRENT HAZARDLAND STANDARDS AND SPECIFICATIONS FOR SOIL EROSION AND SEDIMENT CONTROL AND EROSION THEREOF.
- FOLLOWING INITIAL SOIL DISTURBANCE OR RE-DISTURBANCE, PERMANENT OR TEMPORARY STABILIZATION SHALL BE COMPLETED WITHIN 8) 3 CALENDAR DAYS FOR ALL PERIMETER STABILIZATION CONTROL STRUCTURES, DICES, PERMEABLE SLOPES AND ALL SLOPES GREATER THAN 3:1, 4) 7 DAYS AS TO ALL OTHER DISTURBED OR GRADED AREAS ON THE PROJECT SITE.
- ALL DISTURBED AREAS MUST BE STABILIZED WITHIN THE TIME PERIOD SPECIFIED ABOVE. IN ACCORDANCE WITH THE 2011 MARYLAND STANDARDS AND SPECIFICATIONS FOR SOIL EROSION AND SEDIMENT CONTROL, MULCHING (SEC. B-4-3), TEMPORARY STABILIZATION WITH MULCH ALONE CAN ONLY BE DONE WHEN RECOMMENDED SEEDING DATES DO NOT ALLOW FOR PROPER GERMINATION AND ESTABLISHMENT OF GRASSES.
- ALL SEDIMENT CONTROL STRUCTURES ARE TO REMAIN IN PLACE AND ARE TO BE MAINTAINED IN OPERATIVE CONDITION UNTIL PERMISSION FOR THEIR REMOVAL HAS BEEN OBTAINED FROM THE HOWARD COUNTY SEDIMENT CONTROL INSPECTOR.
- SITE ANALYSIS:  
TOTAL AREA OF SITE: 15,826 ACRES  
AREA DISTURBED: 5,776 ACRES  
AREA TO BE ROOFED OR PAVED: 2,718 ACRES  
AREA TO BE VEGETATIVELY STABILIZED: 3,228 ACRES  
TOTAL CUT: 9,110 CU.YDS.  
TOTAL FILL: 12,500 CU.YDS.  
OFFSITE WASTE/BORROW AREA LOCATION: N/A
- ANY SEDIMENT CONTROL PRACTICE THAT IS DISTURBED BY GRADING ACTIVITY FOR PLACEMENT OF UTILITIES MUST BE REPAIRED ON THE SAME DAY OF DISTURBANCE.
- ADDITIONAL SEDIMENT CONTROL MUST BE PROVIDED, IF DEEMED NECESSARY BY THE HOWARD COUNTY SEDIMENT CONTROL INSPECTOR.
- ON ALL SITES WITH DISTURBED AREAS IN EXCESS OF 2 ACRES, APPROVAL OF THE INSPECTION AGENCY SHALL BE REQUESTED UPON COMPLETION OF INSTALLATION OF PERIMETER EROSION AND SEDIMENT CONTROLS, BUT BEFORE PROCEEDING WITH ANY OTHER EARTH DISTURBANCE OR GRADING, OTHER BUILDING OR GRADING INSPECTION APPROVALS MAY NOT BE AUTHORIZED UNTIL THIS INITIAL APPROVAL BY THE INSPECTION AGENCY IS MADE.
- TRENCHES FOR THE CONSTRUCTION OF UTILITIES IS LIMITED TO THREE PIPE LENGTHS OR THAT WHICH SHALL BE BACK-FILLED AND STABILIZED BY THE END OF EACH WORKDAY, WHICHEVER IS SHORTER.
- ANY CHANGES OR REVISIONS TO THE SEQUENCE OF CONSTRUCTION MUST BE REVIEWED AND APPROVED BY THE PLAN APPROVAL AUTHORITY PRIOR TO PROCEEDING WITH CONSTRUCTION.
- A PROJECT IS TO BE SEQUENCED SO THAT GRADING ACTIVITIES BEGIN ON ONE GRADING UNIT (MAXIMUM ACREAGE OF 20 ACRES PER GRADING UNIT) AT A TIME. WORK MAY PROCEED TO A SUBSEQUENT GRADING UNIT WHEN AT LEAST 50 PERCENT OF THE DISTURBED AREA IN THE PROCEEDING GRADING UNIT HAS BEEN STABILIZED AND APPROVED BY THE ENFORCEMENT AUTHORITY, UNLESS OTHERWISE SPECIFIED AND APPROVED BY THE APPROVAL AUTHORITY. NO MORE THAN 30 ACRES CUMULATIVELY MAY BE DISTURBED AT A GIVEN TIME.

**PERMANENT SEEDING NOTES**

ALL DISTURBED AREAS SHALL BE STABILIZED AS FOLLOWS:

**SEEDING PREPARATION:**  
LOOSEN UPPER THREE INCHES OF SOIL BY RAKING, DISCING OR OTHER ACCEPTABLE MEANS BEFORE SEEDING.

**SOIL AMENDMENTS:**  
APPLY TWO TONS PER ACRE SOLICITIC LIMESTONE (92 LBS./1,000 SQ.FT.) AND 500 LBS. PER ACRE 10-20-20 FERTILIZER (14 LBS./1,000 SQ.FT.) BEFORE SEEDING HARROW OR DISC INTO UPPER THREE INCHES OF SOIL AT TIME OF SEEDING.  
APPLY 400 LBS. PER ACRE 36-0-0 UREA/NITROGEN FERTILIZER (9 LBS./1,000 SQ.FT.) AND 500 LBS. PER ACRE (11.9 LBS./1,000 SQ.FT.) OF 10-20-20 FERTILIZER.

**SEEDING:**  
FOR THE PERIODS MARCH 1 THROUGH APRIL 30, AND AUGUST 1 THROUGH OCTOBER 15, SEED WITH 100 LBS. PER ACRE (2.3 LBS./1,000 SQ.FT.) OF KENTUCKY 31 TALL FESCUE FOR THE PERIOD MAY 1 THROUGH JULY 31, SEED WITH 50 LBS./ACRE (1.1 LBS./1,000 SQ.FT.) KENTUCKY 31 TALL FESCUE AND 2 LBS. PER ACRE (0.05 LBS./1,000 SQ.FT.) OF WEEPING LOWGRASS. DURING THE PERIOD OF OCTOBER 16 THROUGH FEBRUARY 28, PROJECT SITE BY OPTION (1) - TWO TONS PER ACRE OF WELL ANCHORED STRAW MULCH AND SEED AS SOON AS POSSIBLE IN THE SPRING, OPTION (2) - USE SOO OPTION (3) - SEED WITH 100 LBS./ACRE KENTUCKY 31 TALL FESCUE AND MULCH WITH TWO TONS/ACRE WELL ANCHORED STRAW. ALL SLOPES SHOULD BE HYDROSEEDING.

**MULCHING:**  
APPLY 1 TO 2 TONS PER ACRE (10 TO 90 LBS./1,000 SQ.FT.) UNWEIGHTED SMALL GRASS STRAW IMMEDIATELY AFTER SEEDING. ANCHOR MULCH IMMEDIATELY AFTER APPLICATION USING 200 GALLONS PER ACRE (5 GAL./1,000 SQ.FT.) OF EMULSIFIED ASPHALT ON FLAT ACRES ON SLOPES 6 FEET OR HIGHER USE 340 GALLONS PER ACRE (8 GAL./1,000 SQ.FT.) FOR ANCHORING.

**MAINTENANCE:**  
INSPECT ALL SEEDED AREAS AND MAKE NEEDED REPAIRS, REPLACEMENTS AND RESEEDINGS.  
FOR PUBLIC ROWS SUBSTITUTE CHAINING CROWNWEED AT 15 LBS./ACRE AND KENTUCKY 31 TALL FESCUE AT 40 LBS./ACRE AS THE SEEDING REQUIREMENT. OPTIMUM SEEDING DATE FOR THIS MIXTURE IS MARCH 1 TO APRIL 30.

**DUST CONTROL**

**DEFINITION:**  
CONTROLLING DUST BLOWING AND MOVEMENT ON CONSTRUCTION SITES AND ROADS.

**PURPOSE:**  
TO PREVENT BLOWING AND MOVEMENT OF DUST FROM EXPOSED SOIL SURFACES, REDUCE ON AND OFF-SITE DAMAGE, HEALTH HAZARDS AND IMPROVE TRAFFIC SAFETY.

**CONDITIONS WHERE PRACTICE APPLIES:**  
THIS PRACTICE IS APPLICABLE TO AREAS SUBJECT TO DUST BLOWING AND MOVEMENT WHERE ON AND OFF-SITE DAMAGE IS LIKELY WITHOUT TREATMENT.

**SPECIFICATIONS:**

- TEMPORARY METHODS**
- MULCHES - SEE STANDARDS FOR VEGETATIVE STABILIZATION WITH MULCHES ONLY. MULCH SHOULD BE COMBED OR TACKED TO PREVENT BLOWING.
  - VEGETATIVE COVER - SEE STANDARDS FOR TEMPORARY VEGETATIVE COVER.
  - TILLAGE - TO ROUGHEN SURFACE AND BRING CLODS TO THE SURFACE. THIS IS AN EMERGENCY MEASURE WHICH SHOULD BE USED BEFORE SOIL BLOWING STARTS. BEGIN PLOWING ON WINDWARD SIDE OF THE SITE. CHESEL-TYPE PLOWS SPACED ABOUT 12' APART, SPRING-TOOTHED HARROWS AND SIMILAR PLOWS ARE EXAMPLES OF EQUIPMENT WHICH MAY PRODUCE THE DESIRED EFFECT.
  - IRRIGATION - THIS IS GENERALLY DONE AS AN EMERGENCY TREATMENT. AT NO TIME SHOULD THE SITE BE IRRIGATED TO THE POINT THAT RUNOFF BEGINS TO FLOW.
  - BARROWS - SOLID BARRED FENCES, SILT FENCES, SNOW FENCES, SURFAP FENCES, STRAW BALE DIKES AND SIMILAR MATERIAL CAN BE USED TO CONTROL AIR CURRENTS AND SOIL BLOWING. BARROWS PLACED AT RIGHT ANGLES TO PREVAILING CURRENTS AT INTERVALS OF ABOUT 10 FEET. THEIR HEIGHT AND EFFECTIVENESS IN CONTROLLING SOIL BLOWING.
  - CALCIUM CHLORIDE - APPLY AT RATES THAT WILL KEEP SURFACE MOIST. MAY NEED RETREATMENT.

- PERMANENT METHODS**
- PERMANENT VEGETATION - SEE STANDARDS FOR PERMANENT VEGETATIVE COVER AND PERMANENT STABILIZATION WITH SOO. EXISTING TREES OR LARGE SHRUBS MAY AFFORD VALUABLE PROTECTION IF LEFT IN PLACE.
  - TOPSOILING - COVERING WITH LESS EROSION SOIL. SEE STANDARDS FOR TOPSOILING.
  - STONE - COVER SURFACE WITH CRUSHED STONE OR COARSE GRAVEL.

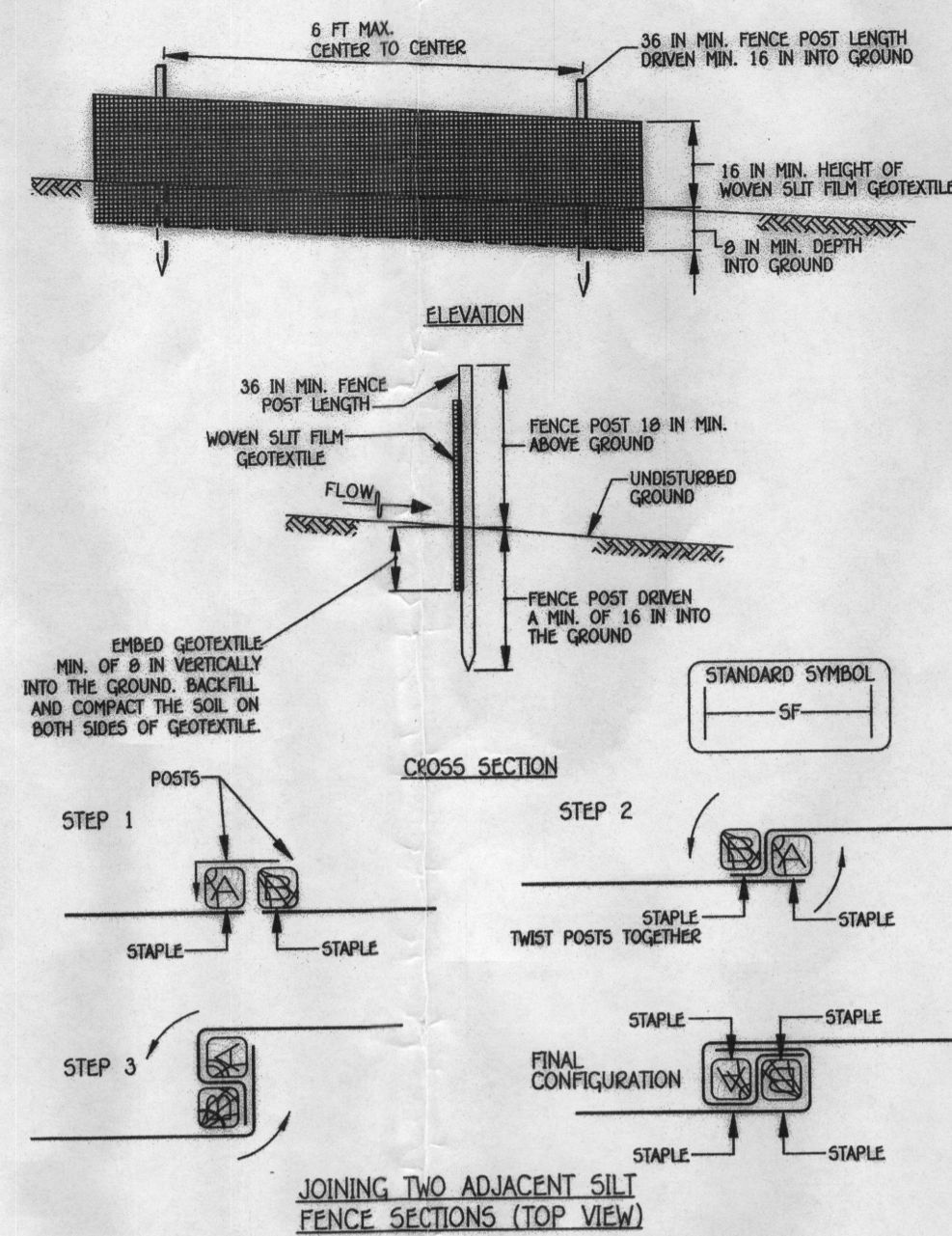

- CONSTRUCTION SPECIFICATIONS**
- USE WOOD POSTS 1 3/4" x 1 3/4" x 1/2" (MINIMUM) SQUARE CUT OF SOUND QUALITY HARDWOOD, AS AN ALTERNATIVE TO WOODEN POST USE STANDARD "T" OR "U" SECTION STEEL POSTS WEIGHING NOT LESS THAN 1 POUND PER LINEAR FOOT.
  - USE 36 INCH MINIMUM POSTS SPACED 16 INCH MINIMUM INTO GROUND NO MORE THAN 6 FEET APART.
  - USE WOVEN SILT FILM GEOTEXTILE AS SPECIFIED IN SECTION H-1 MATERIALS AND FASTEN GEOTEXTILE SECURELY TO UPSLOPE SIDE OF FENCE. POSTS WITH WIRE TIES OR STAPLES AT TOP AND MID-SECTION.
  - PROVIDE MANUFACTURER CERTIFICATION TO THE INSPECTION/ENFORCEMENT AUTHORITY SHOWING THAT THE GEOTEXTILE USED MEETS THE REQUIREMENTS IN SECTION H-1 MATERIALS.
  - EMBED GEOTEXTILE A MINIMUM OF 6 INCHES VERTICALLY INTO THE GROUND, BACKFILL AND COMPACT THE SOIL ON BOTH SIDES OF FABRIC.
  - WHERE TWO SECTIONS OF GEOTEXTILE ADJOIN, OVERLAP, TWIST, AND STAPLE TO POST IN ACCORDANCE WITH THIS DETAIL.
  - EXTEND BOTH ENDS OF THE SILT FENCE A MINIMUM OF FIVE HORIZONTAL FEET UPSLOPE AT 45 DEGREES TO THE MAIN FENCE ALIGNMENT TO PREVENT RUNOFF FROM GOING AROUND THE ENDS OF THE SILT FENCE.
  - REMOVE ACCUMULATED SEDIMENT AND DEBRIS WHEN BULGES DEVELOP IN SILT FENCE OR WHEN SEDIMENT REACHES 20% OF FENCE HEIGHT. REPLACE GEOTEXTILE IF TORN. IF UNDERMINING OCCURS, REINSTALL FENCE.

**SILT FENCE**

NOT TO SCALE

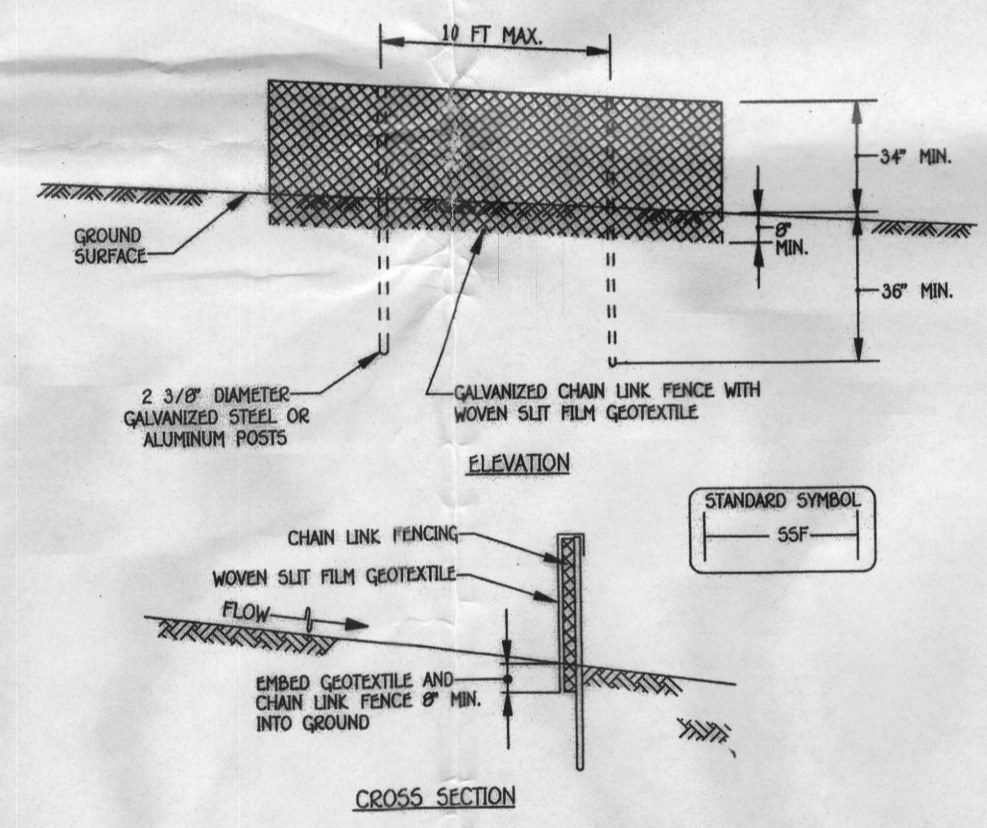

- CONSTRUCTION SPECIFICATIONS**
- INSTALL 2 3/8" DIAMETER GALVANIZED STEEL POSTS OF 0.095 INCH WALL THICKNESS AND SIX FOOT LENGTH SPACED NO FURTHER THAN 10 FEET APART. DRIVE THE POSTS A MINIMUM OF 36" INTO THE GROUND.
  - FASTEN 3/8" GAUGE OR HEAVIER GALVANIZED CHAIN LINK FENCE (2 3/8" MAXIMUM OPENING) 42" IN HEIGHT SECURELY TO THE FENCE POSTS WITH WIRE TIES OR HUG RINGS.
  - FASTEN WOVEN SILT FILM GEOTEXTILE AS SPECIFIED IN SECTION H-1 MATERIALS, SECURELY TO THE UPSLOPE SIDE OF CHAIN LINK FENCE WITH TIES SPACED EVERY 6" AT THE TOP AND MID SECTION. EMBED GEOTEXTILE AND CHAIN LINK FENCE A MINIMUM OF 6" INTO THE GROUND.
  - WHERE ENDS OF THE GEOTEXTILE COME TOGETHER, THE ENDS SHALL BE OVERLAPPED BY 6", FOLDED AND STAPLED TO PREVENT SEEDMENT BY PAGES.
  - EXTEND BOTH ENDS OF THE SUPER SILT FENCE A MINIMUM OF FIVE HORIZONTAL FEET UPSLOPE AT 45 DEGREES TO THE MAIN FENCE ALIGNMENT TO PREVENT RUNOFF FROM GOING AROUND THE ENDS OF THE SUPER SILT FENCE.
  - PROVIDE MANUFACTURER CERTIFICATION TO THE INSPECTION/ENFORCEMENT AUTHORITY SHOWING THAT GEOTEXTILE USED MEETS THE REQUIREMENTS IN SECTION H-1 MATERIALS.
  - REMOVE ACCUMULATED SEDIMENT AND DEBRIS WHEN BULGES DEVELOP IN FENCE OR WHEN SEDIMENT REACHES 20% OF FENCE HEIGHT. REPLACE GEOTEXTILE IF TORN. IF UNDERMINING OCCURS, REINSTALL CHAIN LINK FENCING AND GEOTEXTILE.

**SUPER SILT FENCE**

NOT TO SCALE

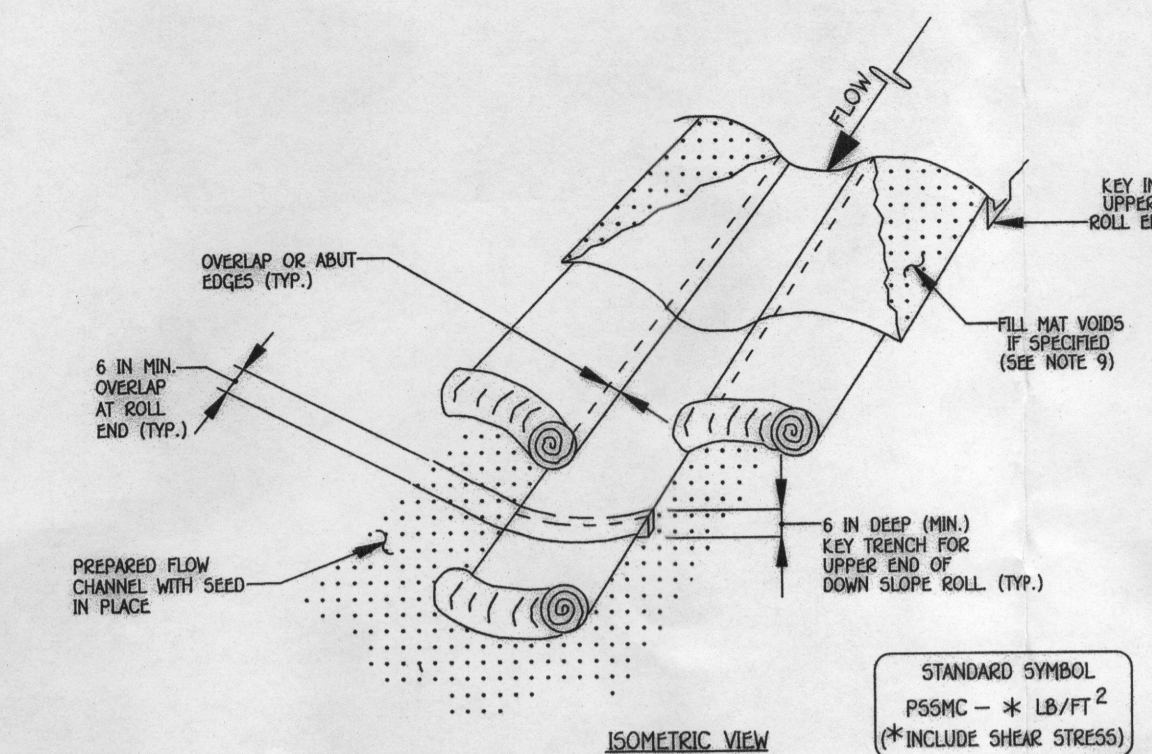

- CONSTRUCTION SPECIFICATIONS**
- USE MATTING THAT HAS A DESIGN VALUE FOR SHEAR STRESS EQUAL TO OR HIGHER THAN THE SHEAR STRESS DESIGNATED ON APPROVED PLANS.
  - USE PERMANENT SOIL STABILIZATION MATTING MADE OF OPEN WEAVE SYNTHETIC, NON-Biodegradable FIBRES OR ELEMENTS OF UNIFORM THICKNESS AND DISTRIBUTION THROUGHOUT. CHEMICALS USED IN THE MAT MUST BE NON-LEACHING AND NON-TOXIC TO VEGETATION AND SEED GERMINATION AND NON-HARMFUL TO THE SOIL. IF PRESENT, MATTING MUST BE EXTENDED PLASTIC WITH A MAXIMUM MESH OPENING OF 2" x 2" AND SUFFICIENTLY BONDING OR SEAM ON 2" CENTERS ALONG LONGITUDINAL AXIS OF THE MATERIAL TO PREVENT SEPARATION OF THE NET FROM THE PARENT MATERIAL.
  - SECURE MATTING USING STEEL STAPLES OR WOOD STAPLES. STAPLES MUST BE "U" OR "T" SHAPED STEEL WIRE HAVING A MINIMUM GAUGE OF NO. 11 AND NO. 8 RESPECTIVELY. "U" SHAPED STAPLES MUST AVERAGE 1" TO 1 1/2" WIDE AND BE A MINIMUM OF 6" LONG. "T" SHAPED STAPLES MUST HAVE A MINIMUM 8" MAIN LEG, A MINIMUM 1" SECONDARY LEG, AND MINIMUM 4" HEAD. WOOD STAPLES MUST BE ROUND-SHAPE HARDWOOD, 1/2" TO 2" LENGTH 1" x 3" CROSS SECTION, AND WEDGE SHAPE AT THE BOTTOM.
  - PERFORM FINAL GRADING, TOPSOIL APPLICATION, SEEDING PREPARATION, AND PERMANENT SEEDING IN ACCORDANCE WITH SPECIFICATIONS. PLACE MATTING WITHIN 48 HOURS OF COMPLETING SEEDING OPERATIONS.
  - UNROLL MATTING IN DIRECTION OF WATER FLOW, CENTERING THE FIRST ROLL ON THE CHANNEL CENTER LINE, WORK FROM CENTER OF CHANNEL OUTWARD WHEN PLACING ROLLS. LAY MATTING SMOOTHLY AND FIRMLY UPON THE SEEDED SURFACE, AVOID STRETCHING THE MATTING.
  - OVERLAP OR ABUT EDGES OF MATTING ROLLS PER MANUFACTURER'S RECOMMENDATIONS. OVERLAP ROLL ENDS BY 6" (MINIMUM), WITH THE UPSLOPE MAT OVERLAPPING ON TOP OF THE NEXT DOWNSTREAM MAT.
  - KEY IN THE TOP OF SLOPE END OF MAT 6 INCHES MINIMUM BY DRIVING A TRENCH, PLACING THE MATTING ROLL END IN THE TRENCH, STARTING THE MAT IN PLACE, REPLACING THE EXCAVATED MATERIAL AND TAMPING TO SECURE THE MAT END IN THE KEY.
  - STAPLES/STAPLE MAT IN A STRAGGLED PATTERN ON 4 FOOT (MAXIMUM) CENTERS THROUGHOUT AND 2 FOOT (MAXIMUM) CENTERS ALONG SEAMS, JOINTS, AND ROLL ENDS.
  - IF SPECIFIED BY THE DESIGNER OR MANUFACTURER AND DEPENDING ON THE TYPE OF MAT BEING INSTALLED, ONCE THE MATTING IS LAYED AND STAPLED IN PLACE, FILL THE MAT VOIDS WITH TOP SOIL OR GRANULAR MATERIAL AND LIGHTLY COMPACT OR ROLL TO MAXIMIZE SOIL/MAT CONTACT WITHOUT CRUSHING MAT.
  - ESTABLISH AND MAINTAIN VEGETATION SO THAT REQUIREMENTS FOR ADEQUATE VEGETATIVE ESTABLISHMENT ARE CONTINUOUSLY MET IN ACCORDANCE WITH SECTION B-4 VEGETATIVE STABILIZATION.

**PERMANENT SOIL STABILIZATION  
MATTING CHANNEL APPLICATION**

NOT TO SCALE

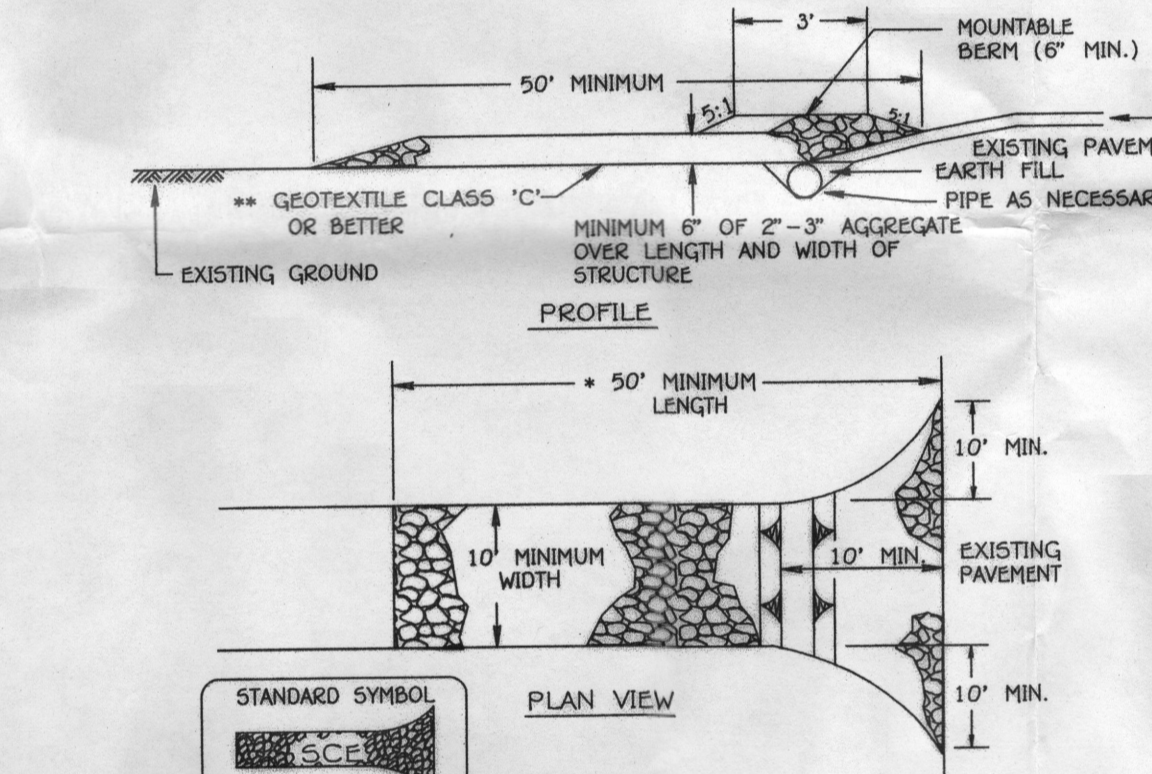

- CONSTRUCTION SPECIFICATION**
- LENGTH - MINIMUM OF 50' (40' FOR SINGLE RESIDENCE LOT).
  - WIDTH - 10' MINIMUM SHOULD BE PLACED AT THE EXISTING ROAD TO PROVIDE A TURNING RADIUS.
  - GEOTEXTILE FABRIC (FILTER CLOTH) SHALL BE PLACED OVER THE EXISTING GROUND PRIOR TO PLACING STONE. WHILE PLAN APPROVAL AUTHORITY MAY NOT REQUIRE SINGLE FAMILY RESIDENCES TO USE GEOTEXTILE.
  - STONE - CRUSHED AGGREGATE (2" TO 3") OR RECLAIMED OR RECYCLED CONCRETE EQUIVALENT SHALL BE PLACED AT LEAST 6" DEEP OVER THE LENGTH AND WIDTH OF THE ENTRANCE.
  - SURFACE WATER - ALL SURFACE WATER FLOWING TO OR DIVERTED TOWARD CONSTRUCTION ENTRANCES SHALL BE FILTERED THROUGH THE ENTRANCE, MAINTAINING POSITIVE DRAINAGE. PIPE INSTALLED THROUGH THE STABILIZED CONSTRUCTION ENTRANCE SHALL BE PROTECTED WITH A MOUNTABLE BERM WITH 2:1 SLOPES AND A MINIMUM OF 6" OF STONE OVER THE PIPE. PIPE HAS TO BE SIZED ACCORDING TO THE DRAINAGE. WHEN THE BERM IS LOCATED AT A HIGH SPOT AND HAS NO DRAINAGE TO CONVEY A PIPE WILL NOT BE NECESSARY. PIPE SHOULD BE SIZED ACCORDING TO THE AMOUNT OF RUNOFF TO BE CONVEYED. A 6" MINIMUM WILL BE REQUIRED.
  - LOCATION - A STABILIZED CONSTRUCTION ENTRANCE SHALL BE LOCATED AT EVERY POINT WHERE CONSTRUCTION TRAFFIC ENTERS OR LEAVES A CONSTRUCTION SITE. VEHICLES LEAVING THE SITE MUST TRAVEL OVER THE ENTIRE LENGTH OF THE STABILIZED CONSTRUCTION ENTRANCE.

**STABILIZED CONSTRUCTION ENTRANCE**

NOT TO SCALE

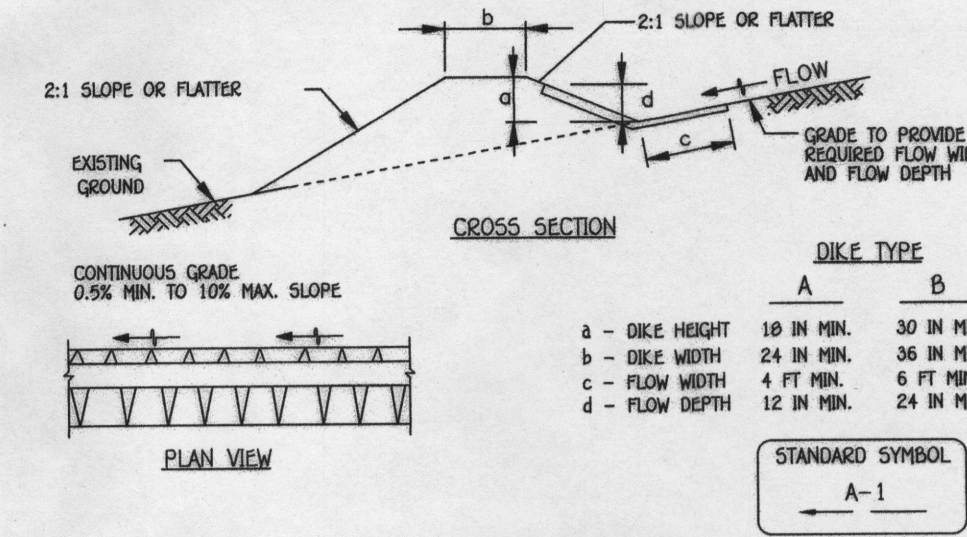

- FLOW CHANNEL STABILIZATION**
- STANDARD SYMBOL: A-1
- SEED WITH STRAW MULCH AND TACK. (NOT ALLOWED FOR CLEAR WATER OVERFLOW.)  
SEED WITH SOIL STABILIZATION MATTING OR LINE WITH SOO.  
4 TO 7 INCH STONE OR EQUIVALENT RECYCLED CONCRETE PRESSED INTO SOIL. A MINIMUM OF 7 INCHES AND FLUSH WITH GROUND.

**CONSTRUCTION SPECIFICATIONS**

- REMOVE AND DISPOSE OF ALL TREES, BRUSH, STUMPS, OBSTRUCTIONS, AND OTHER OBJECTIONABLE MATERIALS SO AS NOT TO INTERFERE WITH PROPER FUNCTION OF ENTRANCE.
- EXCAVATE OR SHAPE EXISTING GROUND TO LINE, GRADE, AND CROSS SECTION AS SPECIFIED. BANK PROJECTIONS OR OTHER IRREGULARITIES ARE NOT ALLOWED.
- CONSTRUCT FILL.
- CONSTRUCT FLOW CHANNEL ON AN UNDISTURBED, CONTINUOUS GRADE, ADJUSTING THE LOCATION DUE TO FIELD CONDITIONS AS NECESSARY TO MAINTAIN POSITIVE DRAINAGE.
- PROVIDE OUTLET PROTECTION AS REQUIRED ON APPROVED PLAN.
- STABILIZE EARTH DICE WITHIN THREE DAYS OF INSTALLATION. STABILIZE FLOW CHANNEL FOR CLEAR WATER OVERFLOW WITHIN 24 HOURS OF INSTALLATION.
- MAINTAIN LINE, GRADE, AND CROSS SECTION REMOVE ACCUMULATED SEDIMENT AND DEBRIS, AND MAINTAIN POSITIVE DRAINAGE. KEEP EARTH DICE AND POINT OF DISCHARGE FREE OF EROSION, AND CONTINUOUSLY MEET REQUIREMENTS FOR ADEQUATE VEGETATIVE ESTABLISHMENT IN ACCORDANCE WITH SECTION B-4 VEGETATIVE STABILIZATION.
- UPON REMOVAL OF EARTH DICE, GRADE AREA FLUSH WITH EXISTING GROUND, WITHIN 24 HOURS OF REMOVAL. STABILIZE DISTURBED AREA WITH TOPSOIL, SEED, AND MULCH, OR AS SPECIFIED ON APPROVED PLAN.

**EARTH DIKE**

NOT TO SCALE

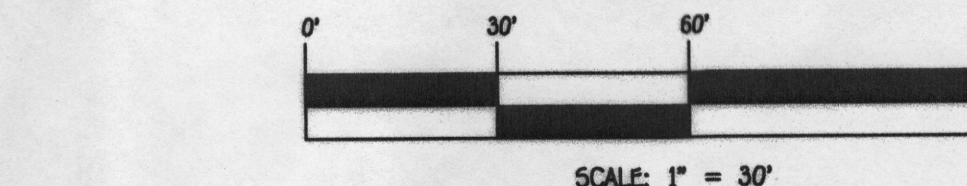

**SITE DEVELOPMENT AND  
SEDIMENT/EROSION CONTROL DETAILS & NOTES  
WALNUT CREEK  
PHASE TWO  
LOTS 48 THRU 67**

ZONED: RC-DEO AND RC-DEO  
TAX MAP NO.: 28 GRID NO.: 17 & 18 PARCEL NO.: 49  
5TH ELECTION DISTRICT HOWARD COUNTY, MARYLAND  
SCALE: AS SHOWN DATE: APRIL 2013  
SHEET 6 OF 6

**DEVELOPER'S CERTIFICATE**

"I/WE CERTIFY THAT ALL DEVELOPMENT AND CONSTRUCTION WILL BE DONE ACCORDING TO THIS PLAN AND THAT ANY RESPONSIBLE PERSONNEL INVOLVED IN THE CONSTRUCTION PROJECT WILL HAVE A CERTIFICATE OF ATTENDANCE AT A DEPARTMENT OF THE ENVIRONMENT APPROVED TRAINING PROGRAM FOR THE CONTROL OF SEDIMENT AND EROSION BEFORE BEGINNING THE PROJECT. I ALSO AUTHORIZE FIELD/ON-SITE INSPECTION BY THE HOWARD SOIL CONSERVATION DISTRICT."

Signature: John R. Blanton  
DATE: 5/13/13  
HOWARD SOIL CONSERVATION DISTRICT

**ENGINEER'S CERTIFICATE**

"I HEREBY CERTIFY THAT THIS PLAN FOR EROSION AND SEDIMENT CONTROL REPRESENTS A PRACTICAL AND WORKABLE PLAN BASED ON MY PERSONAL KNOWLEDGE OF THE SITE CONDITION AND THAT IT WAS PREPARED IN ACCORDANCE WITH THE REQUIREMENTS OF THE HOWARD SOIL CONSERVATION DISTRICT."

Signature: Earl D. Collins  
DATE: 4/20/13  
EARL D. COLLINS

**OWNER/DEVELOPER**

CRAFTMARK HOMES  
1355 BEVERLY ROAD  
SUITE 330  
MCLAN, VIRGINIA 22101  
703-928-6535

**FISHER, COLLINS & CARTER, INC.**  
CIVIL ENGINEERING CONSULTANTS & LAND SURVEYORS

CENTRAL: SQUARE OFFICE PARK 10272 BALTIMORE NATIONAL PkE  
CITY: MD 21144  
(410) 461-2255

NO.	REVISION	DATE

I:\2004\CHOC\Draw\PHASE TWO FINALS\CHOC01-3000\_SPT\_44E15 2-9 (CRAFTMARK).dwg, 4/29/2013 2:27:40 PM, \\VFCC08\Miller 36

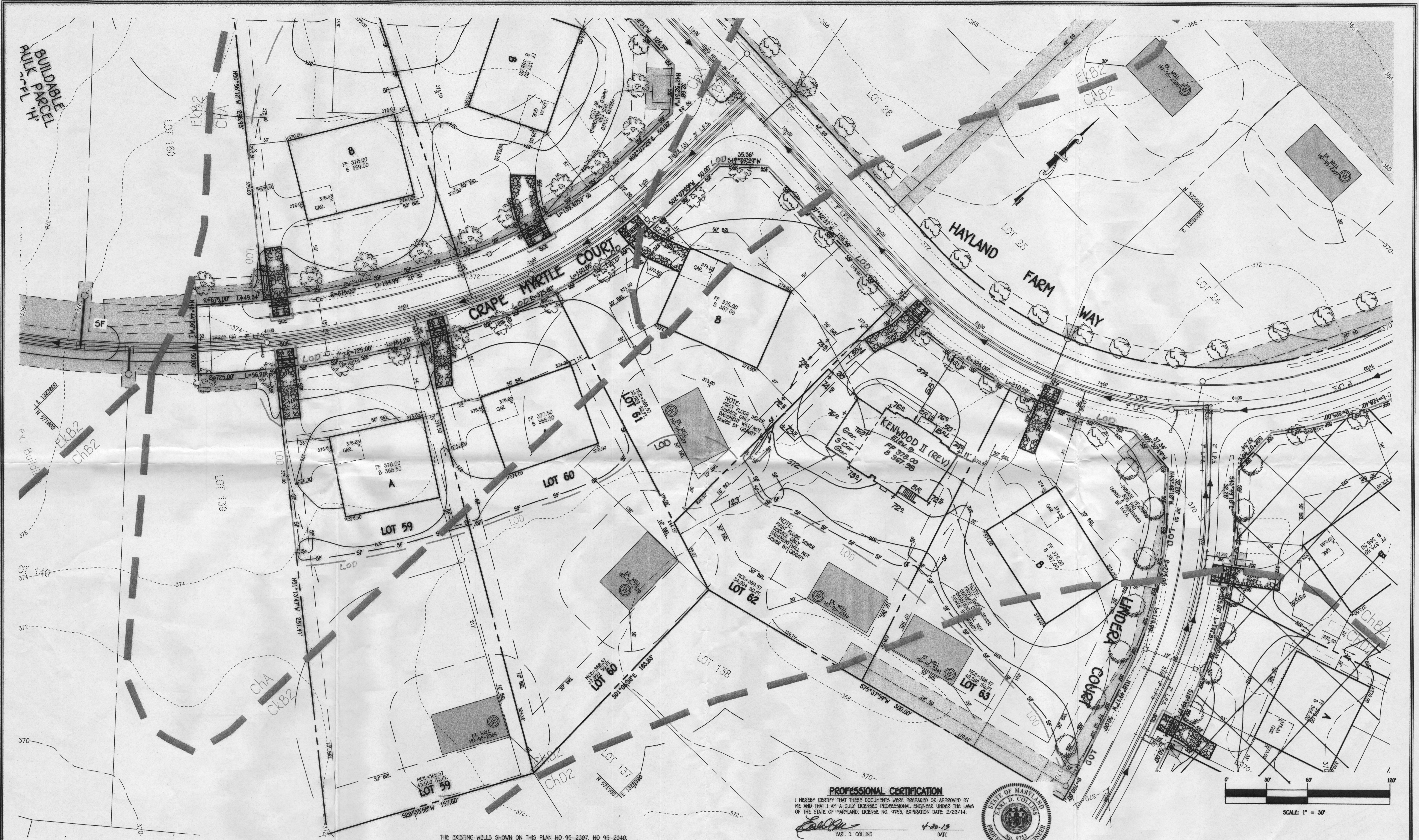

**FISHER, COLLINS & CARTER, INC.**  
CIVIL ENGINEERING CONSULTANTS & LAND SURVEYORS  
FEDERAL SOURCE OFFICE PARK - 15277 BALFOUR NATIONAL PIKE  
ELLSWORTH CITY, MARYLAND 21042  
(410) 461-2999

NO.	REVISION	DATE
1	Rev. hse. & 9rd. Lot 62	6-7-13

THE EXISTING WELLS SHOWN ON THIS PLAN HO 95-2307, HO 95-2340, HO 95-2341, HO 95-2369 AND HO 95-2370 HAVE BEEN FIELD LOCATED BY FISHER, COLLINS & CARTER, INC., PROFESSIONAL LAND SURVEYORS AND ARE ACCURATELY SHOWN.

THIS DEVELOPMENT IS APPROVED FOR SOIL EROSION AND SEDIMENT CONTROL BY THE HOWARD SOIL CONSERVATION DISTRICT.  
APPROVED:  
*John R. Blunt*  
HOWARD SOIL CONSERVATION DISTRICT  
5/13/13

**PROFESSIONAL CERTIFICATION**  
I HEREBY CERTIFY THAT THESE DOCUMENTS WERE PREPARED OR APPROVED BY ME AND THAT I AM A DULY LICENSED PROFESSIONAL ENGINEER UNDER THE LAWS OF THE STATE OF MARYLAND, LICENSE NO. 9753, EXPIRATION DATE: 2/28/14.  
*Earl D. Collins*  
EARL D. COLLINS  
4-30-13  
DATE



**DEVELOPER'S CERTIFICATE**  
"I/WE CERTIFY THAT ALL DEVELOPMENT AND CONSTRUCTION WILL BE DONE ACCORDING TO THIS PLAN AND THAT ANY RESPONSIBLE PERSONNEL INVOLVED IN THE CONSTRUCTION PROJECT WILL HAVE A CERTIFICATE OF ATTENDANCE AT A DEPARTMENT OF THE ENVIRONMENT APPROVED TRAINING PROGRAM FOR THE CONTROL OF SEDIMENT AND EROSION BEFORE BEGINNING THE PROJECT. I ALSO AUTHORIZE PERIODIC ON-SITE INSPECTION BY THE HOWARD SOIL CONSERVATION DISTRICT."  
*David Pastva*  
DAVID PASTVA  
4/30/13  
DATE

**ENGINEER'S CERTIFICATE**  
"I HEREBY CERTIFY THAT THIS PLAN FOR EROSION AND SEDIMENT CONTROL REPRESENTS A PRACTICAL AND WORKABLE PLAN BASED ON MY PERSONAL KNOWLEDGE OF THE SITE CONDITION AND THAT IT WAS PREPARED IN ACCORDANCE WITH THE REQUIREMENTS OF THE HOWARD SOIL CONSERVATION DISTRICT."  
*Earl D. Collins*  
EARL D. COLLINS  
4-30-13  
DATE

**OWNER/DEVELOPER**  
CRAFTMARK HOMES  
1395 BEVERLY ROAD  
SUITE 330  
MCLEAN, VIRGINIA 22101  
703-928-6535

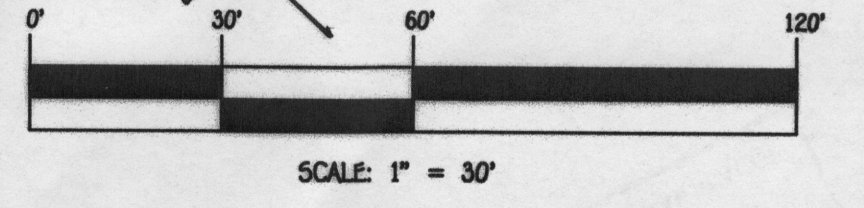

**SITE DEVELOPMENT AND SEDIMENT/EROSION CONTROL PLAN**  
**WALNUT CREEK**  
PHASE TWO  
LOTS 48 THRU 67  
ZONED: RC-DEO AND RC-DEO  
TAX MAP NO.: 28 GRID NO.: 17 & 18 PARCEL NO.: 49  
5TH ELECTION DISTRICT HOWARD COUNTY, MARYLAND  
SCALE: 1" = 30' DATE: APRIL 2013  
SHEET 3 OF 6

G.P. 13-062