

LAYOUT 8/2/10 INSP 4 8/13/10
INSP 2 8/9/10 INSP 5 _____
INSP 3 8/12/10 INSP 6 _____

ISSUE DATE: 5/12/2010

APPROVAL DATE: _____

PERMIT

P 533319

A 531811

Tax ID # 1403292339

**ON-SITE SEWAGE DISPOSAL SYSTEM
HOWARD COUNTY HEALTH DEPARTMENT
BUREAU OF ENVIRONMENTAL HEALTH**

T & J Lawn Service IS PERMITTED TO INSTALL ☒ ALTER ☐

ADDRESS: _____ PHONE NUMBER: 410-784-4857

SUBDIVISION: BREEZEWOOD FARMS LOT NUMBER: _____

ADDRESS: 15751 BUSHY PARK ROAD PROPERTY OWNER: JOHN CLIME

SEPTIC TANK CAPACITY (GALLONS): 2000 OUTLET BAFFLE FILTER REQUIRED ☐

PUMP CHAMBER CAPACITY (GALLONS): NA COMPARTMENTED TANK REQUIRED ☒

NUMBER OF BEDROOMS: 4 APPLICATION RATE: 0.8

SQUARE FOOTAGE OF HOUSE: ~2,000

LINEAR FEET OF TRENCH REQUIRED: 155'

TRENCHES:	Trenches to be 3 feet wide. Inlet 3 feet below original grade. Bottom maximum depth 6 feet below grade. Effective area begins at 4 feet below original grade with 3 feet of stone below distribution pipe.
LOCATION:	Pump, fill & collapse existing drywell and septic tank, Set septic tank per drawing. Run 3 : 60' trenches on contour.
NOTES:	Do not order the septic tank until after layout inspection and Sanitarian approval. Stake septic easement corners. Call for layout inspection. Mark utilities. Gravel tickets must be available for Environmental Sanitarians. Stone must be approved by the Howard County Health Department. A written variance request is required for tanks deeper than 3 feet. A traffic bearing lid is required for tanks deeper than 4 feet.

PLANS APPROVED: HEIDI SCOTT DATE: 7/1/2010

NOTE: PERMIT VOID AFTER 2 YEARS

NOTE: CONTRACTOR RESPONSIBLE FOR SCHEDULING A PRE-CONSTRUCTION INSPECTION FOR ALL INSTALLATIONS

NOTE: WATERTIGHT SEPTIC TANKS REQUIRED

NOTE: ALL PARTS OF SEPTIC SYSTEM SHALL BE 100 FEET FROM ANY WATER WELL

NOTE: MANHOLE RISERS REQUIRED ON ALL SEPTIC TANKS AND PUMP CHAMBERS

**NEITHER THE HOWARD COUNTY COUNCIL OR THE HEALTH DEPARTMENT IS
RESPONSIBLE FOR THE SUCCESSFUL OPERATION OF ANY SYSTEM
PERMITTEE RESPONSIBLE FOR OBTAINING FINAL APPROVAL ON THIS PERMIT
CALL 410-313-1771 FOR INSPECTION OF SEPTIC SYSTEM**

NOT TO SCALE



See separate sheet for
As-Built

ROAD NAME

TRENCH/DRAINFIELD DATA

WIDTH 3 INLET 3' BOTTOM 6'

NUMBER OF TRENCHES 3

TOTAL LENGTH 178'

ABSORPTION AREA 534' + SW

DISTRIBUTION BOX LEVEL level

DISTRIBUTION BOX BAFFLE Yes

DISTRIBUTION BOX PORT Yes

SEPTIC TANK DATA

SEPTIC TANK 1 LEVEL Yes

MANUFACTURER Babylon

CAPACITY 2000 GAL

SEAM LOC Top

TANK LID DEPTH 2.5'

BAFFLES Yes

BAFFLE FILTER —

MANHOLE LOC Front

6" PORT LOC Rear

WATERTIGHT TEST no

SLOTTED Yes

DATE ON LID 6-22-10

PUMP/SEPTIC TANK LEVEL N/A

MANUFACTURER —

CAPACITY — GAL

SEAM LOC —

TANK LID DEPTH —

BAFFLES —

BAFFLE FILTER —

MANHOLE LOC —

6" PORT LOC —

WATERTIGHT TEST —

SLOTTED —

DATE ON LID —

PRE-CONSTRUCTION:

8/2/10 Trench layout given. 30x52' trenches are to be installed on contour starting just above perc test 1002. Set tank gora 15' from Dbox, out of 100' radius of ed. well. Call for inspection. Ex well needs to be raised above final grade min. 8". This can be done after permit. (KW)

INSTALLATION: 8/9/10 Trenches installed. Digging tank hole now. Told me to keep hole shallow (check dimensions). OK to backfill trenches. Leave Dbox network exposed when installed. (KW)

8/12/10 Tank set, baffles installed correctly, tank level. Dbox installed but not leveled. Contractor installed "bells" in pipe to trenches backwards. Reverse bell or add coupling and cut out bell and call for re-insp. 8/13/10 Couplers added. Bells switched around. Dbox leveled. Need S.H.C. (KW)

FINAL INSPECTOR

DATE OF APPROVAL

NOT TO SCALE

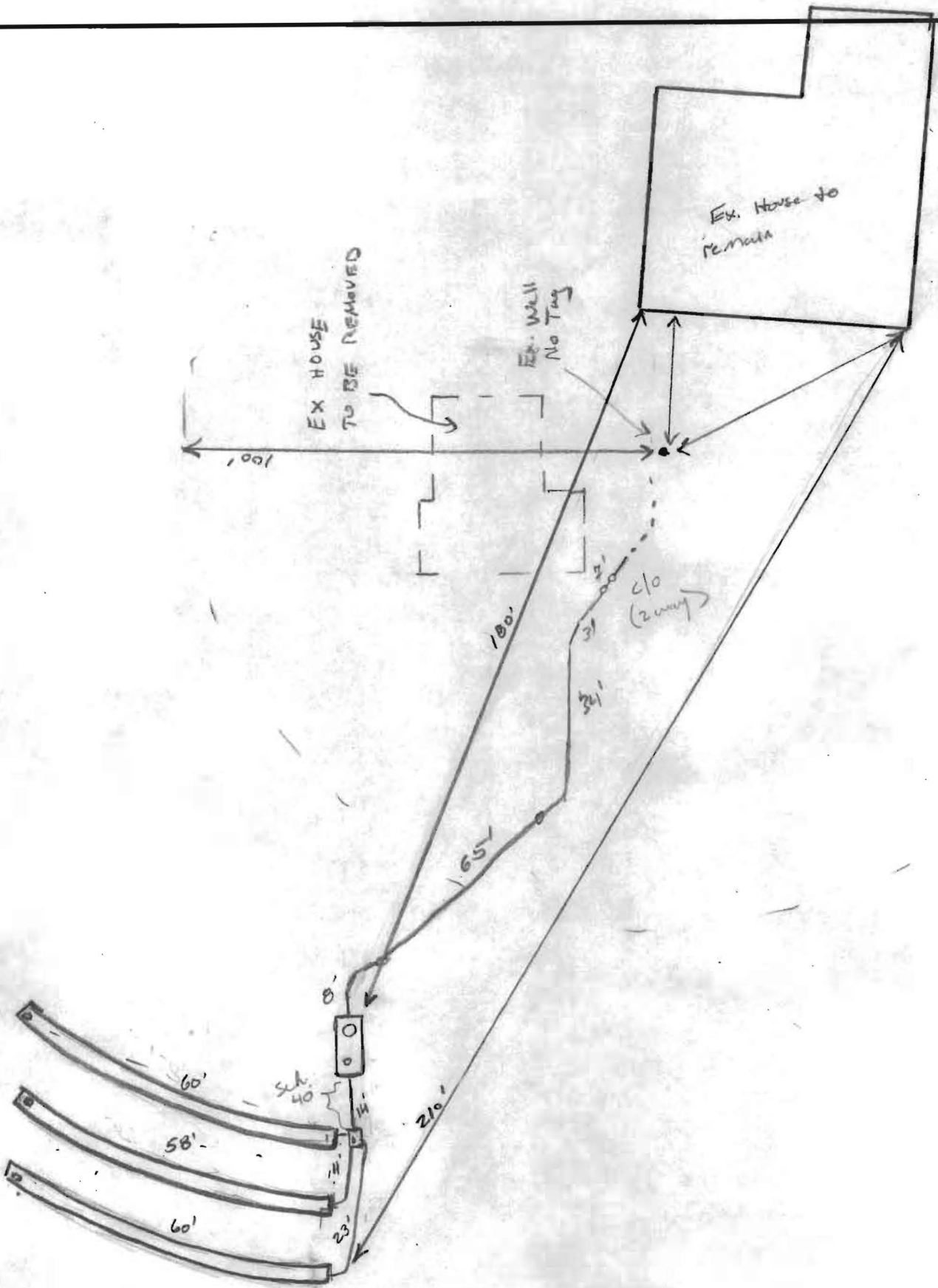

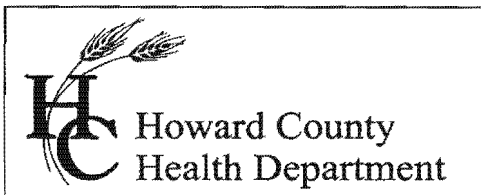

Bureau of Environmental Health
7178 Columbia Gateway Drive, Columbia MD 21046
(410) 313-2640 Fax (410) 313-2648
TDD (410) 313-2323 Toll Free 1-866-313-6300
website: www.hchealth.org

Peter L. Beilenson, M.D., M.P.H., Health Officer

October 14, 2010

TO: Kent Sheubrooks, Acting Chief
Division of Land Development

FROM: Michael J. Davis *mjd*
Assistant Director
Bureau of Environmental Health

RE: **SDP-10-090**
T & J Lawn Service Inc.

The Health Department has reviewed the proposed site development plan. Perc testing was conducted recently to establish a sewage disposal area and install a new septic system for a four bedroom home. The proposed building was not discussed. Contact Heidi Scott at the Health Department to discuss project details.

C: file

MJD

Peter L. Beilenson, M.D., M.P.H., Health Officer

July 7th, 2010

MEMORANDUM

TO: John R. Cline (Homeowner)
15751 Bushy Park Road
Breezewood Farms

FROM: Kevin M. Wolf, R.S., R.E.H.S. (kmw)
Environmental Sanitarian
Well and Septic Program

RE: 15751 Bushy Park Rd.
Woodbine, MD 21797
M. 14, G.1, P. 148, -- 5.634 A
(Demolition of Existing House and structure, re-build new house)

This is to advise that the Howard County Health Department recommends issuance of the demolition permit for the above referenced property. The existing well will be utilized for the replacement house. By doing so, you have agreed to the following conditions set forth by the Health Department.

Before demolition, the well that served the current house must be properly disconnected and sealed off. Also, protective devices must be placed around it to prevent any future damage. These precautions need to remain in place during the demolition and construction phases. The well (No Tag) can be reconnected to the new house.

Because of its age and design, the septic system tank and drywell will need to be properly abandoned (i.e. pumped, collapsed and filled in with clean fill). A new septic system will be designed in the newly established septic reserve area on your property. This will happen during building permit review.

A new septic permit will need to be obtained. A well inspection will be required for final approval when reconnecting to the new house. Additionally, applicable water tests for issuance of an ICOP will be needed.

KMW
Cc: File

June 28, 2010

Howard County Health Department
Water & Sewerage Program
7178 Columbia Gateway Drive
Columbia, MD 2106

Dear: Health inspector

re: 15751 Bushy Park Road

We would like to make you aware that the septic and water lines have been cut and capped as we are going to apply for a demolition permit for the above address. Can you please forward this to the proper department so that we may be released from your division.

Thank you,



John R. Clime

June 28,2010

Howard County Health Department
Water & Sewerage Program
7178 Columbia Gateway Drive
Columbia, MD 2106

Dear: Health inspector

re: 15751 Bushy Park Road

We would like to make you aware that the septic and water lines have been cut and capped as we are going to apply for a demolition permit for the above address. Can you please forward this to the proper department so that we may be released from your division.

Thank you,



John R. Clime

TOTAL SEPTIC

Septic Pumping • Repair • Inspection

P.O. Box 100
Lisbon, MD 21765
1-877-45-TOTAL
Fax 410-489-4316

001129

Septic Service Form

Owner's Name: TJ Lawn Service

Phone #: _____

Property Address: 15751 Bushy Park
WOODBINE MD

Septic tank accessible? ☒ YES ☐ NO

Distance from driveway: one hose

I give Total Septic permission to use my driveway as access to service my septic tank and will not hold them responsible should damage occur. X _____

Tank Condition: Good ☒ Fair ☐ Poor

Suggested repairs: pumped Drywell and septic tank
for collapsing of both

Estimated cost \$ _____

Size: 500 1000 1250 1500 ☒ Other

Solids: Light Regular Heavy

Backflush 1x 2x Other

Other Repairs/Services:

1: _____ \$ N/A
2: _____ \$ N/A
3: _____ \$ _____

Bill Paid, Check # _____ Total Charges \$ 185.00

Send Bill to: _____

Service performed was acceptable: x [Signature] Date: 10/2/10

I authorize Total Septic to clean my sewer line using a jet machine and understand that they will take every precaution to not damage the existing line. I will not hold Total Septic responsible should the sewer line be damaged through no fault of their own. X _____

Thank you for using Total Septic for your septic needs