

Bureau of Environmental Health  
 7178 Gateway Drive Columbia, MD 21046  
 (410) 313-2640 Fax (410) 313-2648  
 TDD (410) 313-2323 Toll Free 1-866-313-6300  
 website: www.hchealth.org

Dr. Peter Beilenson, M.D., M.P.H., Health Officer

**DEMOLITION REQUEST FORM**

(Please fill in all blanks)

**Information of Property to be Demolished:**

Cornerstone Holdings, LLC 10885 Harmel Drive  
 Current Owner's Name Property Address  
Columbia, MD 21044

Ledar Acres  
 Subdivision (if applicable) Lot # 6

Sandra Boyer  
Melvin Anders  
 All Prior Owners' Names (if requested or known) Tax Map 35 Parcel # 101 Tax ID # 05-341566

To clear dot for development  
 Purpose/Reason for Demolition

3 New Buildable dots  
 Future plans of property after demo (i.e. subdivision, parking lot, re-build new house, etc...)

If a subdivision, SDP# \_\_\_\_\_ Has the structure(s) been deemed unsafe by DILP  YES  NO

**UTILITY RECORDS:**

Property currently connected to public water  YES  NO

Property currently connected to public sewer  YES  NO

Does the property currently have any wells and/or septic systems  YES  NO

→ Explain:

\*Note: Any wells and/or septic systems that are to remain may require an approved percolation certification plan under *Howard County Code Sec. 3.805*

\*Note: Any septic systems that are to be abandoned must be done by a septic contractor with documentation of the process.

\*Note: All abandoned wells are to be sealed by a well driller licensed by the Maryland State Board of Well Drillers *COMAR Sec 26.04.04.11 Abandonment Standards D (3)*

**COMMENTS:**

Theresa M. Chevery  
Office manager  
 Applicant's Name (please print)

(410) 792-2565  
 Applicant's Phone #

tee tee 7761@comcast.net  
 Applicant's Email

(410) 792-2567  
 Applicant's Fax #

Theresa M. Chevery, Office  
Mgr.  
 Applicant's Signature

3/27/13  
 Date

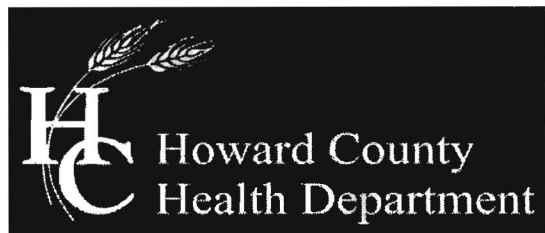

## Bureau of Environmental Health

7178 Columbia Gateway Drive, Columbia, MD 21046-2147

Main: 410-313-2640 | Fax: 410-313-2648

TDD 410-313-2323 | Toll Free 1-866-313-6300

[www.hchealth.org](http://www.hchealth.org)

Facebook: [www.facebook.com/hocohealth](http://www.facebook.com/hocohealth)

Twitter: HowardCoHealthDep

**Maura J. Rossman, M.D., Health Officer**

---

### MEMORANDUM

April 29, 2013

TO: Theresa Cheverly  
Cornerstone Homes

FROM: Jeff Williams  
Program Supervisor  
Well and Septic Program

RE: 10885 Harmel Road  
Columbia, MD 21044  
Demolition of existing dwelling

---

This is to advise that the Howard County Health Department recommends issuance of the demolition permit for the structures on the above referenced property.

The well and on-site sewage disposal system serving the dwelling have been properly abandoned and notification was delivered to the Health Department.

If any additional wells or on-site sewage disposal systems are found during site work, you must notify this office immediately.

Cc: Property file

MARYLAND DEPARTMENT OF THE ENVIRONMENT, WATER MANAGEMENT ADMINISTRATION  
 1800 Washington Blvd., Baltimore, Maryland 21230 (410) 537-3784

\*\*\*\*\*  
 WATER WELL ABANDONMENT-SEALING REPORT FORM  
 \*\*\*\*\*

SUBMIT COPIES OF COMPLETED FORM TO:

- \* COUNTY ENVIRONMENT AGENCY (contact MDE, WMA if address needed)
- \* WELL OWNER
- \* MDE, WATER MANAGEMENT ADMINISTRATION, WELL PROGRAM

DATE WELL ABANDONED: 4/4/13 (month/day/year)

\* PERMIT NUMBER OF ABANDONED WELL (if any) \_\_\_\_\_

\* PERMIT NUMBER OF REPLACEMENT WELL \_\_\_\_\_

\* PERSON ABANDONING WELL: Michael Isom

WELL DRILLERS LICENSE NUMBER: 162

CIRCLE: MWD/MSD/MGD

\* OWNER'S NAME: Cornestone Homes

SITE LOCATION MAP

\* WELL LOCATION:  
 COUNTY: HOWARD  
 NEAREST TOWN: Columbia  
 TAX MAP \_\_\_\_\_ BLOCK \_\_\_\_\_ PARCEL \_\_\_\_\_  
 SUBDIVISION: \_\_\_\_\_  
 SECTION: \_\_\_\_\_ LOT: \_\_\_\_\_  
 NEAREST ROAD: 10885 Harmel Drive

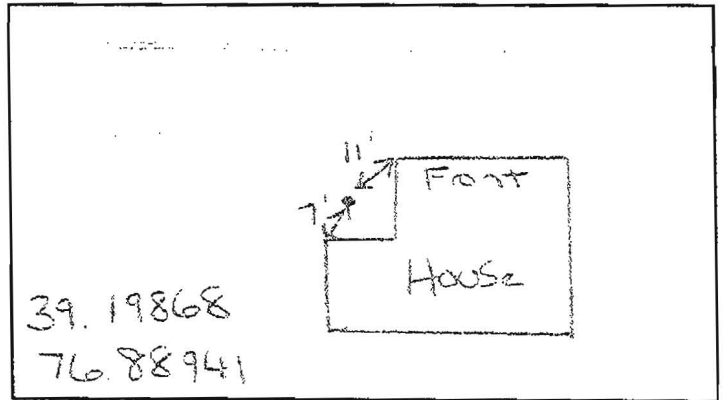

\* TYPE OF WELL BEING ABANDONED:

- DRILLED \_\_\_\_\_ JETTED
- \_\_\_\_\_ BORED/AUGERED \_\_\_\_\_ HAND DUG
- \_\_\_\_\_ OTHER (specify) \_\_\_\_\_

\* USE CODE:

- DOMESTIC \_\_\_\_\_ MUNICIPAL/PUBLIC
- \_\_\_\_\_ IRRIGATION \_\_\_\_\_ INDUSTRIAL
- \_\_\_\_\_ TEST/OBSERVATION \_\_\_\_\_ GEOTHERMAL

\* TYPE OF CASING:

- STEEL \_\_\_\_\_ PLASTIC
- \_\_\_\_\_ CONCRETE \_\_\_\_\_ OTHER (specify) \_\_\_\_\_

\* SIZE OF CASING: 6 INCHES IN DIAMETER

\* DEPTH OF WELL: 50 FEET DEEP

\* WAS ANY CASING REMOVED? \_\_\_\_\_ YES \_\_\_\_\_ NO  
 if yes, length removed, in feet: \_\_\_\_\_

\* WAS CASING RIPPED OR PERFORATED? \_\_\_\_\_ YES \_\_\_\_\_ NO

LOG OF SEALING MATERIAL

MATERIAL	FEET	
	FROM	TO
Bentonite clay	50	0
VOLUME OF MATERIAL USED		

SIGNATURE-MASTER WELL DRILLER OR SUPERVISING SANITARIAN  
 DENV 828 JULY 1997

162 MWD/MSD/MGD  
 LICENSE # CIRCLE ONE DATE 4/4/13

4) WELL OWNER



**Z's CONTRACTING, L.L.C.**  
**2115 SAND HILL ROAD, MARRIOTTSVILLE, MARYLAND, 21104**

April 15, 2013

Howard County Health Department  
Water and Sewerage Program  
7178 Columbia Gateway Drive  
Columbia, MD 21046

RE: 10885 Harmel Drive  
Columbia, Maryland, 21044

To Whom It May Concern:

This letter is to confirm that the septic system at the above referenced address has been abandoned and sealed. The system was pumped, crushed/collapsed and backfilled with clean fill dirt.

If you have any questions, please do not hesitate to call either myself at (410) 493-7957 or John Connors, Director of Construction, Cornerstone Homes, Inc., at (410) 792-2565.

Sincerely,

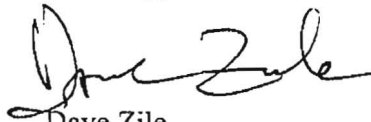

Dave Zile  
Owner  
Z's Contracting, L.L.C.



Cornerstone  
Homes, Inc.

9695 Norfolk Avenue ■ Laurel, Maryland 20723  
(410) 792-2565 ■ Fax (410) 792-2567

March 27, 2013

Howard County Health Dept.  
Water and Sewerage Program  
7178 Columbia Gateway Drive  
Columbia, MD 21046-2132

RE: Demolition Permit  
10885 Harmel Drive, Columbia, Maryland, 21044

To Whom It May Concern:

Please let this letter serve as the request of Cornerstone Homes, Inc. to have released the above referenced property at your earliest convenience so we may obtain a demolition letter that can be attached to our demolition permit application. This property has well and septic service and we will be abandoning both. We will provide to you the proper paperwork confirming that this has been completed. It also has water and sewer service which we will be re-using. Attached is the Demolition Request Form.

Thank you for your assistance in this matter. If you have any questions, or need any additional information, please do not hesitate to call either myself or Brian Boy at (410) 792-2565.

Sincerely,

Theresa M. Chevery  
Office Manager  
Cornerstone Homes, Inc.

tmc

Enclosure

## Williams, Jeffrey

---

**From:** Williams, Jeffrey  
**Sent:** Tuesday, April 09, 2013 2:07 PM  
**To:** 'teetee7761@comcast.net'; 'theresa@cornerstone-homes.com'  
**Subject:** demo permit 10885 Harmel Drive

We have received your demolition request form for 10885 Harmel Drive. I see on the form that there are existing well & septic components that must be abandoned. We require that they be abandoned prior to issuance of the demo permit. What we will need is a copy of the well abandonment report from the well driller and a memo on letterhead from the excavator who abandons the septic describing what they did to abandon the septic. Those can be forwarded to my attention. Once we receive them, I can issue a memo recommending issuance of the demo permit. Thanks

Jeff Williams  
Program Supervisor, Well & Septic Program  
Bureau of Environmental Health  
Howard County Health Dept.  
410-313-4261  
[jewilliams@howardcountymd.gov](mailto:jewilliams@howardcountymd.gov)

### CONFIDENTIALITY NOTICE

This message and the accompanying documents are intended only for the use of the individual or entity to which they are addressed and may contain information that is privileged, confidential, or exempt from disclosure under applicable law. If the reader of this email is not the intended recipient, you are hereby notified that you are strictly prohibited from reading, disseminating, distributing, or copying this communication. If you have received this email in error, please notify the sender immediately and destroy the original transmission.