

5/23/74

PERMIT

SEWAGE DISPOSAL SYSTEM

MARYLAND STATE DEPARTMENT OF HEALTH

HOWARD COUNTY

ELLICOTT CITY

DISTRICT 5

DATE 11/8/73

INDEXED

Gene Evans

IS PERMITTED TO INSTALL ☒ ALTER

ADDRESS 808 Maple Crest Drive, Baltimore, Md. 21220 PHONE 686-8953

A SEWAGE DISPOSAL SYSTEM LOCATED AT

SUBDIVISION 6666 6636 ROAD Cedar Lane (see application for better directions) LOT

PROPERTY OWNER Roger Walter Dorsey & wife

ADDRESS

SPECIFICATIONS - 2 bedrooms

DRAIN FIELD DEPTH FEET, BOTTOM AREA SQ. FT.

SEEPAGE PITS ABSORBENT SIDE-WALL AREA SQ. FT.

SEPTIC TANK CAPACITY 1,000 GALLONS

FOR GARBAGE GRINDER, INCREASE DISPOSAL AREA 22% & TANK CAPACITY 50%.

OTHER Dry well - 300 sq. ft. absorbent sidewall area to begin below inlet pipe.

Inlet pipe 3 to 4 ft. below original grade. Max. depth permitted for dry well below

original grade is 10 ft. Place dry well about 300 ft. from front lot line (Cedar Lane)

and about 85 ft. from left side line as seen when facing lot from Cedar Lane.

NOTE: ALL PIPE FROM HOUSE TO DRY WELL MUST BE CAST IRON.

PERMIT VOID AFTER THREE YEARS.

NOTE: INSTALL STAND PIPE ON SEPTIC TANK AND DRY WELL.

PLANS APPROVED BY D. W. Monaghan DATE 8/22/67

FILL SEPTIC TANK AND DISTRIBUTION BOX WITH WATER BEFORE CALLING FOR AN INSPECTION. COVER NO WORK UNTIL INSPECTED AND APPROVED.

NEITHER THE HOWARD COUNTY COMMISSIONERS NOR THE HEALTH DEPARTMENT IS RESPONSIBLE FOR THE SUCCESSFUL OPERATION OF ANY SYSTEM.

Dry well - 16 ft. sq. set 24" top for 12 ft. diam.
fill in rest with gravel.
Dry well must have 5 ft. depth of effective area
below the inlet pipe. WDM - 11/8/73

File # 19248
5/23/74

P 19248

A 12974

12974

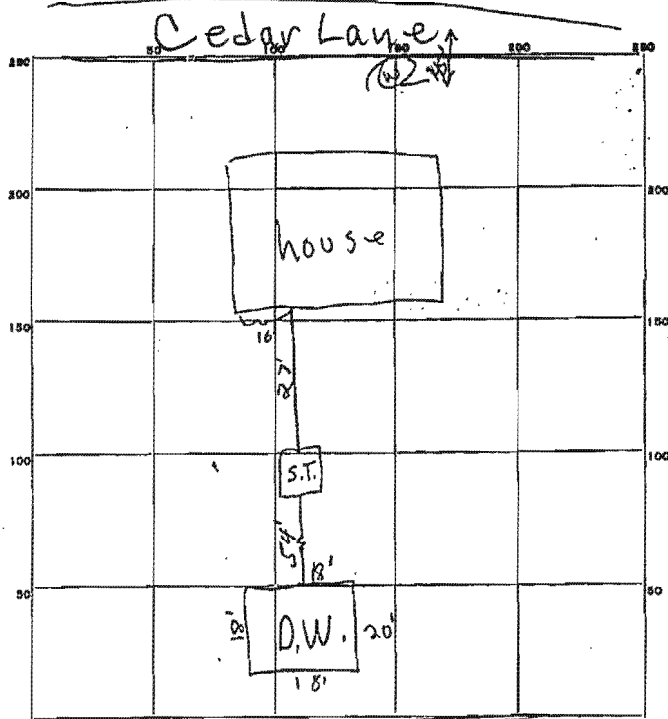

PERMIT CARD N.P. S.T. / D.W.

SEPTIC TANK, LEVEL ✓ CLEANOUTS ✓ / ✓

DISTRIBUTION BOX, LEVEL _____

TILE FIELD, DEPTH _____ FT. TRENCH WIDTH _____ FT.

GRAVEL DEPTH _____ IN. TOTAL LENGTH _____ FT.

NUMBER OF TRENCHES _____ TOTAL BOTTOM AREA _____

OUTSIDE PERIMETER 74 FT. DEPTH BELOW INLET 6 FT.

SEEPAGE PITS, INSIDE DIAMETER _____

ABSORBENT AREA ~444 SQ. FT.

REMARKS 1/23/74 - Pot hole - partially blocked. called Mr. Evans to have system dug out and in to call
before any stone is installed
4/3/74 OK to put gravel around D.W. Revised

DATE SYSTEM APPROVED 5/23/74 INSPECTOR Frank Skinner