

C1 5949 SEQUENCE NO. (OEP USE ONLY)  
 (THIS NUMBER IS TO BE PUNCHED IN COLS. 3-6 ON ALL CARDS)

STATE OF MARYLAND  
 WELL COMPLETION REPORT  
 FILL IN THIS FORM COMPLETELY  
 PLEASE PRINT OR TYPE

THIS REPORT MUST BE SUBMITTED WITHIN 45 DAYS AFTER WELL IS COMPLETED.  
 COUNTY NUMBER A 26619

DATE Received [ ] DATE WELL COMPLETED 062987 Depth of Well 365 (TO NEAREST FOOT) PERMIT NO. 10-81-2128

OWNER ASSOCIATES CARMEN STREET OR RFD DAYTON MEADOWS CT. TOWN DAYTON SUBDIVISION DAYTON MEADOWS SECTION 1 AREA 1 LOT 12

WELL LOG

Not required for driven wells

STATE THE KIND OF FORMATIONS PENETRATED, THEIR COLOR, DEPTH, THICKNESS AND IF WATER BEARING

DESCRIPTION (Use additional sheets if needed)	FEET		Check if water bearing
	FROM	TO	
SAND	0	40	
GRAY MICACIOUS	40	365	

GROUTING RECORD

WELL HAS BEEN GROUTED (Circle Appropriate Box) YES (Y) NO (N)

TYPE OF GROUTING MATERIAL CEMENT (CM) BENTONITE CLAY (BC)

NO. OF BAGS 14 NO. OF POUNDS 1316

GALLONS OF WATER 84

DEPTH OF GROUT SEAL (to nearest foot) from 0 ft. to 49 ft.

CASING RECORD

casing types insert appropriate code below

STEEL (ST) CONCRETE (CO) PLASTIC (PL) OTHER (OT)

MAIN CASING TYPE SF

Nominal diameter top (main) casing (nearest inch) 6

Total depth of main casing (nearest foot) 48

OTHER CASING (if used)

diameter inch depth (feet) from to

SCREEN RECORD

screen type or open hole insert appropriate code below

STEEL (ST) BRASS (BR) OPEN HOLE (HO) PLASTIC (PL) OTHER (OT)

DEPTH (nearest ft.)

EACH SCREEN

1	HO	45	305
2			
3			

SLOT SIZE 1 2 3

DIAMETER OF SCREEN (NEAREST INCH) from to

GRAVEL PACK IF WELL DRILLED WAS FLOWING WELL INSERT F IN BOX 68

OEP USE ONLY (NOT TO BE FILLED IN BY DRILLER)

T (E.R.O.S.) WQ

TELESCOPE CASING LOG INDICATOR OTHER DATA

PUMPING TEST

HOURS PUMPED (nearest hour) 6

PUMPING RATE (gal. per min. to nearest gal.) 100

METHOD USED TO MEASURE PUMPING RATE bucket

WATER LEVEL (distance from land surface) BEFORE PUMPING 54 WHEN PUMPING 218

TYPE OF PUMP USED (for test) S submersible

PUMP INSTALLED

DRILLER WILL INSTALL PUMP YES (NO)

IF DRILLER INSTALLS PUMP, THIS SECTION MUST BE COMPLETED FOR ALL WELLS EXCEPT HOME USE

TYPE OF PUMP INSTALLED PLACE (A,C,J,P,R,S,T,O) IN BOX - SEE ABOVE:

CAPACITY: GALLONS PER MINUTE (to nearest gallon) PUMP HORSE POWER PUMP COLUMN LENGTH (nearest ft.) CASING HEIGHT (circle appropriate box and enter casing height) LAND SURFACE (nearest foot)

CIRCLE APPROPRIATE LETTER

A WELL WAS ABANDONED AND SEALED WHEN THIS WELL WAS COMPLETED

E ELECTRIC LOG OBTAINED

P TEST WELL CONVERTED TO PRODUCTION WELL

I HEREBY CERTIFY THAT THIS WELL HAS BEEN CONSTRUCTED IN ACCORDANCE WITH COMAR 10.17.13 "WELL CONSTRUCTION" AND IN CONFORMANCE WITH ALL CONDITIONS STATED IN THE ABOVE CAPTIONED PERMIT, AND THAT THE INFORMATION PRESENTED HEREIN IS ACCURATE AND COMPLETE TO THE BEST OF MY KNOWLEDGE.

DRILLERS IDENT. NO. 238

DRILLERS SIGNATURE Joseph S. Mayone

SITE SUPERVISOR (sign. of driller or journeyman responsible for sitework if different from permittee)

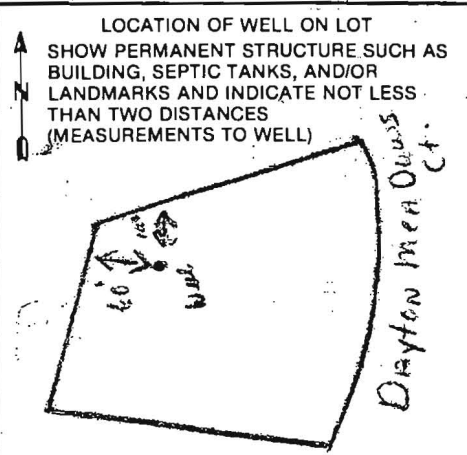

B 1 8285 SEQUENCE NO. (OEP USE ONLY)  
(THIS NUMBER IS TO BE PUNCHED IN COLS. 3-6 ON ALL CARDS)

STATE OF MARYLAND  
PERMIT TO DRILL WELL  
please print or type

OEP PERMIT NUMBER  
40-81-2128  
fill in this form completely

Date Received  
OWNER INFORMATION  
CARMAN ASSOCIATES  
Box 122  
E. L. K. I. C. H. A. CITY MD 21043

DRILLER INFORMATION  
Joseph I. Mayne  
Joseph I. Mayne Well Drilling  
5512 Ridge Rd. Mt. Airy 21771  
5/21/87

WELL INFORMATION  
APPROX. PUMPING RATE (GAL. PER MIN.) 3  
AVERAGE DAILY QUANTITY NEEDED (GAL. PER DAY) 500

USE FOR WATER (CIRCLE APPROPRIATE BOX)  
HOME (SINGLE OR DOUBLE HOUSEHOLD UNIT ONLY)  
FARMING (LIVESTOCK WATERING & AGRICULTURAL IRRIGATION)  
INDUSTRIAL, COMMERCIAL, STATE AND FEDERAL GOV. OTHER (REQUIRES APPROPRIATION PERMIT)  
PUBLIC OR PRIVATE WATER COMPANY (REQUIRES APPROPRIATION PERMIT AND STATE HEALTH DEPARTMENT APPROVAL)  
TEST, OBSERVATION, MONITORING (MAY REQUIRE APPROPRIATION PERMIT)

APPROXIMATE DEPTH OF WELL 300 FEET

APPROXIMATE DIAMETER OF WELL 6 INCH NEAREST

METHOD OF DRILLING (circle one)  
BORED (or Augered) JETTED Jetted & DRIVEN  
AIR-ROTARY AIR-PERCussion ROTARY (Hydraulic Rotary)  
CABLE REVERSE-ROTARY DRIVE-POINT  
other

REPLACEMENT OR DEEPEINED WELLS (CIRCLE APPROPRIATE BOX)  
THIS WELL WILL NOT REPLACE AN EXISTING WELL  
THIS WELL WILL REPLACE A WELL THAT WILL BE ABANDONED AND SEALED  
THIS WELL WILL REPLACE A WELL THAT WILL BE USED AS A STANDBY  
THIS WELL WILL DEEPEIN AN EXISTING WELL  
PERMIT NUMBER OF WELL TO BE REPLACED OR DEEPEINED (IF AVAILABLE)

Not to be filled in by driller (OEP USE ONLY)  
APPROP. PERMIT NUMBER GAP  
FORCE INITIALS IN BOX PERMIT No. 40-81-2128

SPECIAL CONDITIONS

LOCATION OF WELL  
HOWARD COUNTY  
DAYTON MEADOWS CI  
SECTION E LOT 19 AREA  
DAYTON  
MILES FROM TOWN (enter 0 if in town) 0 MI

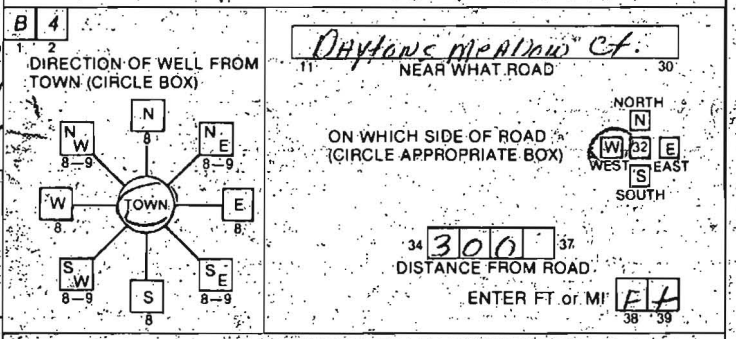

NOT TO BE FILLED IN BY DRILLER HEALTH DEPARTMENT APPROVAL  
HOWARD COUNTY NAME A26619 COUNTY NO.  
OEP SIGNATURE DATE ISSUED 06/12/87 B. N. Wilson 12/12/87  
NORTH GRID 512000 EAST GRID 0801000

SHOW MAJOR FEATURES OF BOX & LOCATE WELL WITH AN X  
SOURCES OF DRILLING WATER  
1. Well  
WRITE THE BOX NUMBER FROM THE MAP HERE:  
8001  
5102

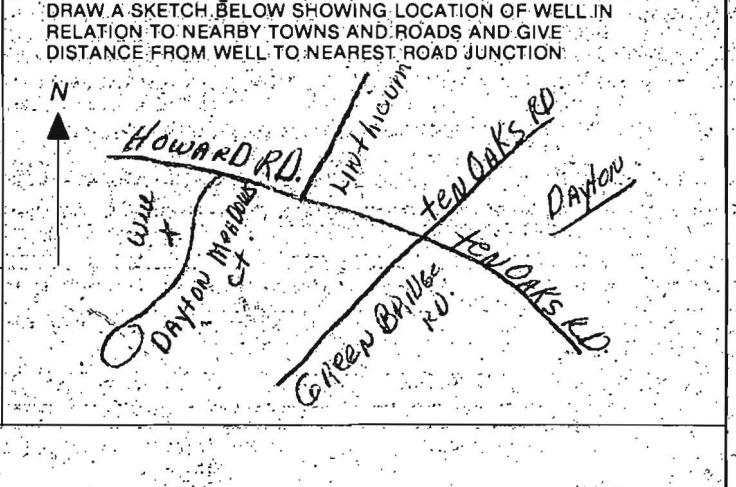

Page      of       
 Date 6/29/87

Review 11/24/87 S.M.W. Jr

**FIELD DATA SHEET  
 HOWARD COUNTY WELL YIELD TEST**

Well Permit No. HO - 81-2128  
 Location of property (road) Nauston Meadows Ct  
 Subdivision Nauston Meadows Lot 12 Block      Plat      Sec. I  
 Well Driller Joseph Maize Owner Corman Ass.

Depth of well 365'  
 Distance of measuring point (M.P.) above ground 3'  
 Static water level (S.W.L.) below M.P. 54'

**I. High rate pumping -- reservoir drawdown**

Time pump started 9:30 Pumping rate 12 gal.  
 Total time 45 min to reach pumping water level 218 ft. below M.P.

**II. Recovery pump test data - observations to be recorded every 15 minutes**

TIME (in 15 minute intervals)	WATER LEVEL below M.P.	PUMPING RATE time to fill $\frac{1}{2}$ gallon bucket	FLOW METER READING (if used)	CALCULATED FLOW (gallons per minute)
9:45	118	5		12
10:00	192	6		10
10:15	218	6		10
10:30	218	36		1 $\frac{6}{10}$
10:45	218	36		1 $\frac{6}{10}$
11:00	218	36		1 $\frac{6}{10}$
11:15	218	36		1 $\frac{6}{10}$
11:30	218	36		1 $\frac{6}{10}$
11:45	218	36		1 $\frac{6}{10}$
12:00	218	36		1 $\frac{6}{10}$
12:15	218	36		1 $\frac{6}{10}$
12:30	218	36		1 $\frac{6}{10}$
12:45	218	36		1 $\frac{6}{10}$
1:00	218	36		1 $\frac{6}{10}$
1:15	218	36		1 $\frac{6}{10}$
1:30	218	36		1 $\frac{6}{10}$
1:45	218	36		1 $\frac{6}{10}$
2:00	218	36		1 $\frac{6}{10}$
2:15	218	36		1 $\frac{6}{10}$
2:30	218	36		1 $\frac{6}{10}$
2:45	218	36		1 $\frac{6}{10}$
3:00	218	36		1 $\frac{6}{10}$
3:15	218	36		1 $\frac{6}{10}$
3:30	218	36		1 $\frac{6}{10}$
3:45	218	36		1 $\frac{6}{10}$
4:00	218	36		1 $\frac{6}{10}$

STATE OF MARYLAND  
DEPARTMENT OF HEALTH AND MENTAL HYGIENE  
LABORATORIES ADMINISTRATION  
REPORT OF WATER ANALYSIS

Sample Number: H 1092 Name: CHARMEN ASSOC County: HOWARD

Source of Sample: DAYTON MEADOWS LOT 12 Collector: STAYER  
Street Town or City

Sample Type (Circle): Community Source Non-Community Distribution Private MCL Emergency Recheck Routine

Remarks: MD 51-2128

County: 13 Plant No.      Sampling Station      Date Collected 062987 Time 1230<sup>P</sup> Acid  Iced

Field Data: pH\*      Chlorine Residual Free      Total      Specific Conductance     

✓	ANALYSIS	CODE	RESULTS	✓	ANALYSIS	CODE	RESULTS
	pH*	011			Arsenic	253	
	Alkalinity (Total)	040			Barium	262	
	Alkalinity (HCO <sub>3</sub> )	050			Cadmium	273	
	Alkalinity (CO <sub>3</sub> )	060			Chromium	283	
	pH*, Ca CO <sub>3</sub> , SAT.	071			Lead	302	
	Alkalinity, Ca CO <sub>3</sub> , SAT	080			Mercury	314	
	Hardness	110			Selenium	323	
	Ammonia-N	143			Silver	333	
✓	Nitrate-Nitrite N	162	4		Aluminum	192	
	Nitrite N	173			Calcium	231	
	MBAS	182			Copper	241	
	Chloride	091			Iron	122	
	Fluoride	101			Magnesium	241	
	Color*	020			Manganese	133	
	Turbidity*	031			Nickel	391	
	Conductance*, SPEC.	201			Potassium	361	
	Silica	210			Sodium	371	
	Sulfate	220			Zinc	342	
	Total Residue	381					

\* Results reported in units, all others in milligrams per liter (ppm)

Date Received      Date Reported      Chemist      Lab No. 16818

11/13/92

HOWARD COUNTY HEALTH DEPARTMENT  
Bureau of Environmental Health  
3525-H Ellicott Mills Drive  
Ellicott City, MD 21043  
461-9933

OK  
Final  
C.B.S.

APPLICATION FOR PITLESS ADAPTER, WELL PUMP AND PRESSURE TANK INSTALLATION  
LINE

New Installation X Replacement \_\_\_\_\_  
Receipt # - 0 -  
Date 11/4/92  
Name of Installer LEAGA PLS + Htg Co. Telephone 465-1401  
License Number 6318  
Certified Well Pump Installer \_\_\_\_\_ Well Driller \_\_\_\_\_ Registered Plumber X  
Name of Property Owner TRINITY HOMES Telephone \_\_\_\_\_  
Subdivision DAYTON MEADOWS Lot # 12 Well Tag # HO-51-2128  
Site Address 13814 DAYTON MEADOWS CT

Pump Motor Pitless Adapter  
1. Type 1. Horsepower 1/4 1. Make \_\_\_\_\_  
a. Deep well jet \_\_\_\_\_ 2. RPM \_\_\_\_\_ 2. Model # \_\_\_\_\_  
b. Shallow well jet \_\_\_\_\_ 3. Voltage \_\_\_\_\_ 3. Depth \_\_\_\_\_  
c. Submersible X a. 110 \_\_\_\_\_  
2. Make \_\_\_\_\_ b. 220 X  
3. Model # \_\_\_\_\_  
4. Capacity \_\_\_\_\_ GPM  
5. Pump exceeds well capacity Yes \_\_\_\_\_ No X  
6. If Yes, is low pressure cutoff switch installed? Yes \_\_\_\_\_ No \_\_\_\_\_  
7. What methods are used to protect the pump and electrical wiring from vibrations? Torque arrestors \_\_\_\_\_ Cable guards \_\_\_\_\_ Other X

Tank Piping Well data  
1. Capacity 80 gal 1. Type P.E 1. Depth \_\_\_\_\_ ft.  
2. Pressure relief valve? YES 2. Size 1/2" 2. Yield \_\_\_\_\_ GPM  
3. NSF and/or BOCA Code approved \_\_\_\_\_ 3. Static water level \_\_\_\_\_ ft.  
4. Depth of supply line \_\_\_\_\_ 4. Will water supply be disinfected by installer? \_\_\_\_\_

I understand that it is my responsibility to notify the Howard County Health Department when the installation is ready for inspection (otherwise this permit is null and void).

All information given above is true to the best of my knowledge.  
Signature of Applicant: [Signature]

Date: 11/3/92

Note: A sticker indicating approval/status of the installation will be placed on the well casing at the time of the inspection.

11/14/92 Note ok at casing area of well, only. C.B.S.

CASELL TESTING, INC.

ENVIRONMENTAL SAMPLING AND TESTING  
10940 BEAVER DAM ROAD, HUNT VALLEY, MD 21030  
(410) 252-7742

REPORT DATE: Dec 22, 1992

County Howard

Lab Number 92-4979

CERTIFICATE OF ANALYSIS

Maryland State Certified Water Quality  
Laboratory No. 115

Sample iced Yes  
Residual Cl<sub>2</sub> <0.1 mg/L

REQUESTER: Attn: Lynn  
Trinity Builders  
6212 Devon Drive  
Columbia, Maryland 21044

cc: County Health Dept. Yes

Property Sampled: U&O: 13814 Dayton Meadows Court

Station Sampled: Kitchen

Tax Map #:

Date/Time Sampled: Dec 21, 1992 2:55 pm

Parcel #:

Owner, Telephone No.: Brian Long

Sampler: J. Lynn #88-249M

Subdivision Name: Dayton Meadows

Lot Number: 12

Building Permit No.: 44786

Well Number: HO-81-2128

Observation: Satisfactory

RESULTS OF ANALYSIS:

Parameter	Result	Method	MCL	
Nitrate	0.6 mg/L as N	ISE	10.0 mg/L as N	Pass
Turbidity	<1.0 NTU	EPA 180.1	10.0 NTU	Pass
pH	7.1 Units	EPA 150.1	6.5-8.5 Units	
Sand	Negative		Negative	
Total Coliform	Present	ONPG-MMO MUG	Absent	Fail
Fecal Coliform	Absent			

Based upon coliform bacteriological standards, the above results indicate that at the time the sample was collected, this water sample was UNSAFE for drinking purposes.

B2  
12/30/92  
Hold for more tests

Sharon K. Cassell  
Sharon K. Cassell

\* MCL = Maximum Contamination

6/25/84  
SUBDIVISION:

DAYTON MEADOWS  
DAYTON MEADOWS CT.  
SEC 1 AREA 1  
DRY WELL OR DRY WELL AND TRENCH

A 26619

LOT NUMBER: 12

sq. ft./bedroom

	Septic Tank
3 bedroom	1000 gallon
4 bedroom	1250 gallon
5 bedroom	1500 gallon

Minimum Total Square Feet

Inlet \_\_\_\_\_ feet below original grade.  
 Bottom maximum depth \_\_\_\_\_ feet below original grade.  
 Effective area begins at \_\_\_\_\_ feet below original grade.

NOTE: If trench is used to make up absorbent area, run the trench on level ground and leave a 5-foot earth buffer between dry well and trench. No trench is to exceed 100 feet in length. Trench inlet to be same as dry well, with \_\_\_\_\_ feet of stone below distribution pipe.

TRENCHES

Trench to be 2 wide. 220 sq. ft./bedroom  
55 LINEAR FT / BEDROOM  
 Inlet 4 1/2 feet below original grade. 220 LINEAR FT  
 Bottom maximum depth 8 1/2 feet below original grade. PER 4 BEDROOMS  
 Effective area begins at 4 1/2 feet below original grade.  
4 feet of stone below distribution pipe.

- NOTE:
- (1) No trench to exceed 100 feet in length.
  - (2) If more than one trench used, a distribution box is required.
  - (3) Trenches to be installed on level ground.
  - (4) Call for inspection of trench before gravel is installed.
  - (5) Provide 6" - 8" diameter cleanout and cap to grade or above on septic tank and drywell.
  - (6) If a garbage disposal is used, increase septic tank capacity by 50% and increase absorbent sidewall area by 22%.

LOCATION: BEGINNING FROM THE LEFT FRONT LOT CORNER  
 PLACE 1ST TRENCH 120' DOWN THE LEFT (375') LOT LINE  
 AND 190' OFF THE LEFT LINE AS SEEN WHEN FACING  
 PROPERTY FROM DAYTON MEADOWS CT. RUN TRENCHES  
 ALONG CONTOUR TOWARDS THE FRONT (450') LOT LINE.

## CASSELL TESTING, INC.

ENVIRONMENTAL SAMPLING AND TESTING  
10940 BEAVER DAM ROAD, HUNT VALLEY, MD 21030  
(410) 252-7742

REPORT DATE: Jan 14, 1993

County Howard

Lab Number 93-0129

Sample Iced Yes  
Residual Cl<sub>2</sub> <0.1 mg/L

cc: County Health Dept. Yes

## CERTIFICATE OF ANALYSIS

Maryland State Certified Water Quality

Laboratory No. 115

REQUESTER: Attn: Lynn  
Trinity Builders  
6212 Devon Drive  
Columbia, Maryland 21044

Property Sampled: U&amp;O: 13814 Dayton Meadows Court, retest #3

Station Sampled: Kitchen tap

Tax Map #:

Date/Time Sampled: Jan 13, 1993 9:45 am

Parcel #:

Owner, Telephone No.: Brian Long 531-5632

Sampler: S. Cassell #084

Subdivision Name: Dayton Meadows

Lot Number: 12

Building Permit No.: 44786

Well Number: HO-81-2128

Observation: Satisfactory

## RESULTS OF ANALYSIS:

Parameter	Result	Method	MCL	
Total Coliform	Present	ONPG-MMO MUG	Absent	Fail
Fecal Coliform	Absent			

Based upon coliform bacteriological standards, the above results indicate that at the time the sample was collected, this water sample is UNSAFE for drinking purposes.

*See 3/3/93 I.C.O.F. results*

*Heather R. Beam*

Heather R. Beam

**CASELL TESTING, INC.**

ENVIRONMENTAL SAMPLING AND TESTING  
 10940 BEAVER DAM ROAD, HUNT VALLEY, MD 21030  
 (410) 252-7742

REPORT DATE: Dec 29, 1992

County Howard

Lab Number 92-5042

Sample Iced Yes  
 Residual Cl<sub>2</sub> <0.1 mg/L

cc: County Health Dept. Yes

**CERTIFICATE OF ANALYSIS**

Maryland State Certified Water Quality  
 Laboratory No. 115

REQUESTER: Attn: Lynn  
 Trinity Builders  
 6212 Devon Drive  
 Columbia, Maryland 21044

Property Sampled: U&O: 13814 Dayton Meadows Court

Station Sampled: Kitchen

Tax Map #:

Date/Time Sampled: Dec 28, 1992 12:25 pm

Parcel #:

Owner, Telephone No.: Brian Long

Sampler: J. Lynn #88-249M

Subdivision Name: Dayton Meadows

Lot Number: 12

Building Permit No.: 44786

Well Number: HO-81-2128

Observation: Satisfactory

**RESULTS OF ANALYSIS:**

Parameter	Result	Method	MCL	
Total Coliform	Present	ONPG-MMO MUG	Absent	Fail
Fecal Coliform	Absent			

Based upon coliform bacteriological standards, the above results indicate that at the time the sample was collected, this water sample was **UNSAFE** for drinking purposes.

12/30  
 C.B.  
 Hold for more tests

*Heather R. Beam*

Heather R. Beam

\* MCL = Maximum Contamination

**CASELL TESTING, INC.**

ENVIRONMENTAL SAMPLING AND TESTING  
 10940 BEAVER DAM ROAD, HUNT VALLEY, MD 21030  
 (410) 252-7742

REPORT DATE: Jan 7, 1993

County Howard

Lab Number 93-0045

Sample Iced Yes  
 Residual Cl<sub>2</sub> <0.1 mg/L

cc: County Health Dept. Yes

**CERTIFICATE OF ANALYSIS**

Maryland State Certified Water Quality  
 Laboratory No. 115

REQUESTER: Attn: Lynn  
 Trinity Builders  
 6212 Devon Drive  
 Columbia, Maryland 21044

Property Sampled: U&O: 13814 Dayton Meadows Court, retest #2

Station Sampled: Kitchen tap

Tax Map #:

Date/Time Sampled: Jan 6, 1993 11:10 am

Parcel #:

Owner, Telephone No.: Brian Long

Sampler: P. Kellner #92-245

Subdivision Name: Dayton Meadows

Lot Number: 12

Building Permit No.: 44786

Well Number: HO-81-2128

Observation: Satisfactory

**RESULTS OF ANALYSIS:**

Parameter	Result	Method	MCL
Total Coliform	Present	ONPG-MMO MUG	Absent
Fecal Coliform	Absent		

\*

Fail

Based upon coliform bacteriological standards, the above results indicate that at the time the sample was collected, this water sample is **UNSAFE** for drinking purposes.

X ~ Ba ~ X

*Heather R. Beam*

Heather R. Beam

\* MCL = Maximum Contamination

# HOWARD COUNTY HEALTH DEPARTMENT

JOYCE M. BOYD, M.D., M.P.H.  
COUNTY HEALTH OFFICER



Bureau of Environmental Health  
3525 Ellicott Mills Drive  
Ellicott City, Maryland 21043

Director - 461-9955  
Water & Sewerage, Permits - 461-9933  
Community Environmental Health - 461-9944  
Technical Services - 461-9955

January 14, 1993

Trinity Builders  
5212 Devon Drive  
Columbia, Maryland  
21044

RE: LOT #12 Dayton Meadows  
13814 Dayton Meadows Court  
Well tag # HO-81-2128

Dear Sir,

This is to advise you that the septic system was installed, inspected and approved on November 16, 1992.

The water sample recently submitted for testing was free of coliform and fecal coliform bacteria at the time of sampling and is bacteriologically safe for drinking.

## INTERIM CERTIFICATE OF POTABILITY

This certifies that the initial sampling requirements of COMAR 26.04.04 "Well Regulations" have been met for the water supply system installed under permit(s) HO-81-2128. No guarantee can be given for health protection beyond this date of issue. Based upon a satisfactory investigation and evaluation by the Howard County Health Department, the Department of Health and Mental Hygiene accepts this well system as required by COMAR 26.04.04.09.

This certificate may become final upon completion of the final bacteriological test which is to be taken by the county health department with six months. The well owner accepts his responsibilities under COMAR 26.04.04.10.

Data of Water Sample .

January 13, 1993

March 3, 1993

Date Well Approved

June 29, 1987

Charles B. Streaker P.S.  
Approving Authority  
Charles B. Streaker, Sanitarian  
Water and Sewerage Program

**CASSELL TESTING, INC.**

ENVIRONMENTAL SAMPLING AND TESTING  
10940 BEAVER DAM ROAD, MOUNT VALLEY, MD 21030  
(410) 252-7742

REPORT DATE: Mar 4, 1993

County Howard

Lab Number 93-0686

Sample iced Yes  
Residual Cl<sub>2</sub> <0.1 mg/L

cc: County Health Dept. Yes

**CERTIFICATE OF ANALYSIS**

Maryland State Certified Water Quality  
Laboratory No. 115

REQUESTER: Mr. Brian Long  
13814 Dayton Meadows Court  
Dayton, Maryland 21036

Property Sampled U&O: 13814 Dayton Meadows Court, retest #7

Station Sampled: Kitchen tap

Tax Map #:

Date/Time Sampled: Mar 3, 1993 1:40 pm

Parcel #:

Owner, Telephone No.: Brian Long 531-5632

Sampler: E. Hause #91-714

Subdivision Name: Dayton Meadows

Lot Number: 12

Building Permit No.: 44786

Well Number: HO-81-2128

Observation: Satisfactory

**RESULTS OF ANALYSIS:**

Parameter	Result	Method	MCL	
Total Coliform	Absent	ONPG-MMO MUG	Absent	Pass

Based upon coliform bacteriological standards, the above results indicate that at the time the sample was collected, this water sample was **SAFE** for drinking purposes.

23 MAR 1993 10:30 AM

*Heather R. Beam*

Heather R. Beam

\* MCL = Maximum Contamination



**HOWARD COUNTY HEALTH DEPARTMENT**

*Joyce M. Boyd, M.D., County Health Officer*

*Reply to: Charles Streaker  
313-2640 or 313-2641*

August 19, 1993

Mr. Brian Long  
13814 Dayton Meadows Court  
Dayton, Maryland 21036

RE: Lot 12, Dayton Meadows S/D  
13814 Dayton Meadows Court  
Well Permit #HO-81-2128

Dear Sir:

A review of our records indicates that final satisfactory water samples were not obtained at the above referenced property. You are requested to contact this office at 313-2640 to arrange for those samples to be taken. These samples are required in order to comply with Maryland Well Construction Regulation (COMAR 26.04.04.09A) (1) which states that: "A person may not put into service a well or water supply system that may be used for human consumption unless a Certificate-of-Potability has first been issued for the well by the approving authority..."

An Interim Certificate-of-Potability was issued based on one satisfactory water sample. The enclosed copy of that Interim Certificate stipulates that a second safe sample be obtained. The purpose of the second sample is to assure that the well is not vulnerable to re-contamination.

You are requested to call this office at 313-2640 to arrange an appointment for the second sample from an inside tap which is the most reliable location from which to obtain a safe sample.

Presently there is no charge for this service.

Very truly yours,

*Charles B. Streaker R.S.*  
Charles B. Streaker, R.S.  
Water and Sewerage Program

CBS:hs

Bureau of Environmental Health  
3525-H Ellicott Mills Drive Ellicott City, Maryland 21043-4544  
Water and Sewerage, Permits 313-2640 Community Environmental Health 313-2642  
Technical Services 313-2644 Director 313-2645 TDD 313-2323



**HOWARD COUNTY HEALTH DEPARTMENT**

Joyce M. Boyd, M.D., County Health Officer

August 25, 1993

Reply to:

Mr. Brian Long  
13814 Dayton Meadows Court  
Dayton, Maryland  
21036

RE: LOT #12 Dayton Meadows S/P  
13814 Dayton Meadows Court  
Well Permit No-81-2128

Dear Mr. B. Long,

This is to advise you that the septic system was installed, inspected and approved on November 18, 1992.

The water sample recently submitted for testing was free of coliform and fecal coliform bacteria at the time of sampling and is bacteriologically safe for drinking.

**FINAL CERTIFICATE OF POTABILITY**

This certifies that all sampling requirements of COMAR 26.04.04 "Well Regulations" have been met for the water supply system installed under permit(s) HO-81-2128.

August 16, 1993  
Date of Final Sampling

August 25, 1993  
Date of Acceptance  
*Charles Streaker*  
Charles Streaker R.S.  
Approving Authority  
Charles Streaker, Sanitarian  
Water and Sewerage Program

Water Sample Dates:  
March 3, 1993  
August 16, 1993

✓  
CS/

**CASSELL TESTING, INC.**  
 ENVIRONMENTAL SAMPLING AND TESTING  
 10940 BEAVER DAM ROAD, HUNT VALLEY, MD 21030  
 (410) 252-7742

REPORT DATE: Aug 17, 1993

County Howard

Lab Number 93-3918

Sample iced: Yes  
 Residual Cl<sub>2</sub> <0.1 mg/l

cc: County Health Dept. Yes

RECEIVED  
 HEALTH DEPARTMENT  
 COUNTY OF HOWARD  
 AUG 17 1993

**CERTIFICATE OF ANALYSIS**

Maryland State Certified Water Quality  
 Laboratory No. 115  
 REQUESTER: Mr. Brian Long  
 13814 Dayton Meadows Court  
 Dayton, Maryland 21036

*u40 follow up*

Property Sampled: 13814 Dayton Meadows Court

Station Sampled: Bathroom sink right side

Tax Map #:

Date/Time Sampled: Aug 16, 1993 1:15 pm

Parcel #:

Owner, Telephone No.: Long 531-5632

Sampler: E. Hause #91-714

Subdivision Name:

Lot Number:

Building Permit No.:

Well Number: HO-81-2128

Observation: Satisfactory

**RESULTS OF ANALYSIS:**

Parameter	Result	Method	MCL
Total Coliform	Absent	ONPG-MMO MUG	Absent Pass ✓

Based upon coliform bacteriological standards, the above results indicate that at the time the sample was collected, this water sample was **SAFE** for drinking purposes.

*Found later 8/25*  
*[Vis pending files C.B.]*  
*per log 8/25*  
*I.C.O.P*  
*1-14-93*  
*C.B.*  
*Sharon K. Cassell*

\* MCL = Maximum Contamination