

11/12 (3) P.C.O. C.B.S.

PERMIT

SEWAGE DISPOSAL SYSTEM

DEPARTMENT OF HEALTH AND MENTAL HYGIENE

HOWARD COUNTY HEALTH DEPARTMENT

BUREAU OF ENVIRONMENTAL HEALTH

481-9933 313-2640

P 48592

A 26619

DISTRICT 5th

DATE 10/3/92

DATE SYSTEM APPROVED 11/16/92

INSPECTOR CW Pella

INDEXED
05-40012

11/13/92 10:30
+ 12:30
No inspection
per supervisor

Paul Schissler/South Carroll Backhoe IS PERMITTED TO INSTALL ALTER

ADDRESS 4410 Salem Bottom Road, Westminster, Maryland 21157 PHONE 875-4197

SUBDIVISION Dayton Meadows LOT 12 ROAD 13814 Dayton Meadows Court

PROPERTY OWNER Trinity Builders

ADDRESS _____

SEPTIC TANK CAPACITY 1500 GALLONS

NUMBER OF BEDROOMS 5

220 SQUARE FEET PER BEDROOM

LINEAR FEET OF TRENCH REQUIRED 275

TRENCHES - Trench to be 2 feet wide. Inlet 4 1/2 feet below original grade. Bottom maximum depth 8 1/2 feet below original grade. Effective area begins at 4 1/2 feet below original grade. 4 feet of stone below distribution pipe.

LOCATION - Beginning from the left front lot corner, place 1st trench 120 feet down the left (375') lot line and 190 feet off the left line as seen when facing property from Dayton Meadows Court. Run trenches along contour towards the front (450') lot line.

NOTES - No trench to exceed 100 feet in length. Provide 6" - 8" diameter cleanout and cap to grade or above on septic tank. OK 8/26/92 RH

PLANS APPROVED BY Bert Nixon DATE 6/25/87

COVER NO WORK UNTIL INSPECTED AND APPROVED

NEITHER THE HOWARD COUNTY COUNCIL NOR THE HEALTH DEPARTMENT IS RESPONSIBLE FOR THE SUCCESSFUL OPERATION OF ANY SYSTEM

NOTE: CLEANOUT REQUIRED EVERY 70 FEET OF SEWER LINE AND/OR AT 90° SWEEPS IN LINES FROM HOUSE TO DRAIN FIELDS; 90° ELBOWS NOT ACCEPTABLE.

NOTE: ALL PARTS OF SEPTIC SYSTEMS (I.E. TANK, DISTRIBUTION BOX TRENCHES) TO BE 100 FEET FROM WELL (UNLESS OTHERWISE SPECIFICALLY AUTHORIZED)

NOTE: IF DEEP TRENCH(ES) ARE USED CALL FOR INSPECTION BEFORE AND AFTER PLACING GRAVEL IN TRENCH(ES)

NOTE: NO DRY WELL SHALL EXCEED 15 FOOT IN DIAMETER NO ABSORPTION TRENCH TO EXCEED 100 FEET IN LENGTH

NOTE: ALL PIPE FROM HOUSE TO SEPTIC TANK MUST BE CAST IRON OR SCHEDULE 35/40 PVC OR ABS

PERMIT VOID AFTER TWO YEARS

NOTE: INSTALL STAND PIPE ON SEPTIC TANK AND DRY WELL STAND PIPES MUST BE 8 INCHES IN DIAMETER CAST IRON. CONCRETE OR TERRA COTTA OR PVA OR ABS ACCEPTED. IF TOP OF SEPTIC TANK IS DEEPER THAN 3 FEET. MANHOLE TO GRADE REQUIRED.

NOTE: DISTRIBUTION BOXES MUST HAVE BAFFLES

***INSTALLER IS RESPONSIBLE FOR OBTAINING FINAL APPROVAL ON THIS PERMIT**

A
26619

HOWARD ROAD

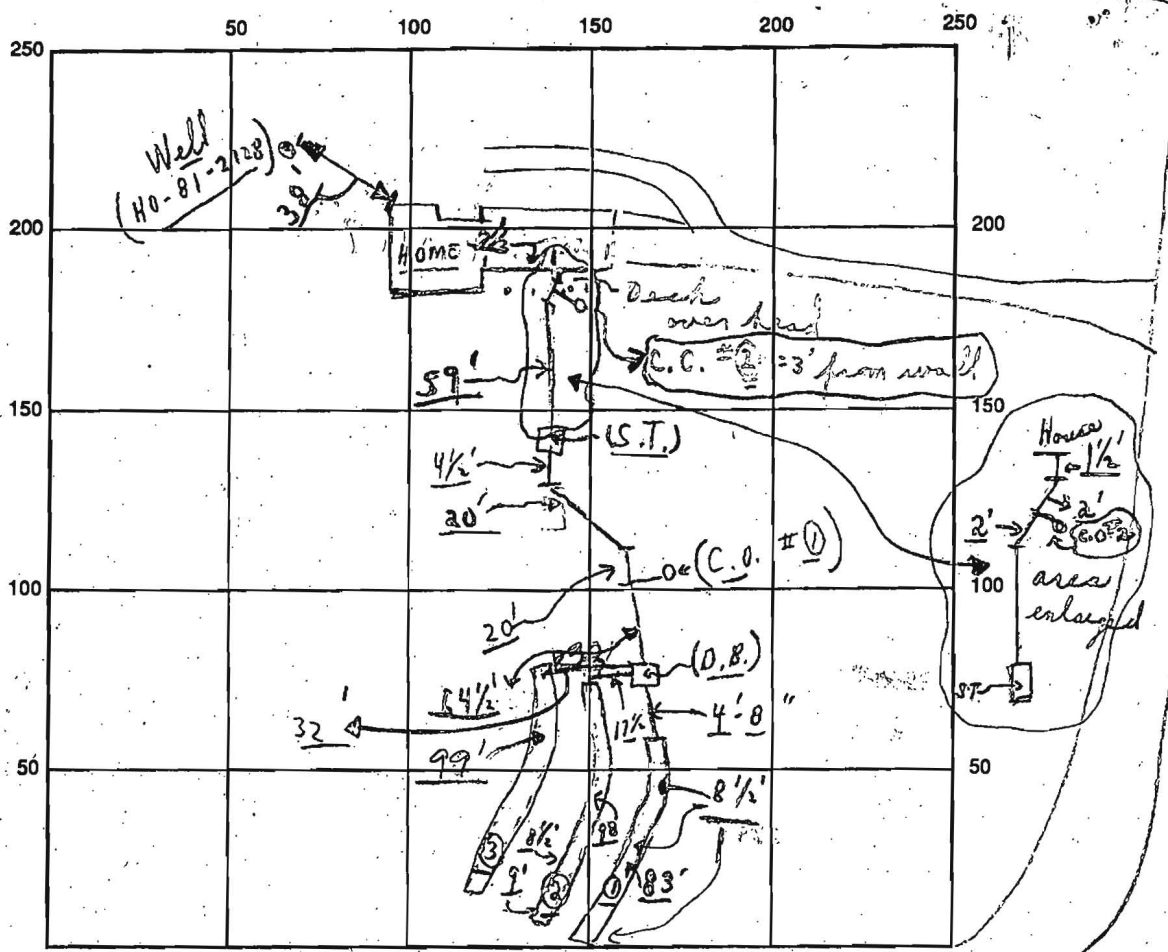

INDICATE NORTH - NAME ADJOINING ROADWAY AS BASE LINE

DAYTON MEADOWS COURT S.T. CO. #1 C.O. #2

SEPTIC TANK LEVEL OK CLEANOUTS S.T. OK CO. #1 OK C.O. #2 OK

DISTRIBUTION BOX LEVEL OK (Baffle is in)

DRAIN FIELD/TITLE DEPTH 8 1/2 FT. TRENCH WIDTH 2 FT. INLET DEPTH 4 1/2 FT.

EFFECTIVE GRAVEL DEPTH 4 + FT. TOTAL LENGTH 280 FT. (83+98+99)

NUMBER OF TRENCHES 3 ONE SIDEWALL/BOTTOM AREA 1120 SQ. FT. $\frac{280 \times 4}{1120}$

DRYWALL INSIDE DIAMETER — FT. EFFECTIVE DEPTH BELOW INLET — FT.

ABSORBENT AREA — SQ. FT.

REMARKS: 9:00 AM 11/12/92 #1 OK to continue #1 Trench as re-designed; partial Early P.M. Partial of low stones, etc. in #1 trench. C.B. ok to cover from house to dist. look only; C.B. (HOLD FOR A CALL)

11/12 LATE P.M. - #1 Trench ok to finish & cover from D. Box to #2 Trench; partial; C.B. (Need to see #3 trench & pipe to same from 2nd trench)

11/13/92 OK TO FINISH FINAL TRENCH & COVER WITHOUT INSP. C.D.

DATE SYSTEM APPROVED 11/13/92 INSPECTOR C. J. Well

I certify that trench #3 is 99 FT. long, 4 FT. + of stone from actual.