

575 Deer Hill Rd.  
(South neighbor)

4/14/89  
Info

#313727

# PERMIT

SEWAGE DISPOSAL SYSTEM

MARYLAND STATE DEPARTMENT OF HEALTH

P 43604

A 42541

DISTRICT 3rd

DATE 2/9/89

DATE SYSTEM APPROVED 4/14/89

INSPECTOR RH

HOWARD COUNTY  
BUREAU OF ENVIRONMENTAL HEALTH  
461-9933

## INDEXED

Fogle Septic Services

Arnold Backhoe & Septic Services, Inc.

IS PERMITTED TO INSTALL  ALTER

ADDRESS P.O. Box 15, Woodbine, Maryland 21797

PHONE 795-7873

SUBDIVISION Bronk Property

ROAD 575 Deer Hill Rd

LOT \_\_\_\_\_

PROPERTY OWNER Richard Nieberline

PHONE: 465-8390

ADDRESS \_\_\_\_\_

IF GARBAGE GRINDER IS USED INCREASE SEPTIC TANK CAPACITY BY 50% AND ABSORPTION AREA BY 22%.

GARBAGE GRINDER? YES \_\_\_\_\_ NO

SEPTIC TANK CAPACITY 1250 GALLONS

NUMBER OF BEDROOMS 4

TRENCHES - 210 sq. ft. per bedroom. Trench to be 3 feet wide. Inlet 3.0 feet below original grade. Bottom maximum depth 5.0 feet below original grade. Effective area begins at 3.0 feet below original grade. 2.0 feet of stone below distribution pipe.

LOCATION - Start the first trench 230 feet from the front lot line and 10 feet from the left lot line as seen when facing the lot from Deer Hill Road. Run trenches on contour toward the right lot line.

NOTE - No trench to exceed 100 feet in length. Provide 6" - 8" diameter cleanout and cap to grade or above on septic tank. OK/CG

230

PLANS APPROVED BY Sid Abel

DATE 11/14/88

COVER NO WORK UNTIL INSPECTED AND APPROVED

NEITHER THE HOWARD COUNTY COUNCIL NOR THE HEALTH DEPARTMENT IS RESPONSIBLE FOR THE SUCCESSFUL OPERATION OF ANY SYSTEM.

NOTE: CLEANOUT REQUIRED EVERY 70 FEET OF SEWER LINE AND/OR AT 90° SWEEPS IN LINES FROM HOUSE TO DRAIN FIELDS

NOTE: ALL PARTS OF SEPTIC SYSTEMS (I.E. TANK, DISTRIBUTION BOX, TRENCHES) TO BE 100 FEET FROM WELL (UNLESS OTHERWISE SPECIFICALLY AUTHORIZED)

NOTE: IF DEEP TRENCHES ARE USED CALL FOR INSPECTION BEFORE AND AFTER PLACING GRAVEL IN TRENCHES)

NOTE: NO DRY WELL SHALL EXCEED 15 FOOT IN DIAMETER NO ABSORPTION TRENCH TO EXCEED 100 FEET IN LENGTH.

NOTE: ALL PIPE FROM HOUSE TO SEPTIC TANK MUST BE CAST IRON OR SCHEDULE 40 PVC OR ABS

PERMIT VOID AFTER TWO YEARS

NOTE: INSTALL STAND PIPE ON SEPTIC TANK AND DRY WELL. STAND PIPES MUST BE 6 INCHES IN DIAMETER. CAST IRON, CONCRETE OR TERRA COTTA OR PVC OR ABS ACCEPTED. IF TOP OF SEPTIC TANK IS DEEPER THAN 3 FEET, MANHOLE TO GRADE REQUIRED

NOTE: DISTRIBUTION BOXES MUST HAVE BAFFLES

**\*INSTALLER IS RESPONSIBLE FOR OBTAINING FINAL APPROVAL ON THIS PERMIT**

\*CALL 461-9933 FOR INSPECTION OF SEPTIC SYSTEMS.

A  
42541

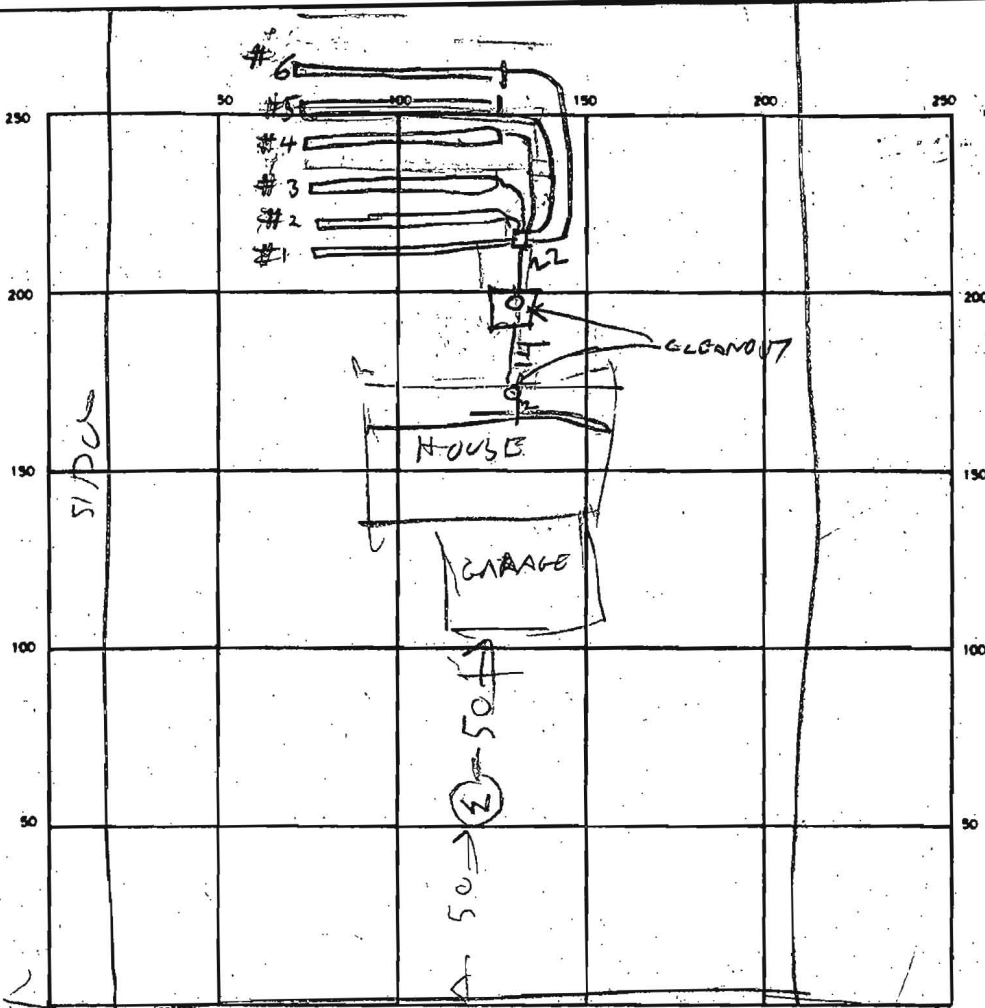

INDICATE NORTH - NAME ADJOINING ROADWAY AS BASE LINE

SEPTIC TANK LEVEL OK 1250 CLEANOUTS ST 012

DISTRIBUTION BOX LEVEL 1 012

DRAIN FIELD/TILE FIELD DEPTH 

1	2	3	4	5	6
5	5	4	4	4	4

 TRENCH WIDTH \_\_\_\_\_ FT. INLET DEPTH \_\_\_\_\_ FT.

EFFECTIVE GRAVEL DEPTH 2 FT. TOTAL LENGTH 

1	2	3	4	5	6
45	47	49	46	44	46

 276

NUMBER OF TRENCHES 6 ONE SIDEWALL/BOTTOM AREA 828 SQ. FT.

DRYWELL INSIDE DIAMETER \_\_\_\_\_ FT. EFFECTIVE DEPTH BELOW INLET \_\_\_\_\_ FT.

ABSORBENT AREA \_\_\_\_\_ SQ. FT.

REMARKS 4/14/89 - LOCATION 015

DATE SYSTEM APPROVED 4/14/89 INSPECTOR Raymond Hodge