

9-16-88  
11:30 PM  
AHP

# APPLICATION

PERCOLATION TESTING

A 42541

P \_\_\_\_\_

HOWARD COUNTY HEALTH DEPARTMENT  
BUREAU OF ENVIRONMENTAL HEALTH  
P.O. BOX 476 ELLICOTT CITY, MARYLAND 21043  
TELEPHONE: 461-9933

NO RECORD of Previous  
TEST

DISTRICT 3 RD

DATE ~~March 19, 1987~~  
Sept 8, 1988

TO: THE COUNTY HEALTH OFFICER  
ELLICOTT CITY, MARYLAND

I, HEREBY, APPLY FOR THE NECESSARY TEST IN ORDER TO CONSTRUCT (OR RECONSTRUCT) A SEWAGE DISPOSAL SYSTEM.

PROPERTY OWNER CHARLES E. BRONK ✓

ADDRESS 571 DEER HILL RD SYKESVILLE PHONE 442-5767 ✓

PROSPECTIVE BUYER \_\_\_\_\_

ADDRESS \_\_\_\_\_ PHONE \_\_\_\_\_

PROPERTY LOCATION:

SUBDIVISION \_\_\_\_\_ LOT NO. \_\_\_\_\_

ROAD AND DESCRIPTION 575 DEER HILL RD (OFF RT. 32 E. SIDE) LOT SOUTH OF  
571

TAX MAP 04 PARCEL # 18

SIZE OF LOT 72 X 423 .69 ACRES TYPE BLDG. SINGLE FAMILY  
(SINGLE FAMILY DWELLING OR COMMERCIAL)

THE SYSTEM INSTALLED UNDER THIS APPLICATION IS ACCEPTABLE ONLY UNTIL PUBLIC FACILITIES BECOME AVAILABLE. I FULLY UNDERSTAND THE FEE CONNECTED WITH THE FILING OF THIS PERC TEST APPLICATION IS NON-REFUNDABLE UNDER ANY CIRCUMSTANCES. I ALSO AGREE TO COMPLY WITH ALL M.O.S.H.A. REQUIREMENTS IN TESTING THIS LOT.

Candace P. Bronk  
(SIGNATURE OF APPLICANT)

APPROVED BY Edry Aluf FOR Standard Lunch DATE 12-2-88

REJECTED BY \_\_\_\_\_ FOR \_\_\_\_\_ DATE \_\_\_\_\_

HOLD PENDING FURTHER TESTS \_\_\_\_\_ DATE \_\_\_\_\_

REASONS FOR REJECTION OR HOLDING 9-16-88 Perce Satisfactory - Hold for Plot + Cert  
Confirmation S. Al

BUDG. PERMIT SIGNED  
AND RETURNED 12-2-88  
BP 22812 SA

## THIS IS NOT A PERMIT

① ②  
SOIL PROFILE

0  
3"  
A1-3  
Brown/  
Yellow Br  
Silty Clay  
Loam  
10%  
Frags

3-3.5  
Yellow Br  
Silt loam  
Clay content  
9-12%

5'  
Yellow Br  
Silt loam  
10% Frags

13"  
Soil Moist

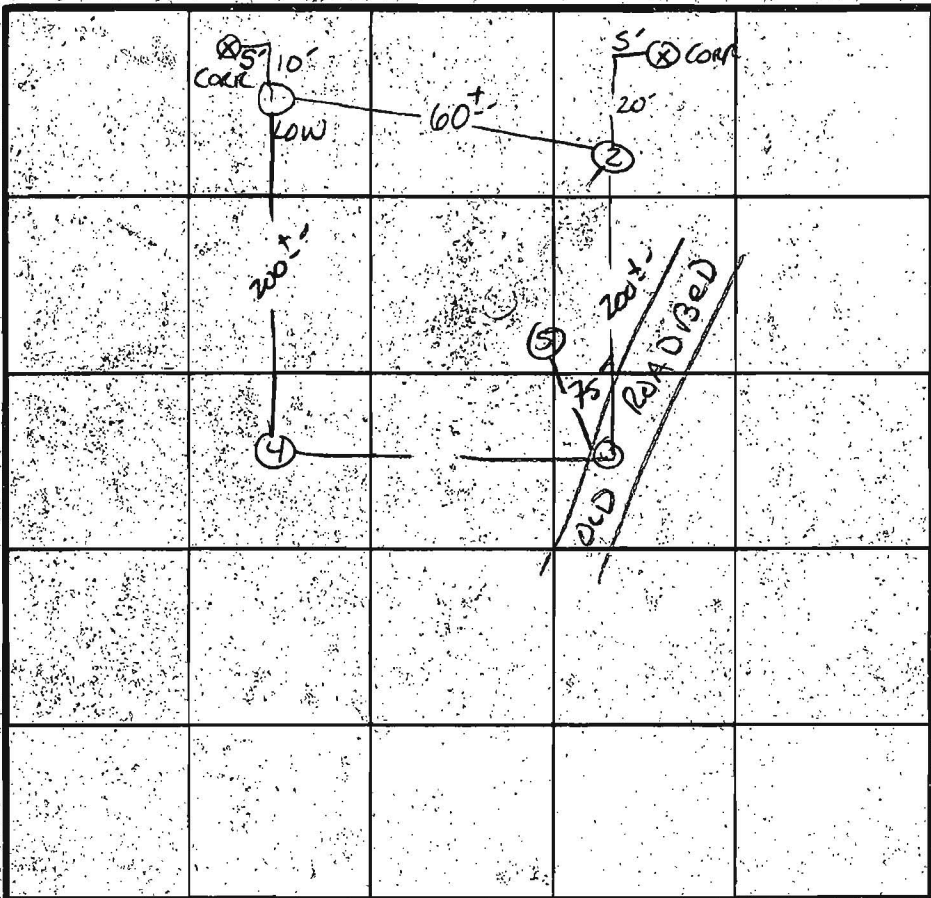

Per 10 min  
Inlet 3.0  
Bottom 5.0  
210 φ/BR

③ ④

3"  
A1-3  
Yellow Br  
clay loam  
10-12%  
Frags

2-3'  
Yellow Br  
Micaceous  
Silt sand loam  
25-30%  
Frags

10-11'  
Solid Bottom

INDICATE NORTH - NAME ADJOINING ROADWAY AS BASE LINE  
DEER HILL RD

DATE	TEST NO.	DEPTH	PRE-WET		TEST - 1" DROP		TIME
			START	STOP	START	STOP	
2/14/88	1 S	3'	2:06	2:19	2:19	2:46	27 MIN
	1 V	13.5'	Soil Pen Profile		Soil wet AT 13.5'		NO H <sub>2</sub> O
	2 S	3'	2:09	2:13	2:13	2:28	15 MIN
	2 V	13.0'	Soil Pen Profile				
	3 S	3.5'	2:49	2:50	2:50	2:52	2 MIN
	3 V	11'	Solid bottom AT 11'				
	4 S	2'	2:46	2:47	2:47	2:49	2 MIN
	4 M	6'	2:40	2:42	2:42	2:46	4 MIN
	4 V	10'	Solid bottom - see Profile				
	5 V	12'	similar to # 1 & 2		w/ no clay below 30"		

REMARKS LOT COR. FOUND / SHALLOW SYST ONLY

TYPE OF SOIL \_\_\_\_\_

TESTED BY S. Pbal ALSO PRESENT Mrs. BRONK Skip, Woody

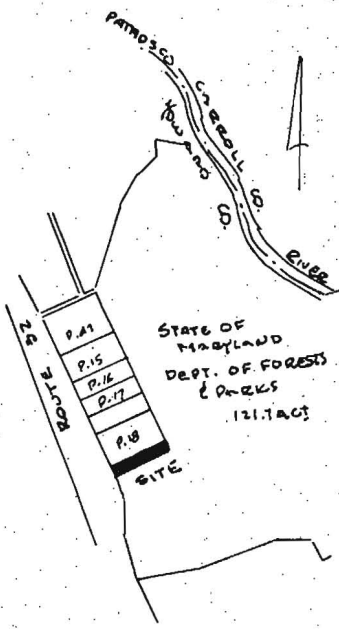

TAXMAP A PARCEL 2C

45  
47  
48  
46  
44  
46  
-----  
276  
3  
28

210  
890

STATE OF MARYLAND  
DEPT. OF FORESTS  
& PARKS  
121.7AC

DEPT. OF PARKS  
121.7AC

L 514 F.464

PARCEL No. 2 L 514 F.464  
3RD ELECTION DISTRICT  
HOWARD CO. MD  
SCALE 1" = 30' DEC. 1, 1988

DISTR. BOX  
EXISTING 455 ✓  
INVERT 455 ✓ 4520 ✓  
TANK  
EXISTING 460 ✓  
INVERT OUT 455 ✓  
INVERT IN 455 ✓  
IN. @ HOUSE = 456 ✓ + 25' ✓  
BASE = 460.00 ✓  
FF = 460.00 ✓  
GAR = 467.7 ✓

BUDG. PERMIT SIGNED  
AND RETURNED 12-2-88  
BP 22812  
[Signature]

DEER HILL ROAD