

PERMIT

SEWAGE DISPOSAL SYSTEM

DEPARTMENT OF HEALTH AND MENTAL HYGIENE

04-361210

P 510682

A 58125-C

DISTRICT _____

DATE 9-14-98

HOWARD COUNTY HEALTH DEPARTMENT
BUREAU OF ENVIRONMENTAL HEALTH
~~X166088~~ 410-313-2640

DATE SYSTEM APPROVED 10/22/98

INSPECTOR Km

INDEXED

Jack Fyock Septic Services IS PERMITTED TO INSTALL ALTER _____

ADDRESS P.O. Box 89 Triadelphia Road Glenelg, MD 21737 PHONE (410) 988-9270

SUBDIVISION Clarks Woods II LOT 1 ROAD 14397 Dorsey Mill Road

PROPERTY OWNER Gurian

ADDRESS _____

**BUILDING PERMIT SIGNED
AND RETURNED**

SEPTIC TANK CAPACITY 1250 GALLONS

NUMBER OF BEDROOMS 4

4-19-03 BOD 141294-DECK W/GAZEBO

180 SQUARE FEET PER BEDROOM

LINEAR FEET OF TRENCH REQUIRED 180

TRENCHES - Trench to be 2 feet wide. Inlet 3 feet below original grade. Bottom maximum depth 7 feet below original grade. Effective area begins at 3 feet below original grade. 4 feet of stone below distribution pipe.

LOCATION - Place the distribution box 70 feet off the 214.49' lot line and 60 feet off the 216.37' lot line as seen when facing the lot from pipestem off Dorsey Mill Road. Run trenches along contour towards the 216.37' lot line.

NOTES - No trench to exceed 100 feet in length. Provide 6" - 8" diameter cleanout and cap to grade or above on septic tank. 10/15/98 OKAM

PLANS APPROVED BY Donna K. Soe DATE 10/15/98

COVER NO WORK UNTIL INSPECTED AND APPROVED

NEITHER THE HOWARD COUNTY COUNCIL NOR THE HEALTH DEPARTMENT IS RESPONSIBLE FOR THE SUCCESSFUL OPERATION OF ANY SYSTEM

NOTE: CLEANOUT REQUIRED EVERY 70 FEET OF SEWER LINE AND/OR AT 90° SWEEPS IN LINES FROM HOUSE TO DRAIN FIELDS, 90° ELBOWS NOT ACCEPTABLE.

NOTE: ALL PARTS OF SEPTIC SYSTEMS (I.E. TANK, DISTRIBUTION BOX TRENCHES) TO BE 100 FEET FROM WELL (UNLESS OTHERWISE SPECIFICALLY AUTHORIZED)

NOTE: IF DEEP TRENCH(ES) ARE USED CALL FOR INSPECTION BEFORE AND AFTER PLACING GRAVEL IN TRENCH(ES)

NOTE: NO DRY WELL SHALL EXCEED 15 FOOT IN DIAMETER NO ABSORPTION TRENCH TO EXCEED 100 FEET IN LENGTH

NOTE: ALL PIPE FROM HOUSE TO SEPTIC TANK MUST BE CAST IRON OR SCHEDULE 35/40 PVC OR ABS

PERMIT VOID AFTER TWO YEARS

NOTE: INSTALL STAND PIPE ON SEPTIC TANK AND DRY WELL STAND PIPES MUST BE 6 INCHES IN DIAMETER CAST IRON, CONCRETE OR TERRA COTTA OR PVA OR ABS ACCEPTED. IF TOP OF SEPTIC TANK IS DEEPER THAN 3 FEET, MANHOLE TO GRADE REQUIRED.

NOTE: DISTRIBUTION BOXES MUST HAVE BAFFLES

*INSTALLER IS RESPONSIBLE FOR OBTAINING FINAL APPROVAL ON THIS PERMIT

*CALL 481-9933 FOR INSPECTION OF SEPTIC SYSTEM.

58125-C

10/22/98
125-00
10/25/98
WPI
ASAP

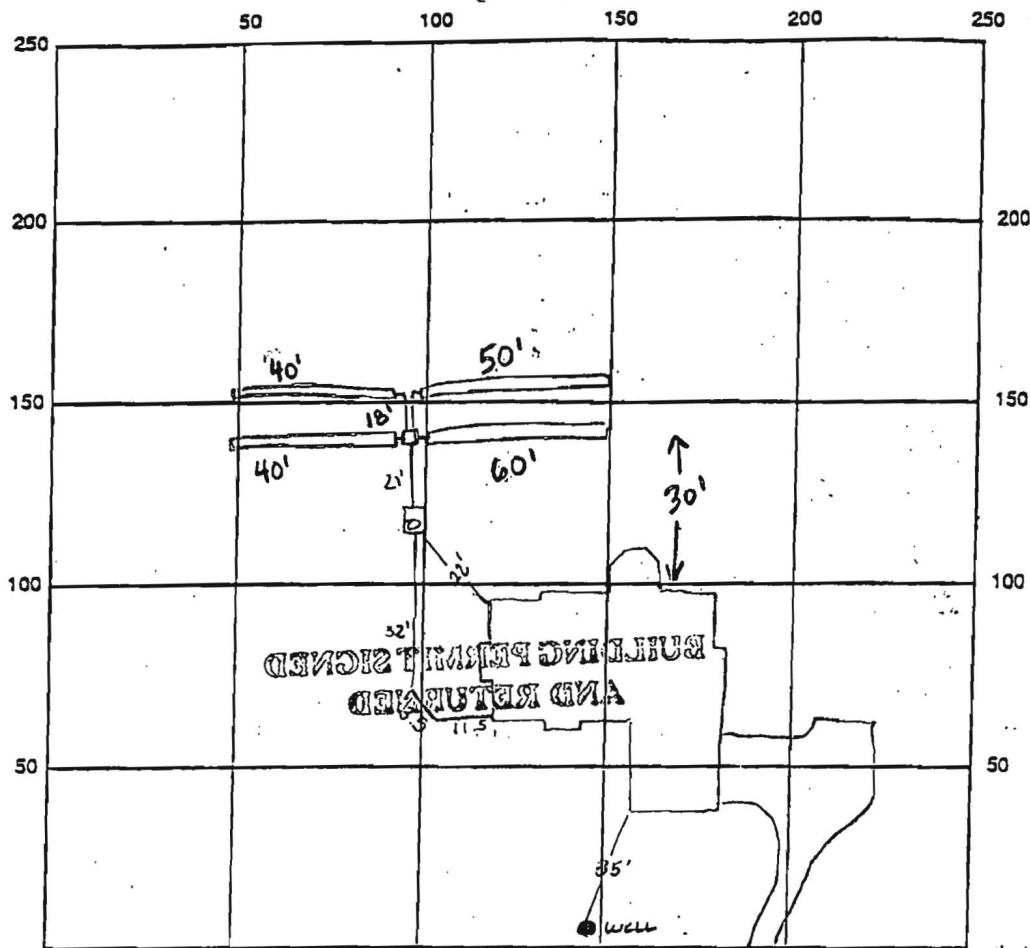

INDICATE NORTH - NAME ADJOINING ROADWAY AS BASE LINE Dorscy Mill Rd

SEPTIC TANK LEVEL OK 1250 gal CLEANOUTS OK

DISTRIBUTION BOX LEVEL OK

DRAIN FIELD/TITLE DEPTH 7 FT. TRENCH WIDTH 2 FT. INLET DEPTH 3 FT.

EFFECTIVE GRAVEL DEPTH 4 FT. TOTAL LENGTH 490 FT.

NUMBER OF TRENCHES 4 ONE SIDEWALL/BOTTOM AREA 760 SQ. FT.

DRYWALL INSIDE DIAMETER FT. EFFECTIVE DEPTH BELOW INLET FT.

ABSORBENT AREA SQ. FT.

REMARKS: 10/22/98 OK to cover house to DB - no house connection -

OK to stone & cover trenches, leave ends open &e

10/22/98 (pm) OK to cover all work, has house connection (Kim)

DATE SYSTEM APPROVED 10/22/98

INSPECTOR Kim Maiste

