

Bureau of Environmental Health
 8930 Stanford Boulevard, Columbia, MD 21045
 Main: 410-313-2640 | Fax: 410-313-2648
 TDD 410-313-2323 | Toll Free 1-866-313-6300
www.hchealth.org
 Facebook: www.facebook.com/hocohealth

Maura J. Rossman, M.D., Health Officer

RECEIPT DATE: 10/15/15 **ONSITE SEWAGE DISPOSAL SYSTEM** P 557412
 INSTALLATION APPROVAL DATE: 12-9-15 **PERMIT** A _____
SEWER HOUSE CONNECTION

PROPERTY ADDRESS: 12149 Hayland Farm Way
 SUBDIVISION: Walnut Creek LOT: 54 TAX ID: 05-595195
 CONTRACTOR: Craftmark Homes Inc. EMAIL: jpavlik@craftmarkhomes.com
 CONTRACTOR ADDRESS: 1355 Beverly Road Suite 300, McClean VA, 22101 PHONE: _____
 PROPERTY OWNER: W Creek LC EMAIL: _____
 OWNER ADDRESS: 1355 Beverly Road, McClean VA, 22101 PHONE: _____

NUMBER OF BEDROOMS: 4 CONNECTED TO PUBLIC WATER: YES NO

LOCATION:	INSTALL 4" SEWER LINE PER APPROVED SITE PLAN.
NOTES:	Install cleanouts at bends in SHC and at connection of SHC to grinder pit. Install sleeve on SHC under driveway.

ISSUED BY: Hank Oswald ^{OK}  ISSUE DATE: 10/15/15 EXPIRATION DATE: 10/15/16

- NOTE: HOWARD COUNTY BUREAU OF UTILITIES APPROVAL OF GRINDER PUMP INSTALLATION IS REQUIRED PRIOR TO SEPTIC PERMIT APPROVAL
- NOTE: CONTRACTOR MUST SCHEDULE AN INSPECTION AND GAIN APPROVAL OF ALL COMPONENTS PRIOR TO COVERING
- NOTE: AN ELECTRICAL PERMIT IS REQUIRED FOR INSTALLATION OF ANY ELECTRICAL COMPONENTS OF THE SYSTEM

NEITHER THE HOWARD COUNTY COUNCIL NOR THE HEALTH DEPARTMENT IS RESPONSIBLE FOR THE SUCCESSFUL OPERATION OF ANY SYSTEM. PERMITTEE RESPONSIBLE FOR OBTAINING FINAL APPROVAL ON THIS PERMIT. CALL 410-313-1771 FOR INSPECTION OF SEPTIC SYSTEM.

1" = 30'

NOT TO SCALE

Hayland Farm Way

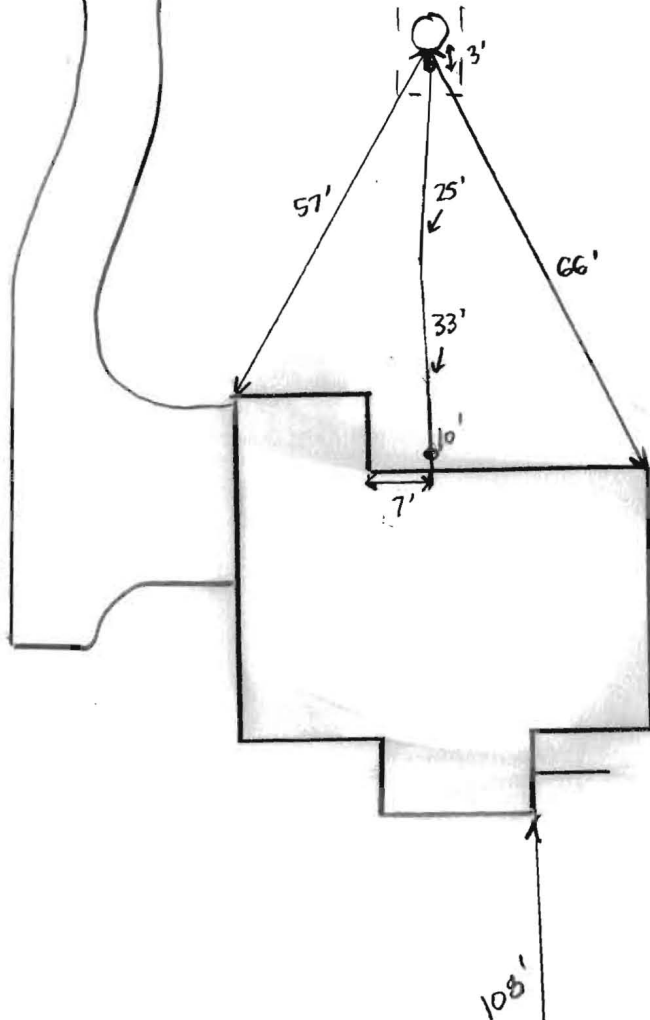

ROAD NAME

TRENCH/DRAINFIELD DATA		
WIDTH	INLET	BOTTOM
_____	_____	_____
NUMBER OF TRENCHES _____		
TOTAL LENGTH _____		
ABSORPTION AREA _____		
DISTRIBUTION BOX LEVEL _____		
DISTRIBUTION BOX BAFFLE _____		
DISTRIBUTION BOX PORT _____		

SEPTIC TANK DATA	
SEPTIC TANK I LEVEL _____	
MANUFACTURER	_____
CAPACITY	_____ GAL
SEAM LOC	_____
TANK LID DEPTH	_____
BAFFLES	_____
BAFFLE FILTER	_____
MANHOLE LOC	_____
6" PORT LOC	_____
WATERTIGHT TEST	_____
SLOTTED	_____
DATE ON LID	_____
PUMP/SEPTIC TANK LEVEL _____	
MANUFACTURER	_____
CAPACITY	_____ GAL
SEAM LOC	_____
TANK LID DEPTH	_____
BAFFLES	_____
BAFFLE FILTER	_____
MANHOLE LOC	_____
6" PORT LOC	_____
WATERTIGHT TEST	_____
SLOTTED	_____
DATE ON LID	_____

PRE-CONSTRUCTION:

INSTALLATION:

H0-95-2372

10/16/15 Not quite under way. Only 10' of sch 40 installed. Told contractor to verify inverts to make gravity. Very close. (Kaw)

10/21/15 Sewer house connection complete. Line bedded with #57 stone. Contractor verified 1 1/2 fall of line. Need approval from Bureau of Utilities for grinder pump startup. (SC)

FINAL INSPECTOR _____ DATE OF APPROVAL 12-9-15

Martin, Sharhonda

From: Baucom, Scott
Sent: Wednesday, December 09, 2015 7:23 AM
To: Harris, Leslie; Wolf, Kevin
Cc: Hart, Amy; Rocco, Anthony; Tuder, Matt; Baker, Brian; Martin, Sharhonda; Williams, Jeffrey; Bozzell, Duane; Bernard, Dana
Subject: U&O Release 12149 Hayland Farm Way

On the morning of December 8th, Duane Bozzell observed the start-up of a Sewage Grinder Pump at the Walnut Creek Shared Septic System:

Craftmark Homes
Walnut Creek, Lot #54
Contract 4530
12149 Hayland Farm Way
Ellicott City, MD 21042

The Sewage Grinder Pump test was successful ; the Bureau of Utilities releases its hold on this property for U&O.

Scott Baucom
Operations Supervisor I
Howard County DPW, Bureau of Utilities
8270 Old Montgomery Rd.
Columbia, MD 21045
Office (410) 313-4975
FAX (410) 313-4989

