

4/5/94  
3 PM 024P 02

# PERMIT ✓

## SEWAGE DISPOSAL SYSTEM

### DEPARTMENT OF HEALTH AND MENTAL HYGIENE

03-290808

#### HOWARD COUNTY HEALTH DEPARTMENT

BUREAU OF ENVIRONMENTAL HEALTH

~~461-9933~~ 313-2640

INDEXED

P 49973L

A REPAIR

DISTRICT \_\_\_\_\_

DATE 4/19/94

DATE SYSTEM APPROVED 4/5/94

INSPECTOR DKS/CBS

Jack Fyock Septic Service IS PERMITTED TO INSTALL \_\_\_\_\_ ALTER

ADDRESS \_\_\_\_\_ PHONE 988-9270

SUBDIVISION \_\_\_\_\_ LOT \_\_\_\_\_ ROAD 12440 Frederick Road

PROPERTY OWNER Mathis

12440 Frederick Road

ADDRESS \_\_\_\_\_

SEPTIC TANK CAPACITY \_\_\_\_\_ GALLONS

NUMBER OF BEDROOMS 3

\_\_\_\_\_ SQUARE FEET PER BEDROOM

LINEAR FEET OF TRENCH REQUIRED \_\_\_\_\_

REPAIR - PURPOSE - SEPTIC SYSTEM HAS FAILED.

Call for inspection when ground is opened so sanitarian can recommend repair. 04/05/94

PLANS APPROVED BY \_\_\_\_\_ DATE \_\_\_\_\_

COVER NO WORK UNTIL INSPECTED AND APPROVED

NEITHER THE HOWARD COUNTY COUNCIL NOR THE HEALTH DEPARTMENT IS RESPONSIBLE FOR THE SUCCESSFUL OPERATION OF ANY SYSTEM

NOTE: CLEANOUT REQUIRED EVERY 70 FEET OF SEWER LINE AND/OR AT 90° SWEEPS IN LINES FROM HOUSE TO DRAIN FIELDS, 90° ELBOWS NOT ACCEPTABLE.

NOTE: ALL PARTS OF SEPTIC SYSTEMS (I.E. TANK, DISTRIBUTION BOX TRENCHES) TO BE 100 FEET FROM WELL (UNLESS OTHERWISE SPECIFICALLY AUTHORIZED)

NOTE: IF DEEP TRENCH(ES) ARE USED CALL FOR INSPECTION BEFORE AND AFTER PLACING GRAVEL IN TRENCH(ES)

NOTE: NO DRY WELL SHALL EXCEED 15 FOOT IN DIAMETER NO ABSORPTION TRENCH TO EXCEED 100 FEET IN LENGTH

NOTE: ALL PIPE FROM HOUSE TO SEPTIC TANK MUST BE CAST IRON OR SCHEDULE 35/40 PVC OR ABS

PERMIT VOID AFTER TWO YEARS

NOTE: INSTALL STAND PIPE ON SEPTIC TANK AND DRY WELL STAND PIPES MUST BE 6 INCHES IN DIAMETER CAST IRON, CONCRETE OR TERRA COTTA OR PVA OR ABS ACCEPTED. IF TOP OF SEPTIC TANK IS DEEPER THAN 3 FEET. MANHOLE TO GRADE REQUIRED.

NOTE: DISTRIBUTION BOXES MUST HAVE BAFFLES

**\*INSTALLER IS RESPONSIBLE FOR OBTAINING FINAL APPROVAL ON THIS PERMIT**

A 49973L

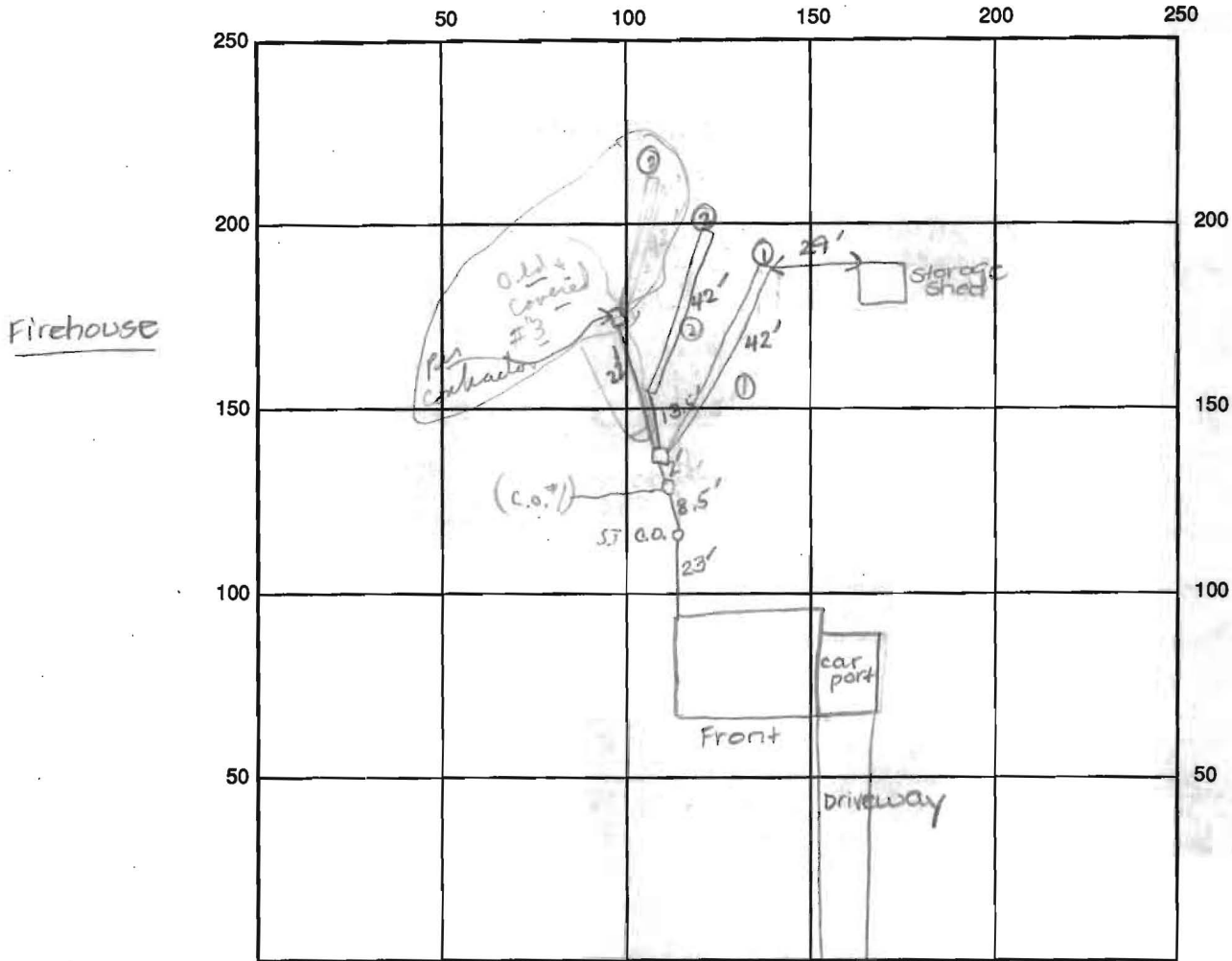

INDICATE NORTH - NAME ADJOINING ROADWAY AS BASE LINE  
 Frederick Rd. (Rte. 144)

SEPTIC TANK LEVEL Existing CLEANOUTS Septic tank OK, c.o. ① OK

DISTRIBUTION BOX LEVEL OK - baffle in

DRAIN FIELD/TITLE DEPTH 10.5 FT. TRENCH WIDTH 2 FT. INLET DEPTH 4/5 FT.

EFFECTIVE GRAVEL DEPTH 6 FT. TOTAL LENGTH 84 New FT.

NUMBER OF TRENCHES 2 ONE SIDEWALL/BOTTOM AREA 504<sup>+</sup> SQ. FT.

DRYWALL INSIDE DIAMETER — FT. EFFECTIVE DEPTH BELOW INLET — FT.

ABSORBENT AREA 504 SQ. FT. +(old system)

REMARKS: 4/5/94 saw line from septic tank to distribution box  
and two new trenches ① and ②. OK to cover as  
finish material (on site) trench caving in places. DKS

water well per owner on other lot. DKS

DATE SYSTEM APPROVED 4/5/94 INSPECTOR DKS/CBS