

# APPLICATION

SEWAGE DISPOSAL TESTING

STATE OF MARYLAND - DEPARTMENT OF HEALTH AND MENTAL HYGIENE

HOWARD COUNTY HEALTH DEPARTMENT  
ENVIRONMENTAL HEALTH SERVICES

P. O. BOX 476, ELLICOTT CITY, MARYLAND 21043  
TELEPHONE: 992-2330

A 36348

P \_\_\_\_\_

DISTRICT \_\_\_\_\_

DATE 12/20/85

TO: THE COUNTY HEALTH OFFICER  
ELLICOTT CITY, MARYLAND

I HEREBY APPLY FOR THE NECESSARY TEST IN ORDER TO CONSTRUCT (OR RECONSTRUCT) A SEWAGE DISPOSAL SYSTEM.

PROPERTY OWNER MARC WOOD HOMES LTD

ADDRESS 4008 HERITAGE HILL LANE PHONE 531-2071

PROPERTY LOCATION:

SUBDIVISION CAMERON TRACT LOT NO. 5

ROAD AND DESCRIPTION CAMERON COURT + FOLLY QUARTER

SIZE OF LOT 3 TYPE BLDG. RESIDENTIAL  
(NUMBER OF BEDROOMS)

THE SYSTEM INSTALLED UNDER THIS APPLICATION IS ACCEPTABLE ONLY UNTIL PUBLIC FACILITIES BECOME AVAILABLE. I FULLY UNDERSTAND THE  
FEE CONNECTED WITH THE FILING OF THIS PERC TEST APPLICATION IS NON-REFUNDABLE UNDER ANY CIRCUMSTANCES. I ALSO AGREE TO COMPLY  
WITH ALL M.O.S.H.A. REQUIREMENTS IN TESTING THIS LOT. Ron Marc Rusdort  
(SIGNATURE OF APPLICANT)

APPROVED BY \_\_\_\_\_ FOR \_\_\_\_\_ DATE \_\_\_\_\_

REJECTED BY \_\_\_\_\_ FOR \_\_\_\_\_ DATE \_\_\_\_\_

HOLD PENDING FURTHER TESTS \_\_\_\_\_ DATE \_\_\_\_\_

REASONS FOR REJECTION OR HOLDING \_\_\_\_\_

## THIS IS NOT A PERMIT

10

## SOIL PROFILE

Red/brown  
clay loam  
4 1/2'  
Fine/med  
grain to  
brown  
micaceous  
loam  
Uniform  
to bottom  
12' bottom

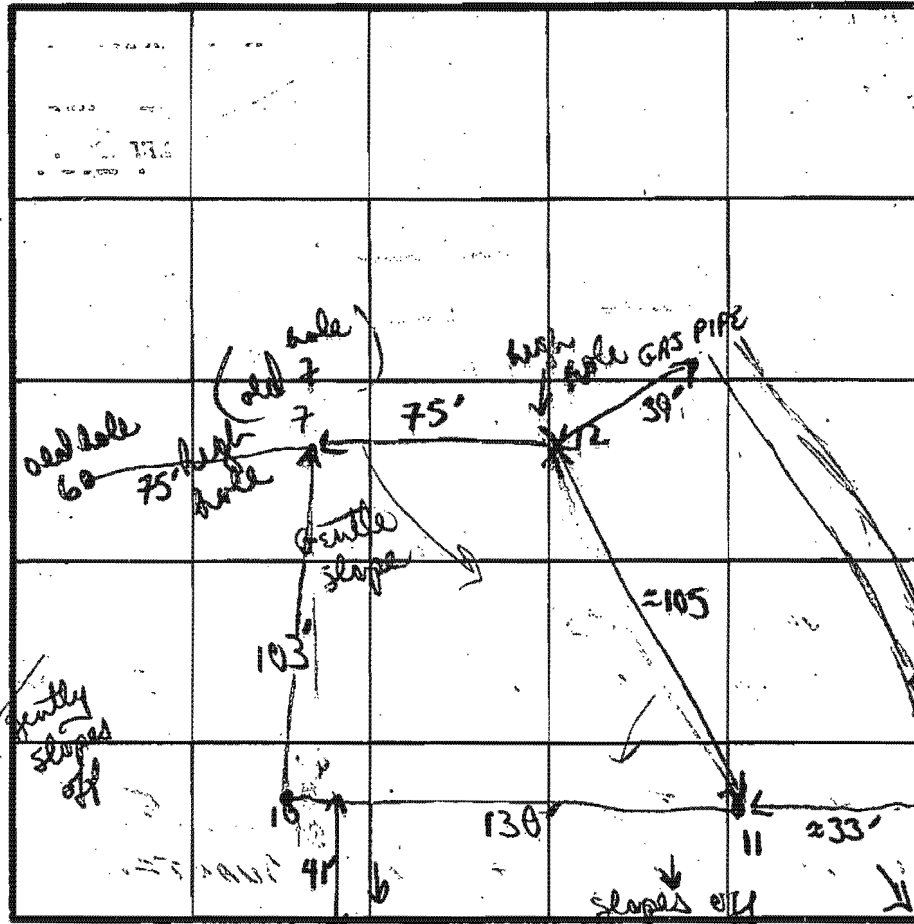

11  
tan brown  
powdery loam  
multiple layers  
of 1 type of  
soil  
heavy micaceous  
soil  
7 white soft  
clumps (quartz?)  
type soil w/ mica  
10 micaceous  
soil brown  
loam  
12'

INDICATE NORTH - NAME ADJOINING ROADWAY AS BASE LINE.  
CAMERON CT.

7 Perc  
10 min  
Inlet 4  
Bottom 8

DATE	TEST NO.	DEPTH	PRE-WET		TEST - 1" DROP		TIME
			START	STOP	START	STOP	
12/86	10	3 1/2'	116	119	119	122	3 min
		12'	uniform below clay layer to bottom				
	11	2 1/2'	126	129	129	134	5 min
		17'	138	141	141	144	3 min
		12'	bottom (see soil profile)				
	12	VISUAL					
		12'	bottom uniform				

12  
tan brown  
clay loam  
3 1/2'  
generally  
uniform fine  
tan powdery  
sandy  
loam  
(1 small patch  
of white mica  
soil at 10')

EH-12-1079

REMARKS

TYPE OF SOIL

TESTED BY

soil mixed bag loamy soil with lots of mica  
all perc times good

B. Nyren

ALSO PRESENT

Jack, Ron Marc