

LAYOUT 8/21/2009 INSP 4 _____
INSP 2 8/24/09 INSP 5 _____
INSP 3 _____ INSP 6 _____

ISSUE DATE: 8/24/2009

PERMIT - Repair

P 531876

APPROVAL DATE: 8/24/09

A Repair

Tax ID #05377161

**ON-SITE SEWAGE DISPOSAL SYSTEM
HOWARD COUNTY HEALTH DEPARTMENT
BUREAU OF ENVIRONMENTAL HEALTH**

JM Contracting IS PERMITTED TO INSTALL ALTER

ADDRESS: Sykesville, MD 21784 PHONE NUMBER: 443-277-7526

SUBDIVISION: _____ LOT NUMBER: _____

ADDRESS: 7344 Hopkin's Way PROPERTY OWNER: Sharon L. Pratt

SEPTIC TANK CAPACITY (GALLONS): Ex. OUTLET BAFFLE FILTER REQUIRED

PUMP CHAMBER CAPACITY (GALLONS): N/A COMPARTMENTED TANK REQUIRED

NUMBER OF BEDROOMS: 4 APPLICATION RATE: 1.2

SQUARE FOOTAGE OF HOUSE: N/A

LINEAR FEET OF TRENCH REQUIRED: 112 APPROX. STONE AMT. 69 Ton

TRENCHES:	Trenches to be 2 feet wide. Inlet 3 feet below original grade. Bottom maximum depth 8 feet below grade. Effective area begins at 4 feet below original grade. 5 feet of stone below distribution pipe.
LOCATION:	Install a 50' trench and a 70' trench as specified in field at time of repair perc. Trenches will maintain 100' separation from ex. dug well next to dwelling.
NOTES:	Manhole access needs to be installed on the tank along with a new outlet baffle. Pump and collapse ex. dry well. Observation pipes required at ends of trenches. Future repair system install just below this permit system. Sidewall may be increased for max. adsorption

PLANS APPROVED: Kevin Wolf DATE: 8/21/2009

- NOTE: PERMIT VOID AFTER 2 YEARS
- NOTE: CONTRACTOR RESPONSIBLE FOR SCHEDULING A PRE-CONSTRUCTION INSPECTION FOR ALL INSTALLATIONS
- NOTE: WATERTIGHT SEPTIC TANKS REQUIRED
- NOTE: ALL PARTS OF SEPTIC SYSTEM SHALL BE 100 FEET FROM ANY WATER WELL
- NOTE: MANHOLE RISERS REQUIRED ON ALL SEPTIC TANKS AND PUMP CHAMBERS

**NEITHER THE HOWARD COUNTY COUNCIL OR THE HEALTH DEPARTMENT IS
RESPONSIBLE FOR THE SUCCESSFUL OPERATION OF ANY SYSTEM
PERMITTEE RESPONSIBLE FOR OBTAINING FINAL APPROVAL ON THIS PERMIT
CALL 410-313-1771 FOR INSPECTION OF SEPTIC SYSTEM**

NOT TO SCALE

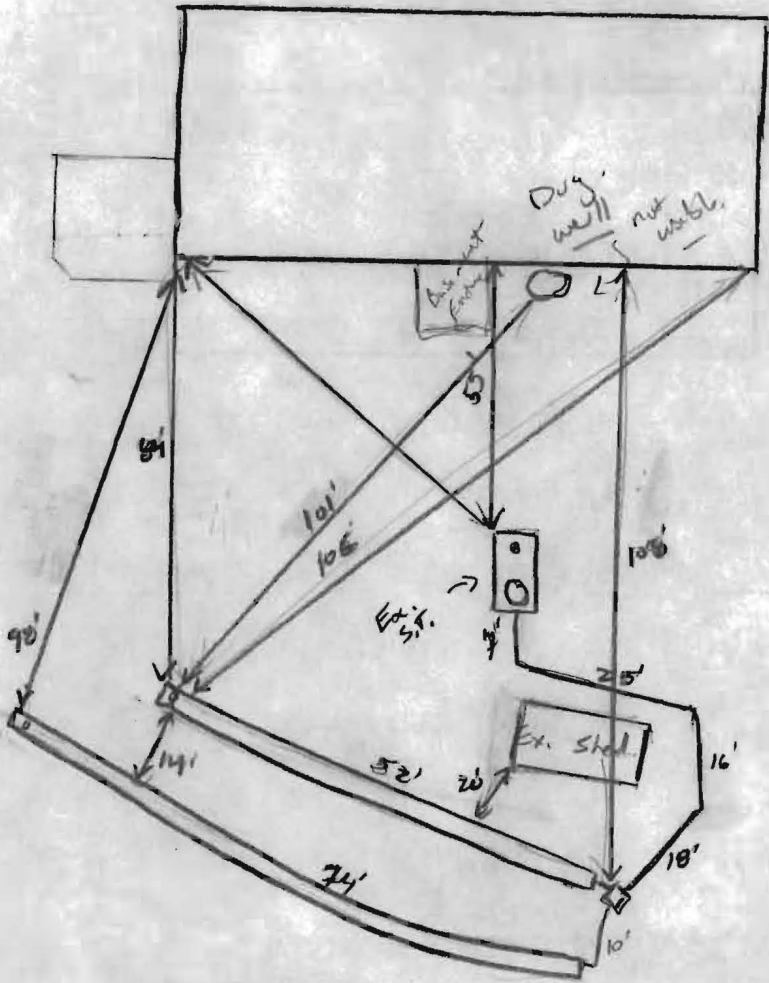

ROAD NAME

TRENCH/DRAINFIELD DATA

WIDTH 2' INLET 3 BOTTOM 8'
 NUMBER OF TRENCHES ~~#~~ 2
 TOTAL LENGTH 120'
 ABSORPTION AREA 240'±sw
 DISTRIBUTION BOX LEVEL Levelers
 DISTRIBUTION BOX BAFFLE Yes
 DISTRIBUTION BOX PORT No

SEPTIC TANK DATA

SEPTIC TANK I LEVEL Existing
 MANUFACTURER ?
 CAPACITY 1250? GAL
 SEAM LOC mid
 TANK LID DEPTH 1.5'
 BAFFLES Rear (new)
 BAFFLE FILTER no
 MANHOLE LOC Rear
 6" PORT LOC Front
 WATERTIGHT TEST no
 SLOTTED no
 DATE ON LID no

PUMP/SEPTIC TANK LEVEL

MANUFACTURER _____
 CAPACITY _____ GAL
 SEAM LOC _____
 TANK LID DEPTH _____
 BAFFLES _____
 BAFFLE FILTER _____
 MANHOLE LOC _____
 6" PORT LOC _____
 WATERTIGHT TEST _____
 SLOTTED _____
 DATE ON LID _____

PRE-CONSTRUCTION:

8/21/09 Install a 50' trench and a 70' trench as pointed out in field. Maintain 100' from ex. well. System designed for max. sidewall absorption. Future report will be below new trenches. (K)

INSTALLATION:

8/24/09 System installed per manufacturer. Bottom trench installed a little off center do work around some large stumps. OK to back fill (K)

FINAL INSPECTOR

[Signature]

DATE OF APPROVAL

8/24/09