

8/3/87  
11:12 AM

# PERMIT

SEWAGE DISPOSAL SYSTEM

MARYLAND STATE DEPARTMENT OF HEALTH

HOWARD COUNTY  
BUREAU OF ENVIRONMENTAL HEALTH  
461-9933

04313976

INDEXED

P 39731

A REPAIR

DISTRICT \_\_\_\_\_

DATE 7/27/87

DATE SYSTEM APPROVED 8/4/87

INSPECTOR Candler

Tom Nicholes

IS PERMITTED TO INSTALL \_\_\_\_\_ ALTER X

ADDRESS 3804 Jim Smith Lane, New Windsor, MD 21776 PHONE 635-2646

SUBDIVISION \_\_\_\_\_ ROAD 631 Peetz Road LOT \_\_\_\_\_

PROPERTY OWNER Ms. Sandy Shane

ADDRESS \_\_\_\_\_

IF GARBAGE GRINDER IS USED INCREASE SEPTIC TANK CAPACITY BY 50% AND ABSORPTION AREA BY 22%.

GARBAGE GRINDER? YES \_\_\_\_\_ NO \_\_\_\_\_

SEPTIC TANK CAPACITY 1000 GALLONS NUMBER OF BEDROOMS 3

REPAIR - CALL FOR INSPECTION WHEN GROUND IS OPENED UP SO SANITARIAN CAN RECOMMEND REPAIR.

ADDITION WILL BE NO CLOSER TO WELL THAN EXISTING STRUCTURE.

NO CAPACITY ADDED -

VIS INSP TO CONFIRM WORKING CONDITION & SUFFICIENT

REPAIR AREA TO SUPPORT ADDITION TO HOUSE,

PLANS APPROVED BY C. Williams DATE 7/27/87

COVER NO WORK UNTIL INSPECTED AND APPROVED.

NEITHER THE HOWARD COUNTY COUNCIL NOR THE HEALTH DEPARTMENT IS RESPONSIBLE FOR THE SUCCESSFUL OPERATION OF ANY SYSTEM.

NOTE: CLEANOUT REQUIRED EVERY 70 FEET OF SEWER LINE AND/OR AT 90° SWEEPS IN LINES FROM HOUSE TO DRAIN FIELDS.

NOTE: ALL PARTS OF SEPTIC SYSTEMS (I.E., TANK, DISTRIBUTION BOX, TRENCHES) TO BE 100 FEET FROM WELL (UNLESS OTHERWISE SPECIFICALLY AUTHORIZED)

NOTE: IF DEEP TRENCH(IES) ARE USED CALL FOR INSPECTION BEFORE AND AFTER PLACING GRAVEL IN TRENCH(IES).

NOTE: NO DRY WELL SHALL EXCEED 15 FOOT IN DIAMETER. NO ABSORPTION TRENCH TO EXCEED 100 FEET IN LENGTH.

NOTE: ALL PIPE FROM HOUSE TO SEPTIC TANK MUST BE CAST IRON OR SCHEDULE 40 PVC OR ABS.

PERMIT VOID AFTER TWO YEARS.

NOTE: INSTALL STAND PIPE ON SEPTIC TANK AND DRY WELL. STAND PIPES MUST BE 6 INCHES IN DIAMETER. CAST IRON, CONCRETE OR TERRA COTTA OR PVC OR ABS ACCEPTED. IF TOP OF SEPTIC TANK IS DEEPER THAN 3 FEET MANHOLE TO GRADE REQUIRED.

NOTE: DISTRIBUTION BOXES MUST HAVE BAFFLES.

BLDG. PERMIT SIGNED

AND RETURNED 9/22/87

Serial # 14174

BLDG. PERMIT SIGNED

AND RETURNED 3/23/95

Serial # 47639-addition

BLDG. PERMIT SIGNED

AND RETURNED 8/4/87

Serial # 11157

\*INSTALLER IS RESPONSIBLE FOR OBTAINING FINAL APPROVAL ON THIS PERMIT

\*CALL 461-9933 FOR INSPECTION OF SEPTIC SYSTEMS.

EH - 2-1186

P-39731

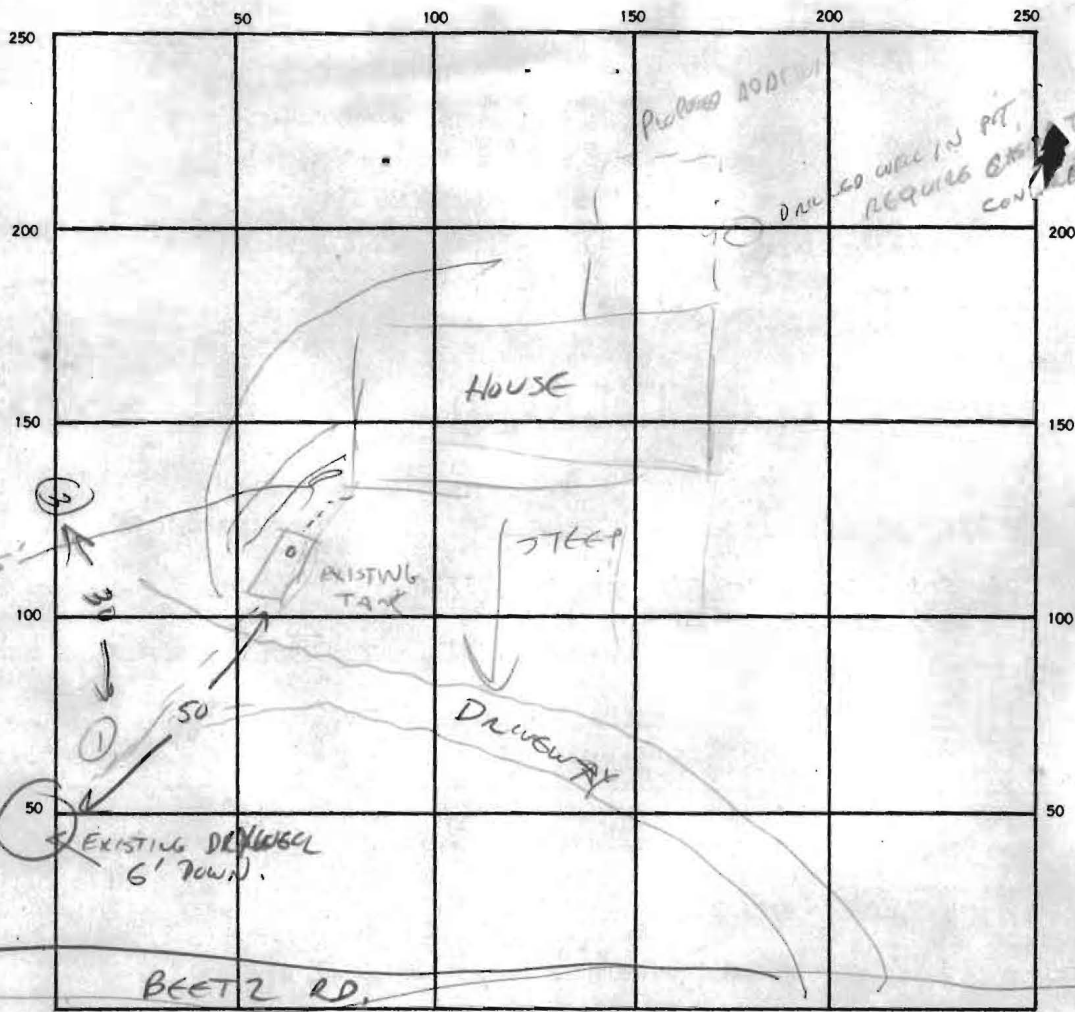

INDICATE NORTH. — NAME ADJOINING ROADWAY AS BASE LINE.

SEPTIC TANK. LEVEL \_\_\_\_\_ CLEANOUTS \_\_\_\_\_

DISTRIBUTION BOX. LEVEL \_\_\_\_\_

DRAIN FIELD/TILE FIELD. DEPTH \_\_\_\_\_ FT. TRENCH WIDTH \_\_\_\_\_ FT. INLET DEPTH \_\_\_\_\_ FT.

EFFECTIVE GRAVEL DEPTH \_\_\_\_\_ FT. TOTAL LENGTH \_\_\_\_\_ FT.

NUMBER OF TRENCHES \_\_\_\_\_ ONE SIDEWALL/BOTTOM AREA \_\_\_\_\_ SQ. FT.

DRYWELL INSIDE DIAMETER \_\_\_\_\_ FT. EFFECTIVE DEPTH BELOW INLET \_\_\_\_\_ FT.

ABSORBENT AREA \_\_\_\_\_ SQ. FT.

REMARKS 3' FILL IN FRONT OF HOUSE

12/12/38

#2

12/12/54

45 SECONDS ON 4" INCH AT 3 1/2' FAILS

12/13/18

HOLDS #2 ACCEPTABLE - DRYWELL LOCATED.

12/14/01

ORANGEBURG SEWER LINE REPLACED.

12/14/48

SUFFICIENT ROAD AREA ESTABLISHED, OK TO RELEASE BP.

DATE SYSTEM APPROVED 8/4/87

INSPECTOR

Craywell

